

ESA - SEE ENVIRONMENTAL RESOURCES IMPACT TABLE IN GENERAL NOTES FOR CONSTRUCTION RESTRICTIONS

Curve 1
 PI Sta: 104+24.44
 N: 1048809.4375
 E: 1992779.2456
 DELTA: 57°07'19.8" (RT)
 D: 6°50'13.9"
 T: 456.15'
 L: 835.46'
 R: 838.00'
 E: 116.11'
 e: MATCH EXIST

MATCHLINE STA 104+50.00
 SEE SHEET 54-0009

MATCHLINE STA 110+00.00
 SEE SHEET 54-0009

Order Plans

WWW.ONLINE.COM

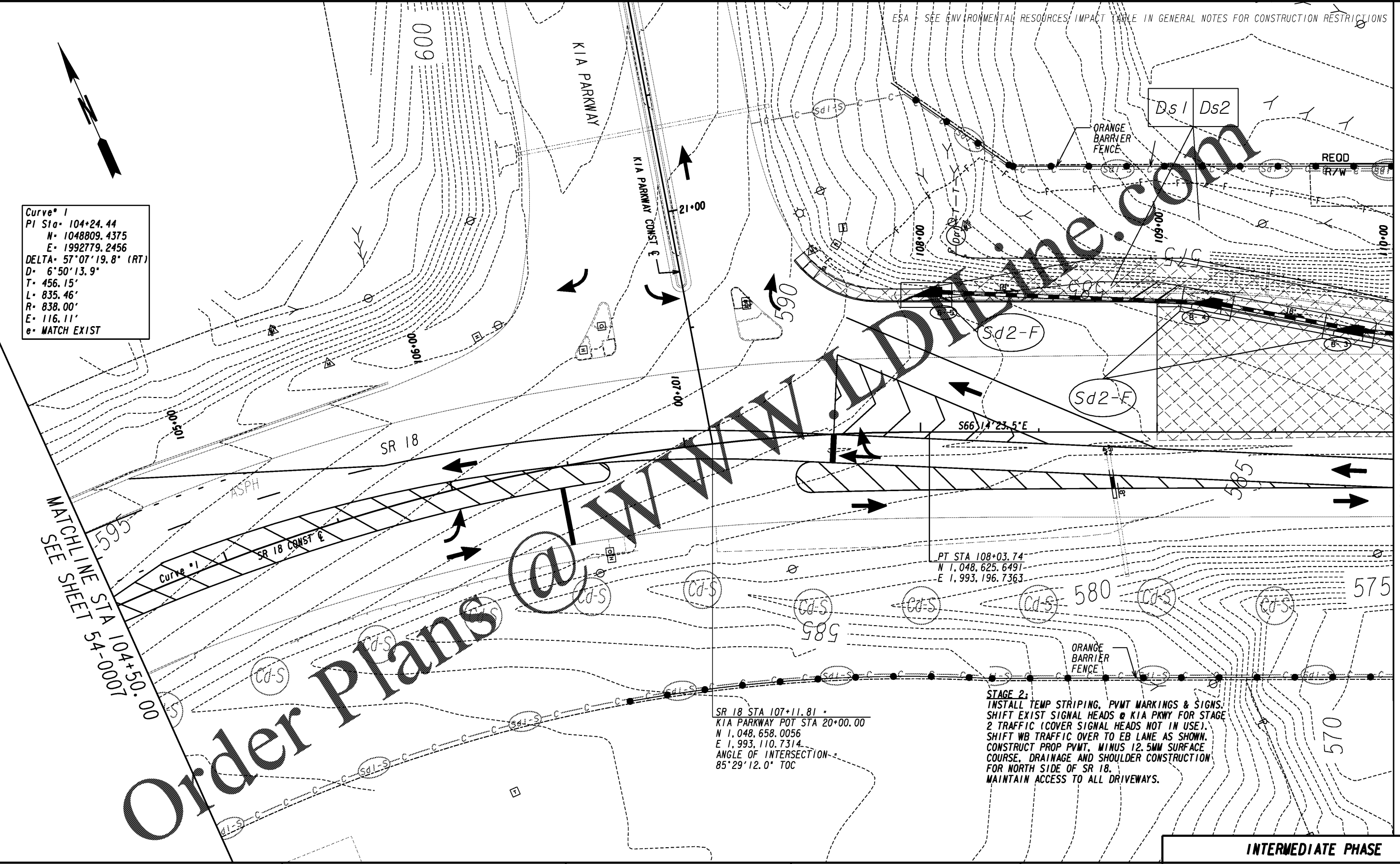

STAGE 2:
 INSTALL TEMP STRIPING, PVT MARKINGS & SIGNS.
 SHIFT EXIST SIGNAL HEADS @ KIA PKWY FOR STAGE
 2 TRAFFIC (COVER SIGNAL HEADS NOT IN USE).
 SHIFT WB TRAFFIC OVER TO EB LANE AS SHOWN.
 CONSTRUCT PROP PVT, MINUS 12.5MM SURFACE
 COURSE, DRAINAGE AND SHOULDER CONSTRUCTION
 FOR NORTH SIDE OF SR 18.
 MAINTAIN ACCESS TO ALL DRIVEWAYS.

PROPERTY AND EXISTING R/W LINE	-----P-----	BEGIN LIMIT OF ACCESS.....BLA	-----B-----
REQUIRED R/W LINE	-----R-----	END LIMIT OF ACCESS.....ELA	-----E-----
CONSTRUCTION LIMITS	-----C-----	LIMIT OF ACCESS	-----L-----
EASEMENT FOR CONSTR	-----F-----	REQ'D R/W & LIMIT OF ACCESS	-----R-----
& MAINTENANCE OF SLOPES	-----S-----	ORANGE BARRIER FENCE	-----O-----
EASEMENT FOR CONSTR OF SLOPES	-----S-----	ESA - ENV. SENSITIVE AREA	-----E-----
EASEMENT FOR CONSTR OF DRIVES	-----D-----	(SEE ERIT TABLE)	-----D-----

INFRASTRUCTURE
 CONSULTING & ENGINEERING
 4940 PEACHTREE INDUSTRIAL BLVD., SUITE 310
 NORCROSS, GEORGIA 30071

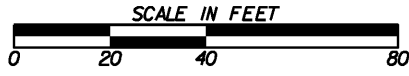

REVISION DATES	

INTERMEDIATE PHASE		
BMP LOCATION DETAILS		
SR 18 BRIDGE REPLACEMENT @ LONG CAME CREEK		
TROUP COUNTY		
STAGE 2 STA 104+50.00 TO STA 110+00.00		
CHECKED:	DATE:	DRAWING No.
BACKCHECKED:	DATE:	54-0008
CORRECTED:	DATE:	
VERIFIED:	DATE:	