

**STAGE 1:**  
MAINTAIN TRAFFIC ON EXIST ROADWAY.  
MAINTAIN ACCESS TO ALL DRIVEWAYS.  
DEMOLISH EXIST CONC MEDIAN & CONSTRUCT TEMP PVMT AS SHOWN.

ESA - SEE ENVIRONMENTAL RESOURCES IMPACT TABLE  
GENERAL NOTES FOR CONSTRUCTION RESTRICTIONS

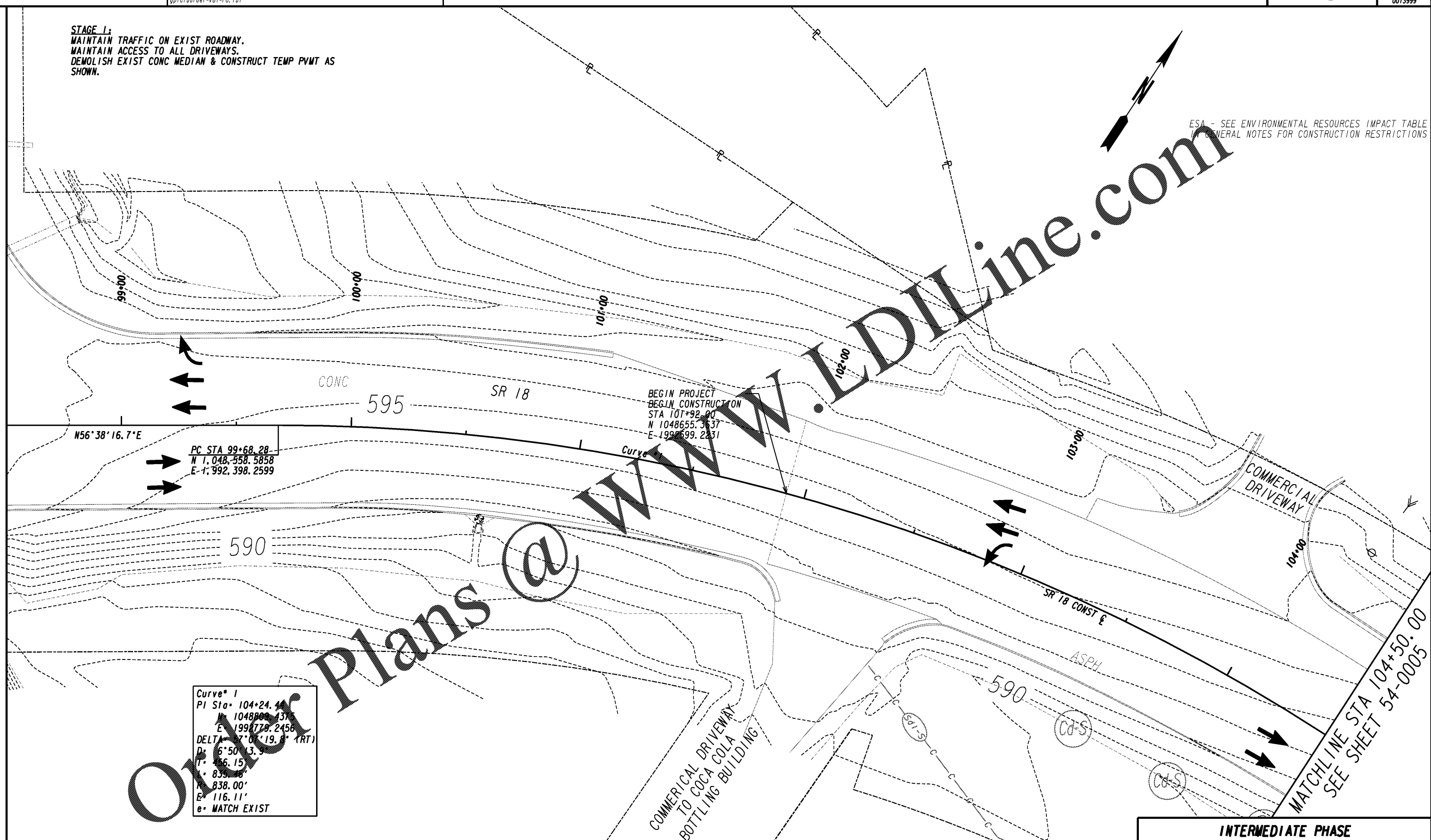

N56°38'16.7"E

PC STA 99+68.28  
N 1,048,558.5858  
E -1,992,398.2599

BEGIN PROJECT  
BEGIN CONSTRUCTION  
STA 101+92.00  
N 1048655.3637  
E -1997699.2231

**Curve 1**  
PI Sta 104+24.41  
N 1048800.1316  
E 1997778.2456  
DELTA 7°07'19.5" (RT)  
D: 6°50'13.9"  
L: 856.15'  
T: 839.08'  
A: 838.00'  
E: 116.11'  
e: MATCH EXIST

Plans @

PROPERTY AND EXISTING R/W LINE  
REQUIRED R/W LINE  
CONSTRUCTION LIMITS  
EASEMENT FOR CONSTR  
& MAINTENANCE OF SLOPES  
EASEMENT FOR CONSTR OF SLOPES  
EASEMENT FOR CONSTR OF DRIVES

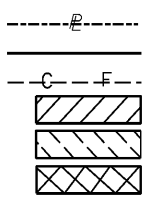

BEGIN LIMIT OF ACCESS.....BLA  
END LIMIT OF ACCESS.....ELA  
LIMIT OF ACCESS  
REQ'D R/W & LIMIT OF ACCESS  
ORANGE BARRIER FENCE  
ESA - ENV. SENSITIVE AREA  
(SEE ERIT TABLE)

**INFRASTRUCTURE**  
CONSULTING & ENGINEERING  
4940 PEACHTREE INDUSTRIAL BLVD., SUITE 310  
NORCROSS, GEORGIA 30071

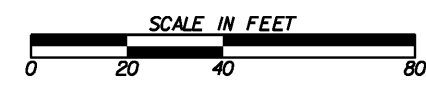

REVISION DATES

NO.	DATE	DESCRIPTION

**INTERMEDIATE PHASE**  
**BMP LOCATION DETAILS**  
**SR 18 BRIDGE REPLACEMENT @ LONG CAME CREEK**  
**TROUP COUNTY**  
**STAGE 1 STA 101+92.00 TO STA 104+50.00**

CHECKED:	DATE:	DRAWING No.
BACKCHECKED:	DATE:	54-0004
CORRECTED:	DATE:	
VERIFIED:	DATE:	