

**STAGE 5**

**TRAFFIC**

1. USE CIRCULATING TRAFFIC AT ROUNDABOUTS.
2. MAINTAIN SINGLE LANE OF TRAFFIC IN ALL DIRECTIONS AS SHOWN UNTIL FINAL PAVEMENT MARKINGS ARE PLACED.
3. ADD FINAL PAVEMENT MARKINGS.
4. MAINTAIN ACCESS TO ALL DRIVEWAYS.

**CONSTRUCTION**

1. SEE PI 0013999 FOR CONSTRUCTION STAGING UPSTREAM OF STA 15+00.00.
2. PLACE THE 12.5MM SURFACE LIFT.
3. COMPLETE MEDIAN AS SHOWN.

**EROSION**

1. MAINTAIN PERIMETER BMPs.
2. MAINTENANCE OF TEMPORARY BMPs FROM PREVIOUS STAGES.

ESA - PERENNIAL STREAM PSI  
 SEE GENERAL NOTES 'ENVIRONMENTAL  
 RESOURCES IMPACT TABLE'  
 FOR CONSTRUCTION RESTRICTIONS

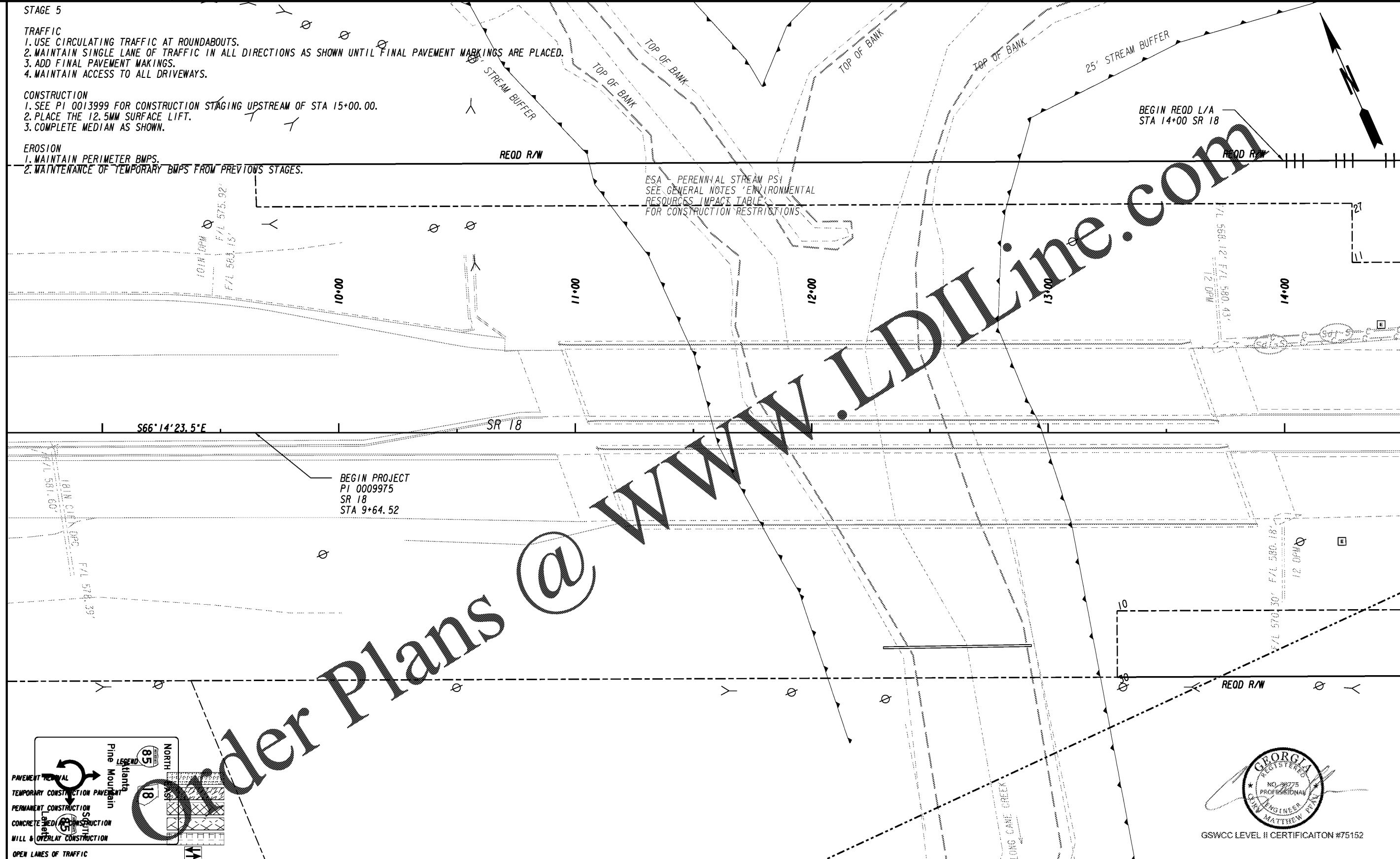

S66°14'23.5"E

BEGIN PROJECT  
 PI 0009975  
 SR 18  
 STA 9+64.52

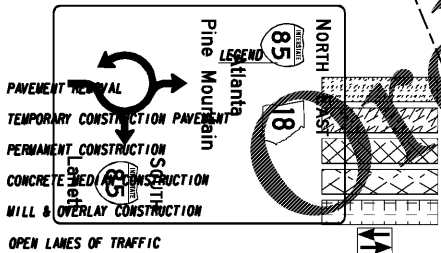

PROPERTY AND EXISTING R/W LINE	---
REQUIRED R/W LINE	---
CONSTRUCTION LIMITS	---
EASEMENT FOR CONSTR & MAINTENANCE OF SLOPES	---
EASEMENT FOR CONSTR OF SLOPES	---
EASEMENT FOR CONSTR OF DRIVES	---

BEGIN LIMIT OF ACCESS.....BLA	---
END LIMIT OF ACCESS.....ELA	---
REQ'D LIMIT OF ACCESS	---
REQ'D LIMIT OF ACCESS & R/W	---
ORANGE BARRIER FENCE	---
ESA - ENV. SENSITIVE AREA (SEE ERIT TABLE)	---

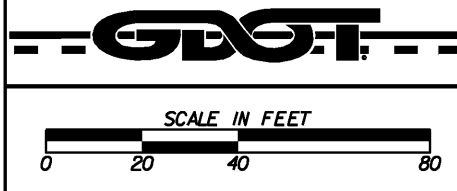
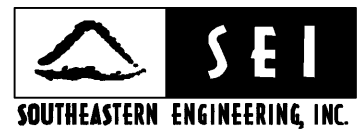

REVISION DATES	

BMP LOCATION DETAILS		
1-85 @ SR 18 & SR 18 @ SR 103		
STAGE 5 INTERMEDIATE PHASE		
CHECKED:	DATE:	DRAWING No.
BACKCHECKED:	DATE:	54-0076
CORRECTED:	DATE:	
VERIFIED:	DATE:	