

STAGE 4

TRAFFIC

- 1. USE CIRCULATING TRAFFIC AT ROUNDABOUTS.
- 2. MAINTAIN SINGLE LANE OF TRAFFIC IN ALL DIRECTIONS.
- 3. SHIFT EB TRAFFIC BACK TO WB LANE ON SR 18; UTILIZE ONE LANE IN EACH DIRECTION, APPROXIMATE STA (37+50 TO 41+00).
- 4. MAINTAIN ACCESS TO ALL DRIVEWAYS.

CONSTRUCTION

- 1. SEE PI 0013999 FOR CONSTRUCTION STAGING UPSTREAM OF STA 15+00.00.
- 2. CONSTRUCT PERMANENT PAVEMENT AS SHOWN THROUGH 19MM LIFT.
- 3. COMPLETE MEDIAN AND ROUNDABOUT APRON/CENTRAL ISLAND AS SHOWN.
- 4. REMOVE EXISTING SR 103 ROADWAY, REMOVE TEMPORARY PAVEMENT FROM PREVIOUS STAGES AND GRADE TO DRAIN.
- 5. COMPLETE SHOULDERS AND DITCHES WHERE TEMPORARY DITCHES USED TO BE.

EROSION

- 1. MAINTAIN PERIMETER BMPS.
- 2. MAINTENANCE OF TEMPORARY BMPS FROM PREVIOUS STAGES.
- 3. INSTALL TEMPORARY BMPS AS SHOWN.

ESA - PERENNIAL STREAM PSI
SEE GENERAL NOTES 'ENVIRONMENTAL
RESOURCES IMPACT TABLE'
FOR CONSTRUCTION RESTRICTIONS

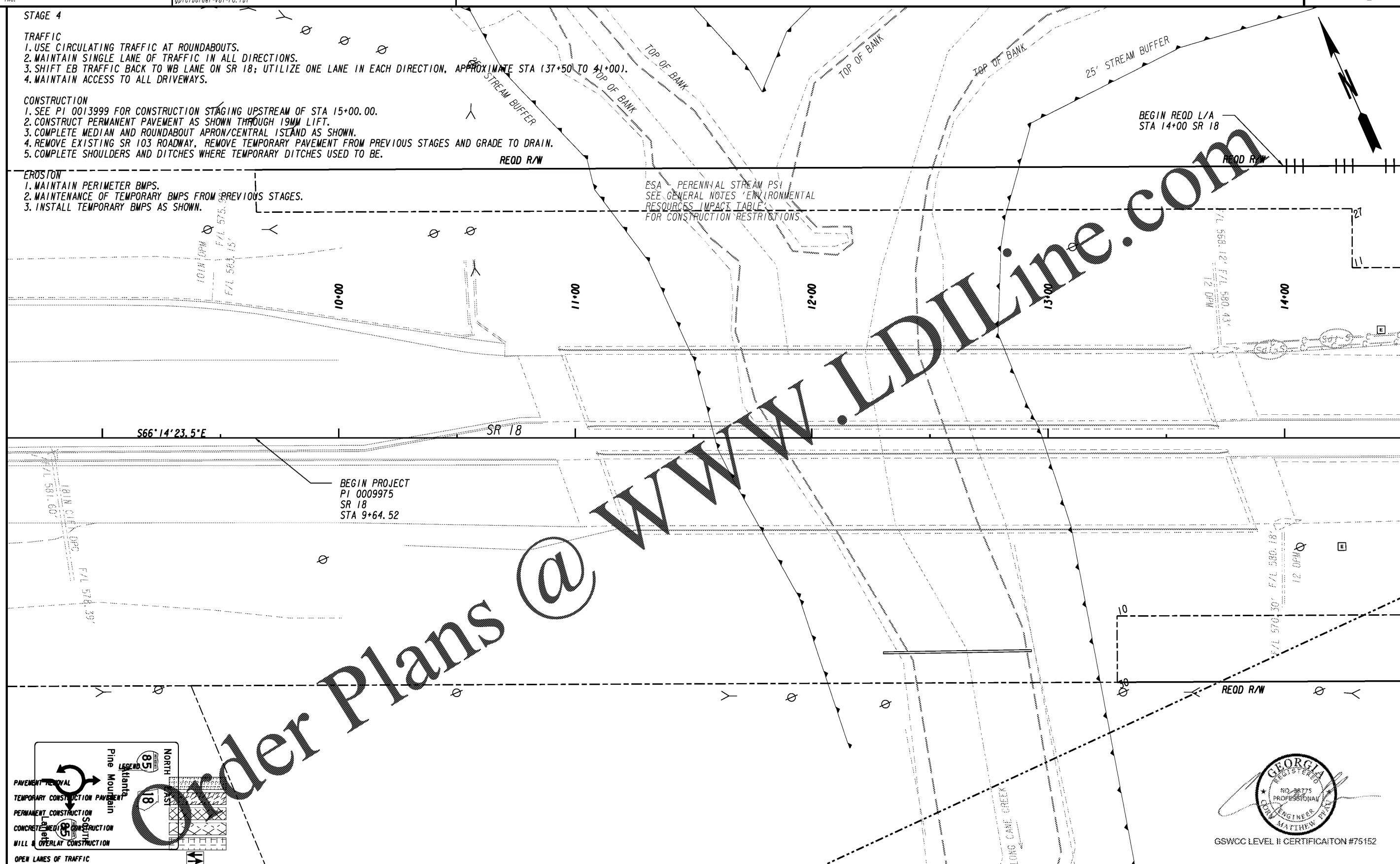

S66°14'23.5"E

SR 18

BEGIN PROJECT
PI 0009975
SR 18
STA 9+64.52

BEGIN REOD L/A
STA 14+00 SR 18

REOD R/W

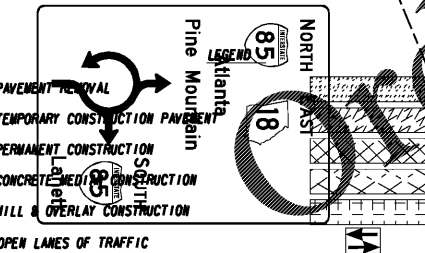

GSWCC LEVEL II CERTIFICATION #75152

PROPERTY AND EXISTING R/W LINE	---
REQUIRED R/W LINE	---
CONSTRUCTION LIMITS	---
EASEMENT FOR CONSTR & MAINTENANCE OF SLOPES	---/---
EASEMENT FOR CONSTR OF SLOPES	---/---
EASEMENT FOR CONSTR OF DRIVES	---/---

BEGIN LIMIT OF ACCESS.....BLA	---
END LIMIT OF ACCESS.....ELA	---
REQ'D LIMIT OF ACCESS	---
REQ'D LIMIT OF ACCESS & R/W	---
ORANGE BARRIER FENCE	---
ESA - ENV. SENSITIVE AREA (SEE ERIT TABLE)	---

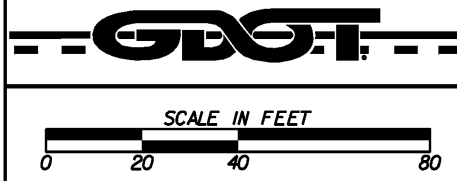
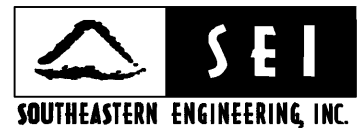

REVISION DATES	

BMP LOCATION DETAILS		
1-85 @ SR 18 & SR 18 @ SR 103		
STAGE 4 INTERMEDIATE PHASE		
CHECKED:	DATE:	DRAWING No.
BACKCHECKED:	DATE:	54-0061
CORRECTED:	DATE:	
VERIFIED:	DATE:	

DRAWING No. 54-0062
MATCH LINE STA. 14+50