

ESA - PERENNIAL STREAM PS
SEE GENERAL NOTES 'ENVIRONMENTAL
RESOURCES' IMPACT TABLE
FOR CONSTRUCTION RESTRICTIONS

END PROPOSED L/A
BEGIN EAST L/A
STA 406+50.00
FOR EXIT RAMP

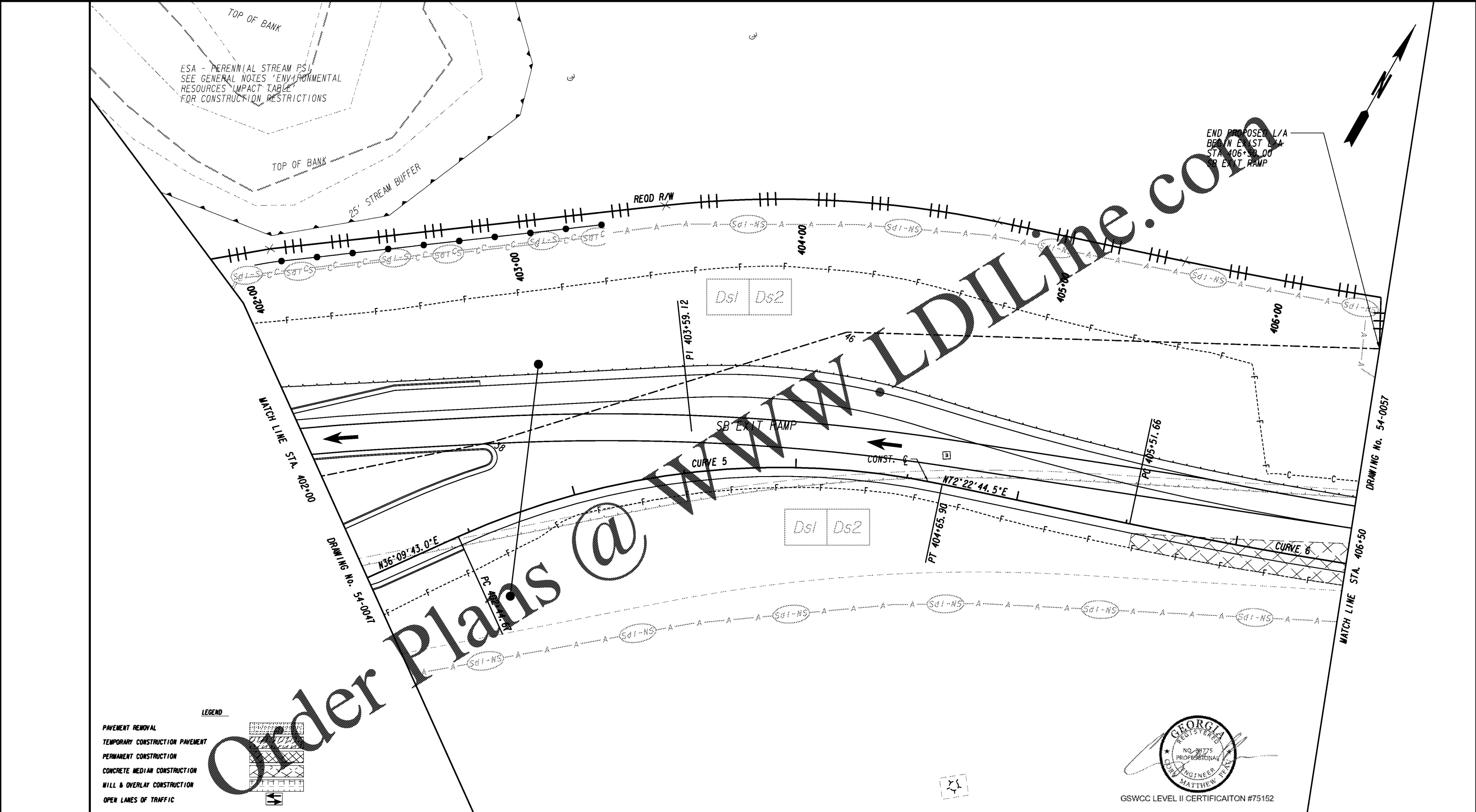

LEGEND

	PAVEMENT REMOVAL
	TEMPORARY CONSTRUCTION PAVEMENT
	PERMANENT CONSTRUCTION
	CONCRETE MEDIAN CONSTRUCTION
	MILL & OVERLAY CONSTRUCTION
	OPEN LANES OF TRAFFIC

Order plans @ WWW.LDILINE.COM



	PROPERTY AND EXISTING R/W LINE
	REQUIRED R/W LINE
	CONSTRUCTION LIMITS
	EASEMENT FOR CONSTR & MAINTENANCE OF SLOPES
	EASEMENT FOR CONSTR OF SLOPES
	EASEMENT FOR CONSTR OF DRIVES

	BEGIN LIMIT OF ACCESS.....BLA
	END LIMIT OF ACCESS.....ELA
	REQ'D LIMIT OF ACCESS
	REQ'D LIMIT OF ACCESS & R/W
	ORANGE BARRIER FENCE
	ESA - ENV. SENSITIVE AREA (SEE ERIT TABLE)

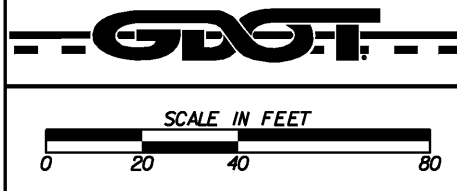
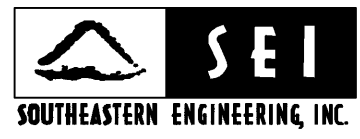

REVISION DATES	

BMP LOCATION DETAILS		
1-85 @ SR 18 & SR 18 @ SR 103		
STAGE 3 INTERMEDIATE PHASE		
CHECKED:	DATE:	DRAWING No.
BACKCHECKED:	DATE:	54-0056
CORRECTED:	DATE:	
VERIFIED:	DATE:	