

ESA - PERENNIAL STREAM PS
SEE GENERAL NOTES 'ENVIRONMENTAL
RESOURCES' IMPACT TABLE
FOR CONSTRUCTION RESTRICTIONS

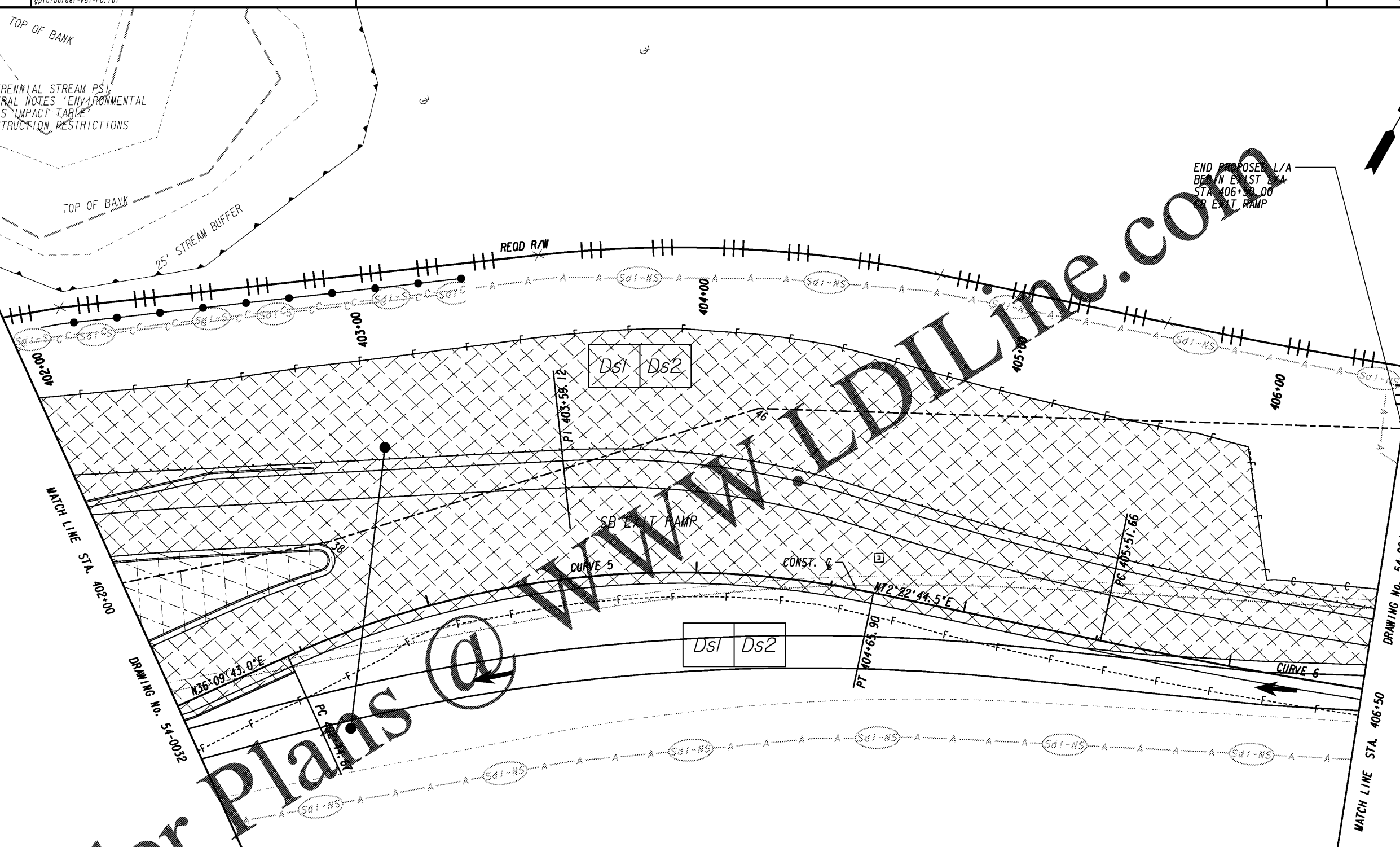

END PROPOSED L/A
BEGIN EAST L/A
STA 406+50.00
FOR EXIT RAMP

MATCH LINE STA. 402+00

DRAWING NO. 54-0032

DRAWING NO. 54-0042

MATCH LINE STA. 406+50

LEGEND

- PAVEMENT REMOVAL
- TEMPORARY CONSTRUCTION PAVEMENT
- PERMANENT CONSTRUCTION
- CONCRETE MEDIAN CONSTRUCTION
- MILL & OVERLAY CONSTRUCTION
- OPEN LANES OF TRAFFIC

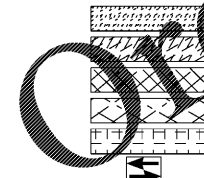

- PROPERTY AND EXISTING R/W LINE
- REQUIRED R/W LINE
- CONSTRUCTION LIMITS
- EASEMENT FOR CONSTR & MAINTENANCE OF SLOPES
- EASEMENT FOR CONSTR OF SLOPES
- EASEMENT FOR CONSTR OF DRIVES

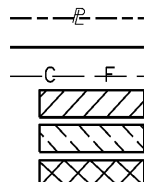

- BEGIN LIMIT OF ACCESS.....BLA
- END LIMIT OF ACCESS.....ELA
- REQ'D LIMIT OF ACCESS
- REQ'D LIMIT OF ACCESS & R/W
- ORANGE BARRIER FENCE
- ESA - ENV. SENSITIVE AREA (SEE ERIT TABLE)

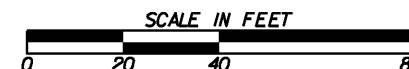
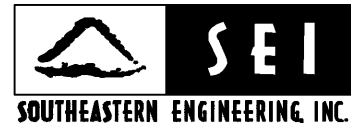
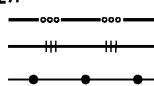

REVISION DATES

NO.	DATE	DESCRIPTION

BMP LOCATION DETAILS

I-85 @ SR 18 & SR 18 @ SR 103
STAGE 2 INTERMEDIATE PHASE

CHECKED:	DATE:	DRAWING No.
BACKCHECKED:	DATE:	54-0041
CORRECTED:	DATE:	
VERIFIED:	DATE:	



Order Plans @ www.LDILine.com