

STAGE 2

TRAFFIC

- 1. SHIFT WB TRAFFIC TO EB LANE ON SR 18; UTILIZE 2. ONE LANE IN EACH DIRECTION.
- 2. USE SINGLE LANE FOR NB AND SB OFF RAMP AND ON RAMP; USE THE NEW BYPASS LANE PAVEMENT.
- 3. MAINTAIN USE OF TEMPORARY SIGNALS AT THE NB RAMP TERMINAL.
- 4. MAINTAIN ACCESS TO ALL DRIVEWAYS.

CONSTRUCTION

- 1. SEE PI 0013999 FOR CONSTRUCTION STAGING UPSTREAM OF STA 15+00.00.
- 2. PLACE TEMPORARY PAVEMENT AS SHOWN.
- 3. CONSTRUCT PERMANENT PAVEMENT AS SHOWN THROUGH 19MM LIFT.
- 4. CONSTRUCT MEDIAN ISLANDS AS SHOWN.
- 5. MAINTAIN USE OF EXISTING ROADWAY FOR NB AND SB EXIT RAMP, AND SR 103.
- 6. COMPLETE ANY SHOULDER WORK NOT FINISHED IN STAGE 1.
- 7. INSTALL TEMPORARY DRAINAGE AS NOTED.

EROSION

- 1. MAINTAIN PERIMETER BMPS.
- 2. MAINTENANCE OF TEMPORARY BMPS FROM PREVIOUS STAGES.
- 3. INSTALL TEMPORARY BMPS AS SHOWN.

ESA - PERENNIAL STREAM PSI
SEE GENERAL NOTES 'ENVIRONMENTAL
RESOURCES IMPACT TABLE'
FOR CONSTRUCTION RESTRICTIONS.

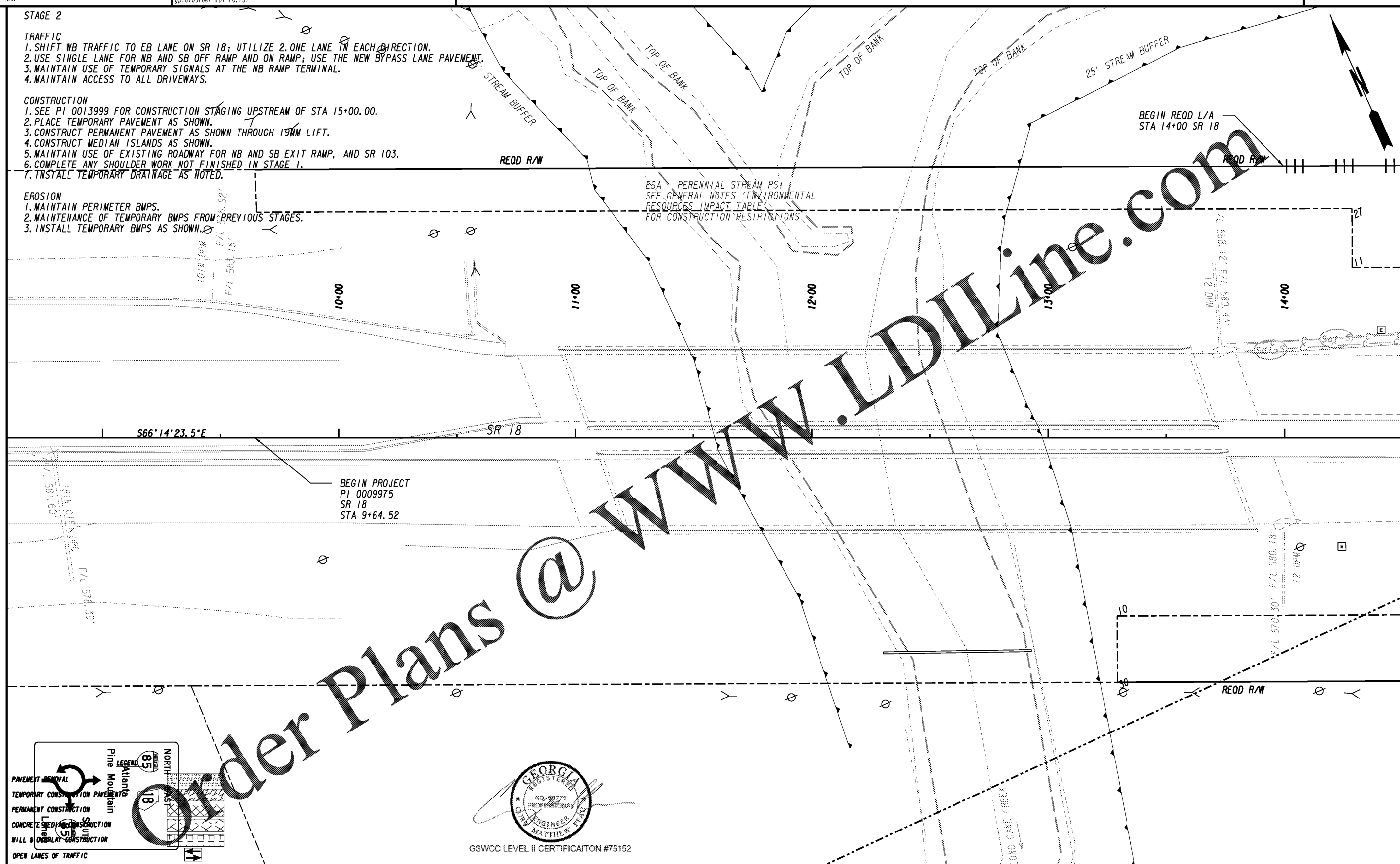

S66°14'23.5"E

SR 18

BEGIN PROJECT
PI 0009975
SR 18
STA 9+64.52

BEGIN REOD L/A
STA 14+00 SR 18

DRAWING No. 54-0032

MATCH LINE STA. 14+50

LEGEND

85
North
8
East

Pine Mountain
Atlantic

PAVEMENT REMOVAL
TEMPORARY CONSTRUCTION PAVEMENT
PERMANENT CONSTRUCTION
CONCRETE MEDIAN CONSTRUCTION
WILL & OVRLAY CONSTRUCTION
OPEN LANES OF TRAFFIC

GEORGIA REGISTERED PROFESSIONAL ENGINEER
NO. 28775
MATTHEW PEAK

GSWCC LEVEL II CERTIFICATION #75152

PROPERTY AND EXISTING R/W LINE	---
REQUIRED R/W LINE	---
CONSTRUCTION LIMITS	---
EASEMENT FOR CONSTR & MAINTENANCE OF SLOPES	---/---
EASEMENT FOR CONSTR OF SLOPES	---/---
EASEMENT FOR CONSTR OF DRIVES	---/---

BEGIN LIMIT OF ACCESS.....BLA	---
END LIMIT OF ACCESS.....ELA	---
REQ'D LIMIT OF ACCESS	---
REQ'D LIMIT OF ACCESS & R/W	---
ORANGE BARRIER FENCE	---
ESA - ENV. SENSITIVE AREA (SEE ERIT TABLE)	---

SEI
SOUTHEASTERN ENGINEERING, INC.

GDOT

SCALE IN FEET

0 20 40 80

REVISION DATES	

BMP LOCATION DETAILS

1-85 @ SR 18 & SR 18 @ SR 103
STAGE 2 INTERMEDIATE PHASE

CHECKED:	DATE:	DRAWING No. 54-0031
BACKCHECKED:	DATE:	
CORRECTED:	DATE:	
VERIFIED:	DATE:	