

DEPARTMENT OF TRANSPORTATION STATE OF GEORGIA

EROSION, SEDIMENTATION & POLLUTION CONTROL PLAN I-85 AT SR 18 AND SR 18 AT SR 103 INTERSECTION IMPROVEMENTS.

FEDERAL AID PROJECT
TROUP COUNTY

This project has been prepared using the Horizontal Georgia Coordinate System of 1984 (NAD 83) and the North American Vertical Datum (NAVD) of 1988.

STA 16+86.67 SR 18 -
STA 400+00.00 SB EXIT RAMP

BEGIN EXIST BRIDGE
SR 18
STA 11+08.34

END EXIST BRIDGE
SR 18
STA 13+71.88

BEGIN PROJECT
PI 0009975
STA 15+00.00 -
END PROJECT
PI 0013999
STA 115+00.00
N 1048345.1220
E 1993833.9770

STA 16+43.29 SR 18 -
STA 305+81.20 SB ENTRANCE RAMP

PRIMARY PERMITTEE

GEORGIA DEPARTMENT OF TRANSPORTATION
One Georgia Center
600 West Peachtree Street North West
Atlanta, Georgia 30308
Phone: (404) 631-1990
Email: espcep@dof.ga.gov

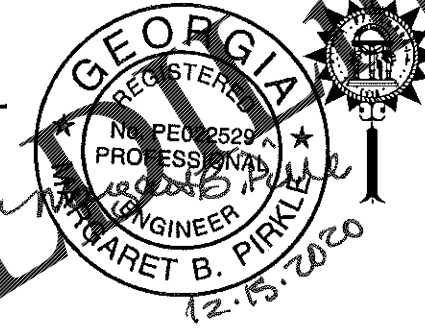
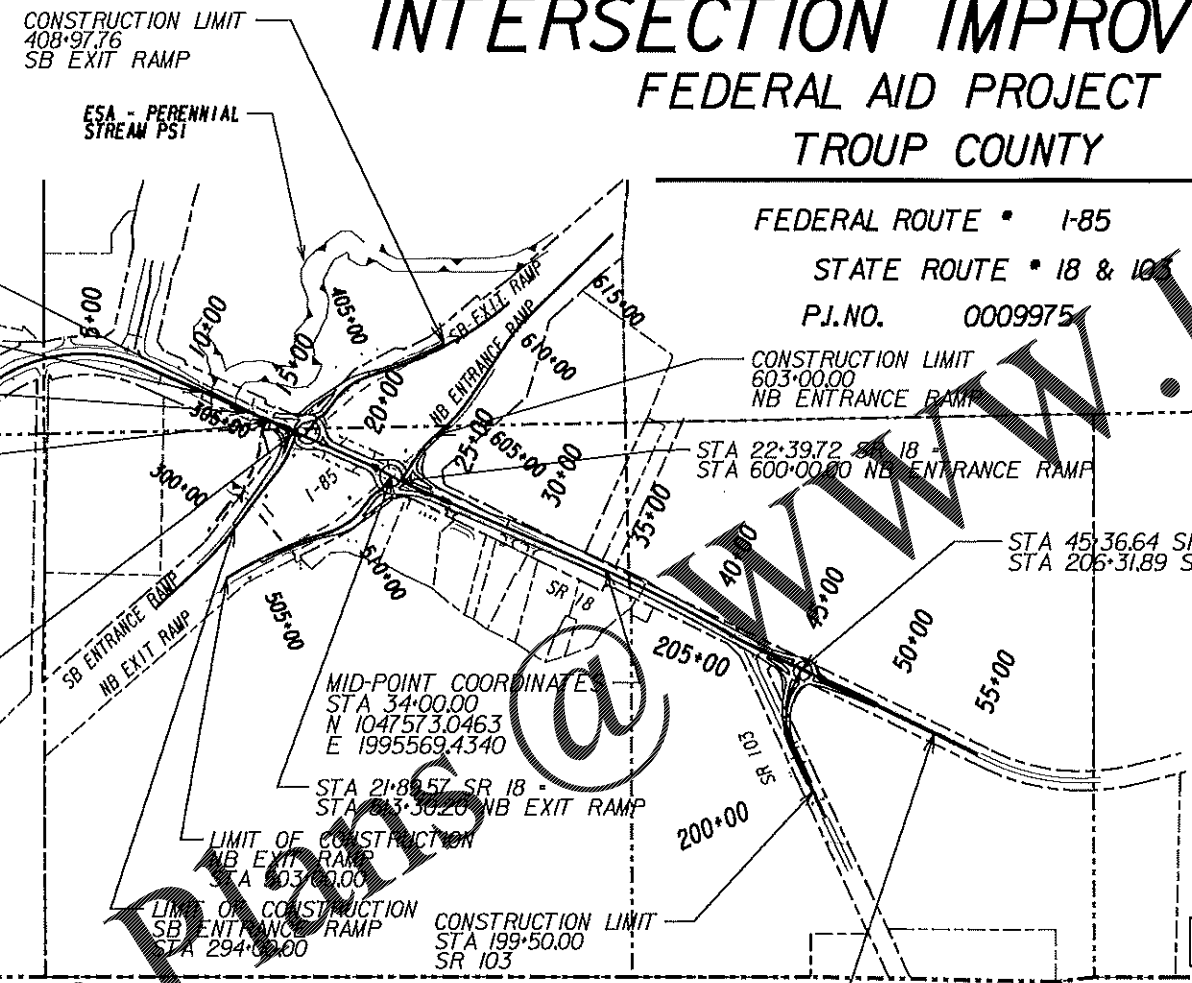

BEGIN-POINT COORDINATES
Longitude: -85.15282°
Latitude: 32.87829°
MID-POINT COORDINATES
Longitude: -85.14714°
Latitude: 32.87621°
END-POINT COORDINATES
Longitude: -85.14158°
Latitude: 32.87394°

"I certify that this Erosion, Sedimentation and Pollution Control Plan has been prepared in accordance with Part IV, of the General NPDES Permit No. GA000002."

"I certify that the permittee's Erosion, Sedimentation and Pollution Control Plan provides for an appropriate and comprehensive system of best management practices required by the Georgia Water Quality Control Act and the document 'Manual for Erosion and Sediment Control in Georgia' (Manual) published by the State Soil and Water Conservation Commission as of January 1 of the year in which the land disturbing activity was permitted, provides for sampling of the receiving water(s) and the sampling of the storm water outfalls and that the designed system of best management practices and sampling methods is expected to meet the requirements contained in the General NPDES Permit No. GA000002."

"I certify that the permittee's Erosion, Sedimentation and Pollution Control Plan provides for the monitoring of (a) all perennial and intermittent streams and other water bodies shown on the USGS topographic map and all other field verified perennial and intermittent streams and other water bodies, or (b) where any such specific identified perennial or intermittent stream and other water body is not proposed to be sampled, I have determined in my professional judgment, utilizing the factors required in the General NPDES Permit No. GA000002, that the increase in the turbidity of each specific identified sampled receiving water will be representative of the increase in the turbidity of a specific identified un-sampled receiving water."

"I certify under penalty of law that this plan was prepared after a site visit to the location described herein by myself or my authorized agent, under my direct supervision."

(3) "I CERTIFY UNDER THE PENALTY OF LAW THAT THIS DOCUMENT AND ALL ATTACHMENTS WERE PREPARED UNDER MY DIRECTION OR SUPERVISION IN ACCORDANCE WITH A SYSTEM DESIGNED TO ASSURE THAT QUALIFIED PERSONNEL PROPERLY GATHER AND EVALUATE THE INFORMATION SUBMITTED. BASED ON MY INQUIRY OF THE PERSON OR PERSONS WHO MANAGE THE SYSTEM, OR THOSE PERSONS DIRECTLY RESPONSIBLE FOR GATHERING THE INFORMATION, THE INFORMATION SUBMITTED IS, TO THE BEST OF KNOWLEDGE AND BELIEF, TRUE, ACCURATE, AND COMPLETE. I AM AWARE THAT THERE ARE SIGNIFICANT PENALTIES FOR SUBMITTING FALSE INFORMATION, INCLUDING THE POSSIBILITY OF FINE AND IMPRISONMENT FOR KNOWING VIOLATIONS."

[Signature]
PRIMARY PERMITTEE'S SIGNATURE OR AUTHORIZED AGENT

"I CERTIFY AS THE DESIGN PROFESSIONAL THAT I WILL VISIT THE SITE TO VISUALLY INSPECT THE INSTALLATION OF THE INITIAL SEDIMENT STORAGE REQUIREMENTS, PERIMETER CONTROL BMPs, AND THE SEDIMENT BASINS IN ACCORDANCE WITH PART IV, A.5 WITHIN 7 DAYS AFTER INSTALLATION"

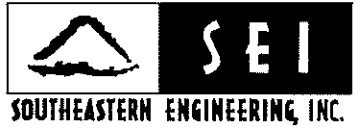

PLANS PREPARED BY: SOUTHEASTERN ENGINEERING, INC.

RECOMMENDED FOR APPROVAL BY: *Kimberly W. Nesbitt*
STATE PROGRAM DELIVERY ADMINISTRATOR

Date: 12/5/2020 *Margaret B. Pirkle*
MARGARET B. PIRKLE, P.E. - CHIEF ENGINEER

0000072890
GSWCC LEVEL II Certification Number

24 HOUR CONTACT:

Name _____

Street Address _____

City, State Zip _____

Phone Number _____

Email Address _____

Contractor shall complete the information in this box.

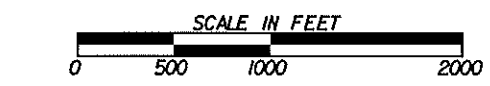

LENGTH OF PROJECT	COUNTY No. 285
	Project No. 0009975
	MILES
NET LENGTH OF ROADWAY	0.72
NET LENGTH OF BRIDGES	0.00
NET LENGTH OF PROJECT	0.72
NET LENGTH OF EXCEPTIONS	
GROSS LENGTH OF PROJECT	0.72



PLANS COMPLETED 12-03-2020

DATE	ENTITY REQUESTING REVISION(S)	DRAWING NUMBER(S)	SIGNATURE	GSWCC LEVEL II CERT.*
-	-	-	-	-
-	-	-	-	-
-	-	-	-	-
-	-	-	-	-
-	-	-	-	-