

LOCATION SKETCH

DESIGN DATA:
 TRAFFIC A.D.T.: 22,150 (2020)
 TRAFFIC A.D.T.: 30,450 (2040)
 TRAFFIC D.H.V.: 2,055
 DIRECTIONAL DIST.: 50/50
 % TRUCKS: 11%
 24 HR. TRUCKS %: 12.5%
 SPEED DESIGN: 45 MPH

LOCATION & DESIGN APPROVAL DATE: N/A

FUNCTIONAL CLASS:
RURAL MINOR ARTERIAL

THIS PROJECT IS 100% IN TROUP COUNTY AND IS 100% IN CONG. DIST. NO. 3.

PROJECT DESIGNATION: EXEMPT

THIS PROJECT HAS BEEN PREPARED USING THE HORIZONTAL GEORGIA COORDINATE SYSTEM OF 1983 (NAD 1983/94 WEST ZONE, AND THE NORTH AMERICAN VERTICAL DATUM (NAVD) OF 1988.

DEPARTMENT OF TRANSPORTATION
 STATE OF GEORGIA
 CITY OF WEST POINT, GEORGIA
 UTILITY RELOCATION PLANS
 BRIDGE REPLACEMENT PROJECT
 SR 18/EAST 10TH STREET OVER LONG CANE CREEK
 TROUP COUNTY

FEDERAL ROUTE N/A
 STATE ROUTE # 18
 P.I. NO. 0013999

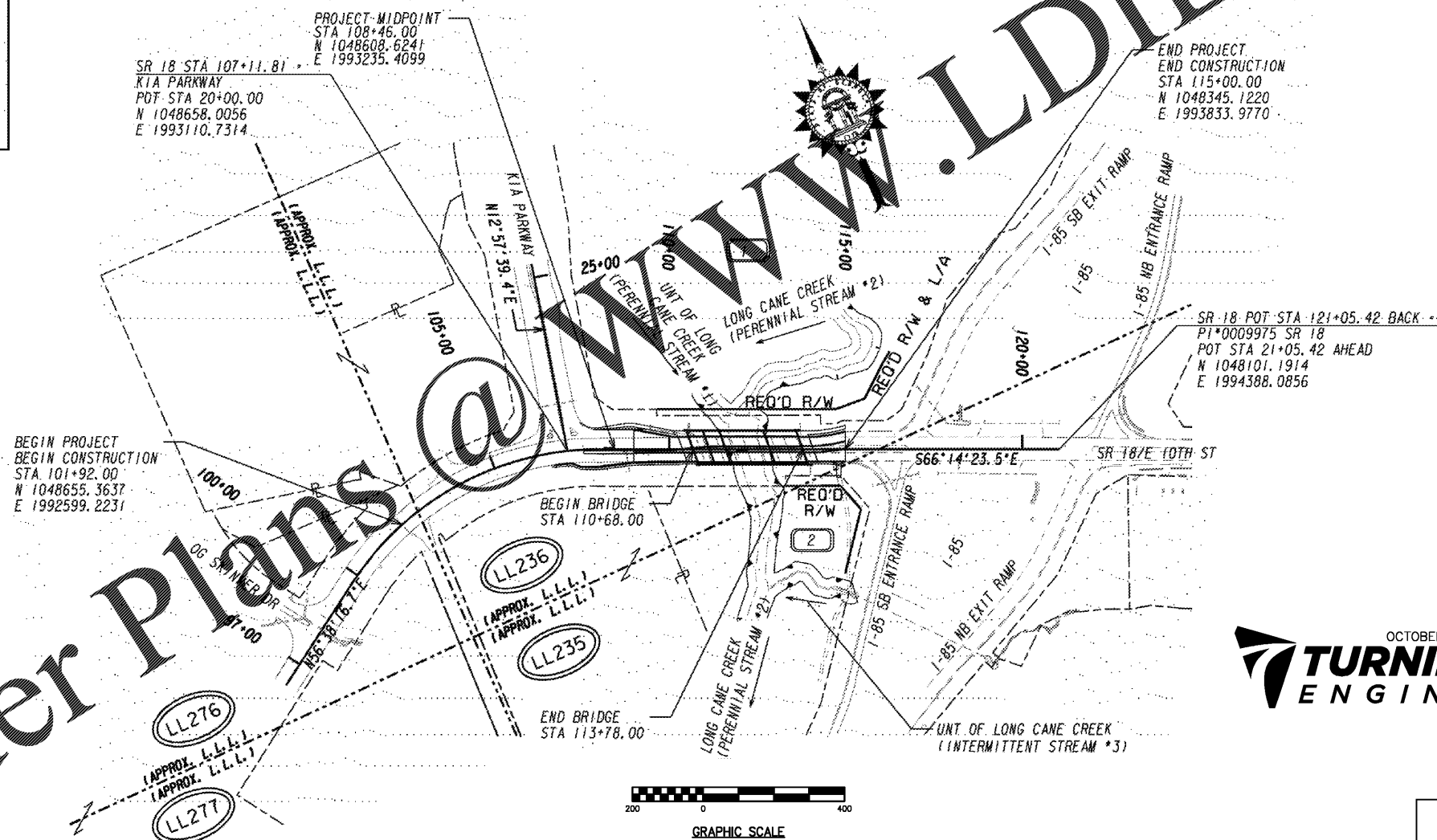

Order Plans @



OCTOBER 2020

ATLANTA
 AUGUSTA
 ST. SIMONS ISLAND

PROJECT TO BE CONSTRUCTED AS PER GEORGIA DEPARTMENT OF TRANSPORTATION STANDARD SPECIFICATIONS, 2013 EDITION, AS APPROVED BY THE FEDERAL HIGHWAY ADMINISTRATION AND AS MODIFIED BY CONTRACT DOCUMENTS.

LENGTH OF PROJECT	COUNTY No. 285
	Project No. 0013999
	MILES
NET LENGTH OF ROADWAY	0.232
NET LENGTH OF BRIDGES	0.059
NET LENGTH OF PROJECT	0.291
NET LENGTH OF EXCEPTIONS	0.000
GROSS LENGTH OF PROJECT	0.291

PLANS COMPLETED: OCTOBER 2020

REVISIONS:

DATE: SHEET NO:



Know what's below.
 Call before you dig.

DRAWING No.

44-0001

THE DATA TOGETHER WITH ALL OTHER INFORMATION SHOWN ON THESE PLANS OR IN ANYWAY INDICATED THEREBY, WHETHER BY DRAWINGS OR NOTES, OR IN ANY OTHER MANNER, ARE BASED UPON FIELD INVESTIGATIONS AND ARE BELIEVED TO BE INDICATIVE OF ACTUAL CONDITIONS. HOWEVER, THE SAME ARE SHOWN AS INFORMATION ONLY, ARE NOT GUARANTEED, AND DO NOT BIND THE DEPARTMENT OF TRANSPORTATION IN ANY WAY. THE ATTENTION OF BIDDER IS SPECIFICALLY DIRECTED TO SUBSECTIONS 102.04, 102.05, AND 104.03 OF THE SPECIFICATIONS.