

NOTE: LOCATION OF DETOURS TO BE DETERMINED BY THE ENGINEER ON CONSTRUCTION OR AS SHOWN IN THE PLANS.

TEMPORARY TRAFFIC CONTROL DEVICES FOR DETOURS SHALL CONFORM TO THE REQUIREMENTS OF THE MANUAL ON UNIFORM TRAFFIC CONTROL DEVICES AND SHALL BE INCLUDED IN THE PAYMENT FOR TRAFFIC CONTROL.

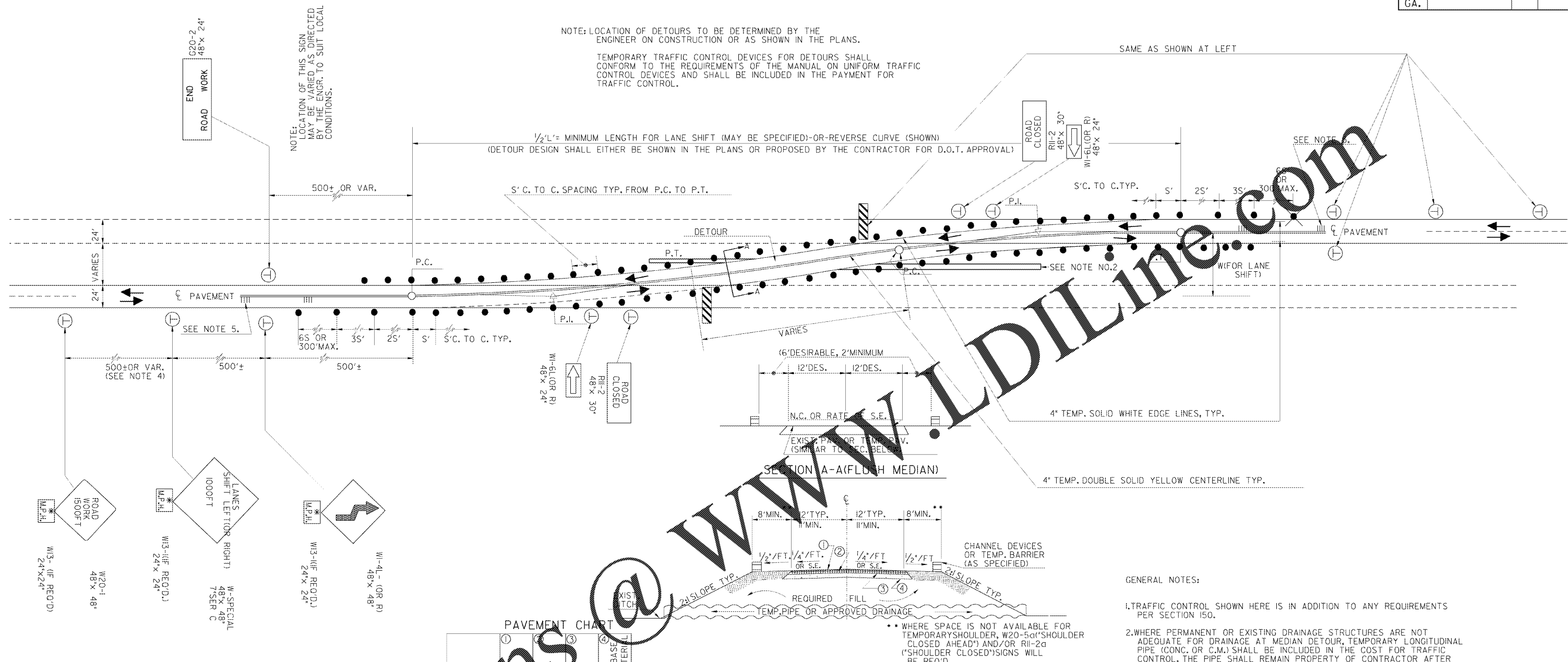

PAVEMENT CHART

	①	②	③	④
CURRENT AD. (C&W)	12.5 SUPERPAVE	16.5 SUPERPAVE	19 mm SUPERPAVE	220 lb/yd <sup>2</sup>
	12.5 SUPERPAVE	16.5 SUPERPAVE	25 mm SUPERPAVE	330 lb/yd <sup>2</sup>
				8" GRADED AGGREGATE BASE
				-OR- OTHER BASE MATERIAL
UNDER 750	X	X		X
750-1500	X	X		X
1500-6000	X	X	X	X
OVER 6000	X	X	X*	X

\*USE 25 mm SUPERPAVE-440 lb/yd<sup>2</sup> IF DETOUR IS TO BE IN OPERATION FOR LONGER THAN 2 YEAR.

STANDARD LEGEND

- TYPE III BARRICADE
- SEQUENTIAL-OR-FLASHING ARROW
- TEMPORARY POST MOUNTED SIGN - (7' MOUNT HEIGHT)
- PORTABLE MOUNTED SIGN - MINIMUM HEIGHT OF 1 FT. ABOVE THE EDGE OF PAVEMENT; INSTALLED AS PER NCHRP 350 TESTING REQUIREMENTS.
- WORK AREA

SPEED POSTED AT: W1-4 SIGN (MPH)	TYPICAL DIMENSIONS (FT.)			
	S	2S	3S	6S OR 300' MAX.
25	25	50	75	150
30	30	60	90	180
35	35	70	105	210
40	40	80	120	240
45	45	90	135	270
50	50	100	150	300
55	55	110	165	330

(NOT APPLICABLE FOR CHANNEL TRAFFIC CONTROL-SEE NO. 4)

\*TEMPORARY ADVISORY SPEEDS (IF REQ'D) WILL TYPICALLY DEPEND UPON THE DESIGN SPEED OF THE CURVES OR LANE SHIFTS AND SHALL BE SHOWN IN THE PLANS OR APPROVED BY THE ENGINEER.

GENERAL NOTES:

- TRAFFIC CONTROL SHOWN HERE IS IN ADDITION TO ANY REQUIREMENTS PER SECTION 150.
- WHERE PERMANENT OR EXISTING DRAINAGE STRUCTURES ARE NOT ADEQUATE FOR DRAINAGE AT MEDIAN DETOUR, TEMPORARY LONGITUDINAL PIPE (CONC. OR C.M.) SHALL BE INCLUDED IN THE COST FOR TRAFFIC CONTROL. THE PIPE SHALL REMAIN PROPERTY OF CONTRACTOR AFTER DETOUR REMOVAL.
- TEMPORARY BARRIER, TEMPORARY ATTENUATORS, AND/OR GUARDRAIL, WHEN REQUIRED, SHALL BE IN ACCORDANCE WITH STD. 4960 OR OTHER PLAN DETAILS.
- WHERE CONSTRUCTION BEGINS IN ADVANCE OF, OR EXTENDS PAST THE CROSSOVER THE DESIGNATED CHANNELIZATION DEVICES OR TEMPORARY BARRIER SHALL BE EXTENDED ACCORDINGLY WITH THE INITIAL W20-1 SIGNS AND G20-2 SIGNS LOCATED RELATIVE TO THE PROJECT LIMITS.
- SEE SEPARATE SHEET WHERE RUMBLE STRIPS ARE SPECIFIED.

FORMULA:

$L' = S \times W$  FOR SPEEDS OF 45 MPH, OR GREATER

$L' = \frac{WS^2}{60}$  FOR SPEEDS OF 40 MPH, OR LESS

WHERE: S = POSTED SPEED;  
W = WIDTH OF LANE SHIFT;  
AND L' = LENGTH OF TAPER.

MIN. LENGTH FOR LANE SHIFTS =  $\frac{1}{2}L'$   
MIN. LENGTH FOR SHLD. CLOSURE =  $\frac{1}{3}L'$   
DESIRABLE LENGTH FOR LANE SHIFT =  $L'$

3-30-06		DATE		DEPARTMENT OF TRANSPORTATION	
				STATE OF GEORGIA	
REMOVED FLAGS		REVISION		STANDARD	
				TRAFFIC CONTROL DETAILS	
				TYPICAL DETOUR ACROSS MEDIAN	
				NO SCALE	
				SEPT., 1996	
GLO	BY	DES. (SUBMITTED) <i>[Signature]</i>	STATE ROAD & AIRPORT DESIGN ENGINEER		NUMBER
		TRA. (APPROVED) <i>[Signature]</i>	CHIEF ENGINEER		9109