

STAGE 4:
 REMOVE CONFLICTING STAGE 3 TEMP STRIPING, PVMT MARKINGS & SIGNS.
 INSTALL STAGE 4 TEMP STRIPING, PVMT MARKINGS & SIGNS.
 SHIFT ALL KIA PKWY SIGNAL HEADS TO PERMANENT POSITIONS.
 SHIFT EB & WB TRAFFIC TO STAGE 4 LOCATIONS.
 INSTALL TRAFFIC CONTROL DEVICES PER MANUAL ON UNIFORM TRAFFIC CONTROL DEVICES, CURRENT EDITION, AND GDOT STDS.
 CONSTRUCT PROP RAISED CONCRETE MEDIAN & DRAINAGE.
 MAINTAIN ACCESS TO ALL DRIVEWAYS.

STAGE 5:
 MILL AND INLAY FINAL SURFACE COURSE (12.5MM).
 INSTALL PERMANENT SIGNING AND MARKING UNDER NIGHT TIME LANE CLOSURES.

WEST POINT DEV AUTH

INTERFACEFLOR LLC

INTERFACE FLOORING SYSTEM INC

ESA - SEE ENVIRONMENTAL RESOURCES IMPACT TABLE
GENERAL NOTES FOR CONSTRUCTION RESTRICTIONS

KIA WEST POINT LLC

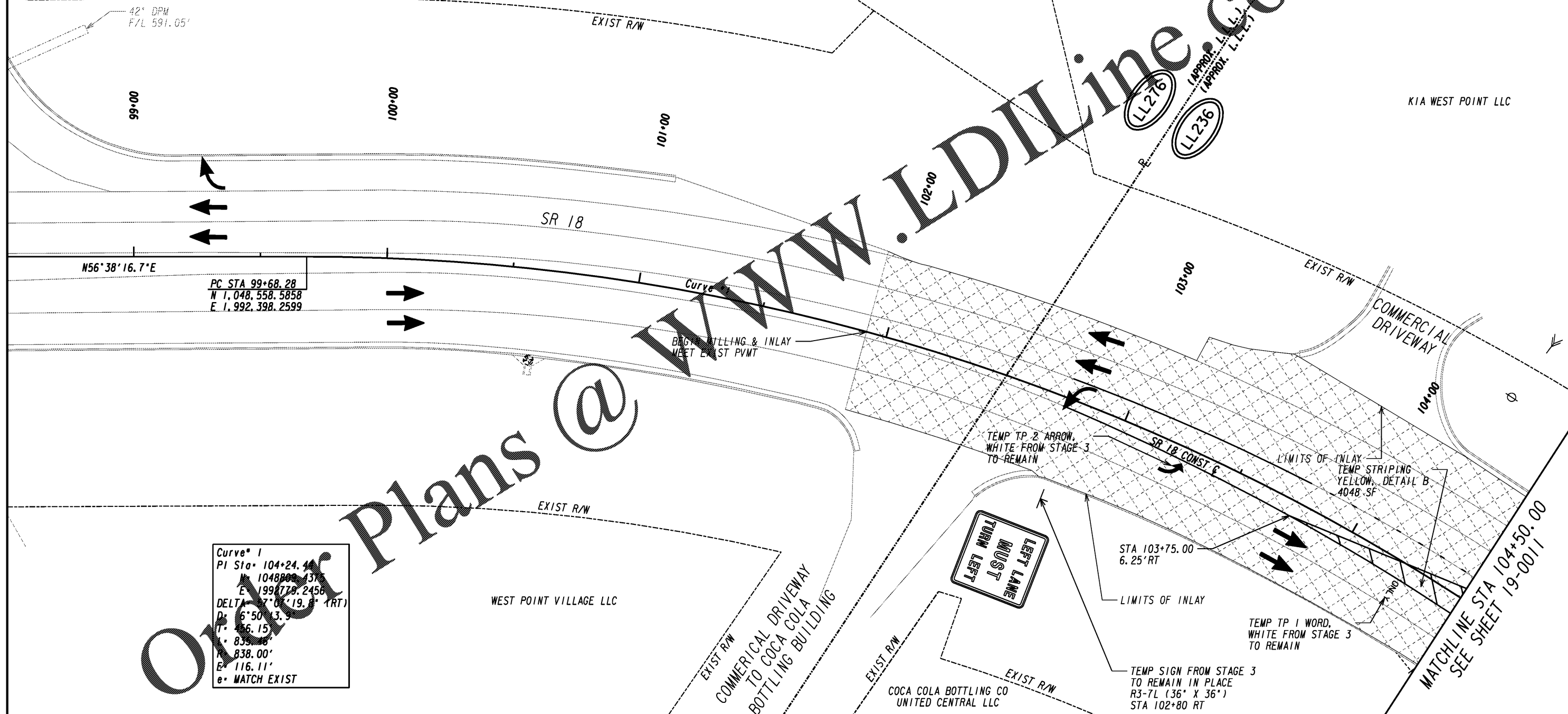

N56°38'16.7"E

PC STA 99+68.28
 N 1,048,558.5858
 E 1,992,398.2599

SR 18

Curve

BEGIN MILLING & INLAY
MEET EXIST PVMT

EXIST R/W

COMMERCIAL DRIVEWAY

EXIST R/W

WEST POINT VILLAGE LLC

COMMERCIAL DRIVEWAY
TO COCA COLA
BOTTLING BUILDING

COCA COLA BOTTLING CO
UNITED CENTRAL LLC

TEMP TP 2 ARROW,
WHITE FROM STAGE 3
TO REMAIN

STA 103+75.00
6.25' RT

LIMITS OF INLAY

TEMP TP 1 WORD,
WHITE FROM STAGE 3
TO REMAIN

TEMP SIGN FROM STAGE 3
TO REMAIN IN PLACE
R3-7L (36" X 36")
STA 102+80 RT

LIMITS OF INLAY
TEMP STRIPING
YELLOW, DETAIL B
4048 SF

MATCHLINE STA 104+50.00
SEE SHEET 19-0011

Plans @

Curve 1
 PI Sta 104+24.41
 N 1048800.1316
 E 1998778.2456
 DELTA 7°07'19.8" (RT)
 D: 6°50'13.9"
 I: 86.15'
 R: 839.88'
 E: 838.00'
 E: 116.11'
 e: MATCH EXIST

PAVEMENT REMOVAL



TEMPORARY CONSTRUCTION PAVEMENT

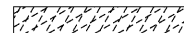

PERMANENT CONSTRUCTION



CONCRETE MEDIAN CONSTRUCTION



MILL & INLAY CONSTRUCTION

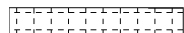

OPEN LANES OF TRAFFIC



INFRASTRUCTURE
CONSULTING & ENGINEERING

4940 PEACHTREE INDUSTRIAL BLVD., SUITE 310
NORCROSS, GEORGIA 30071

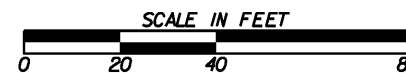

REVISION DATES

CONSTRUCTION STAGING PLAN
SR 18 BRIDGE REPLACEMENT @ LONG CREEK
TROUP COUNTY
STAGES 4/5 STA 101+92 TO STA 104+50

CHECKED:	DATE:	DRAWING No.
BACKCHECKED:	DATE:	19-0010
CORRECTED:	DATE:	
VERIFIED:	DATE:	