

ESA - SEE ENVIRONMENTAL RESOURCES IMPACT TABLE IN GENERAL NOTES FOR CONSTRUCTION RESTRICTIONS

END REQ'D R/W  
BEGIN REQ'D R/W & L/A  
STA 114+00.00, 113.40'LT  
END TEMP CONC BARRIER  
PORTABLE IMPACT ATTENUATOR TYP B  
STA 115+65.00, 24.23'LT

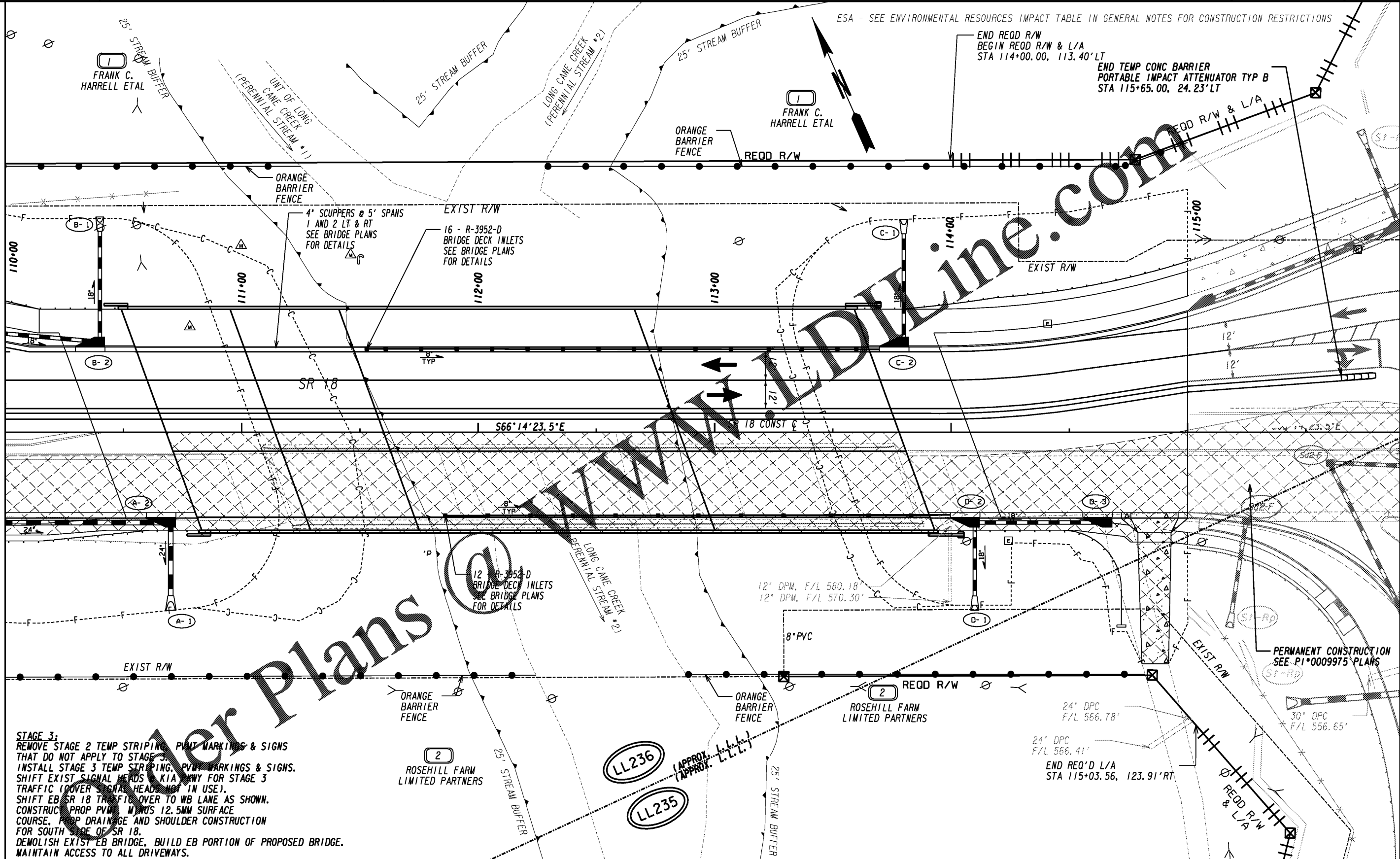

MATCHLINE STA 110+00.00  
SEE SHEET 19-0008

**STAGE 3:**  
 REMOVE STAGE 2 TEMP STRIPING, PAINT MARKINGS & SIGNS THAT DO NOT APPLY TO STAGE 3.  
 INSTALL STAGE 3 TEMP STRIPING, PAINT MARKINGS & SIGNS. SHIFT EXIST SIGNAL HEADS, KIA HWY FOR STAGE 3 TRAFFIC (COVER SIGNAL HEADS NOT IN USE).  
 SHIFT EB SR 18 TRAFFIC OVER TO WB LANE AS SHOWN. CONSTRUCT PROP PVM, MWD'S 12.5MM SURFACE COURSE, PROP DRAINAGE AND SHOULDER CONSTRUCTION FOR SOUTH SIDE OF SR 18.  
 DEMOLISH EXIST EB BRIDGE, BUILD EB PORTION OF PROPOSED BRIDGE. MAINTAIN ACCESS TO ALL DRIVEWAYS.

PAVEMENT REMOVAL	
TEMPORARY CONSTRUCTION PAVEMENT	
PERMANENT CONSTRUCTION	

CONCRETE MEDIAN CONSTRUCTION	
MILL & INLAY CONSTRUCTION	
OPEN LANES OF TRAFFIC	

**INFRASTRUCTURE**  
 CONSULTING & ENGINEERING  
 4940 PEACHTREE INDUSTRIAL BLVD., SUITE 310  
 NORCROSS, GEORGIA 30071



REVISION DATES	

<b>CONSTRUCTION STAGING PLAN</b>		
<b>SR 18 BRIDGE REPLACEMENT @ LONG CANE CREEK</b>		
<b>TROUP COUNTY</b>		
<b>STAGE 3 STA 110+00 TO STA 115+00</b>		
CHECKED:	DATE:	DRAWING No.
BACKCHECKED:	DATE:	19-0009
CORRECTED:	DATE:	
VERIFIED:	DATE:	