

**STAGE 3:**  
 REMOVE STAGE 2 TEMP STRIPING, PVMT MARKINGS & SIGNS THAT DO NOT APPLY TO STAGE 3.  
 INSTALL STAGE 3 TEMP STRIPING, PVMT MARKINGS & SIGNS. SHIFT EXIST SIGNAL HEADS @ KIA PKWY FOR STAGE 3 TRAFFIC (COVER SIGNAL HEADS NOT IN USE).  
 SHIFT EB SR 18 TRAFFIC OVER TO WB LANE AS SHOWN. CONSTRUCT PROP PVMT, MINUS 12.5MM SURFACE COURSE, PROP DRAINAGE AND SHOULDER CONSTRUCTION FOR SOUTH SIDE OF SR 18.  
 MAINTAIN ACCESS TO ALL DRIVEWAYS.

ESA - SEE ENVIRONMENTAL RESOURCES IMPACT TABLE  
 GENERAL NOTES FOR CONSTRUCTION RESTRICTIONS

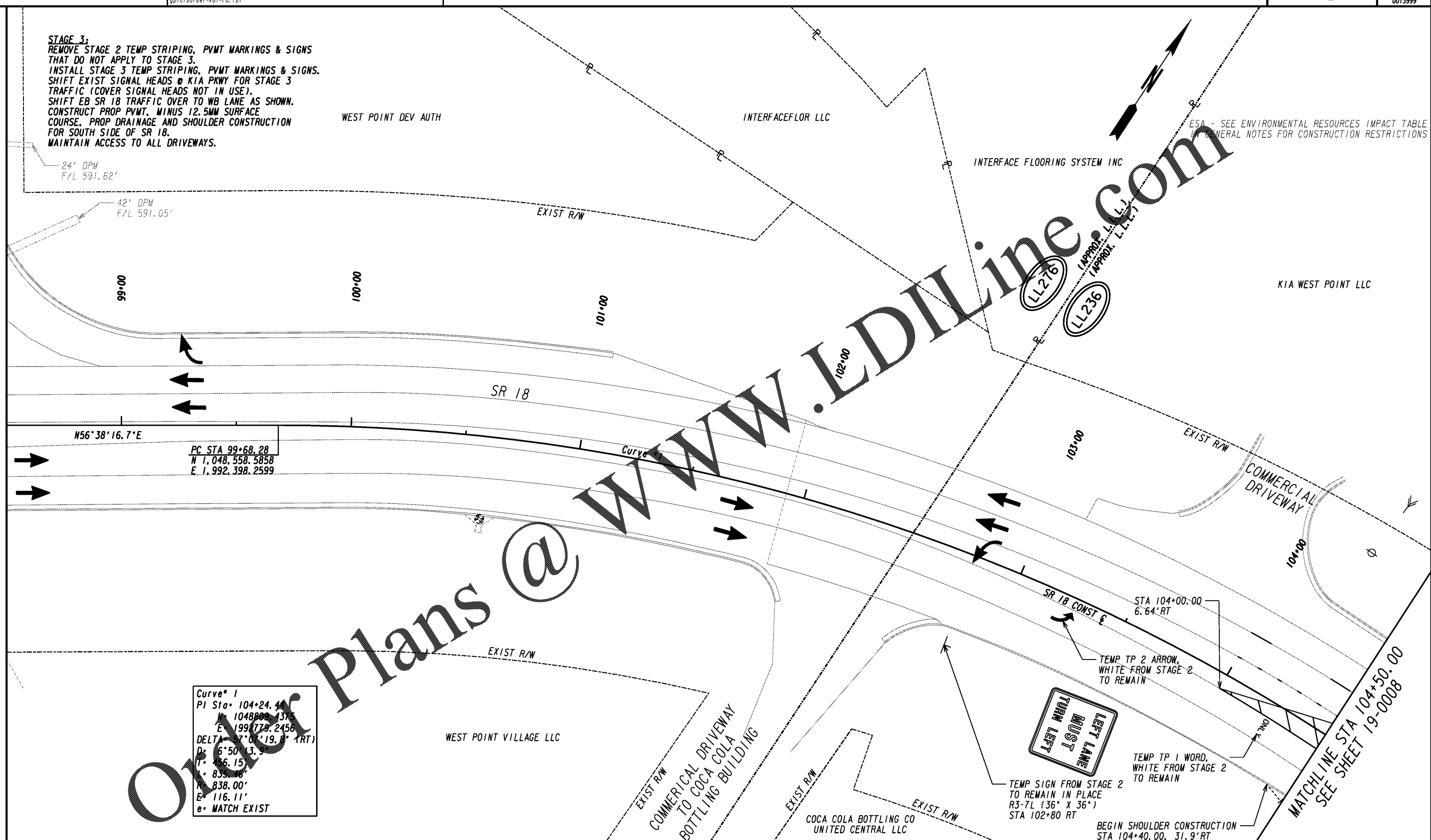

24" DPM  
 F/L 591.62'

42" DPM  
 F/L 591.05'

N56°38'16.7"E

PC STA 99+68.28  
 N 1,048,558.5858  
 E 1,992,398.2599

**Curve 1**  
 PI Sta 104+24.43  
 N 1048800.137  
 E 1998778.2456  
 DELTA 7°07'19.8" (RT)  
 D: 6°50'13.9"  
 L: 856.15'  
 R: 838.00'  
 E: 116.11'  
 e: MATCH EXIST

PAVEMENT REMOVAL

TEMPORARY CONSTRUCTION PAVEMENT

PERMANENT CONSTRUCTION

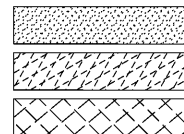

CONCRETE MEDIAN CONSTRUCTION

MILL & INLAY CONSTRUCTION

OPEN LANES OF TRAFFIC

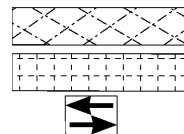

**INFRASTRUCTURE**  
 CONSULTING & ENGINEERING

4940 PEACHTREE INDUSTRIAL BLVD., SUITE 310  
 NORCROSS, GEORGIA 30071

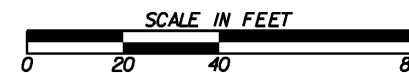

REVISION DATES

**CONSTRUCTION STAGING PLAN**  
**SR 18 BRIDGE REPLACEMENT @ LONG CREEK**  
**TROUP COUNTY**  
**STAGE 3 STA 101+92 TO STA 104+50**

CHECKED:	DATE:	DRAWING No.
BACKCHECKED:	DATE:	19-0007
CORRECTED:	DATE:	
VERIFIED:	DATE:	