

ESA - SEE ENVIRONMENTAL RESOURCES IMPACT TABLE IN GENERAL NOTES FOR CONSTRUCTION RESTRICTIONS

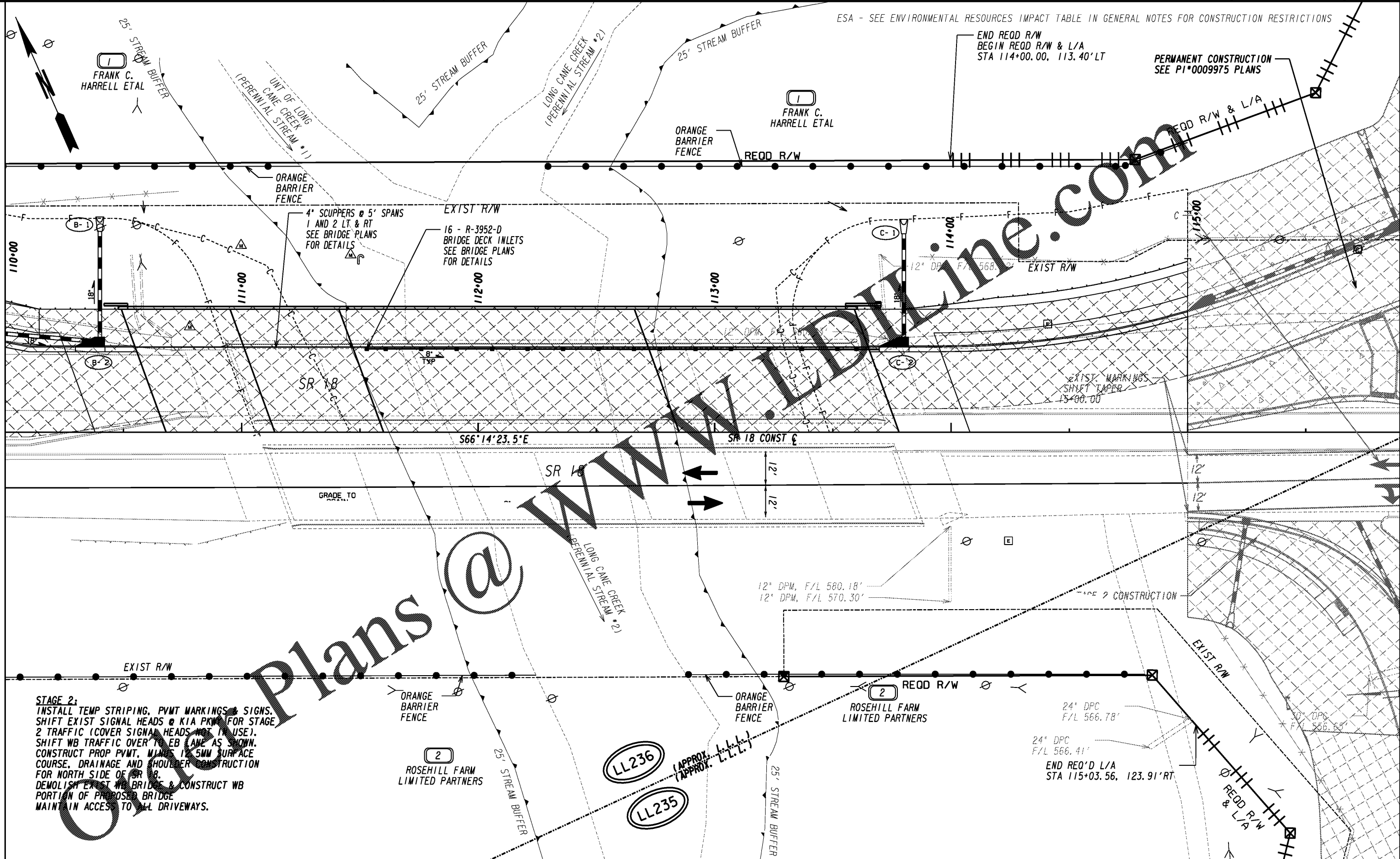

MATCHLINE STA 110+00.00
SEE SHEET 19-0005

STAGE 2:
 INSTALL TEMP STRIPING, PVMT MARKINGS & SIGNS.
 SHIFT EXIST SIGNAL HEADS @ KIA PKWY FOR STAGE
 2 TRAFFIC (COVER SIGNAL HEADS NOT IN USE).
 SHIFT WB TRAFFIC OVER THE EB LANE AS SHOWN.
 CONSTRUCT PROP PVMT, MAINS 1/2" SMM SURFACE
 COURSE, DRAINAGE AND SHOULDER CONSTRUCTION
 FOR NORTH SIDE OF SR 18.
 DEMOLISH EXIST WB BRIDGE & CONSTRUCT WB
 PORTION OF PROPOSED BRIDGE.
 MAINTAIN ACCESS TO ALL DRIVEWAYS.

PAVEMENT REMOVAL	
TEMPORARY CONSTRUCTION PAVEMENT	
PERMANENT CONSTRUCTION	

CONCRETE MEDIAN CONSTRUCTION	
MILL & INLAY CONSTRUCTION	
OPEN LANES OF TRAFFIC	

INFRASTRUCTURE
 CONSULTING & ENGINEERING
 4940 PEACHTREE INDUSTRIAL BLVD., SUITE 310
 NORCROSS, GEORGIA 30071

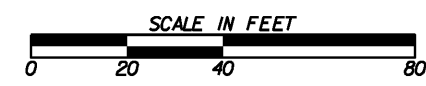

REVISION DATES	

CONSTRUCTION STAGING PLAN		
SR 18 BRIDGE REPLACEMENT @ LONG CANE CREEK		
TROUP COUNTY		
STAGE 2 STA 110+00 TO STA 115+00		
CHECKED:	DATE:	DRAWING No.
BACKCHECKED:	DATE:	19-0006
CORRECTED:	DATE:	
VERIFIED:	DATE:	