

31+00  
3A  
ROSE ROCK HOLDINGS LLC  
SEE SHEET 17  
32+00

33+00

34+00

35+00

3  
FRANK C. HARRELL ETAL  
SEE SHEET 17

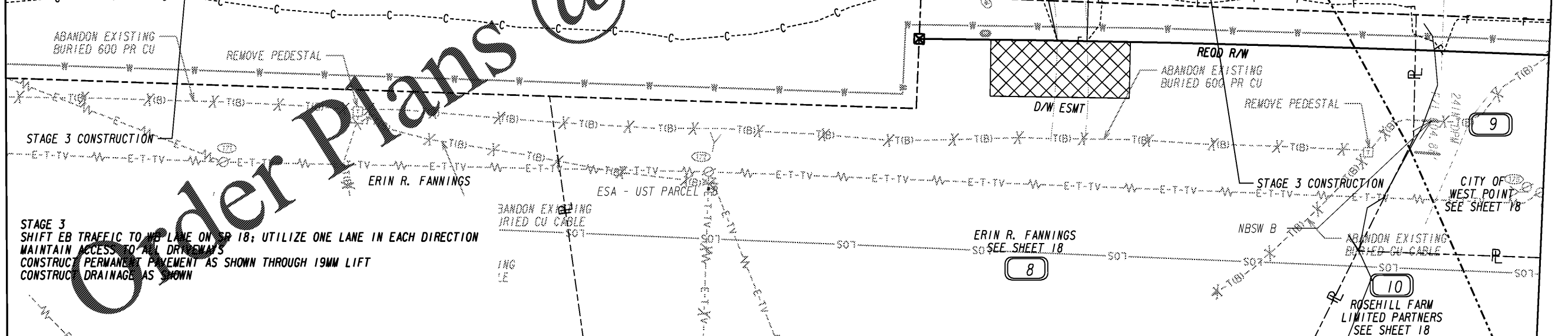
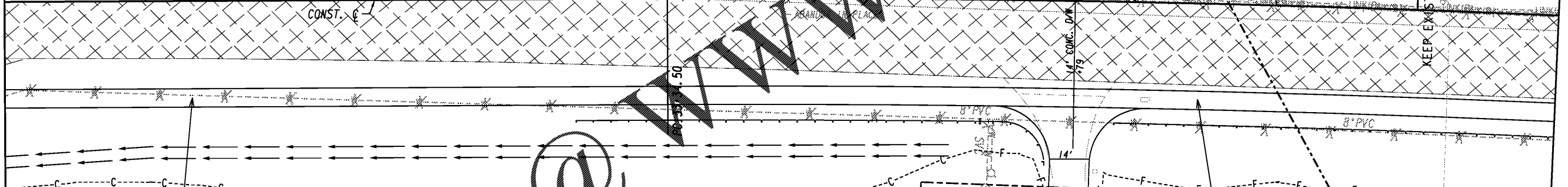
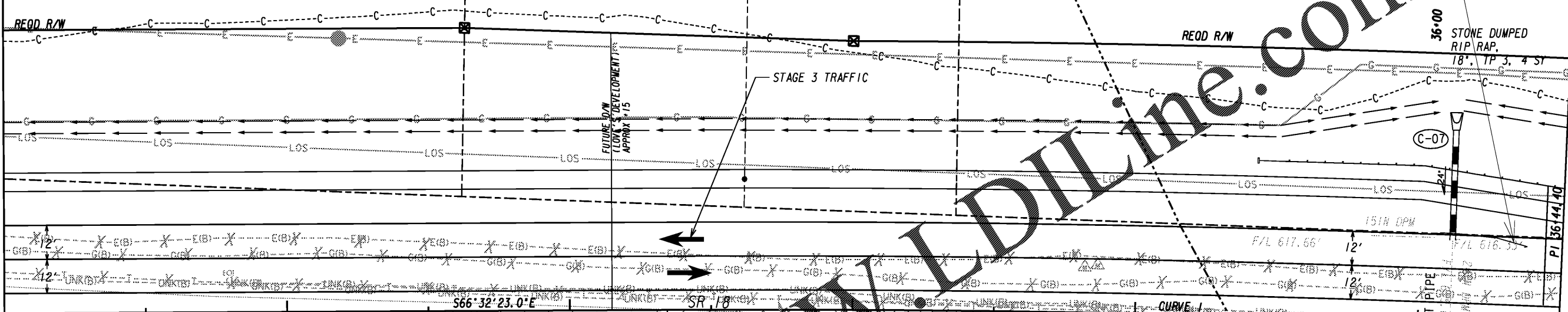
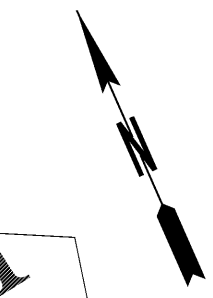

STAGE 3  
SHIFT EB TRAFFIC TO WB LANE ON SR 18; UTILIZE ONE LANE IN EACH DIRECTION  
MAINTAIN ACCESS TO ALL DRIVEWAYS  
CONSTRUCT PERMANENT PAVEMENT AS SHOWN THROUGH 19MM LIFT  
CONSTRUCT DRAINAGE AS SHOWN

LEGEND

|                                 |  |
|---------------------------------|--|
| PAVEMENT REMOVAL                |  |
| TEMPORARY CONSTRUCTION PAVEMENT |  |
| PERMANENT CONSTRUCTION          |  |
| CONCRETE MEDIAN CONSTRUCTION    |  |
| MILL & OVERLAY CONSTRUCTION     |  |
| OPEN LANES OF TRAFFIC           |  |

**Kimley»Horn**

Engineering, Planning, and Environmental Consultants  
Suite 350, 3930 East Jones Bridge Road  
Peachtree Corners, Georgia 30092

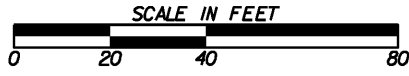

REVISION DATES

**CONSTRUCTION STAGING PLAN**  
**I-85 @ SR 18 & SR 18 @ SR 103**  
**STAGE 3**

|              |       |             |
|--------------|-------|-------------|
| CHECKED:     | DATE: | DRAWING No. |
| BACKCHECKED: | DATE: | 19-0092     |
| CORRECTED:   | DATE: |             |
| VERIFIED:    | DATE: |             |

DRAWING No. 19-0091

MATCH LINE STA. 31+00

DRAWING No. 19-0093

MATCH LINE STA. 36+50