

Order Plans @ WWW.DIline.com

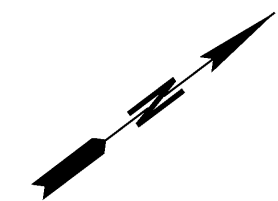

DRAWING No. 19-0057
MATCH LINE STA. 601+50

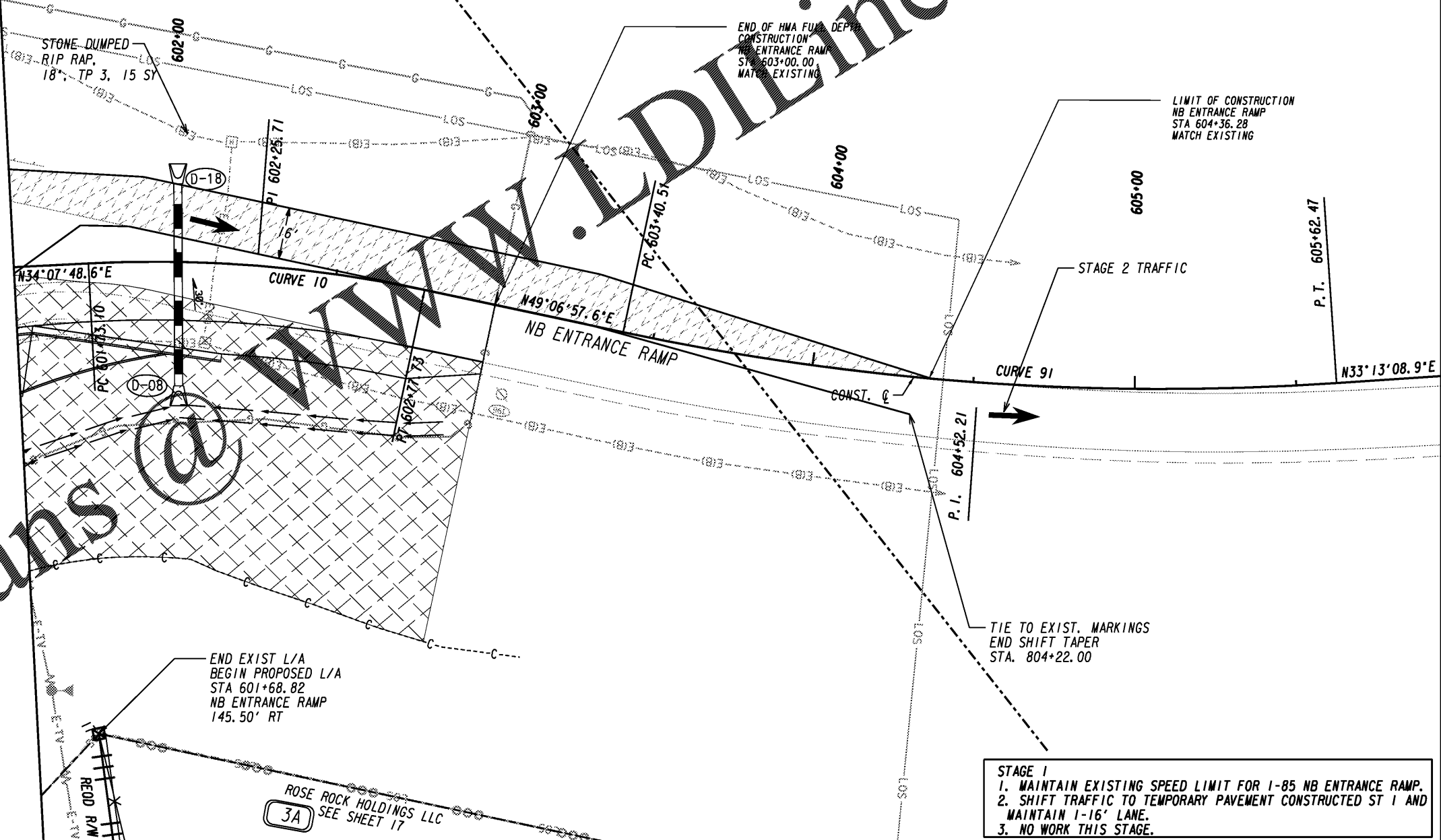

STAGE 1

1. MAINTAIN EXISTING SPEED LIMIT FOR I-85 NB ENTRANCE RAMP.
2. SHIFT TRAFFIC TO TEMPORARY PAVEMENT CONSTRUCTED ST 1 AND MAINTAIN 1-16' LANE.
3. NO WORK THIS STAGE.

LEGEND

PAVEMENT REMOVAL	
TEMPORARY CONSTRUCTION PAVEMENT	
PERMANENT CONSTRUCTION	
CONCRETE MEDIAN CONSTRUCTION	
MILL & OVERLAY CONSTRUCTION	
OPEN LANES OF TRAFFIC	

Kimley»Horn
 Engineering, Planning, and Environmental Consultants
 Suite 350, 3930 East Jones Bridge Road
 Peachtree Corners, Georgia 30092

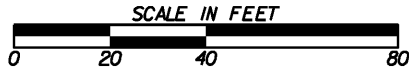

REVISION DATES	

CONSTRUCTION STAGING PLAN		
I-85 @ SR 18 & SR 18 @ SR 103		
STAGE 2		
CHECKED:	DATE:	DRAWING No.
BACKCHECKED:	DATE:	19-0058
CORRECTED:	DATE:	
VERIFIED:	DATE:	