

ESA - PERENNIAL STREAM PS
SEE GENERAL NOTES 'ENVIRONMENTAL
RESOURCES' IMPACT TABLE
FOR CONSTRUCTION RESTRICTIONS

FRANK C. HARRELL ETAL
SEE SHEET 17

END PROPOSED L/A
BEGIN EXIST L/A
STA 406+50.00
SB EXIT RAMP

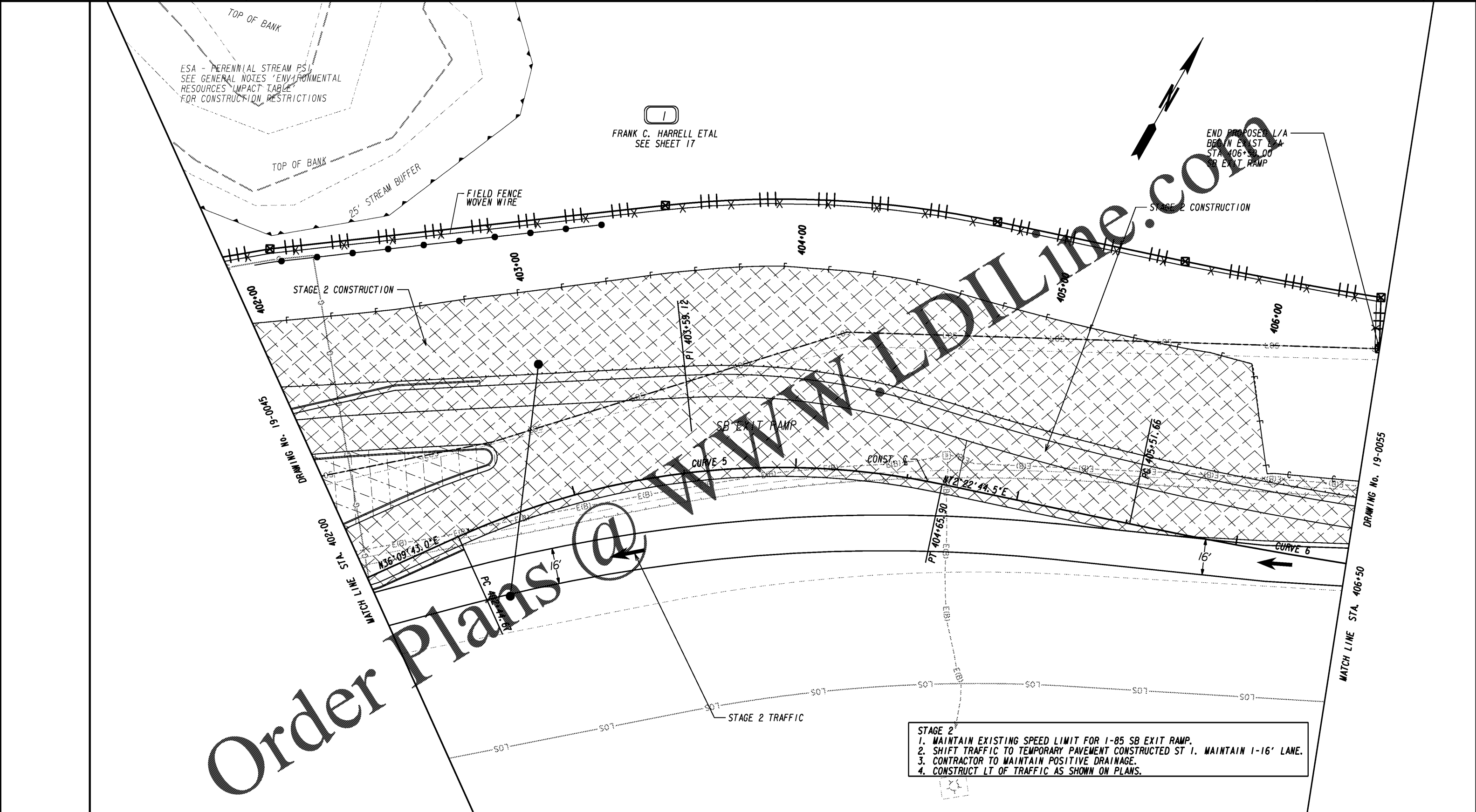

Order Plans @ WWW.LDILine.com

STAGE 2

1. MAINTAIN EXISTING SPEED LIMIT FOR I-85 SB EXIT RAMP.
2. SHIFT TRAFFIC TO TEMPORARY PAVEMENT CONSTRUCTED ST 1. MAINTAIN I-16' LANE.
3. CONTRACTOR TO MAINTAIN POSITIVE DRAINAGE.
4. CONSTRUCT LT OF TRAFFIC AS SHOWN ON PLANS.

LEGEND

PAVEMENT REMOVAL	
TEMPORARY CONSTRUCTION PAVEMENT	
PERMANENT CONSTRUCTION	
CONCRETE MEDIAN CONSTRUCTION	
MILL & OVERLAY CONSTRUCTION	
OPEN LANES OF TRAFFIC	

Kimley»Horn
 Engineering, Planning, and Environmental Consultants
 Suite 350, 3930 East Jones Bridge Road
 Peachtree Corners, Georgia 30092

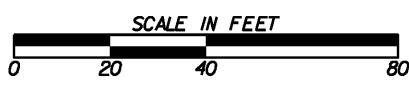

REVISION DATES	

CONSTRUCTION STAGING PLAN
I-85 @ SR 18 & SR 18 @ SR 103
STAGE 2

CHECKED:	DATE:	DRAWING No.
BACKCHECKED:	DATE:	19-0054
CORRECTED:	DATE:	
VERIFIED:	DATE:	