

Order Plans @ WWW.LDILine.com

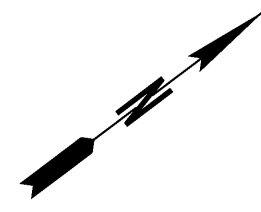

DRAWING No. 19-0002

MATCH LINE STA. 601+50

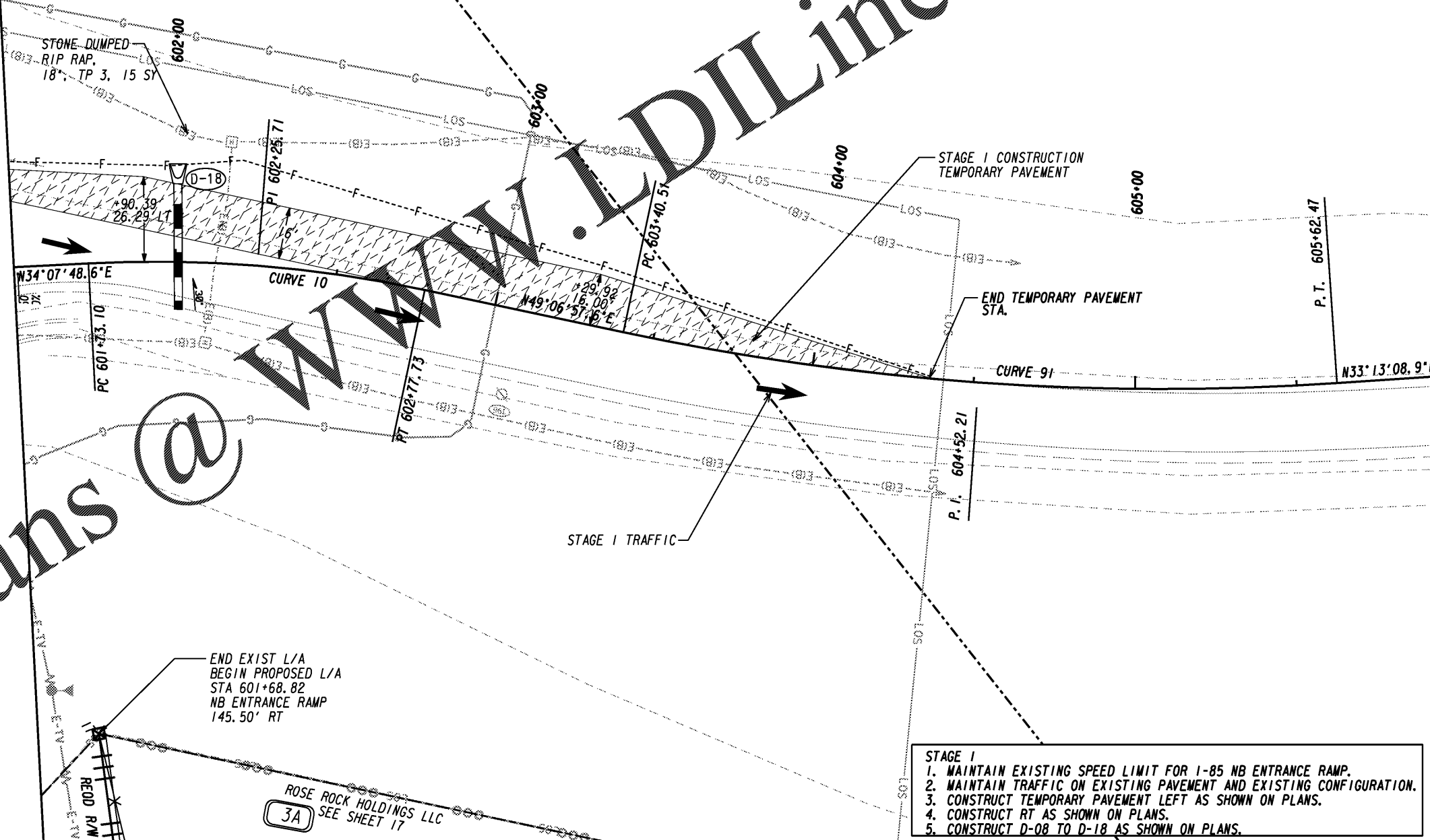

- STAGE I**
1. MAINTAIN EXISTING SPEED LIMIT FOR I-85 NB ENTRANCE RAMP.
 2. MAINTAIN TRAFFIC ON EXISTING PAVEMENT AND EXISTING CONFIGURATION.
 3. CONSTRUCT TEMPORARY PAVEMENT LEFT AS SHOWN ON PLANS.
 4. CONSTRUCT RT AS SHOWN ON PLANS.
 5. CONSTRUCT D-08 TO D-18 AS SHOWN ON PLANS.

END EXIST L/A
BEGIN PROPOSED L/A
STA 601+68.82
NB ENTRANCE RAMP
145.50' RT

ROSE ROCK HOLDINGS LLC
3A SEE SHEET 17

LEGEND

PAVEMENT REMOVAL	
TEMPORARY CONSTRUCTION PAVEMENT	
PERMANENT CONSTRUCTION	
CONCRETE MEDIAN CONSTRUCTION	
MILL & OVERLAY CONSTRUCTION	
OPEN LANES OF TRAFFIC	

Kimley»Horn
 Engineering, Planning, and Environmental Consultants
 Suite 350, 3930 East Jones Bridge Road
 Peachtree Corners, Georgia 30092

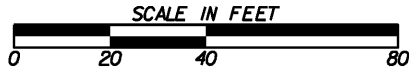

REVISION DATES	

CONSTRUCTION STAGING PLAN		
I-85 @ SR 18 & SR 18 @ SR 103		
STAGE I		
CHECKED:	DATE:	DRAWING No.
BACKCHECKED:	DATE:	19-0014
CORRECTED:	DATE:	
VERIFIED:	DATE:	