

ESA - PERENNIAL STREAM PSII
SEE GENERAL NOTES 'ENVIRONMENTAL
RESOURCES IMPACT TABLE'
FOR CONSTRUCTION RESTRICTIONS

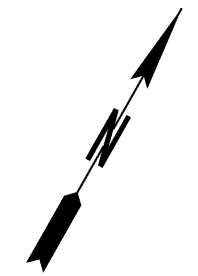
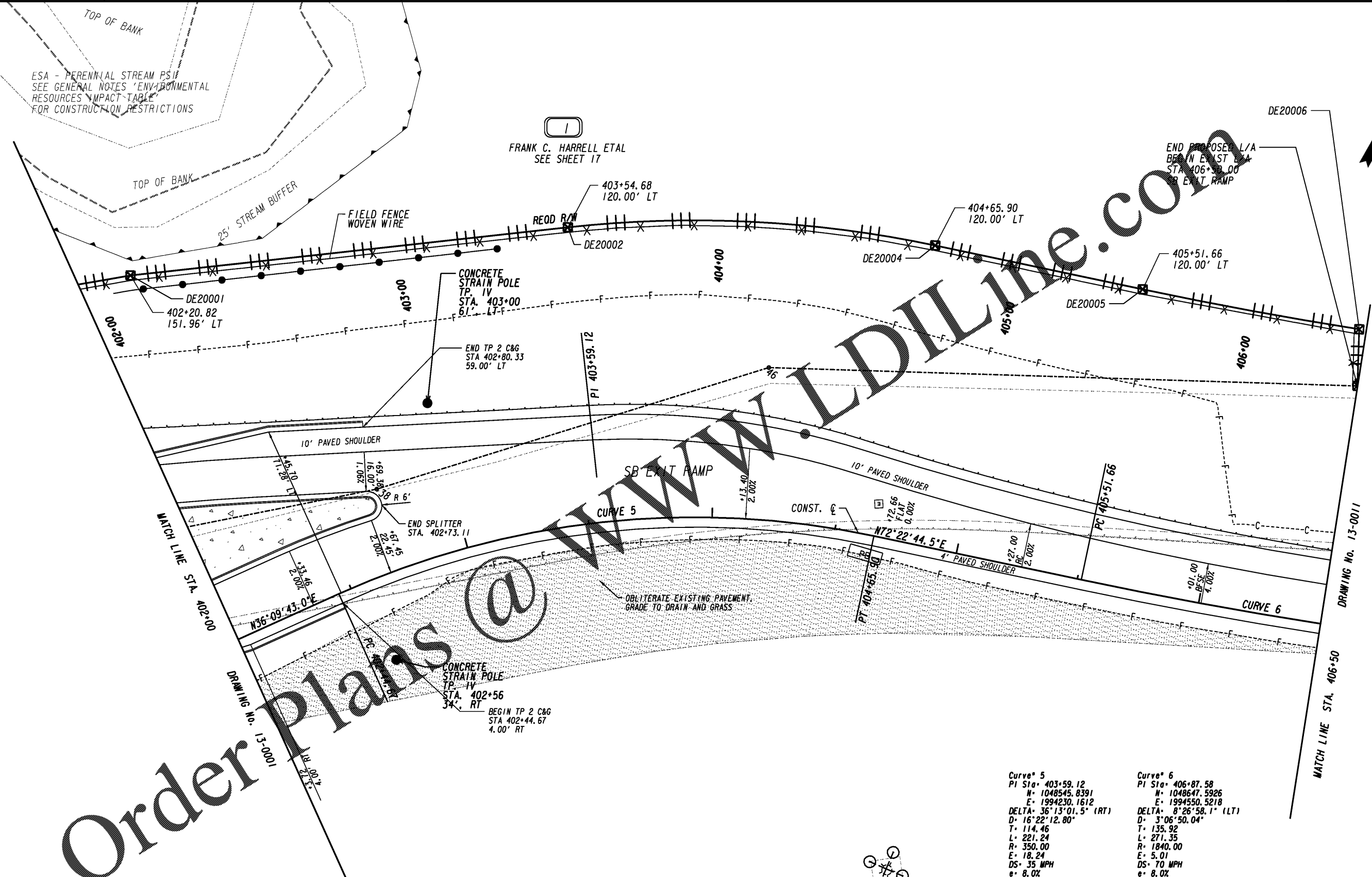

Order Plans @ www.LDILine.com

Curve 5 PI Sta. 403+59.12 N= 1048545.8391 E= 1994230.1612 DELTA= 36°13'01.5" (RT) D= 16°22'12.80" T= 114.46 L= 221.24 R= 350.00 E= 18.24 DS= 35 MPH e= 8.0%	Curve 6 PI Sta. 406+87.58 N= 1048647.5926 E= 1994550.5218 DELTA= 8°26'58.1" (LT) D= 3°06'50.04" T= 135.92 L= 271.35 R= 1840.00 E= 5.01 DS= 70 MPH e= 8.0%
---	---

NOTE: SEE SERIES 11 SHEETS FOR SPLITTER ISLAND AND TRUCK APRON CONSTRUCTION ALIGNMENTS

PROPERTY AND EXISTING R/W LINE	-----e-----
REQUIRED R/W LINE	-----f-----
CONSTRUCTION LIMITS	-----c-----
EASEMENT FOR CONSTR & MAINTENANCE OF SLOPES	-----f-----
EASEMENT FOR CONSTR OF SLOPES	-----f-----
EASEMENT FOR CONSTR OF DRIVES	-----f-----

BEGIN LIMIT OF ACCESS.....BLA	-----o-----
END LIMIT OF ACCESS.....ELA	-----o-----
LIMIT OF ACCESS	-----o-----
REQ'D R/W & LIMIT OF ACCESS	-----o-----
ORANGE BARRIER FENCE	-----o-----
ESA - ENV. SENSITIVE AREA (SEE ERIT TABLE)	-----o-----

Kimley»Horn
Engineering, Planning, and Environmental Consultants
Suite 350, 3930 East Jones Bridge Road
Peachtree Corners, Georgia 30092

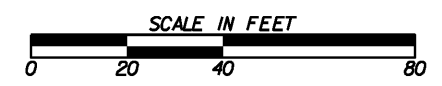

REVISION DATES	

CONSTRUCTION PLAN
1-85 @ SR 18 & SR 18 @ SR 103
1-85 SB EXIT RAMP
STA 402+00 TO 406+50

CHECKED:	DATE:	DRAWING No.
BACKCHECKED:	DATE:	13-0010
CORRECTED:	DATE:	
VERIFIED:	DATE:	