

# DEPARTMENT OF TRANSPORTATION STATE OF GEORGIA

## PLAN AND PROFILE OF PROPOSED I-85 AT SR 18 AND SR 18 AT SR 103

### FEDERAL AID PROJECT TROUP COUNTY

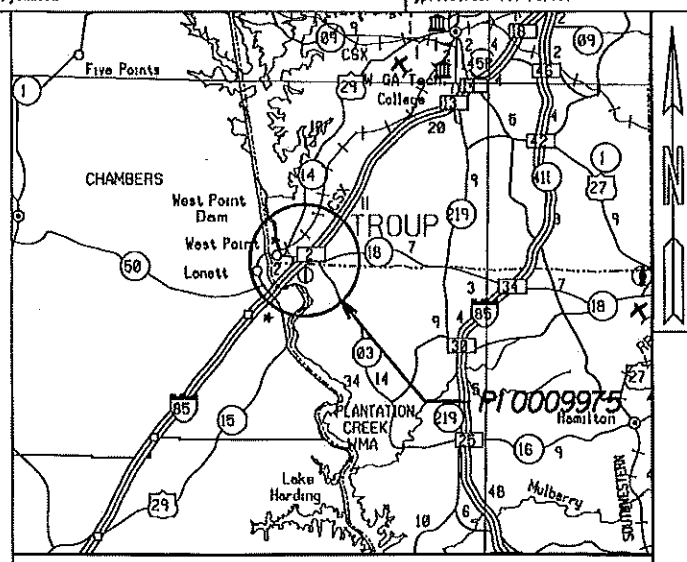

LOCATION SKETCH

DESIGN DATA:	SR 18	SR 103
2022 A.D.T.:	23,955	11,265
2042 A.D.T.:	32,505	15,415
TRAFFIC D.H.V.:	1,550	1,070
DIRECTIONAL DIST.:	50%	50%
% TRUCKS:	9%	19.5%
24 HR. TRUCKS %:	17.0%	19.5%
SPEED DESIGN:	45 MPH	45 MPH

LOCATION & DESIGN  
APPROVAL DATE: 6/5/18

FUNCTIONAL CLASS:  
SR 18 - URBAN MINOR ARTERIAL  
SR 103 - URBAN MINOR ARTERIAL

THIS PROJECT IS 100% IN  
TROUP COUNTY AND IS 100%  
IN CONG. DIST. NO. 3.

PROJECT DESIGNATION: EXEMPT

THIS PROJECT HAS BEEN PREPARED  
USING THE HORIZONTAL GEORGIA  
COORDINATE SYSTEM OF 1984 (NAD  
1983/94 WEST ZONE), AND THE NORTH  
AMERICAN VERTICAL DATUM (NVD)  
OF 1988.

THE DATA, TOGETHER WITH ALL OTHER INFORMATION SHOWN ON THESE PLANS OR IN ANYWAY  
INDICATED THEREBY, WHETHER BY DRAWINGS OR NOTES, OR IN ANY OTHER MANNER, ARE BASED UPON  
FIELD INVESTIGATIONS AND ARE BELIEVED TO BE INDICATIVE OF ACTUAL CONDITIONS, HOWEVER, THE  
SAME ARE SHOWN AS INFORMATION ONLY, ARE NOT GUARANTEED, AND DO NOT BIND THE DEPARTMENT  
OF TRANSPORTATION IN ANY WAY. THE ATTENTION OF BIDDER IS SPECIFICALLY DIRECTED TO  
SUBSECTIONS 102.04, 102.05, AND 104.03 OF THE SPECIFICATIONS.

FEDERAL ROUTE • I-85  
STATE ROUTE • 18 & 103  
P.I. NO. 0009975

NOTE:  
ALL REFERENCES IN THIS DOCUMENT, WHICH INCLUDES ALL PAPERS, WRITINGS,  
DOCUMENTS, DRAWINGS, OR PHOTOGRAPHS USED, OR TO BE USED IN CONNECTION  
WITH THIS DOCUMENT, TO "STATE HIGHWAY DEPARTMENT OF GEORGIA", "STATE  
HIGHWAY DEPARTMENT", "GEORGIA STATE HIGHWAY DEPARTMENT", "HIGHWAY  
DEPARTMENT", OR "DEPARTMENT" WHEN THE CONTEXT THEREOF MEANS THE  
STATE HIGHWAY DEPARTMENT OF GEORGIA, AND SHALL BE DEEMED TO MEAN  
THE DEPARTMENT OF TRANSPORTATION.



PLANS PREPARED BY: KIMLEY-HORN and Associates, Inc.  
DESIGN

RECOMMENDED FOR APPROVAL BY: Kimberly W. Nesbitt  
STATE PROGRAM DELIVERY ADMINISTRATOR

DATE: 12/15/2020  
CHIEF ENGINEER: Margaret B. Purcell

PLANS COMPLETED	12-09-2020
REVISIONS	

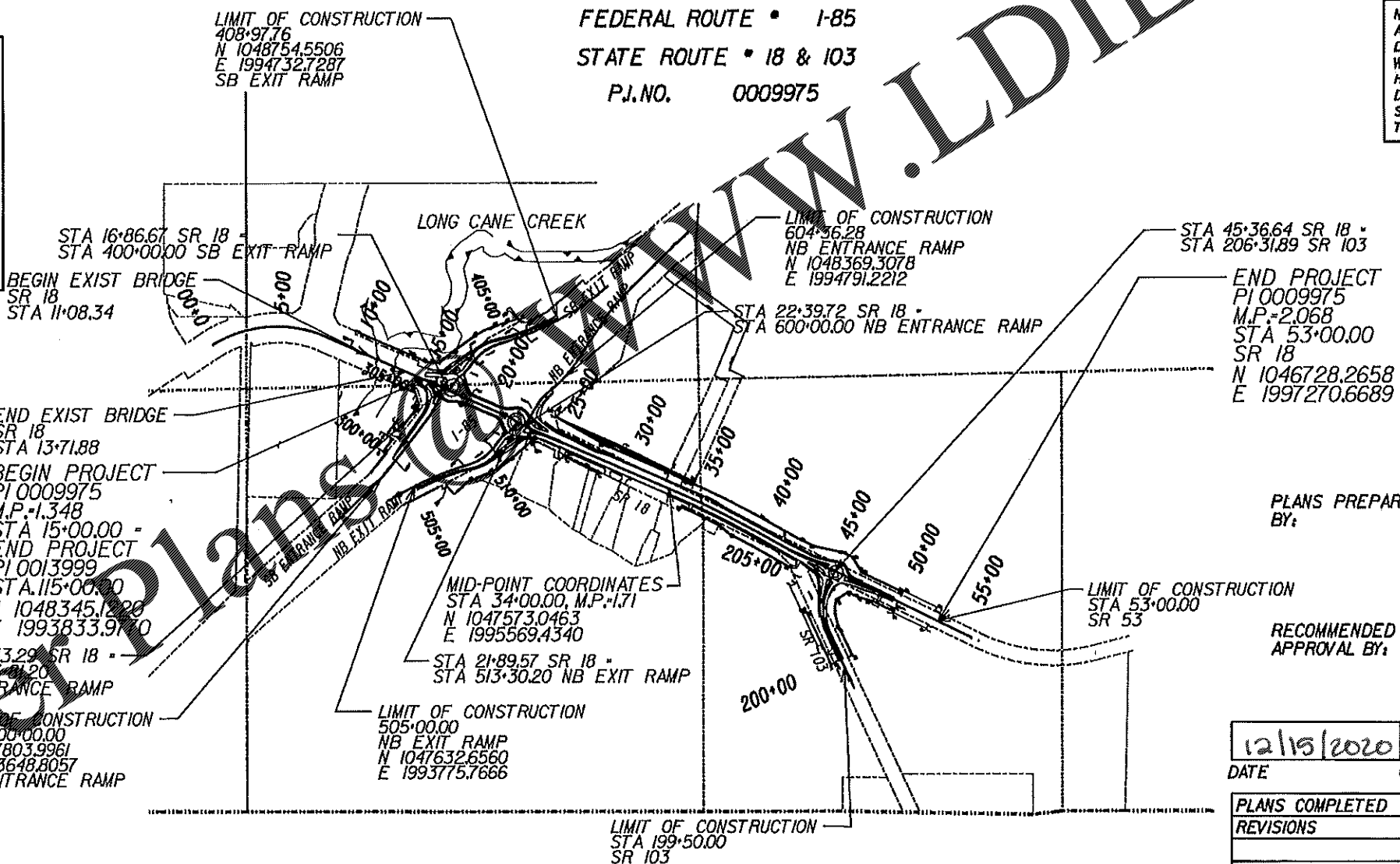

LENGTH OF PROJECT	TROUP COUNTY COUNTY No. 265 Project No. 0009975
	MILES
NET LENGTH OF ROADWAY	0.720
NET LENGTH OF BRIDGES	0.00
NET LENGTH OF PROJECT	0.720
NET LENGTH OF EXCEPTIONS	
GROSS LENGTH OF PROJECT	0.720

**Kimley»Horn**  
Engineering, Planning, and Environmental Consultants  
Suite 350, 3930 East Jones Bridge Road  
Peachtree Corners, Georgia 30092

