

KEYNOTES

- PROVIDE POLE-MOUNTED NEMA 3R COMMUNICATIONS ENCLOSURE 10'-0" AFG. PROVIDE ENCLOSURE WITH THE FOLLOWING:
 - 12-STRAND FIBER OPTIC PATCH PANEL WITH SIX DUPLEX LC ADAPTERS;
 - MEDIA CONVERTER WITH EIGHT CAT6 POE OUTPUT PORTS;
 - ONE 120V, 20A SIMPLEX RECEPTACLE OUTLET.
- PROVIDE 120V, 20A GFCI-TYPE DUPLEX RECEPTACLE OUTLET WITH WEATHERPROOF-WHILE-IN-USE ENCLOSURE 10'-0" AFG.
- MODIFY EXISTING FEEDER AS NEEDED TO RESTORE CONNECTIONS TO RELOCATED PANELBOARD AS THEY EXISTED PRIOR TO DEMOLITION. PROVIDE NEW BRANCH CIRCUITS AS FOLLOWS:
 - ONE 240V, 20A CIRCUIT TO TYPE 'P' LIGHTS INDICATED ON THIS SHEET; USE 1" CONDUIT WITH (2) #8 & (1) #8 G.
 - ONE 120V, 20A CIRCUIT TO SIMPLEX RECEPTACLES INDICATED FOR INSTALLATION IN POLE-MOUNTED COMMUNICATIONS ENCLOSURES; USE 1" CONDUIT WITH (2) #12 & (1) #12 G.
 - ONE 120V, 20A CIRCUIT TO POLE-MOUNTED GFCI RECEPTACLES INDICATED ON THIS SHEET.
 - ONE 120V, 20A CIRCUIT TO RAINBIRD IRRIGATION CONTROLLER. USE 1" CONDUIT WITH (2) #10 & (1) #10 G.
- PROVIDE POLE-MOUNTED NEMA 3R JUNCTION BOX 10'-0" AFG FOR CAT6 CABLE CONNECTION TO CCTV CAMERA.

GENERAL SHEET NOTES

- SEE SHEET E-001 FOR ELECTRICAL GENERAL NOTES.
- SEE SHEET E-002 FOR ABBREVIATIONS AND LEGEND.

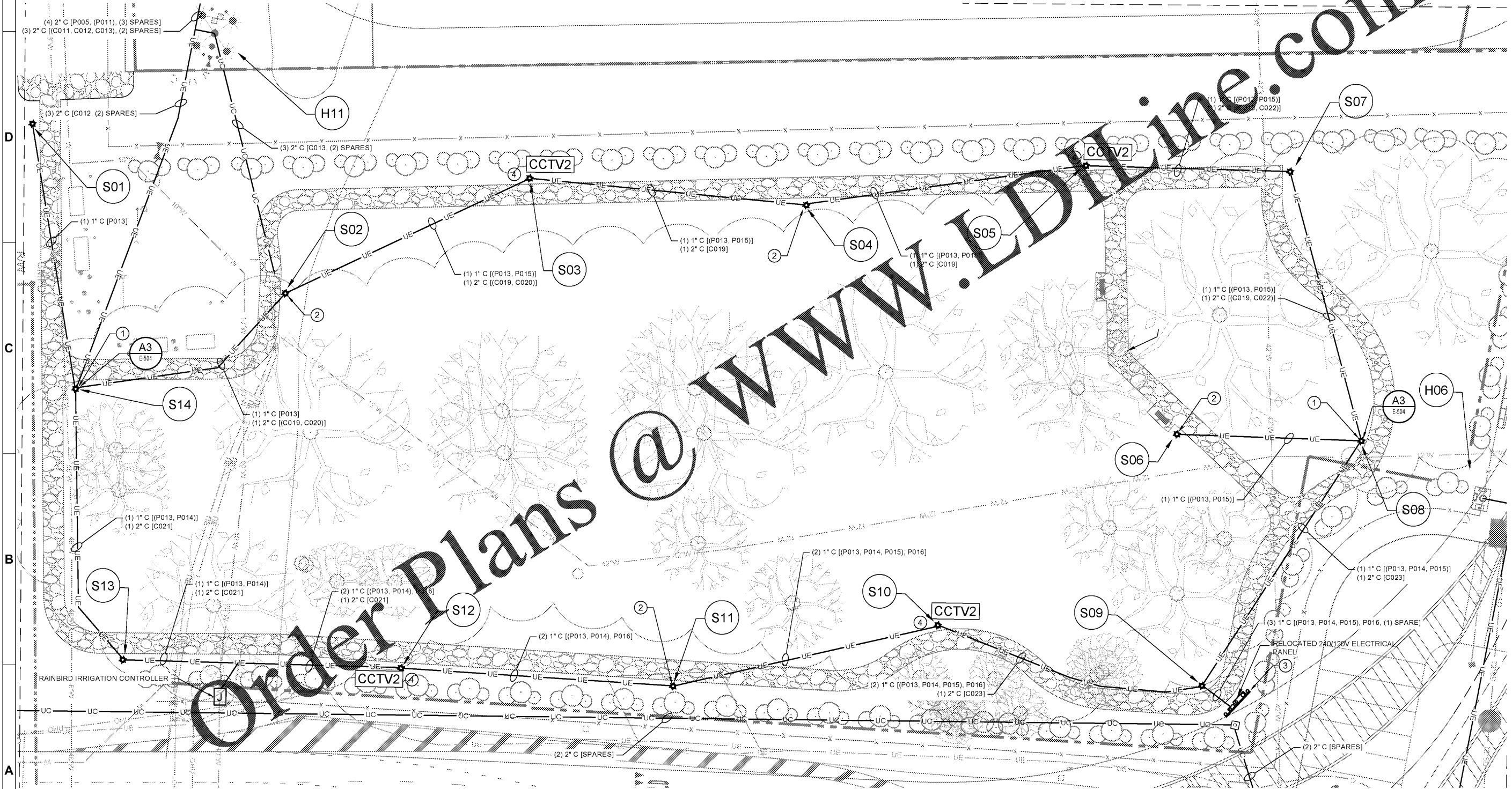

Order Plans @ www.edline.com

A1 OAK GROVE PARK ENLARGED ELECTRICAL PLAN
SCALE: 1" = 20'

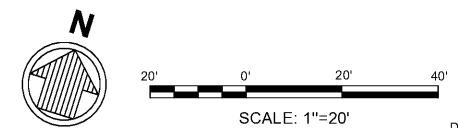

BID ISSUE
ISSUED: 2021-02-03
NOT TO BE USED FOR CONSTRUCTION
DRAWING SCALES SHOWN BASED ON 22"x34" DRAWING

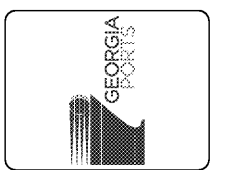

| Rev | Date | Description |
|-----|------|-------------|
| | | |
| | | |
| | | |
| | | |
| | | |
| | | |
| | | |
| | | |
| | | |

GEORGIA PORTS AUTHORITY
GCT CAPACITY IMPROVEMENTS - PHASE 2
OAK GROVE PARK ENLARGED ELECTRICAL PLAN

| | |
|---------------|-------------------|
| Designed by: | JAG |
| Drawn by: | BRL |
| Checked by: | DAW |
| Reviewed by: | JHP |
| Submitted by: | MOFFATT & NICHOLS |

2 EAST BRYAN ST., STE. 501
SAVANNAH, GA 31401
912.231.0044
moffatt & nichols

SEAL

Sheet Reference No. **E-401**
INDEX: OF

File: G:\1516531-264-2020 Capacity Improvements\600 CAD\A1_Active_Phase2_2020 Post_Elec\553254E-401_Plan02_232021 11:38 AM By: GREGG, ALAN - Saved: 2/3/2021 11:38 AM by: AGREGG