

**ABBREVIATIONS**

AB	ANCHOR BOLT	F	DEGREE FAHRENHEIT	N	NORTH	T	TREAD
ACOUST	ACOUSTICAL	FD	FLOOR DRAIN	N/A	NOT APPLICABLE	T & G	TONGUE & GROOVE
AFF	ABOVE FINISHED FLOOR	FE	FIRE EXTINGUISHER	NIC	NOT IN CONTRACT	TBD	TO BE DETERMINED
A/C	AIR CONDITIONING	FEC	FIRE EXTINGUISHER CABINET	NO	NUMBER	TBR	TO BE REMOVED
ACT	ACOUSTICAL CEILING TILE	FF	FINISH FLOOR	NOM	NOMINAL	TEL	TELEPHONE
ADD	ADDITION	FFE	FINISHED FLOOR ELEVATION	NTS	NOT TO SCALE	TEHP	TEMPERED, TEMPORARY, TEMPERATURE
ADJ	ADJACENT, ADJUSTABLE	FIN	FINISH			TER	TERRAZO
AHU	AIR HANDLING UNIT	FIX	FIXTURE	OC	ON CENTER	THK	THICK(NESS)
ALUM (IN)	ALUMINUM	FL (R)	FLOOR (ING)	OD	OUTSIDE DIAMETER	THR	THRESHOLD
ANOD	ANODIZED	FLASH	FLASHING	OH	OVERHEAD	TOS	TOP OF STEEL
APPROX	APPROXIMATE(LY)	FLOOR	FLOOR/RES	OPG	OPENING	TOW	TOP OF WALL
ARCH	ARCHITECTURAL	FOUND.	FOUNDATION	OPP	OPPOSITE	TS	TRANSITION STRIP
		F.R.I.	FIRE RETARDANT TREATED	ORIG	ORIGINAL	TYP	TYPICAL
		FIG	FOOTING	OZ	OUNCE	UC	UNDER CUT
BRG	BEARING	FT	FOOT, FEET	PART	PARTITION	UH	UNIT HEATER
BD	BOARD	FUR	FURRING	PBD	PARTICLE BOARD	UL	UNDERWRITER'S LABORATORY
BLDG	BUILDING	GA	GALVE	PCT	PORCELAIN CERAMIC TILE	UNF	UNFINISHED
BLK (G)	BLOCK (ING)	GALV	GALVANIZED	PERF	PERFORATED	UNO	UNLESS NOTED OTHERWISE
BOT/BTM	BOTTOM	GB	GRAB BAR	PF	PREFINISHED	VAR	VARNISH
CAB	CABINET	GC	GENERAL CONTRACTOR	PLAM	PLASTIC LAMINATE	VB	VINYL BASE
CAP	CAPACITY	GD	GRADE, GRADING	PLYWD	PLYWOOD	VCT	VINYL COMPOSITION TILE
CAT	CATALOG	GL	GLASS, GLAZING	PR	PAIR	VENT	VENTILATION / VENTILATOR
CD	CEILING DIFFUSER	GND	GROUND	PREFAB	PREFABRICATED	VERT	VERTICALLY
CEM	CEMENT	GPM	GALLONS PER MINUTE	PREP	PREPARED	VEST	VESTIBULE
CER	CERAMIC	GWB, GYP BD	GYPSUM WALL BOARD	PSF	POUNDS PER SQUARE FOOT	VIF	VERIFY IN FIELD
CFM	CUBIC FEET PER MINUTE			PSI	POUNDS PER SQUARE INCH	VIN	VINYL
CG	CORNER GUARD			PT	PAINTED, PRESURE TREATED	VWC	VINYL WALL COVERING
CJ	CONTROL JOINT	HD	HUB DRAIN	PL	PLATE / PROPERTY LINE		
CKT	CIRCUIT	HDWR	HARDWARE	PLAS	PLASTER	W	WEST
CL	CENTER LINE	HDWD	HARDWOOD	PLAS	PLASTER	W/	WITH
CLG	CEILING	HGT	HEIGHT	PVC	POLY VINYL CHLORIDE	W/O	WITHOUT
CLR	CLEAR	HM	HOLLOW METAL	QTY	QUANTITY	WC	WATER CLOSET, WATER COOLER
CMU	CONCRETE MASONRY UNIT	HORIZ	HORIZONTAL (LY)	R	RADIUS, RISER, R-VALUE	WD	WOOD
CO	CLEANOUT	HP	HORSEPOWER	RA	RETURN AIR	WG	WALL GUARD
COL	COLUMN	HR	HOUR	RBR	RUBBER	WT	WEIGHT
CONC	CONCRETE	HV(AC)	HEATING/VENTILATING/ (AIR CONDITIONING)	RC	REFRIGERATION CONTRACTOR	WWF	WELDED WIRE FABRIC
CONN	CONNECTION	HW	HOT WATER	RCP	REFLECTED CEILING PLAN		
CONT	CONTINUOUS			RD	ROOF DRAIN		
COORD	COORDINATE, COORDINATED			RE	REFERENCE, REFER TO		
CORR	CORRIDOR	ID	INSIDE DIAMETER	REC	RECESSED		
CPT	CARPET	IN	INCHES	REFL	REFLECTED (IVE)		
CPS	COURSES	INCAN	INCANDESCENT	REINF	REINFORCE (ED) (ING)		
CT	CERAMIC TILE	INSUL	INSULATED, INSULATION	REQ'D	REQUIRED		
		INT	INTERIOR	REQ/MT	REQUIREMENT		
		INV	INVERT	RES	RESILIENT		
DBL	DOUBLE	JAN	JANITOR	RET	RETURN		
DEMO	DEMOLITION	J-BOX	JUNCTION BOX	REV	REVISION, REVISED		
DES	DESIGNATION	JST	JOIST	RF	RADIO FREQUENCY		
DET	DETAIL	JT	JOINT	RM	ROOM		
DF	DRINKING FOUNTAIN	K.D.	KNOCK DOWN	R.O.	ROUGH OPENING		
DIA OR Ø	DIAMETER	KIT	KITCHEN	S	SOUTH		
DIM	DIMENSION	K.P.	KICK PLATE	SAPC	SUSPENDED-ACOUSTICAL-PANEL-CEILING		
DISP	DISPENSER	K.W.H.	KILOWATT HOUR	SCHE	SCHEDULE (D)		
DN	DOWN	LAM	LAMINATE	SCWD	SOLID CORE WOOD		
DO	DITTO (DO OVER)	LAV	LAVATORY	SECT	SECTION		
DR	DOOR	LB (S)	POUND (S)	SGFT	STRUCTURAL GLAZED FACING TILE		
DS	DOWNSPOUT	LG	LONG	SHT	SHEET		
DWG	DRAWING	MAS	MASONRY	SIM	SIMILAR		
E	EAST	MATL	MATERIAL	SPEC	SPECIFICATION(S)		
EA	EACH	MAX	MAXIMUM	SQ	SQUARE		
EC	ELECTRICAL CONTRACTOR	MDF	MODIFIED DENSITY FIBERBOARD	SS	STAINLESS STEEL		
EF	EACH FACE/ EPOXY FLOOR	MEZZ	MEZZANINE	ST	STAIN(ED)		
EJ	EXPANSION JOINT	MECH	MECHANICAL	STD	STANDARD		
EL	REFERENCE ELEVATION	MTL	METAL	STL	STORAGE		
ELEC (IT)	ELECTRIC(IAL)	MFR	MANUFACTURER	SUSP	SUSPENDED		
ELEV	ELEVATION, ELEVATOR	MILDEW	MILDEW	SV	SHEET VINYL		
ENG	ENGINEER(ING)	MIN	MINIMUM	STRUC	STRUCTURE, STRUCTURAL		
ENLG	ENLARGED	MISC	MISCELLANEOUS				
ENIG	EXTRUDED POLYSTYRENE	MOLDING	MOLDING				
EPS	EXPANDED POLYSTYRENE	MO	MASONRY OPENING				
EQ	EQUAL	MR	MOISTURE RESISTANT				
EQUIP	EQUIPMENT	MTD	MOUNTED				
EWC	ELECTRIC WATER COOLER						
EXIST	EXISTING						
EXP	EXPOSED EXPANSION						
EXT	EXTERIOR, EXTERNAL						
ETR	EXISTING TO REMAIN						
EW	EACH WAY						

**GENERAL SYMBOLS**

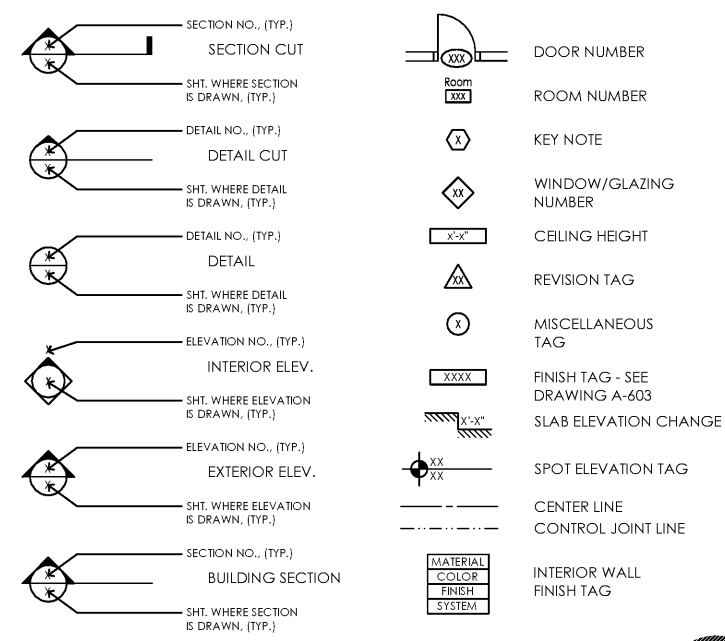

**MATERIAL INDICATION**

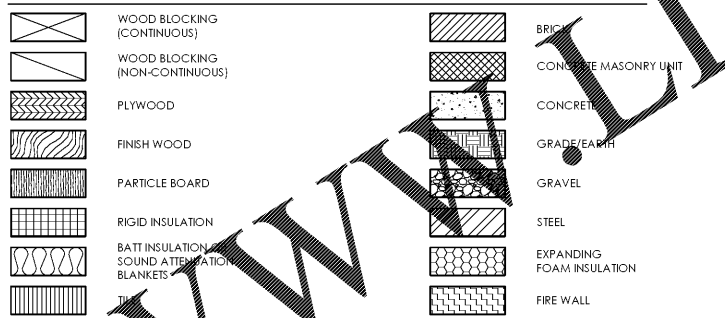

**GENERAL CONSTRUCTION NOTES**

- ALL CONSTRUCTION SHALL CONFORM TO THE CODES LISTED ON G-002.
  - THE CODES, RULES, AND REGULATIONS OF THE STATE IN WHICH THE WORK IS BEING PERFORMED.
  - NFPA REQUIREMENTS AS WELL AS TO STANDARDS OF UNDERWRITERS LABORATORIES INC., AND LOCAL UTILITY CO.
  - CONTRACTOR SHALL BE RESPONSIBLE FOR SECURING ALL PERMITS AS REQUIRED TO PROVIDE THE NEW CONSTRUCTION.
- CONTRACTOR SHALL VISIT THE SITE AND EXAMINE EXISTING CONDITIONS PRIOR TO SUBMITTING BIDS. BIDS SHALL INCLUDE PROVISIONS FOR A COMPLETE JOB BASED ON THE DESIGN INTENT SHOWN ON THE DRAWINGS. FIELD VERIFY ALL DIMENSIONS & CONDITIONS PRIOR TO START OF WORK AND REPORT ALL DISCREPANCIES TO THE ARCHITECT / ENGINEER.
- WHEN COMPARING THE DRAWINGS AND SPECIFICATIONS; THE DRAWINGS GOVERN SPECIFICATIONS FOR QUANTITY AND LOCATION, AND SPECIFICATIONS GOVERN DRAWINGS FOR QUALITY AND PERFORMANCE. IN THE EVENT OF AMBIGUITY IN QUANTITY OR QUALITY, THE GREATER QUANTITY AND SUPERIOR QUALITY SHALL GOVERN.
- CONTRACTOR SHALL BE FULLY RESPONSIBLE FOR ALL COORDINATION AS REQUIRED INCLUDING COORDINATION WITH ANY WORK PROVIDED BY OWNER AND BY OTHERS.
  - REFER TO HVAC, PLUMBING, & ELECTRICAL DRAWINGS FOR WORK PERFORMED BY THOSE TRADES.
- THE OWNER SHALL DESIGNATE STAGING AND STORAGE AREAS OF THE SITE FOR USE BY CONTRACTOR DURING CONSTRUCTION. CONTRACTOR SHALL KEEP THE PREMISES AND SURROUNDING AREA FREE FROM ACCUMULATION OF WASTE OF RUBBISH MATERIALS, CONTRACTOR'S TOOLS, CONSTRUCTION EQUIPMENT, MACHINERY, AND SURPLUS MATERIALS.
- AREAS OF THE SITE AND ANY EXISTING CONSTRUCTION TO REMAIN, AND IF DAMAGED DURING CONSTRUCTION SHALL BE RESTORED TO THE ORIGINAL CONDITION (AT NO ADDITIONAL COST TO THE OWNER.)
- CONTRACTOR SHALL PROVIDE ALL PROTECTION OF THE WORK THROUGHOUT CONSTRUCTION AS REQUIRED AND PER CODE.
- PROVIDE A SELF-LEVELING CEMENTITIOUS UNDERLAMENT WHERE FINISHING COMPOUNDS DO NOT MEET MANUFACTURER REQUIREMENTS FOR SUBSTRATE PREPARATION.
- PAINTING INCLUDES WALLS, SOFFIT, DOOR FRAMES, HOLLOW METAL DOORS, ALL EXPOSED SURFACES, AND ALL SURFACE MOUNTED ITEMS ARE REQUIRED TO PROVIDE FINISHED PRODUCT.
- CONTRACTOR TO VERIFY LOCATIONS OF ALL WALL MOUNTED ITEMS AND PROVIDE SOLID BLOCKING FOR MOUNTING.
- REFER TO FINISH PLANS FOR NOTES FOR TYPES AND EXTENT OF FINISHES.
- REFER TO PROJECT MANUAL APPENDIX 'A' FOR ALL ITEMS FURNISHED BY OWNER AND INSTALLED BY CONTRACTOR.
- REFER TO PROJECT MANUAL APPENDIX 'B' FOR ALL ITEMS PROVIDED BY OWNER.

Issued:	Date:
A Client Review Set	01/21/21
B Permit Set	02/03/21
C Bid Set	02/12/21
D	
Revisions:	Date:
1	
2	
3	
4	
5	
6	
7	
8	
9	

**DO NOT SCALE PLANS**  
Copying, Printing, Software and other processes required to produce these prints can stretch or shrink the actual paper or layout. Therefore, scaling of this drawing may be inaccurate. Contact ms consultants with any need for additional dimensions or clarifications.

**ms consultants, inc.**  
engineers, architects, planners  
5444 Wade Park Blvd.  
Suite 160  
Raleigh, NC 27607-4299  
phone 919.772.5565  
fax 919.779.2308

DRAWN BY: SCG/MEM  
REVIEWED BY: NAL/CMB

Seal

PROFESSIONAL OF RECORD:  
CHARLES M. BUSCH No. 14751  
EXP. DATE: 06/30/2021

**ALDI Inc.**  
1985 Old Union Church Road  
Salisbury, NC 28146  
(704) 642-0223  
(704) 642-0078 fax

ALDI Inc.  
Store No. 87  
2526 Freedom Dr  
Charlotte, NC 28208  
Mecklenburg County  
Project Name & Location:

General Notes, Symbols & Abbrev. Drawing Name:	
Prototype Rls. 06/03/20	Project No. 40452-30
Type: 00x154 FMR	
	A-001
Scale: As Noted	Drawing No.

Order Plans @ WWW.LDILLING.COM