

PROJECT INFORMATION:

THE BUILDING IS IN COMPLIANCE WITH THE:
 2018 NORTH CAROLINA BUILDING CODE
 2018 NORTH CAROLINA EXISTING BUILDING CODE
 2018 NORTH CAROLINA FIRE CODE
 2018 NORTH CAROLINA MECHANICAL CODE
 2018 NORTH CAROLINA PLUMBING CODE
 2018 NORTH CAROLINA ENERGY CONSERVATION CODE
 2018 NORTH CAROLINA FUEL GAS CODE
 2017 NORTH CAROLINA ELECTRICAL CODE
 2009 ICC / ANSI A117.1
 2018 NORTH CAROLINA EXISTING BUILDING CODE

BUILDING PLANNING (CHAPTER 3.4.5.6):		
OCCUPANCY CLASSIFICATION (302.0 - 312.0)	MIXED OCCUPANCY GROUP M & S-1	
	(ALLOWABLE)	(ACTUAL)
NUMBER OF STORIES (TABLE 504.4):	2	1
BUILDING HEIGHT (TABLE 504.3):	60'-0"	19'-7"
BUILDING AREA (TABLE 506.2):	36,000	17,621

AREA MODIFICATIONS (506):
 AUTOMATIC SPRINKLER SYSTEM: YES - (300% INCREASE)

TYPES OF CONSTRUCTION (CHAPTER 6)
 CONSTRUCTION CLASSIFICATION: **VB**

FIRE RESISTANT REQUIREMENTS: (TABLES 601 & 602)
 STRUCTURAL FRAME: 0 HR.
 BEARING WALLS:
 EXTERIOR: 0 HR.
 INTERIOR: 0 HR.
 NONBEARING WALLS AND PARTITIONS:
 EXTERIOR: SEE TABLE 602
 INTERIOR: 0 HR.
 FLOOR CONSTRUCTION: 0 HR.
 ROOF CONSTRUCTION: 0 HR.

FIRE SEPARATION DISTANCE = X (feet)
 LESS THAN 5': 2 HR.
 MORE THAN 5', LESS THAN 10': 1 HR.
 MORE THAN 10', LESS THAN 30': 0 HR.
 GREATER THAN 30': 0 HR.

FIRE AND SMOKE PROTECTION FEATURES: (CHAPTER 7)
 FIRE-RESISTANT RATING OF STRUCTURAL MEMBERS (704): NOT REQUIRED
 EXTERIOR WALLS (705): NOT REQUIRED
 FIRE WALLS (706): NOT REQUIRED
 FIRE BARRIERS(707): NOT REQUIRED
 FIRE PARTITIONS (708): NOT REQUIRED
 SMOKE BARRIERS (709): NOT REQUIRED
 SMOKE PARTITIONS (710): NOT REQUIRED
 FLOOR AND ROOF ASSEMBLIES (711): NOT REQUIRED
 VERTICAL OPENINGS (712): NOT REQUIRED
 SHAFT ENCLOSURES (713): NOT REQUIRED
 PENETRATIONS (714): NOT REQUIRED
 FIRE-RESISTANT JOINT SYSTEMS (715): NOT REQUIRED
 OPENING PROTECTIVES (716): NOT REQUIRED
 DUCTS AND AIR TRANSFER OPENINGS (717): NOT REQUIRED
 CONCEALED SPACES (718): PROVIDED
 FIRE-RESISTANT REQUIREMENTS FOR PLASTER (719): NOT REQUIRED
 THERMAL- AND SOUND-INSULATING MATERIALS(720): NOT REQUIRED

INTERIOR FINISHES (CHAPTER 8)

OCCUPANCY/ GROUP	INTERIOR WALL AND CEILING FINISH REQUIREMENTS BY OCCUPANCY (TABLE 803.11)					
	SPRINKLERED			NONSPRINKLERED		
	EXIT ENCLOSURES AND EXIT PASSAGeways	CORRIDORS	ROOMS AND ENCLOSED SPACES	EXIT ENCLOSURES AND EXIT PASSAGeways	CORRIDORS	ROOMS AND ENCLOSED SPACES
B, E, M, R-1	B	C	C	A	B	C
S	C	C	C	B	B	C

FIRE PROTECTION SYSTEMS (CHAPTER 9)
 AUTOMATIC SPRINKLER SYSTEMS (903): (REQUIRED) YES (PROVIDED) YES
 STANDPIPE SYSTEM (905): (REQUIRED) NO (PROVIDED) NO
 PORTABLE FIRE EXTINGUISHERS (906): (REQUIRED) YES (PROVIDED) YES
 FIRE ALARM AND DETECTION SYSTEMS(907): (REQUIRED) NO (PROVIDED) YES
 EMERGENCY ALARM SYSTEMS (908): (REQUIRED) NO (PROVIDED) NO
 SMOKE CONTROL SYSTEMS (909): (REQUIRED) NO (PROVIDED) NO
 SMOKE AND HEAT REMOVAL(910): (REQUIRED) NO (PROVIDED) NO
 FIRE COMMAND CENTER (911): (REQUIRED) NO (PROVIDED) NO
 FIRE DEPARTMENT CONNECTIONS (912): (REQUIRED) YES (PROVIDED) YES

**MEANS OF EGRESS (CHAPTER 10)
 OCCUPANT LOAD (1004):**

OCCUPANCY LOADS (1004.0 TABLE 1004.1.2)			
OCCUPANCY USE	SQUARE FEET/ OCCUPANT	TOTAL OCCUPANCY SQUARE FOOTAGE	OCCUPANTS
MERCANTILE	60	11,277	188
BUSINESS	100	516	6
STORAGE / STOCK	300	4,107	14
TOTAL OCCUPANT LOAD			208

EGRESS WIDTH (1005):

USE GROUP OR SPACE DESCRIPTION	[A] OCCUPANT LOAD BY USE	[B] EGRESS WIDTH PER OCCUPANT (SECTION 1005.3)		REQUIRED WIDTH (SECTION 1005.3) [A X B]		EXIT WIDTH (IN.)*		ACTUAL WIDTH SHOWN ON PLANS
		STAIR	LEVEL	STAIR	LEVEL	STAIR	LEVEL	
		BUSINESS	6	.3	.2	1.8	1.2	
MERCANTILE	188	.3	.2	56.4	37.6			
STORAGE	14	.3	.2	4.2	2.8			
TOTAL	208	.3	.2	62.4	41.6			

* Where more than one exit, or access to more than one exit, is required, the means of egress shall be configured such that the loss of one exit or access to one exit shall not reduce the available capacity to less than 50 percent of the total required capacity (Section 1005.5)

NUMBER OF EXITS (1006): (REQUIRED) 3 (PROVIDED) 3
 COMMON PATH OF EGRESS TRAVEL (TABLE 1006.2.1): 75' MERCANTILE 100' STORAGE
 ACCESSIBLE MEANS OF EGRESS (1009): (REQUIRED) YES (PROVIDED) YES
 DOOR WIDTH (1010):
 MINIMUM: 32"
 MAXIMUM: 48"
 PANIC HARDWARE (1010.1.10): (REQUIRED) NO (PROVIDED) YES
 EXIT SIGNS (1013): (REQUIRED) YES (PROVIDED) YES
 HANDRAILS (1014): 34" H. MIN., 38" H. MAX.
 GUARDS (1015): 42" H. IF ADJACENT GRADE IS GREATER THAN 30"
 MAXIMUM TRAVEL DISTANCE TO AN EXIT (TABLE 1017.2): 250'
 MINIMUM CORRIDOR WIDTH (1020.2): 44" / 60" FOR H.C. TURN AROUND (AT 200' INTERVALS)
 MAXIMUM DEAD END CORRIDOR DISTANCE (1020.4): 50' IF SPRINKLERED

ACCESSIBILITY (CHAPTER 11)

CHECK-OUT AISLES (TABLE 1109.12.2): (REQUIRED) 2 (PROVIDED) 5

PLUMBING FIXTURE REQUIREMENTS:

OCCUPANCY/ GROUP	MINIMUM NO. OF REQUIRED PLUMBING FIXTURES (IBC/PC TABLE 403.1)					
	WATER CLOSETS (URINALS)		LAVATORIES		BATHUBS/ SHOWERS	DRINKING FOUNTAINS
	MALE	FEMALE	MALE	FEMALE		OTHER
MERCANTILE (REQUIRED)	1 PER 500		1 PER 750		1 PER	SERVICE SINK
MERCANTILE (PROVIDED)	1+1	3	1	2	(2) HI-LO	SERVICE SINK

Order Plans @ WWW.LDILine.com

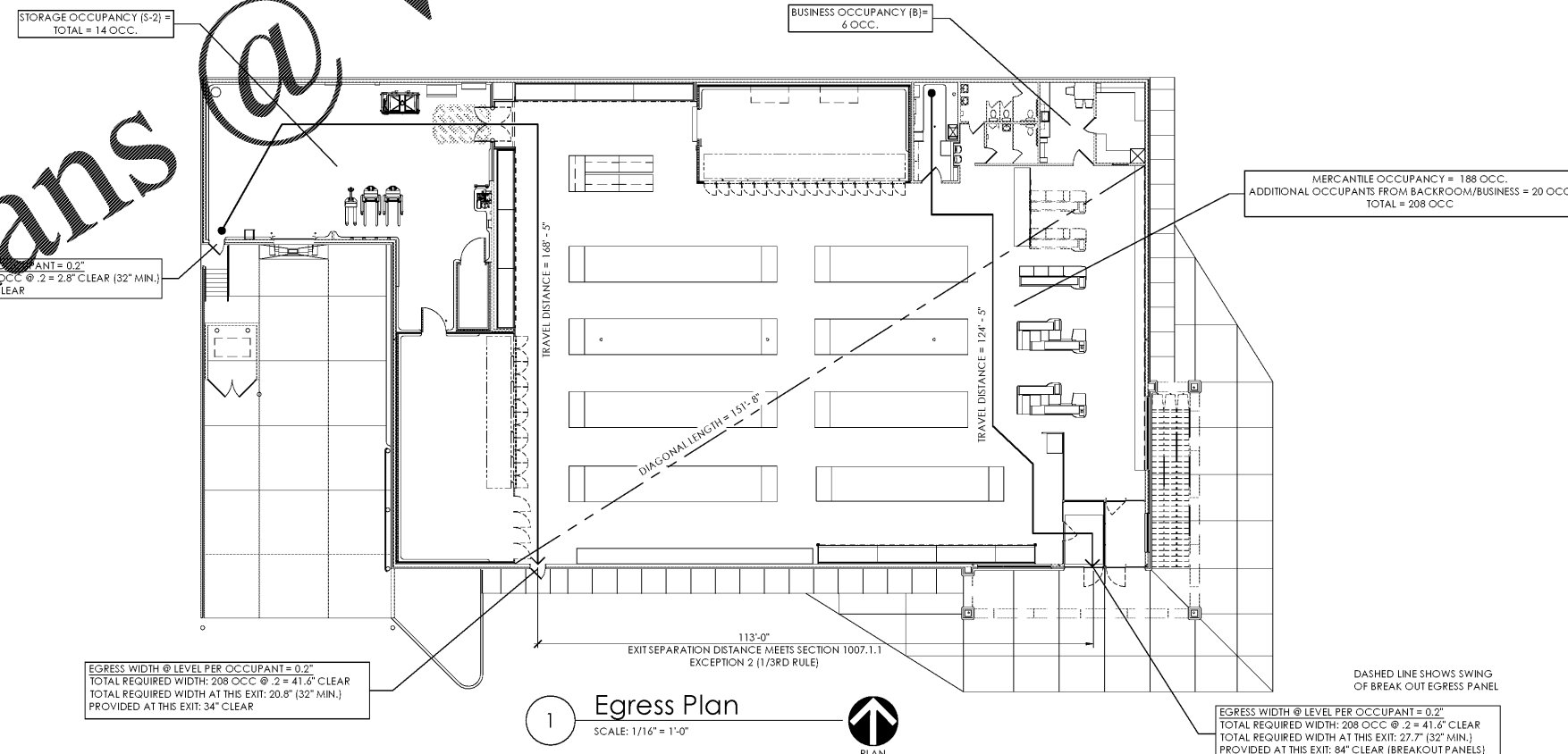

1 Egress Plan
 SCALE: 1/16" = 1'-0"
 PLAN NORTH

Issued:	Date:
A Client Review Set	01/21/21
B Permit Set	02/03/21
C Bid Set	02/12/21
D	
Revisions:	Date:
1	
2	
3	
4	
5	
6	
7	
8	
9	

DO NOT SCALE PLANS
 Copying, Printing, Software and other processes required to produce these prints on stretch or shrink the actual paper or layout. Therefore, scaling of this drawing may be inaccurate. Contact us consultants with any need for additional dimensions or clarifications.

ms consultants, inc.
 engineers, architects, planners
 5444 Wade Park Blvd.
 Suite 160
 Raleigh, NC 27607-4299
 phone 919.772.5565
 fax 919.779.2308

DRAWN BY: SCG/MEM
 REVIEWED BY: NAL/CMB

Seal

PROFESSIONAL OF RECORD:
 CHARLES M. BUSCH No. 14751
 EXP. DATE: 06/30/2021

ALDI Inc.
 1985 Old Union Church Road
 Salisbury, NC 28146
 (704) 642-0022
 (704) 642-0078 fax

ALDI Inc.
 Store No. 87
 2526 Freedom Dr
 Charlotte, NC 28208
 Mecklenburg County
 Project Name & Location:

Code Review

Drawing Name:
 Prototype Rls. 06/03/20
 Project No. 40452-30
 Type: 100x154 FMR

G-002
 Scale: As Noted
 Drawing No.