

ALL DESIGNS, DRAWINGS AND SPECIFICATIONS DEPICTED ON THIS SHEET ARE THE PROPERTY OF D3 STUDIO, PLLC. ANY UNAUTHORIZED USE OR REPRODUCTION IS SUBJECT TO LEGAL PROSECUTION. POSSESSION IN ANY FORM CONSTITUTES ACCEPTANCE OF THESE CONDITIONS. COPYRIGHT 2021

IN-SLAB PLUMBING SCHEDULE										
ITEM	ROUGH-IN HEIGHT	QTY	CW	HW	SANITARY WASTE	GAS SIZE	GAS BTUH	ITEM	DESCRIPTION	REMARKS
P-9-W	IN-SLAB	1			INDIRECT			9	WORKTABLE w/SINK	FLOOR SINK
P-9.1-W	IN-SLAB	1			INDIRECT			9.1	WORKTABLE w/SINK	FLOOR SINK
P-15-W	STUB UP	3			1-1/2"			15	HAND SINK	INDIRECT WASTE; STUB WHERE SHOWN; SET OFF 2" FOR WALL ROUGH-IN; DRAW UP WASTE AND ICE MASH SEPARATE DRAIN LINES; DO NOT MANIFOLD DRAIN LINES.
P-23-W	IN-SLAB	1			INDIRECT			23	ICE MACHINE	FLOOR SINK; SEE NOTE BELOW
P-41-W	IN-SLAB	1			INDIRECT			41	HOT FOOD SERVING COUNTER	FLOOR SINK; SEE NOTE BELOW
P-46-W	IN-SLAB	1			INDIRECT			46	BEVERAGE DISPENSER	FLOOR SINK
P-53-W	IN-SLAB	1			INDIRECT			53	DISHWASHER	FLOOR SINK; INDIRECT WASTE FROM 3 TUBS, MANIFOLDED TO ONE PIPE
P-74-W	IN-SLAB	1			INDIRECT			66	3-COMPARTMENT SINK	FLOOR SINK

- KEYED NOTES THIS SHEET**
- EXISTING HANDSINK SHIFTED DOWN TO INCORPORATE NEW COOK LINE. EXTEND EXISTING WASTE & VENT PIPING WITHIN WALL AS REQUIRED.
 - EXTEND NEW SAN PIPING AND CONNECT TO EXISTING SAN PIPING IN THIS AREA. VERIFY EXACT LOCATION, SIZE, INVERT, AND DIRECTION OF FLOW OF EXISTING PIPING IN FIELD.
 - EXTEND NEW VENT PIPING AND CONNECT TO EXISTING VENT PIPING IN THIS AREA. VERIFY EXACT LOCATION AND SIZE OF EXISTING PIPING IN FIELD.

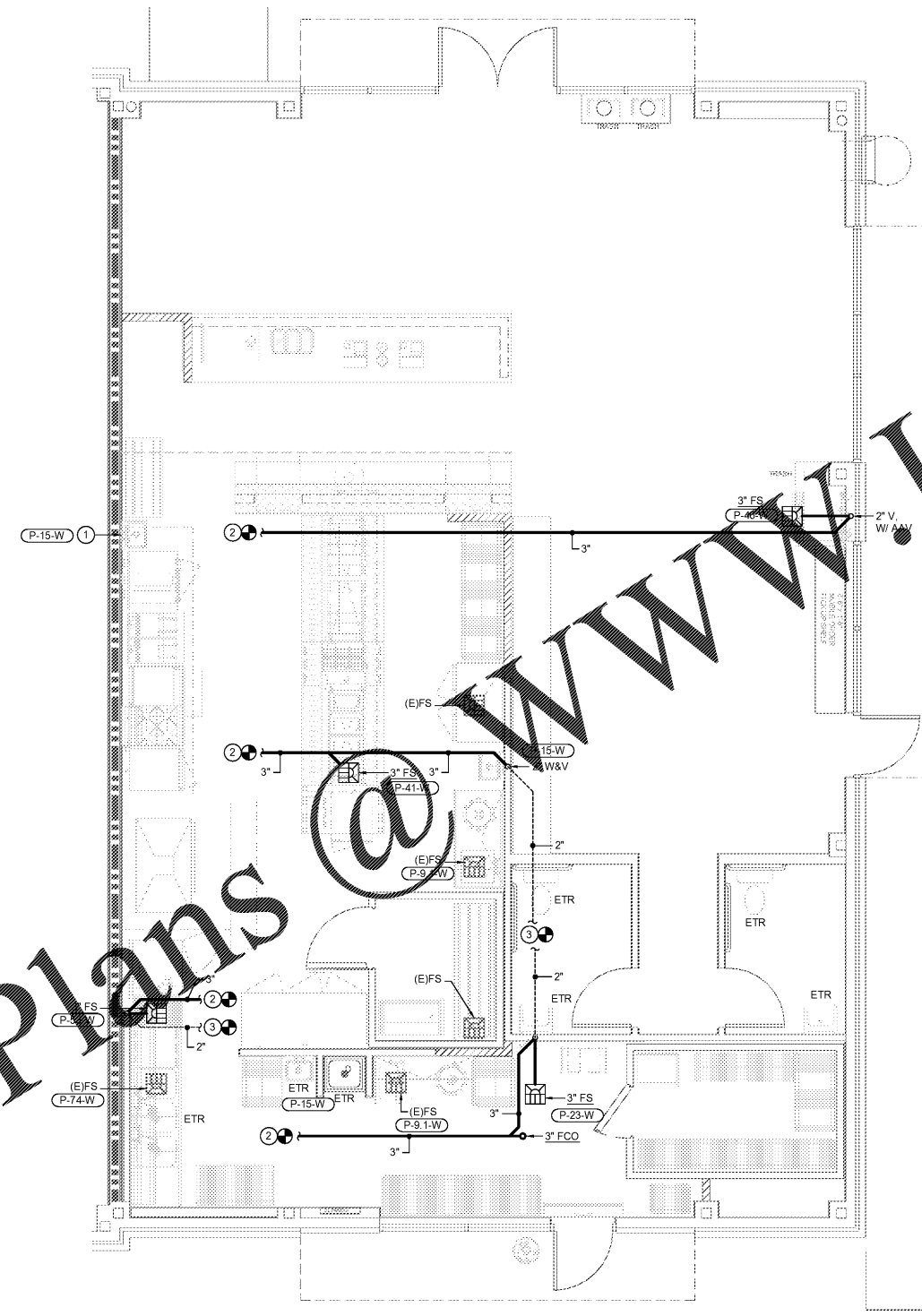

WASTE & VENT PLAN
SCALE: 1/4" = 1'-0"

- GENERAL NOTES THIS SHEET**
- SEE FIXTURE SCHEDULE ON SHEET P0.01 FOR SIZES OF SANITARY WASTE AND VENT CONNECTIONS TO INDIVIDUAL FIXTURES.
 - MINIMUM SIZE FOR SANITARY WASTE AND VENT PIPING BELOW GROUND SHALL BE 2".
 - ALL SANITARY VENT PIPING SHOWN ON THIS SHEET SHALL BE RUN ABOVE CEILINGS IN AREAS WITH CEILINGS AND SHALL BE RUN AS HIGH AS POSSIBLE IN AREAS WITHOUT CEILINGS. UNLESS OTHERWISE NOTED, ALL SANITARY WASTE PIPING SHOWN ON THIS SHEET SHALL BE RUN BELOW FLOORS, UNLESS OTHERWISE NOTED.
 - THE PLUMBING CONTRACTOR SHALL FIELD VERIFY EXISTING CONDITIONS INCLUDING DIRECTION OF FLOW, INVERTS, AND TIE-IN LOCATIONS PRIOR TO ROUTING ANY PIPING. SAWCUT EXISTING SLAB, WALL, OR CEILING CONSTRUCTION AS REQUIRED. AREAS TO BE SAWCUT SHALL BE APPROVED BY ARCHITECT PRIOR TO CUTTING. ALL SAWCUT AND ALTERED SURFACES SHALL BE FILLED, PATCHED, PAINTED, AND REPAIRED TO MATCH ADJACENT SURFACES.

Order Plans @ www.LDILine.com

d3 studio
PLANNING * ARCHITECTURE * INTERIORS
1318 CENTRAL AVENUE :: SUITE A-10
CHARLOTTE, NC 28205
WEBSITE :: www.d3studio.com

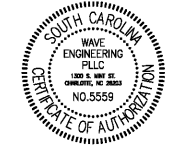

FOR CONSTRUCTION

Viva Chicken.
PERUVIAN ROTISSERIE JOINT
1139 WOODRUFF RD.
-SUITE B
GREENVILLE, SC
29607

REVISION		
no.	date	comment

DRAWN BY: SBC
CHECKED BY: BRD
SUBMITTAL DATE: 02.08.2021
PROJECT NUMBER: 02-2031

PLUMBING
WASTE & VENT
PLAN
P1.01