

ALL DESIGNS, DRAWINGS AND SPECIFICATIONS DEPICTED ON THIS SHEET ARE THE PROPERTY OF D3 STUDIO, P.L.L.C. ANY UNAUTHORIZED USE OR REPRODUCTION IS SUBJECT TO LEGAL PROSECUTION. POSSESSION IN ANY FORM CONSTITUTES ACCEPTANCE OF THESE CONDITIONS. COPYRIGHT 2021

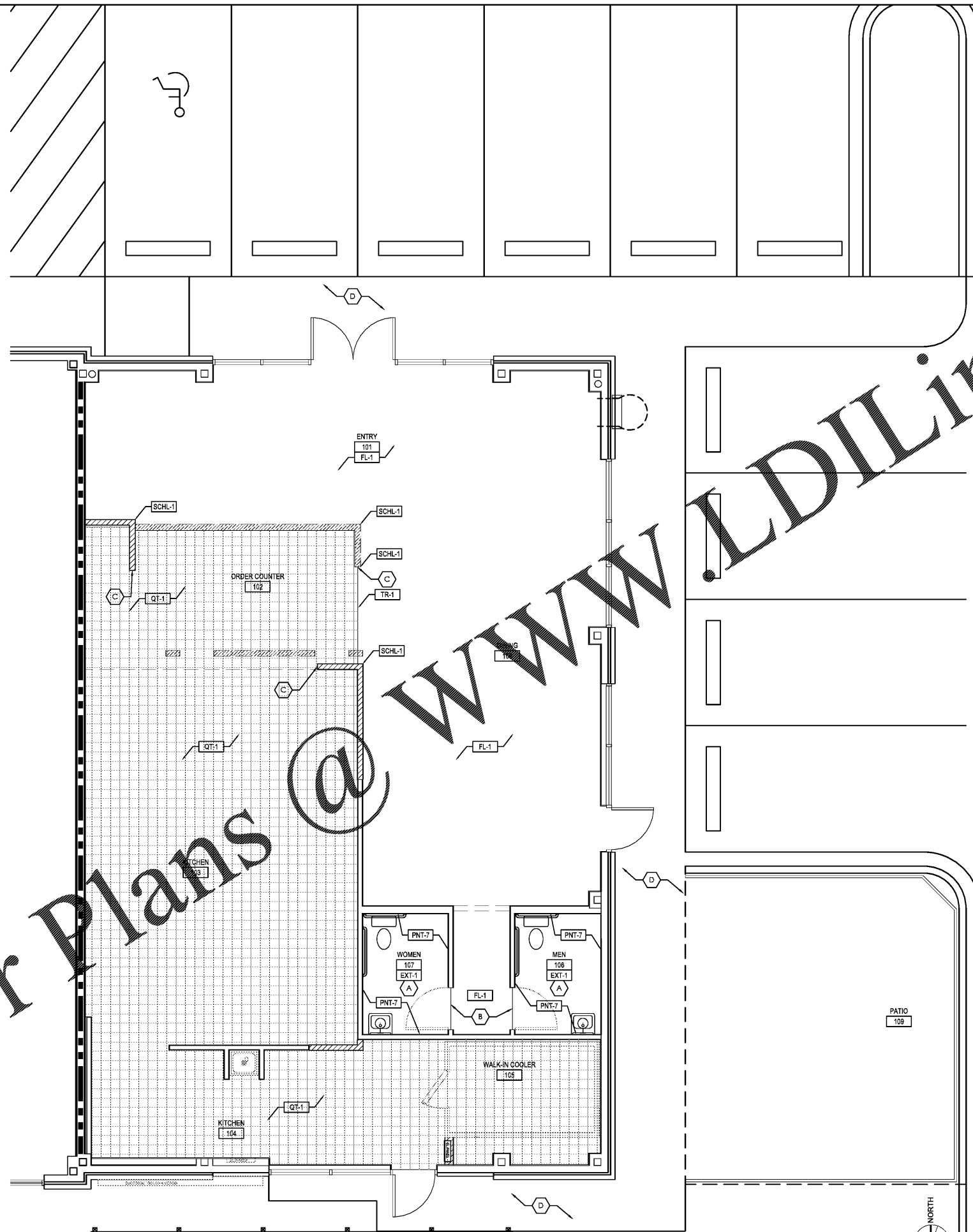

Order Plans @

**FINISH NOTES:**

1. ALL FINISHES SHALL COMPLY WITH 2018 NCSBC CHAPTER 8 AND TABLE 804 OF THE IFC.
  2. ALL FINISHES SHALL COMPLY WITH 2018 NCSBC TABLE 803.11 CLASS C FOR ROOMS AND ENCLOSED SPACES, CLASS B FOR INTERIOR EXIT STAIRWAYS, RAMP AND EXIT PASSAGE WAYS, CLASS B FOR EXIT ACCESS STAIRWAYS AND RAMP.
  3. RESTROOM FINISHES SHALL COMPLY WITH 2018 NCSBC CHAPTER 12 SECTIONS 1210.2.1 THROUGH 1210.2.4.
  4. NOTIFY THE ARCHITECT/PROJECT MANAGER IMMEDIATELY FOR CLARIFICATIONS IF THERE ARE ANY DISCREPANCIES BETWEEN THE FINISH PLAN AND THE INTERIOR ELEVATIONS.
  5. GC TO USE FLOOR LEVELING FOR CONCRETE FLOORS PRIOR TO INSTALLATION OF FLOOR OR WALL FINISHES. VERIFY FLOOR LEVELING WITH D3 STUDIO WHEN CONCRETE IS TO BE STAINED OR SEALED.
  6. WHERE APPLICABLE, NEW FLOOR & WALL TILES ARE TO BE INSTALLED AS INDICATED ON PLAN WITH FULL TILES WHEREVER POSSIBLE. SEE FINISH SCHEDULE FOR SPECIFICATIONS. ALL TILE TO BE INSTALLED TO COMPLY WITH TCNA STANDARDS. A MINIMUM OF 1/16" SPACES TO BE LEFT FOR EXPANSION JOINTS UNLESS OTHERWISE NOTED.
  7. REFER TO INTERIOR ELEVATIONS FOR ADDITIONAL WALL FINISH INFORMATION AND FINISH SCHEDULE FOR ALL SPECIFICATION.
  8. ALL FLOOR FINISHES SHALL BE INSTALLED WITH TOP EDGES LEVEL WITH ADJACENT MATERIAL TOP EDGES. CHECK EACH TILE THICKNESS, AS THESE MAY VARY. CONFIRM THAT NO OVERALL LEVELING OF FLOOR IS REQUIRED. NOTIFY OWNER AND ARCHITECT IF OTHERWISE.
- COORDINATE ALL FINISHING TRANSITIONS AND BASE TILE INSTALLATION WITH MILLWORK SHOP DRAWINGS AND FIELD CONDITIONS.
10. ALL THRESHOLDS SHALL HAVE A MAX HEIGHT OF 1/2" ABOVE EXISTING CONCRETE SLAB AND/OR INTERIOR FINISHES.
  11. TILE TRANSITIONS BETWEEN ROOMS SHALL BE CENTERED ON DOOR FRAME.
  12. SEE PLUMBING DRAWINGS FOR DIMENSIONS AND LOCATIONS OF ALL FLOOR DRAINS AND FLOOR SINKS.

**SUBMITTALS & RFI'S**

1. CONTACT THE PROJECT MANAGER FOR SUBMITTALS & RFI'S. RFI'S SHALL BE FORWARDED TO ARCHITECT VIA EMAIL FOR DOCUMENTATION PURPOSES. ALL SUBMITTALS MUST BE REVIEWED AND STAMPED BY THE G.C. PRIOR TO SENDING TO ARCHITECT. ALLOW A MAXIMUM OF 14 BUSINESS DAYS FOR REVIEW.

**KEYED NOTES:**

- (A) RESTROOM TILE TO REMAIN. REPAIR AND CLEAN TILE AND GROUT. GYP WALLS ABOVE TILE TO REMAIN. REMOVE TEXTURE FROM GYP AND REPAIR AS NEEDED TO SMOOTH FINISH. WALLS ABOVE TILE TO BE PAINTED PNT-7
- (B) EXISTING RESTROOM FLOOR TILE TO REMAIN. TERMINATE AT CENTER OF THRESHOLD AND ADD TRANSITION STRIP FROM EXISTING RESTROOM TILE TO NEW STAINED CONCRETE FLOOR
- (C) CAP END OF WALL WITH STAINLESS STEEL TO COVER TILE-TO-FRP EDGES
- (D) SECTION OF SIDEWALK AT ENTRY TO BE STAINED DARK GRAY - GC TO VERIFY W/ OWNER

FINISH PLAN SCALE: 1/4" = 1'-0" 1

d3 studio  
 PLANNING \* ARCHITECTURE \* INTERIORS  
 1318 CENTRAL AVENUE :: SUITE A-10  
 CHARLOTTE, N.C. 28205  
 WEBSITE :: WWW.D3STUDIO.COM



FOR CONSTRUCTION

**Viva Chicken.**  
 PERUVIAN ROTISSERIE JOINT  
 1139 WOODRUFF RD.  
 -SUITE B  
 GREENVILLE, SC  
 29607

REVISION		
no.	date	comment

DRAWN BY: **JWT**  
 CHECKED BY: **SFB**  
 SUBMITTAL DATE: **02.09.2021**  
 PROJECT NUMBER: **02-2031**

**FINISH PLAN**

**A1.3**