

## 2 TANK CONFIGURATION FOR 5 MICRON PUR-WATER RECOVERY SYSTEMS

THIS IS THE SUGGESTED IDEAL CONFIGURATION FOR A 30 GPM LOW VOLUME 5 MICRON PUR-WATER SYSTEM. PUR-WATER RECOGNIZES THE FACT THAT SEPTIC TANKS ARE A LOCAL BUSINESS AND NOT ALL AREAS WILL HAVE THESE CONFIGURATIONS. THIS DRAWING IS OFFERED AS A GUIDELINE ONLY. IF YOU HAVE ANY QUESTIONS ABOUT A SIZE OR CONFIGURATION OF TANKS IN YOUR AREA, PLEASE CONTACT PUR-WATER AT 800-882-8854

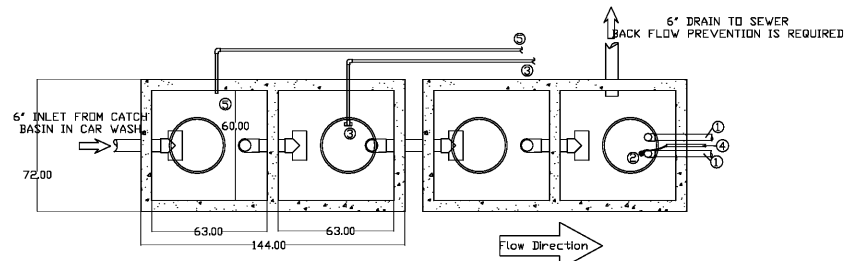

- ① TO PURWATER RECOVERY SYSTEM (2) 2" SCH 80 PVC SUCTION LINES, ONE TO SERVE AS A SPARE. LINES ARE STRAPPED TO THE TANK WALL. INSTALL SCH 80 UNIONS ABOVE THE WATERLINE TO ALLOW SERVICING OF EACH SUCTION LINE. TERMINATE SUCTION LINES W/ FULL FLOW FLAPPER CHECK VALVES (PURWATER SUPPLIED). NO SPRING LOADED FOOT VALVES.
- ② PURWATER PROVIDED (1) LOW-LOW SAFETY LEVEL FLOAT SHOULD BE MOUNTED SO THAT IT WILL BE IN THE DOWN POSITION 8" ABOVE THE BOTTOM OF THE FLAPPER CHECK. THIS FLOAT CONTROLS THE SAFETY FUNCTION TO PROTECT THE PUMP FROM OVERFLOW.
- ③ (1) 1" SCH 80 AIR SPARGER OR OZONE RECIRCULATION LINE. FOR AIR SPARGER SYSTEMS, ALLOW THE SPARGER TO BE 6-12" ABOVE THE WATER LINE. MOUNT IN THE MANWAY, IF POSSIBLE, TO ALLOW ACCESS FOR MAINTENANCE. FOR OZONE SYSTEMS, PLUMB THE LINE WITH A TEE, ON THE WET END, 24" UP FROM THE BOTTOM OF THE TANK.
- ④ (1) 1" SCH 80 PVC LINE TO SERVE AS A CONDUIT FOR (4) 14 GAUGE WIRES (2 W/ ARE SPARES) TERMINATED IN A WATER TIGHT JUNCTION BOX ABOVE THE WATER LINE TO PURWATER RECLAIM SYSTEM FOR FLOAT CONTROLS.
- ⑤ (1) 1" SCH 80 UNDERFLOW LINE FROM THE BOTTOM OF THE RECLAIM SYSTEM CYCLONE SEPARATOR. THIS LINE SHOULD BE LEVEL, OR PREFERABLY, SLOPE FROM THE RECLAIM SYSTEM TO THE CAR WASH CATCH BASIN OR THE FIRST COMPARTMENT OF TANK 1.
- ⑥ USE 6" PIPE AS INTERCONNECT PIPING BETWEEN COMPARTMENTS AND BETWEEN TANKS. ELEVATION DIMENSIONS ARE TO PIPE INVERTS.
- ⑦ (1) 6" SCH 80 PVC PIPE TO BE ROUTED TO SEWER OR OIL WATER SEPARATOR. NOTE: BACK FLOW PREVENTION FROM THE SEWER IS REQUIRED. CONSULT WITH LOCAL AUTHORITIES ON WHETHER FURTHER TREATMENT (I.E. OIL/WATER SEPARATION IS REQUIRED TO MEET DISCHARGE PERMIT).

**NOTES:**  
DRAWING IS FOR REFERENCE ONLY AND IS TO BE USED FOR PLUMBING REFERENCE. CONSULT WITH TANK MANUFACTURER FOR TANK LOADS. CONSULT WITH CIVIL ENGINEER FOR SOIL PREPARATION AND TANK PLACEMENT. SEAL ALL TANK PENETRATIONS TO PROVIDE WATER TIGHT SEAL TO PREVENT TANK LEAKAGE INTO SOIL. LINE TO SEWER TO HAVE BACK FLOW PREVENTION. CONSULT WITH LOCAL AUTHORITIES ON WHETHER FURTHER TREATMENT (I.E. OIL/WATER SEPARATION IS REQUIRED TO MEET DISCHARGE PERMIT).  
APPROX. TANK VOLUME IS 1500 GALLONS PER TANK, EACH TANK IS DIVIDED BY INTERNAL BAFFLE. TOTAL WATER STORAGE IS APPROX. 3000 GALLONS.

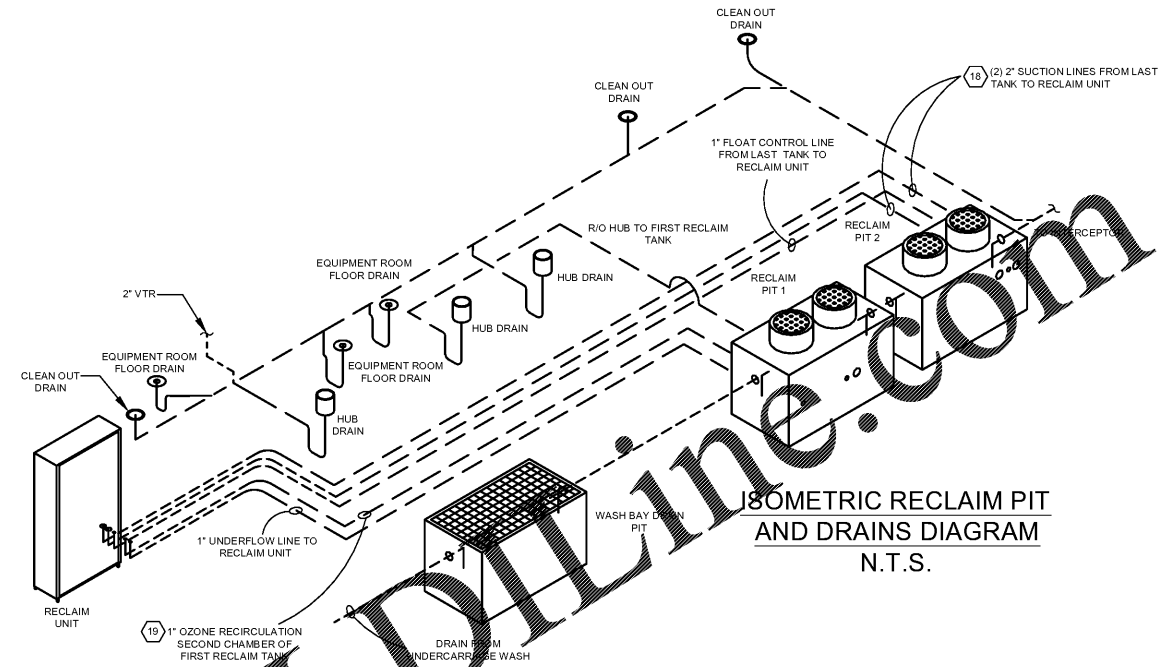
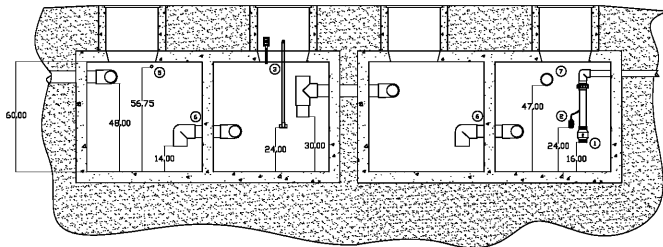

**ISOMETRIC RECLAIM PIT  
AND DRAINS DIAGRAM**  
N.T.S.

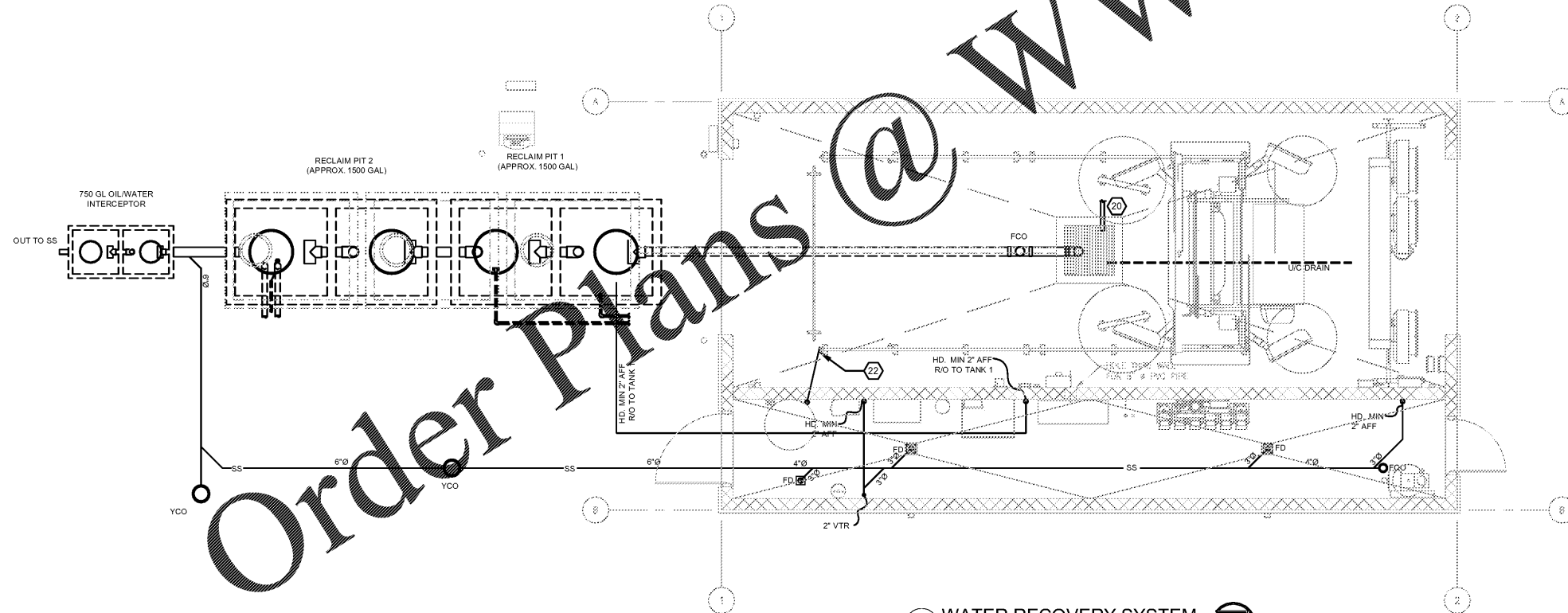

SITE CONTRACTOR IS RESPONSIBLE FOR ALL CAR WASH UNDERGROUND (RECLAIM TANKS, SAND TRAP/PIT, ETC).

ALL CAR WASH UNDERGROUND IS TO BE PROVIDED AND INSTALLED BY SITE CONTRACTOR.

DRAIN LOCATIONS ARE APPROXIMATE. COORDINATE FINAL LOCATIONS WITH EQUIPMENT MANUFACTURERS.

RE SHEET CWP1.1 FOR RECLAIM WATER ROUTING. SEE CIVIL DRAWINGS FOR ALL UNDERGROUND ROUTING.

REFERENCE CWP2.1 FOR PLUMBING SCHEDULES, NOTES, AND SYMBOLS.

Order Plans @

**1 WATER RECOVERY SYSTEM**  
1/4" = 1'-0"

1925 Prospect Ave.  
Orlando, FL 32814  
P (407) 661-9100  
P (407) 661-9101  
[www.ep.com](http://www.ep.com)  
Florida Corporate Certificate #AA 008626

4

Cuhaci & Peterson

Architects Engineers Planners

CLIENT NAME  
**BLACKFIN PARTNERS INVESTMENTS, INC.**  
4400 PCA BLVD, SUITE 600  
PALM BEACH GARDENS, FL 33410

PROJECT NAME  
**7-ELEVEN #11795 - OCALA, FL**  
9000 BLOCK OF SE MARICAMP ROAD  
OCALA, FL 34470

JOSE J. DIAZ-VELAZQUEZ  
LICENSE  
No. 78474  
STATE OF FLORIDA  
PROFESSIONAL ENGINEER

RELEASE	
PROJECT NO.	220085
DATE	12/17/2020
DRAWN	MS
CHECKED	JD

PROJECT NO.	220085
DATE	12/17/2020
DRAWN	MS
CHECKED	JD

CWP1.0