

DRAWING DESCRIPTION  
CANOPY STRUCTURAL  
NOTES AND PLANS

JOB LOCATION  
7-ELEVEN #41795  
MARCAMP RD & CEDAR RADIAL RD  
OCALA, FL

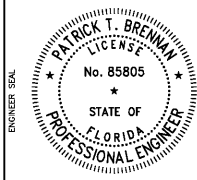

CUSTOMER: 7-ELEVEN, INC - CYPRESS WATERS  
REVISIONS  
NO. DESCRIPTION: DATE: BY:

D. CYPHERS  
DRAWN BY: P. BRENNAN  
CHECKED BY: 12-22-2020  
DATE:  
JOB NO. 20-3580R0  
DWG. NO. CS1  
OF 3 SHEETS

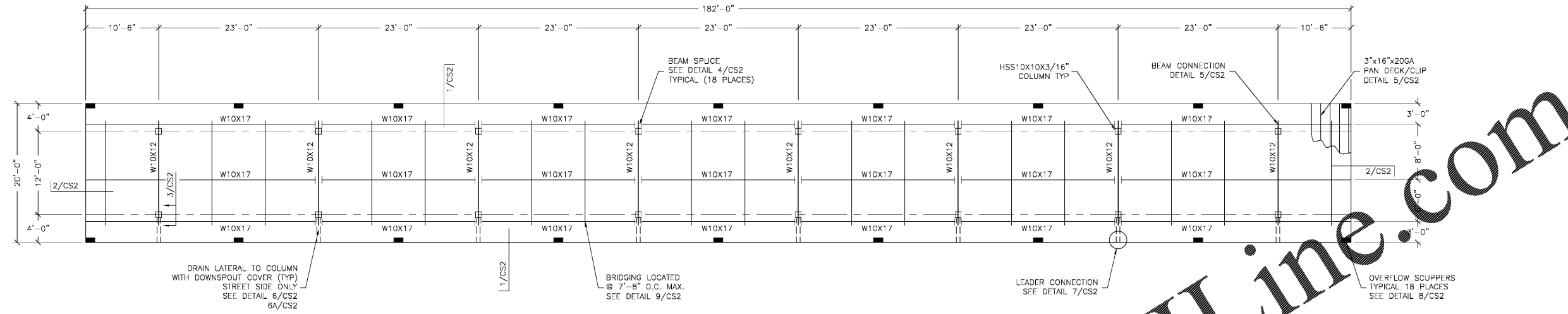

FRAMING PLAN  
SCALE: 1/8"=1'-0"

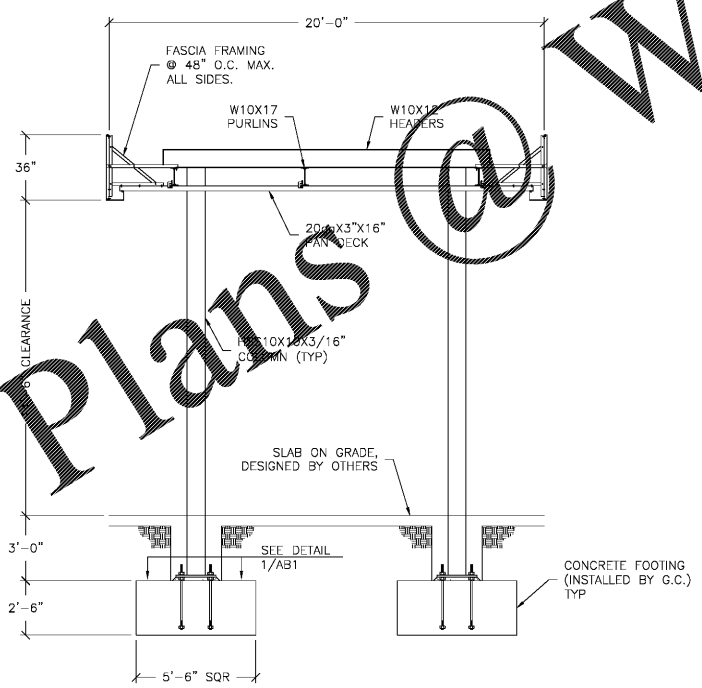

SECTION/ELEVATION  
SCALE: 1/4"=1'-0"

www.LDILine.com

**CANOPY NOTES**

GENERAL NOTES:  
A. THE CONTRACTOR SHALL VERIFY ALL CONDITIONS AND DIMENSIONS AT THE SITE.  
B. OBSERVATION VISITS TO THE SITE BY THE DESIGN ENGINEER SHALL NEITHER BE CONSIDERED AS INSPECTION NOR APPROVAL OF CONSTRUCTION.  
C. DURING AND AFTER CONSTRUCTION, BUILDER AND/OR OWNER SHALL KEEP LOADS ON THE STRUCTURE WITHIN LIMITS OF DESIGN LOADS.  
D. TYPICAL DETAILS AND SECTIONS SHALL APPLY WHERE SPECIFIC DETAILS ARE NOT SHOWN.

- BUILDING CODE: 2017 FLORIDA BUILDING CODE
- USE GROUP: M, CONSTRUCTION TYPE - IIB
- DESIGN LOADS:
  - A. ROOF LIVE LOAD: 20 PSF (REDUCIBLE)
  - B. CANOPY DEAD LOAD: 11.73 PSF
  - C. GROUND SNOW LOAD P<sub>g</sub>: 0 PSF
  - FLAT ROOF SNOW LOAD P<sub>f</sub>: 0 PSF
  - RAIN ON SNOW SURCHARGE: 0 PSF IF P<sub>g</sub><20
  - EXPOSURE FACTOR C<sub>e</sub>: 1.0
  - IMPORTANCE FACTOR I<sub>s</sub>: 1.0
  - THERMAL FACTOR C<sub>t</sub>: 1.2
- BASIC WIND SPEED V<sub>ult</sub>=140 MPH, V<sub>asd</sub>=108 MPH
- BUILDING RISK CATEGORY: II
- EXPOSURE: C
- COMPONENT & CLADDING: ASCE 7-10 CHAPTER 30
- ROOF DESIGN PRESSURES (PSF) C&C FIGURE 30.8-1
 

ZONE 3	ZONE 2	ZONE 1
56	53	56
56	53	38
		34
- EARTHQUAKE DESIGN:
  - IMPORTANCE FACTOR: 1.0
  - S<sub>s</sub>=0.080g
  - S<sub>1</sub>=0.042g
  - S<sub>0.1</sub>=0.057g
  - SITE CLASS: D
  - SEISMIC DESIGN CATEGORY: B
  - SEISMIC FORCE RESISTING SYSTEM: G.2 STEEL ORDINARY CANTILEVERED COLUMN SYSTEM
  - DESIGN BASE SHEAR: 2.92k
  - SEISMIC RESPONSE COEFFICIENT: C<sub>s</sub>=0.07
  - RESPONSE MODIFICATION FACTOR: R=1.25
  - SEISMIC ANALYSIS PROCEDURE: EQUIVALENT LATERAL FORCE

**SPECIAL INSPECTIONS FOR THE CANOPY**

- IN ADDITION TO THE REGULAR INSPECTIONS, THE FOLLOWING ITEMS, IF APPLICABLE, WILL REQUIRE SPECIAL INSPECTION IN ACCORDANCE WITH THE BUILDING CODE. JIMCO SALES AND MANUFACTURING IS AN AISC APPROVED FABRICATOR (218031061-10NIT).
- STRUCTURAL STEEL - SPECIAL INSPECTION REQUIRED IN ACCORDANCE WITH THE QUALITY ASSURANCE INSPECTION REQUIREMENTS OF AISC 360 (IBC 1705.2.1).
  - WELDING - SPECIAL INSPECTION IS NOT REQUIRED WHERE WELDING IS PERFORMED IN AN APPROVED FABRICATOR SHOP AS PER IBC 1704.2.5.1
  - CONCRETE - SPECIAL INSPECTION IS NOT REQUIRED FOR ISOLATED SPREAD CONCRETE FOOTINGS PER IBC 1705.3 EXCEPTION 1.
  - ANCHOR BOLTS - PERIODIC SPECIAL INSPECTION OF ANCHOR BOLT INSTALLATION REQUIRED PER IBC TABLE 1705.3.
  - HIGH STRENGTH BOLTS - IF REQUIRED, A325 BOLTS SHALL BE PRETENSIONED USING AN ACCEPTABLE METHOD SUCH AS "TURN OF NUT" AS PER RCSC SPECIFICATION SECTION 8.2. PERIODIC SPECIAL INSPECTION REQUIRED.

**SEISMIC FORCE RESISTING SYSTEM (SFRS)**

- REFER TO AISC 341-10 SECTION A4 AND ASCE 7-10.
- DESIGNATION OF SFRS: G.2, STEEL, ORDINARY CANTILEVER COLUMN SYSTEMS (ASCF 7-10 TABLE 12.2-1) SEE AISC 341-10 SECTION F5 (OCCS).
- R = 1.25, C<sub>s</sub> = 0.07
- ANALYSIS PROCEDURE = EQUIVALENT LATERAL FORCE
- MEMBERS AND CONNECTIONS THAT ARE PART OF THE SFRS:
  - COLUMNS
  - COLUMN BASE CONNECTION
  - FOOTINGS
- PROTECTED ZONES: N/A
- SEE DETAILS AND NOTE FOR CONNECTION CONFIGURATIONS, MATERIALS SPECIFICATIONS AND SIZES.
- WELD FILLER MATERIALS FOR WELDS PART OF THE SFRS:
  - YIELD STRENGTH - 58 KSI MIN
  - TENSILE STRENGTH - 70 KSI MIN
  - ELONGATION - 22% MIN
  - CVN TOUGHNESS - 20 FT-LB MIN @ 0° F
 SEE DETAILS AND NOTES FOR OTHER WELDING REQUIREMENTS
- DEMAND CRITICAL WELDS - N/A
- LOWEST ANTICIPATED SERVICE TEMPERATURE - 0° F

NOTICE: THIS DOCUMENT IS THE PROPERTY OF JIMCO SALES & MFG. NEITHER THIS DOCUMENT NOR ANY DATA OR INFORMATION HEREIN SHALL BE COPIED OR REPRODUCED IN ANY MANNER, LOANED OR OTHERWISE DISPOSED OF, OR USED FOR ANY PURPOSE WHATSOEVER, WITHOUT THE PRIOR WRITTEN PERMISSION OF JIMCO SALES & MFG. IF THIS DOCUMENT IS LOANED BY OR WITH THE AUTHORITY OF JIMCO SALES & MFG, THE BORROWER, INCONSIDERATION OF SUCH LOAN, AGREES TO THE FOREGOING CONDITIONS AND TO RETURN THIS DOCUMENT ON REQUEST OR UPON COMPLETION OF THE SPECIFICALLY AUTHORIZED WORK FOR WHICH IT WAS USED.