

SECTION 1
3/4" = 1'-0"
S202

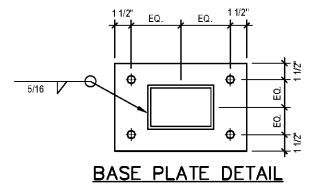

SECTION A
1 1/2" = 1'-0"
S202

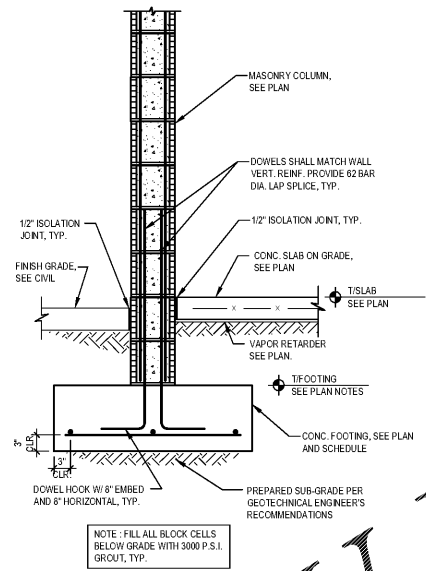

SECTION 2
3/4" = 1'-0"
S202

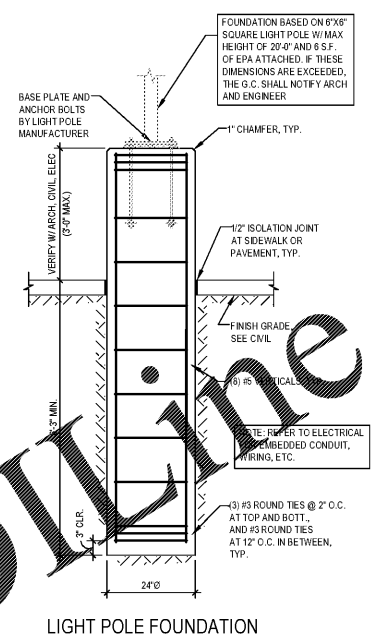

DETAIL 3
1/2" = 1'-0"
S202

Order Plans @ www.LDWline.com

HIGGENBOTHAM
Structural Engineers
3222 Corrine Drive, Suite F
Orlando, Florida 32833
Phone: 407 286 1787
Fax: 407 286 2281
FLORIDA, CA, NO. 28950

PROJECT NO.	2200355
DATE	12/17/2020
DRAWN	REE
CHECKED	JSC

RELEASE	

JUAN B. CANO, P.E.
FLORIDA LICENSE NO. 69377

PROJECT NAME
7-ELEVEN #11795 - OCALA, FL
9000 BLOCK OF SE MARICAMP ROAD
OCALA, FL 34470

CLIENT NAME
BLACKFIN PARTNERS INVESTMENTS, INC.
4440 PCA BLVD, SUITE 600
PALM BEACH GARDENS, FL 33410

SHEET TITLE
DETAILS

Cuhaci & Peterson
Architects Engineers Planners

1925 Prospect Ave.
Orlando, FL 32814
P (407) 661-9100
P (407) 661-9101
www.ep.com
Florida Corporate Certificate #AA 000626

S202