

1 SECTION @ TOWER
3/4" = 1'-0"

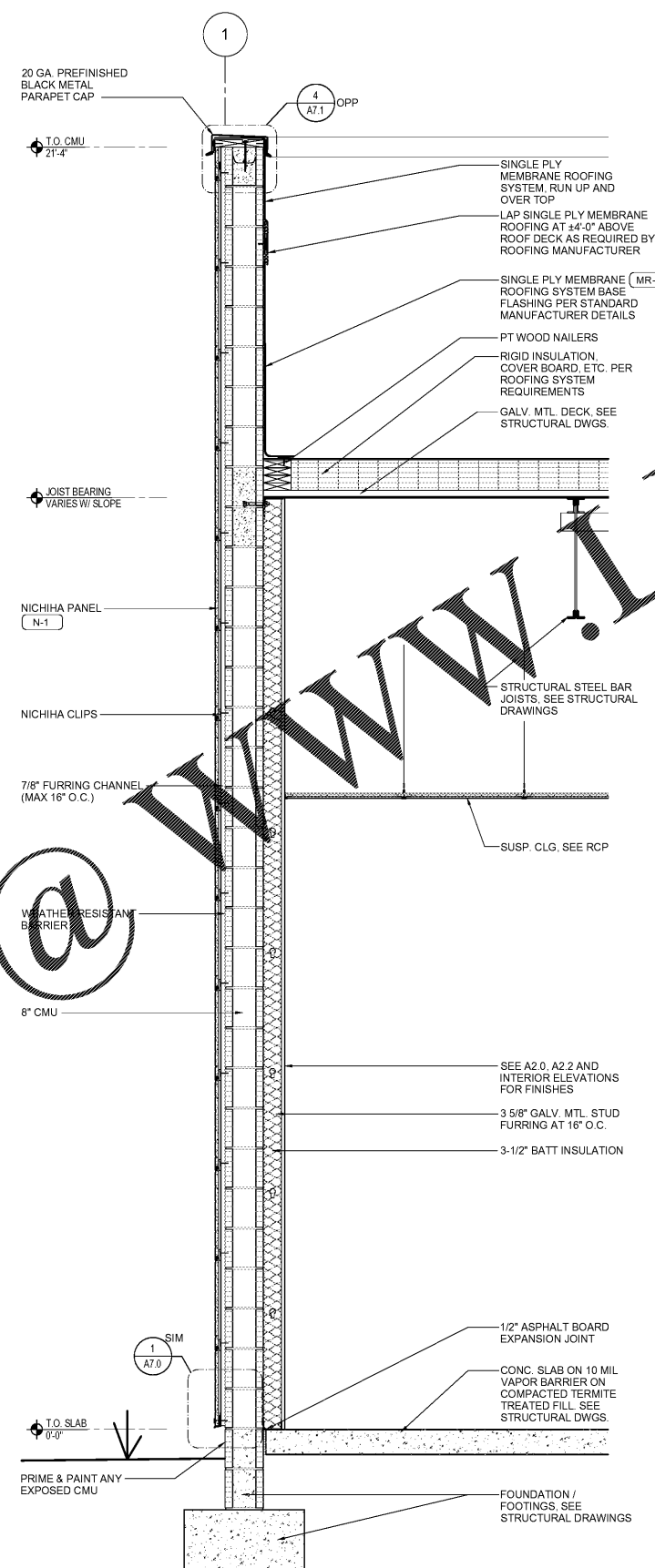

2 SECTION @ SIDE
3/4" = 1'-0"

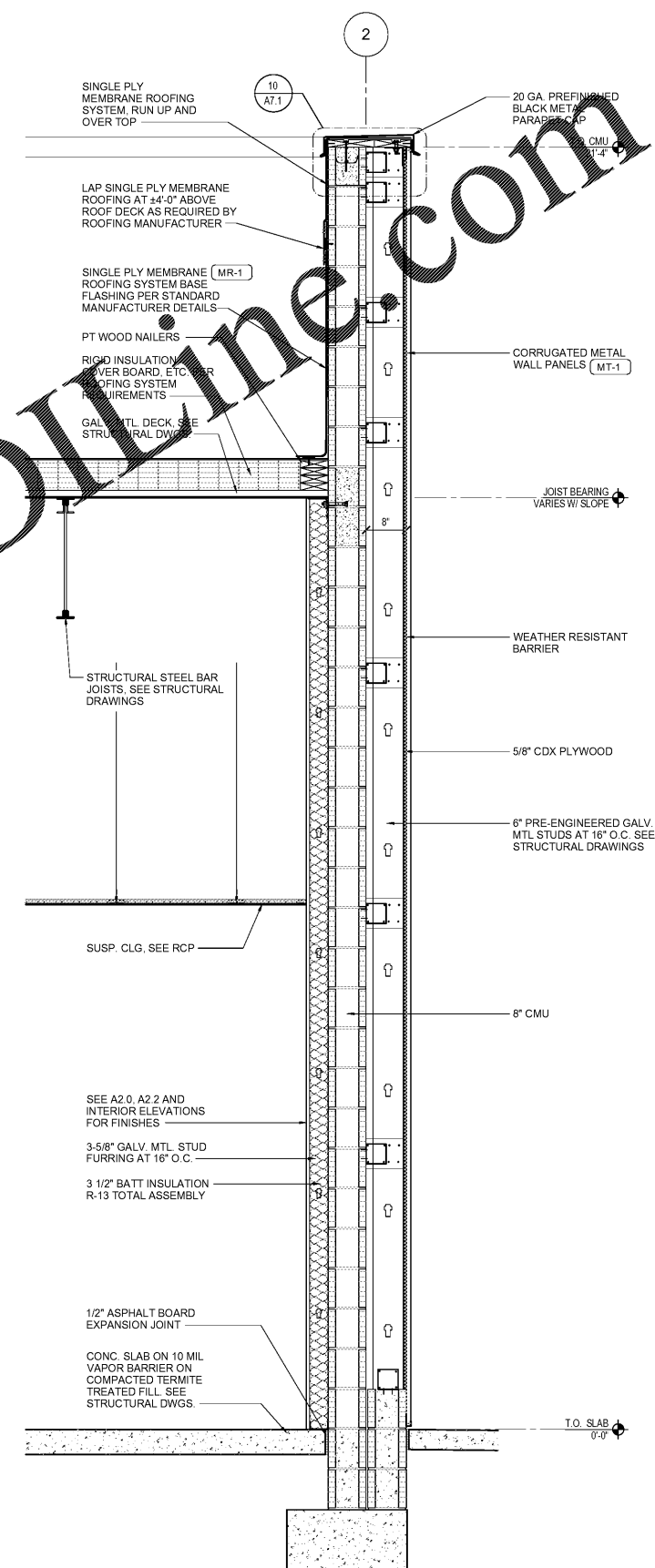

2 SECTION @ SIDE
3/4" = 1'-0"

Order Plans

www.lidline.com

1925 Prospect Ave.
Orlando, FL 32814
P (407) 661-9100
P (407) 661-9101
www.ep.com
Florida Corporate Certificate #AA 000626

4
Enhaci & Peterson
Architects Engineers Planners

CLIENT NAME
BLACKFIN PARTNERS INVESTMENTS, INC.
4400 PCA BLVD, SUITE 600
PALM BEACH GARDENS, FL 33410

PROJECT NAME
7-ELEVEN #1795 - OCALA, FL
9000 BLOCK OF SE MARICAMP ROAD
OCALA, FL 34470



PROJECT NO.	2200355
DATE	12/17/2020
DRAWN	JS
CHECKED	Peter Cruz

RELEASE	
---------	--

A4.2