

GENERAL NOTES	
1.	OSB IS NOT AN APPROVED CONSTRUCTION MATERIAL AND SHALL NOT BE SUBSTITUTED FOR FIRE TREATED PLYWOOD.
2.	ALWAYS WATERPROOF DEMISING WALLS IN WET AREAS, INCLUDING BEHIND COOLER/ FREEZER AND BEVERAGE COUNTER.
3.	ALL SUBSTRATES ARE TO EXTEND TO DECK, UNLESS NOTED OTHERWISE.
4.	PROVIDE FULL HEIGHT CORNER GUARDS AND "T" MOLDING AS REQUIRED AT ALL OUTSIDE CORNERS AND PANEL JOINTS. CORNER GUARDS SHOULD BE FOR MATERIAL FINISH SPECIFIED IN FINISH AND MATERIAL SCHEDULES.
5.	ALL INTERIOR FACE OF EXTERIOR CMU SIP PANEL WALLS TO BE COVERED WITH 1/2" GYPSUM BOARD FROM FLOOR TO ROOF DECK TO MEET FLAME SPREAD RATING. ATTACHED W/ 1" TYPE 'S' SCREWS @ 8" O.C. ALONG EDGES, @ 12" O.C. IN THE FIELD OF THE BOARD. JOINTS ORIENTED VERTICALLY AND STAGGERED ON OPPOSITE SIDES OF ASSEMBLY TO BOTTOM OF ROOF DECK.
6.	**ALL SUBSTRATES ARE TO BE APPLIED OVER AND IN ADDITION TO THE WALLBOARD REQUIRED FOR FIRE RATED WALL CONSTRUCTION DESCRIBED ON THIS SHEET.**

SIGNAGE	
SN1	MEN'S RESTROOM (REFERENCE A6.0)
SN2	WOMEN'S RESTROOM (REFERENCE A6.0)
SN3	EMPLOYEES ONLY
SN4	THIS DOOR IS TO REMAIN UNLOCKED WHEN BUILDING IS OCCUPIED. (NOTE: THE SIGN SHALL BE IN LETTERS 1 INCH HIGH ON A CONTRASTING BACKGROUND.)
SN5	TACTILE EXIT SIGN PER LOCAL AHJ.

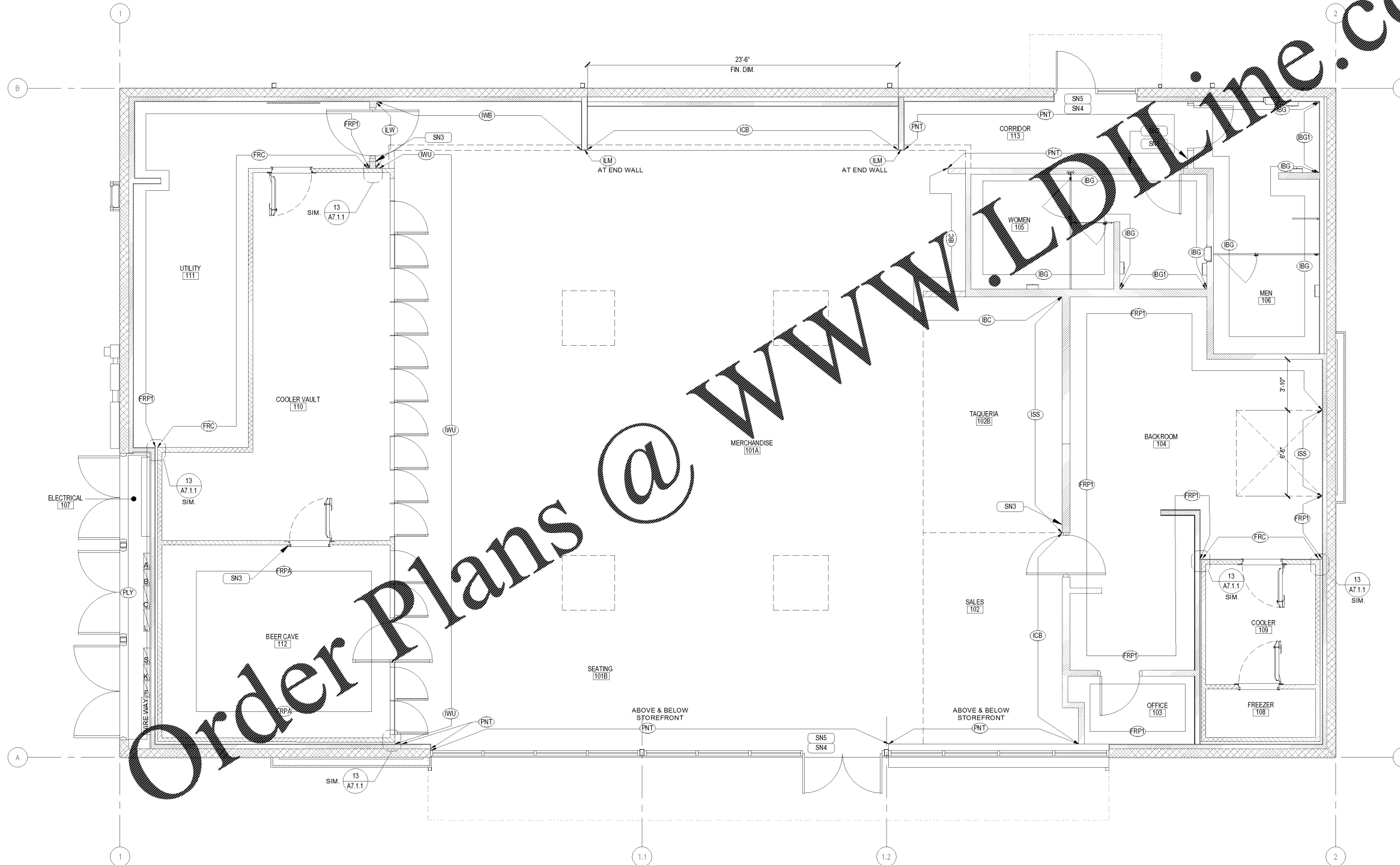

Order Plans @ www.LDOnline.com

1 WALL SUBSTRATE & WALL FINISH PLAN
1/4" = 1'-0"

<p>PROJECT NO. 220035</p> <p>DATE 12/17/2020</p> <p>DRAWN AL, ZJR</p> <p>CHECKED Pgt/LSR</p>	<p>CLIENT NAME BLACKFIN PARTNERS INVESTMENTS, INC. 4400 PCA BLVD, SUITE 600 PALM BEACH GARDENS, FL 33410</p> <p>PROJECT NAME 7-ELEVEN #1795 - OCALA, FL 9000 BLOCK OF SE MARICAMP ROAD OCALA, FL 34470</p>	<p>STATE OF FLORIDA BARON WADE ARBOLD REGISTERED ARCHITECT AR0016440</p>
<p>RELEASE</p>		
<p>WALL SUBSTRATE & WALL FINISH PLAN</p>		

Cuhaci & Peterson
 Architects Engineers Planners

1925 Prospect Ave.
Orlando, FL 32814
P (407) 661-9100
P (407) 661-9101
www.cp.com
Florida Corporate Certificate #AA 000626