

LARGE TREE PLANTING DETAIL
NOT TO SCALE LD.01

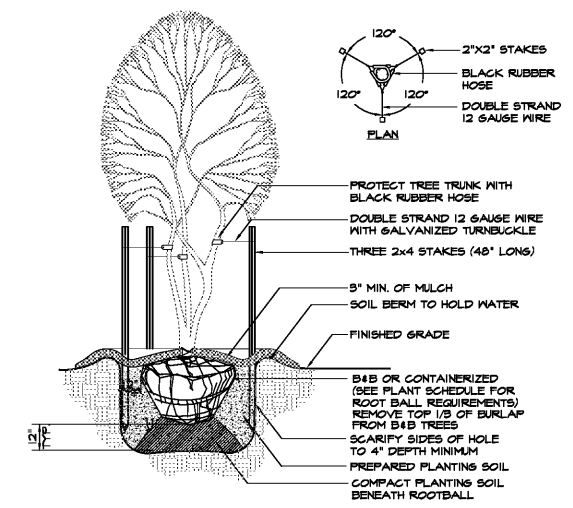

MULTI-STEM TREE PLANTING DETAIL
NOT TO SCALE LD.01

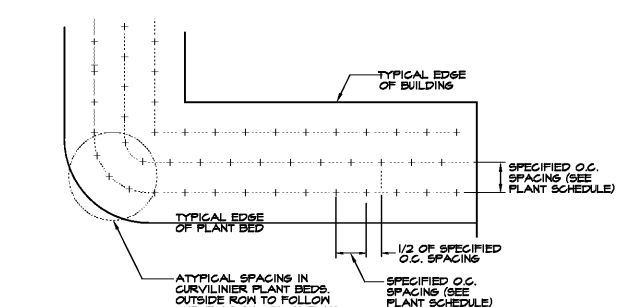

TYPICAL GROUND COVER SPACING DETAIL
NOT TO SCALE LD.01

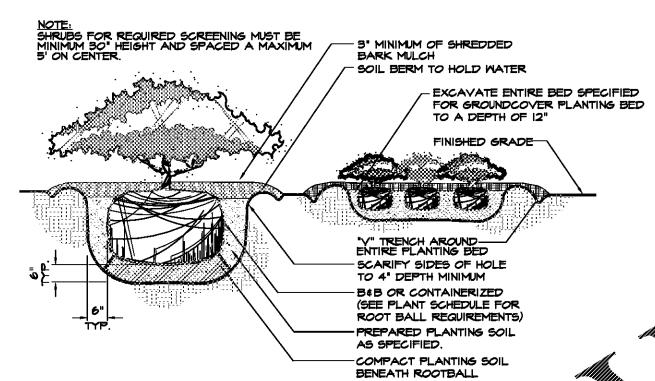

SHRUBS AND GROUND COVER PLANTING DETAIL
NOT TO SCALE LD.01

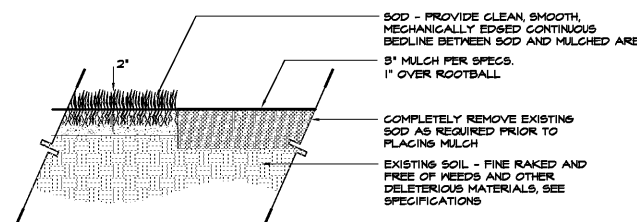

SOD PLACEMENT ADJ. TO MULCH
NOT TO SCALE LD.01

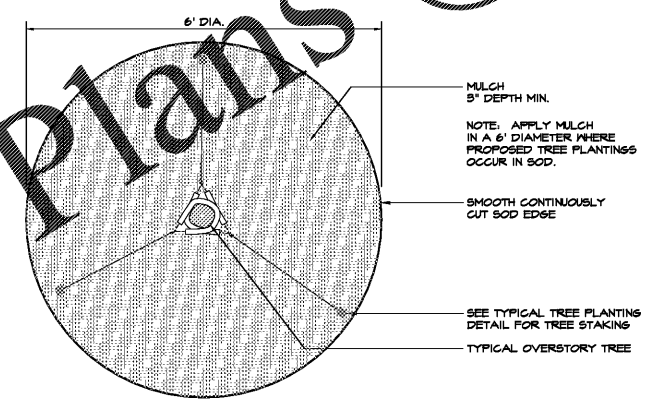

TYPICAL TREE MULCHING DETAIL IN SOD AREAS
NOT TO SCALE LD.01

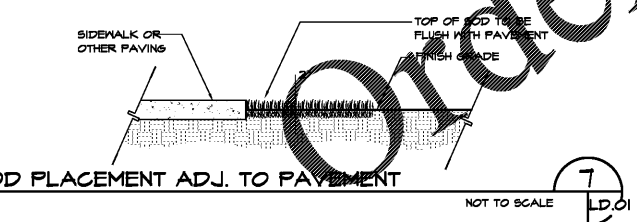

SOD PLACEMENT ADJ. TO PAVEMENT
NOT TO SCALE LD.01

GENERAL NOTES: (REFER TO SEPARATE SPECIFICATIONS SHEET FOR COMPLETE REQUIREMENTS)

- ALL PLANT MATERIAL SHALL BE FLORIDA GRADE NO. 1 OR BETTER AS SPECIFIED IN GRADES AND STANDARDS FOR NURSERY PLANTS, DIVISION OF PLANT INDUSTRY, FLORIDA DEPARTMENT OF AGRICULTURE AND CONSUMER SERVICES, AND SHALL CONFORM TO AMERICAN STANDARDS FOR NURSERY STOCK, AMERICAN NURSERY AND LANDSCAPE ASSOCIATION, LATEST EDITION.
- THE CONTRACTOR IS RESPONSIBLE FOR VERIFICATION OF QUANTITIES IN THE PLANT LIST. IN THE EVENT OF A CONFLICT BETWEEN QUANTITIES IN THE LIST AND THE PLANS, THE PLANS SHALL CONTROL AND THE DISCREPANCY SHALL BE BROUGHT TO THE ATTENTION OF THE LANDSCAPE ARCHITECT PRIOR TO BID. ANY DEVIATION FROM THESE PLANS MUST BE APPROVED BY THE LANDSCAPE ARCHITECT OR OWNER'S REPRESENTATIVE.
- THE CONTRACTOR IS RESPONSIBLE FOR COMPLIANCE WITH ALL APPLICABLE BUILDING CODES, ORDINANCES AND LOCAL REGULATIONS, AND IS RESPONSIBLE FOR OBTAINING ALL PERMITS REQUIRED FOR THE WORK.
- ALL LANDSCAPE INSTALLATION/ MAINTENANCE PROFESSIONALS SHALL BE LICENSED AND CERTIFIED IN ACCORDANCE WITH STATE AND LOCAL REQUIREMENTS.
- THE CONTRACTOR SHALL EXAMINE EXISTING SITE CONDITIONS AND PROMPTLY REPORT ALL DISCREPANCIES AND UNSUITABLE CONDITIONS (WEEDS, MUCK, DEBRIS, OBSTRUCTIONS, ETC.) TO THE LANDSCAPE ARCHITECT PRIOR TO BIDDING. THE CONTRACTOR IS RESPONSIBLE FOR SOIL ANALYSIS PRIOR TO INSTALLATION OF PLANTINGS, AND SHALL ENSURE ALL SOIL AMENDMENTS CONFORM TO SPECIFICATIONS.
- THE CONTRACTOR SHALL ACQUAINT HIMSELF WITH THE SITE AND ALL UTILITIES, (INCLUDING WATER, SEWER AND ELECTRICAL SUPPLY). THE CONTRACTOR SHALL CALL FLORIDA SUNSHINE 811 AND AREA UTILITIES NOT LISTED ON THE LOCATE TICKET. THE EXACT LOCATION OF ALL EXISTING ABOVE GROUND AND UNDERGROUND STRUCTURES, UTILITIES, SPRINKLERS AND PIPE MAY NOT BE INDICATED ON DRAWINGS. THE CONTRACTOR SHALL CONDUCT HIS WORK IN A MANNER TO PROTECT AND PREVENT INTERRUPTION OR DAMAGE TO EXISTING SYSTEMS AND UTILITY SERVICES WHICH MUST REMAIN OPERATIONAL. THE CONTRACTOR IS RESPONSIBLE FOR THEIR REPLACEMENT IF DAMAGED BY HIM AT NO ADDITIONAL COST TO THE OWNER.
- CONTRACTOR SHALL PROTECT EXISTING TREES TO REMAIN, AND IS RESPONSIBLE FOR THEIR COMPARABLE REPLACEMENT IF DAMAGED BY HIM AT NO ADDITIONAL COST TO THE OWNER.
- ALL TREE MATERIAL SHALL BE CONTAINER GROWN UNLESS OTHERWISE SPECIFIED.
- SOIL PROVIDED SHALL BE FREE OF LIMESTONE, PEBBLES OR OTHER CONSTRUCTION DEBRIS.
- ALL PLANTING BEDS SHALL RECEIVE A 3\"/>

SITE TREE REQUIREMENTS:
 SITE: 1.58 AC (68,127 S.F.)
 SITE TREE REQUIREMENT: 11 SOLO 22 SHADE TREES PROVIDED; 0 EMERGING SHADE TREES 24 FRUITED
 TYPE 'C' BUFFER REQUIREMENT:
 -15' WIDE
 -2 CANOPY TREES AND 3 UNDERSTORY TREES PER 100 L.F. ON AVERAGE, 50% PLANTED WITH SHRUBS / GROUNDCOVER.
 RETENTION AREA BUFFER:
 RETENTION AREA BUFFER REQUIREMENT:
 4 CANOPY TREES AND 200 S.F. OF PLANTINGS PER 100 L.F.
 91 L.F. / 100 = 0.91 X 4 = 4 CANOPY TREES
 0.91 X 200 S.F. = 182 S.F.
 PROVIDED:
 CANOPY TREES: 5 CANOPY TREES AND 9 UNDERSTORY CONTINUOUS HEDGE
 PLANTING AREA = 2,774 S.F.

PLANT SCHEDULE

TREES	QTY	BOTANICAL NAME	COMMON NAME	REMARKS	NATIVE
ED/45	3	<i>Elaeocarpus decipiens</i>	Japanese Blueberry Tree	RP6 or 45 gal., 8'-10' ht. x 3.5'-4.5' sprd.	NO
LIM/30	6	<i>Lagerstroemia Indica 'Muskogee'</i>	Lavender Crape Myrtle	RP6 or 30 gal., 6'-7' x 3'-4', Multi-Trunk, 5 Canes	NO
QV/3'	7	<i>Quercus virginiana</i>	Southern Live Oak	RP6 or 65 gal., 12'-14' x 5'-6', 3 1/2" cal. min.	YES
TD/3'	10	<i>Taxodium distichum</i>	Bald Cypress	RP6 or 65 gal., 12'-14' ht. 3'-4' spr. 3 1/2" cal. min.	YES
UP/3'	7	<i>Ulmus parvifolia 'Emer II'</i>	'Emer II' Alleé Elm	RP6 or 65 gal., 12'-14' ht. x 5'-6' sprd., 3 1/2" cal. min.	YES
SHRUB AREAS	QTY	BOTANICAL NAME	COMMON NAME	REMARKS	NATIVE
HPC/3	48	<i>Hamella patens 'Compacta'</i>	Dwarf Scarlet Bush	3 gal., 15"-18" ht., 15"-18" spr. 30" o.c.	YES
IV/3	35	<i>Ilex vomitoria 'Nana'</i>	Dwarf Yaupon	3 gal., 12"-15" ht., 12"-15" spr. 30" o.c.	YES
MC/3	117	<i>Muhlenbergia capillaris</i>	Pink Muhly	3 gal., 15"-18" ht., 10"-13" spr., 30" o.c.	YES
PM/3	143	<i>Fodocarpus macrophyllus</i>	Yew Pine	3 gal., 18"-20" x 15"-18" full, 24" o.c.	NO
RI/3	247	<i>Raphiolepis Indica 'Alba'</i>	White Indian Hawthorn	3 gal., 15"-18" ht., 10"-13" spr., 30" o.c.	NO
TF/3	269	<i>Tripsacum dactyloides</i>	Fakahatchee Grass	3 GAL., 20"-24" X 16"-20", 36" o.c.	YES
VOV/3	65	<i>Viburnum obovatum 'Whorled Glass'</i>	Dwarf Walter's Viburnum	3 gal., 16"-18" x 16"-18", 30" o.c.	YES
GROUND COVERS	QTY	BOTANICAL NAME	COMMON NAME	REMARKS	NATIVE
LEG/1	99	<i>Liriope muscari 'Emerald Goddess'</i>	Liriope	1 gal., 5-6 ppp, 18" o.c.	NO
SOD / MISC.	QTY	BOTANICAL NAME	COMMON NAME	REMARKS	NATIVE
SOD	T.B.D.	<i>Paspalum notatum</i>	Argentine Bahia	Solid, palletted sod	
MULCH	T.B.D.	Pine Straw	Pine Straw	5-6" thick layer	

THE CONTRACTOR IS RESPONSIBLE FOR VERIFICATION OF QUANTITIES IN THE PLANT LIST. IN THE EVENT OF A CONFLICT BETWEEN QUANTITIES IN THE LIST AND THE PLANS, THE PLANS SHALL CONTROL AND THE DISCREPANCY SHALL BE BROUGHT TO THE ATTENTION OF THE LANDSCAPE ARCHITECT PRIOR TO BID. ANY DEVIATION FROM THESE PLANS MUST BE APPROVED BY THE LANDSCAPE ARCHITECT OR OWNER'S REPRESENTATIVE.

MARION COUNTY CODE REQUIREMENTS
 NOTE: ALL LANDSCAPE INSTALLATION AND MAINTENANCE SHALL BE IN ACCORDANCE WITH MARION COUNTY LAND DEVELOPMENT CODE, ARTICLE 6, DIVISION 8, LANDSCAPING
https://www.municode.com/library/1/marion_county

NATIVE PLANT CALCULATIONS
 TOTAL PLANTS (TREES/SHRUBS/GROUNDCOVER): 1,056
 TOTAL NATIVE PLANTS (TREES/SHRUBS/GROUNDCOVER): 558 (53% NATIVE)

LANDSCAPE COMPLETION INSPECTION REQUIREMENTS

- PRIOR TO THE ISSUANCE OF A CERTIFICATE OF OCCUPANCY, THE CONTRACTOR SHALL DOCUMENT THE ACTUAL FIELD INSTALLATION OF THE LANDSCAPE AND SUBMIT TO MARION COUNTY A REQUIRED LANDSCAPE AS-BUILT CERTIFICATION PLAN, SIGNED AND SEALED BY THE LANDSCAPE ARCHITECT (MARION COUNTY LDC DIV. 9, SEC. 6.8.12).
- UPON COMPLETION OF THE INSTALLATION, AND AT A MINIMUM OF SEVEN (7) DAYS PRIOR TO FINAL INSPECTION, THE CONTRACTOR SHALL PROVIDE A CLEAR AND LEGIBLE AS-BUILT DIAGRAM THAT ACCURATELY REPRESENTS THE LANDSCAPE PLAN AS INSTALLED, AND REQUEST AN ON-SITE INSPECTION BY THE LANDSCAPE ARCHITECT.
- WHEN ACCEPTABLE TO THE LANDSCAPE ARCHITECT, THE AS-BUILT PLANS WILL BE APPROVED AND A FINAL INSPECTION AND LANDSCAPE RELEASE GRANTED.

THE CONTRACTOR SHALL MARK-UP A COPY OF THE APPROVED LANDSCAPE DESIGN PLAN WITH THE FOLLOWING AS-BUILT INFORMATION: (NOTE: PRE-APPROVAL BY THE DESIGN PROFESSIONAL IS REQUIRED FOR ANY DESIGN CHANGE (INCLUDING PLANT SUBSTITUTIONS, LAYOUT, QUANTITIES, MATERIALS, ETC.))

- INSTALLED PLANT SPECIES AND SIZES
- INSTALLED PLANT QUANTITIES
- OTHER INSTALLED MATERIALS DOCUMENTATION

THE CONTRACTOR SHALL PROVIDE CONFIRMATION THAT THE OWNER HAS RECEIVED WRITTEN MAINTENANCE, PRUNING, AND FERTILIZER INSTRUCTIONS AND SCHEDULE.

NO.	DATE	DESCRIPTION	CHK BY
	11/19/20	REVISIONS PER COUNTY COMMENTS / SITE CHANGES	JHS

7-ELEVEN MARICAMP RD
 MARION COUNTY, FLORIDA
PERMIT PLANS
 PREPARED FOR: MASTROSERIO ENG

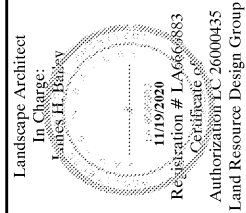

DATE: 08-24-20
 PROJECT NO.: MAS020-03.01
 DRAWN BY: JWS / JHB
 DESIGNED BY: JWS
 CHECKED BY: JHB

SHEET NO.
LD.01