

RELEASED FOR CONSTRUCTION

REVISIONS:

CIVIL CONSTRUCTION PLANS FOR
PIPE MAKER'S CANAL IMPROVEMENTS
LOCATED IN POOLER, GA
PREPARED FOR CITY OF POOLER

JOB NUMBER: 20-265
DATE: 06/05/20
DRAWN BY: RAR
CHECKED BY: TGB
SCALE: AS NOTED

FINAL EROSION CONTROL

SHEET:
ES7.5

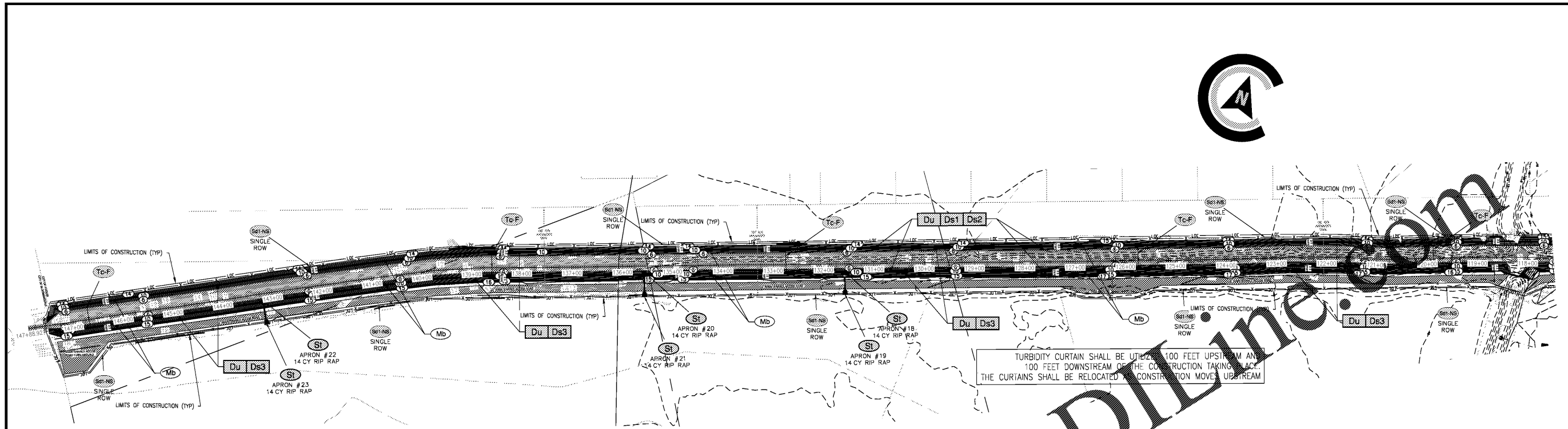

TURBIDITY CURTAIN SHALL BE UTILIZED 100 FEET UPSTREAM AND 100 FEET DOWNSTREAM OF THE CONSTRUCTION TAKING PLACE. THE CURTAINS SHALL BE RELOCATED AS CONSTRUCTION MOVES UPSTREAM.

RIP RAP APRON DESIGN Date: 1/06/2020
PIPEMAKER'S CANAL CCI#: 20-265.000

APRON	D ft.	V ft/s	Q cfs	L ft.	D in.	W ft.	H in.
FES#13	2.00	7.95	73.04	21.00	10.00	24.50	15.00
FES#14	2.00	7.95	73.04	21.00	10.00	24.50	15.00
FES#15	2.50	8.81	247.20	21.00	12.00	24.50	18.00
FES#16	2.50	8.81	247.20	21.00	12.00	24.50	18.00
FES#17	1.50	3.26	21.90	21.00	6.00	24.50	9.00
FES#18	1.50	4.94	38.28	21.00	9.00	24.50	13.50
FES#19	1.50	4.94	38.28	21.00	9.00	24.50	13.50
FES#20	1.50	3.05	10.42	21.00	6.00	24.50	9.00
FES#21	1.50	3.05	10.42	21.00	6.00	24.50	9.00
FES#22	1.50	4.84	35.18	21.00	9.00	24.50	13.50
FES#23	1.50	4.84	35.18	21.00	9.00	24.50	13.50

TEMPORARY SEDIMENT STORAGE REQUIREMENTS - DS 1
DISTURBED AREA: 18.31 AC.
REQUIRED STORAGE: 18.31 AC. X 67 C.Y./AC. = 1,227 C.Y. = 33,123 C.F.
SEDIMENT STORAGE AGAINST SILT FENCE
 $1/2(3.5')(1.5') = 2.63 S.F. \times 23,638 L.F. = 62,168 C.F.$
THE ADDITIONAL STORAGE SHALL BE PROVIDED BY THE TURBIDITY CURTAIN INSTALLED IN THE CHANNEL.
62,168 C.F. > 33,123 C.F. THEREFORE ADEQUATE STORAGE IS PROVIDED WITH THE USE OF SILT FENCE & TURBIDITY CURTAIN.

- SEQUENCE OF CONSTRUCTION**
- INITIAL PHASE:**
- INSTALL PERIMETER CONTROLS TO INCLUDE SILT FENCING AND CONSTRUCTION EXIT.
 - REMOVE DESIGNATED TREES AND CLEAR, GRUB AND GRADE SITE.
 - LIMIT CLEARING AND GRUBBING OF SITE TO ONLY AREAS NECESSARY FOR CONSTRUCTION AS SHOWN.
- INTERMEDIATE PHASE:**
- INSTALL TURBIDITY CURTAINS UPSTREAM AND DOWNSTREAM PRIOR TO CONSTRUCTION.
 - GRADE SITE TO FINAL ELEVATIONS AND INSTALL SLOPE STABILIZATION MATTING.
 - INSTALL STORM STRUCTURES AND PIPING.
 - INSTALL STONE RIP-RAP AT STORM PIPE FLARED END SECTIONS.
- FINAL PHASE:**
- STABILIZE ALL REMAINING DISTURBED AREAS.
 - REMOVE ALL TEMPORARY EROSION CONTROL MEASURES AND STABILIZE DISTURBED AREAS ACCORDINGLY.

NRCS ORIGINAL SUBMITTAL: 10/17/2020

DESIGN PROFESSIONAL'S CREDENTIALS:
ENGINEER'S NAME (PRINTED): TRAVIS BURKE, PE
GEORGIA PE NUMBER: 31215
GSWCC LEVEL II CERTIFICATION NUMBER: 8134

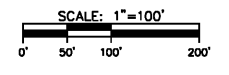

Order Plans @ www.LDiline.com