

CONSTRUCTION NOTES

1. REFER TO A6.1 FOR DOOR INFORMATION & STOREFRONT DIMENSIONS.
2. ALL DIMENSIONS ARE TO FACE OF FRAMING (STUD WALL) OR CENTERLINE OF STRUCTURE UNLESS NOTES OTHERWISE.
3. SEE STRUCTURAL SHEETS FOR ALL STUD FRAMING CONFIGURATIONS, SIZES, SPACING AND GAUGES.
4. ALL EXTERIOR WOOD BLOCKING TO BE MOISTURE RESISTANT PRESERVATIVE TREATED (P.T.).
5. TAPE SEALANT AT ALL ANCHOR LOCATIONS.
6. ALL FLASHING AND SEAMS BETWEEN SHEATHING IN COMPOSITE WOOD STUD WALL CONSTRUCTION CONDITIONS TO BE TAPED AND SEALED WITH TAPE SEALANT.
7. LAP ALL WEATHER RESISTANT BARRIERS AND THRU-WALL FLASHING IN A WATER SHEDDING FASHION. TAPE ALL EXPOSED EDGES.
8. EXTEND ALL THRU-WALL FLASHING TO 1/4 INCH PAST THE EXTERIOR FACE OF WALL.
9. PROVIDE CONTINUOUS ANCHORAGE FOR ALL THRU-WALL FLASHING.
10. EXTEND FLASHING VERTICALLY A MINIMUM OF 8 INCHES ABOVE THE BASE OF THE FLASHING.
11. APPLY SEALANT TO ALL SHEATHING JOINTS AND FASTENER PENETRATIONS.
12. PROVIDE FULLY ADHERED FLASHING AT ALL WINDOW AND DOOR OPENING HEADS, SILLS AND JAMBS.

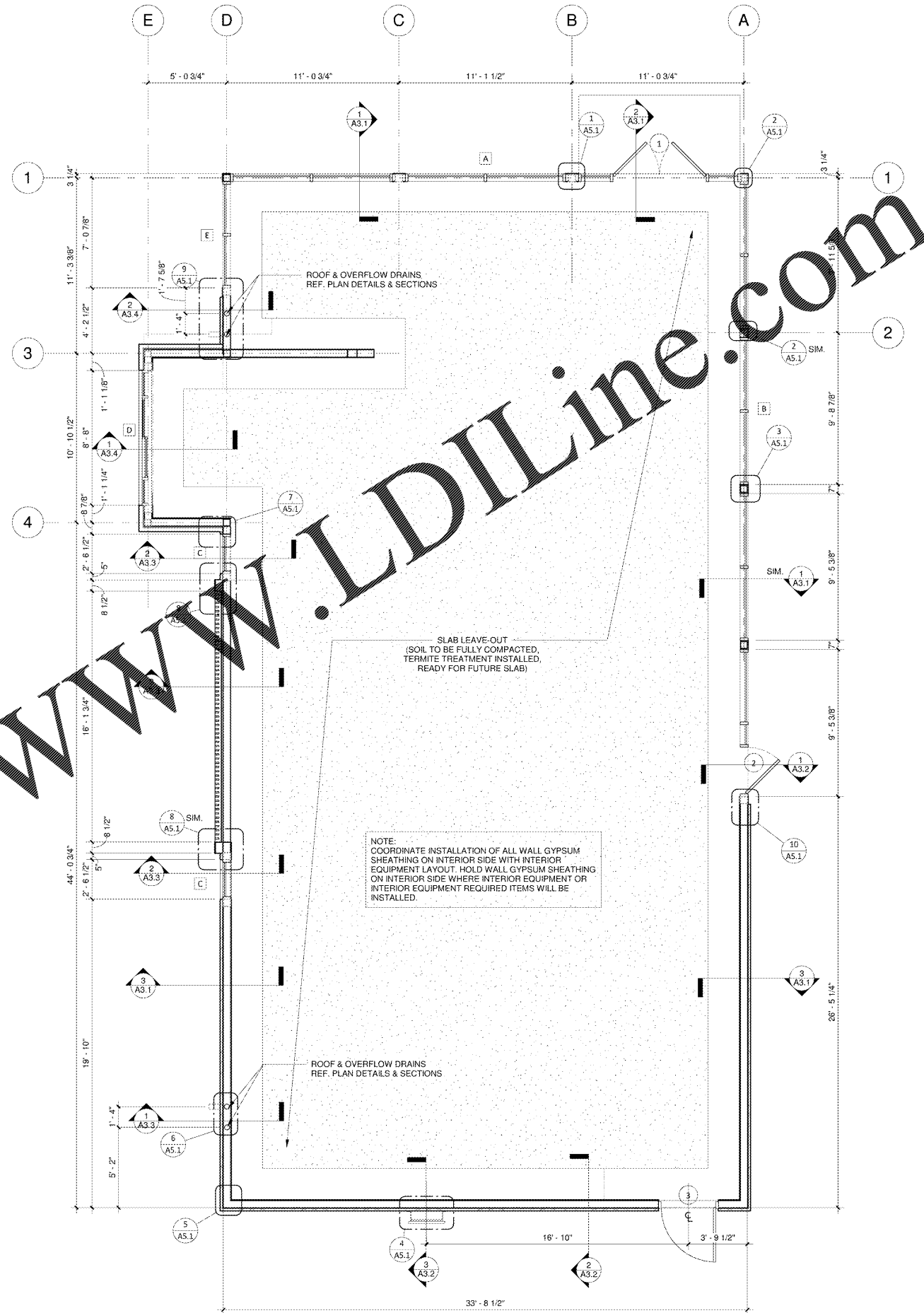

1 FLOOR PLAN
1/4" = 1'-0"

Order Plans @ www.LDILine.com



CHIPOTLE AT CARTERSVILLE
405 E. MAIN STREET
CARTERSVILLE, GA. 30121

REVISIONS

SHEET TITLE
FLOOR PLAN

DATE
12/30/20

PROJECT NUMBER
19303

SHEET NUMBER
A1.1