

GENERAL EROSION CONTROL NOTES

- CONTRACTOR IS TO ADHERE TO THE CITY OF CARTERSVILLE EROSION AND SEDIMENT CONTROL REGULATIONS, AND TO THE SPECIFIC REQUIREMENTS FOR THE STATE OF GEORGIA.
- CONTRACTOR SHALL BE RESPONSIBLE FOR OBTAINING NECESSARY PERMITS PRIOR TO ANY LAND DISTURBING ACTIVITY, AND SHALL KEEP COPIES OF SUCH PERMITS ON-SITE AT ALL TIMES IN THE CONSTRUCTION TRAILER. CONTRACTOR SHALL BE RESPONSIBLE FOR COMPLIANCE WITH NPDES PERMIT REQUIREMENTS.
- CONTRACTOR IS RESPONSIBLE FOR COORDINATING WITH OWNER TO ENSURE IMPLEMENTATION OF ANY MONITORING PROGRAM IN ACCORDANCE WITH STATE SPECIFIC REQUIREMENTS.
- THE CONTRACTOR IS RESPONSIBLE DURING CONSTRUCTION FOR THE CONTINUOUS MAINTENANCE OF ALL EROSION CONTROL MEASURES AS CALLED FOR ON THE APPROVED PLANS AND SPECIFICATIONS.
- CONTRACTOR SHALL CERTIFY THAT ALL FILL AREAS HAVE BEEN COMPACTED TO A MINIMUM 95% COMPACTION.
- CONTRACTOR SHALL PROVIDE NECESSARY MEANS TO PREVENT AIRBORNE EROSION INCLUDING MULCHES, SPRAY-ON ADHESIVES, OR SURFACE IRRIGATION.
- CONTRACTOR SHALL REMOVE TEMPORARY BMPs AT THE END OF THE PROJECT AFTER THE SITE IS FULLY STABILIZED AND A NOTICE OF TERMINATION HAS BEEN FILED.
- CONTRACTOR SHALL SELECT TEMPORARY STOCKPILE LOCATION FOR SEDIMENT POND TO BE HELD TEMPORARILY IF NECESSARY AND TO ENSURE PROPER EROSION CONTROL FOR STOCKPILE.
- EROSION CONTROL PRACTICES SUCH AS SILT FENCE, SEGMENTED FENTON TRENCHES AND CONSTRUCTION EXITS SHALL BE INSTALLED PRIOR TO ANY OTHER CONSTRUCTION ON-SITE.
- ALL GRADED AREAS SHALL BE STABILIZED IMMEDIATELY WITH A TEMPORARY COVER OR MULCH.
- SILT FENCE SHALL BE LOCATED ON-SITE TO PREVENT SEDIMENT AND SILT FROM LEAVING THE PROPERTY LIMITS. ALL SILT FENCE SHALL BE MAINTAINED CONTINUOUSLY BY THE CONTRACTOR DURING CONSTRUCTION.
- SILT FENCE SHALL BE CLEANED OR REPLACED WHEN IT IS UP TO WITHIN ONE FOOT OF TOP OF SILT FENCE.
- ALL CUT AND FILL SLOPES MUST BE SURFACE STABILIZED WITHIN SEVEN (7) DAYS OF THEIR CONSTRUCTION.
- ALL SLOPES THAT EXCEED EIGHT (8) VERTICAL TO ONE (1) HORIZONTAL SHALL BE STABILIZED BY THE CONTRACTOR WITH SYNTHETIC OR VEGETATIVE MATS, IN ADDITION TO GRASSING/VEGETATION.
- EROSION CONTROL DEVICES SHALL BE MAINTAINED UNTIL ALL CONSTRUCTION IS COMPLETE AND UNTIL PERMANENT GROUND COVER HAS BEEN ESTABLISHED AND A NOTICE OF TERMINATION HAS BEEN SUBMITTED TO THE APPROPRIATE AUTHORITY.
- MAXIMUM PERCENTAGE OF COVER SHALL BE AS FOLLOWS:
CUT AREA: 2.1% (SEE NOTE)
FILL AREA: 2.1% (SEE NOTE)
UNLESS OTHERWISE SPECIFIED OR APPROVED BY SOILS ENGINEER.
- SEEK FOR GRASSED SLOPED AREAS USE BOTH TALL PERENNIAL GRASS AT 30-40 POUNDS PER ACRE AND CLEAN, COMBINE-RUN VEGTATION AT 10-15 POUNDS PER ACRE.
- ALL SEDIMENT AND EROSION CONTROL DEVICES SHALL BE MAINTAINED UNTIL FINAL STABILIZATION AND A NOTICE OF TERMINATION HAS BEEN FILED.
- STABILIZATION MEASURES SHALL BE IMPLEMENTED AS SOON AS IS PRACTICAL. IN PORTIONS OF THE SITE WHERE CONSTRUCTION ACTIVITIES HAVE TEMPORARILY OR PERMANENTLY CEASED, BUT IN NO CASE, MORE THAN FORTY (40) DAYS AFTER THE CONSTRUCTION ACTIVITY IN THAT PORTION OF THE SITE HAS TEMPORARILY OR PERMANENTLY CEASED, UNLESS ACTIVITY WITHIN THAT PORTION OF THE SITE WILL RESUME WITHIN TWENTY-ONE DAYS.
- CONTRACTOR SHALL TAKE ALL MEANS TO DIRECT RUNOFF TO SEDIMENT BASINS PRIOR TO LEAVING THE SITE.
- STRIPPING OF VEGETATION, GRADING, AND OTHER DEVELOPMENT ACTIVITIES SHALL BE CONDUCTED IN SUCH A MANNER SO AS TO MINIMIZE EROSION.
- ADEQUATE PROVISION SHALL BE PROVIDED TO MINIMIZE DAMAGE FROM SURFACE WATER TO THE CUT FACE OF EXCAVATIONS OR THE SLOPING SURFACES OF FILLS. ALL GRADED AREAS SHALL BE STABILIZED IMMEDIATELY WITH A TEMPORARY COVER OF MULCH.
- CONTRACTOR SHALL TAKE NECESSARY PRECAUTION SO THAT CUTS AND FILLS SHALL NOT ENDEANGER ADJACENT PROPERTY.
- FILLS SHALL NOT ENCRUCH UPON NATURAL WATERWAYS OR CONSTRUCTED CHANNELS IN A MANNER SO AS TO ADVERSELY AFFECT OTHER DOWNSTREAM PROPERTY OWNERS.
- ALL GRADING EQUIPMENT SHALL CROSS FLOWING STREAMS BY THE MEANS OF APPROVED AND PERMITTED STREAM CROSSINGS UTILIZING BRIDGES OR CULVERTS. ALL SUCH CROSSINGS SHALL BE KEPT TO A MINIMUM.
- PROVISIONS SHALL BE MADE FOR TREATMENT OR CONTROL OF ANY SOURCE OF SEDIMENTS AND ADEQUATE SEDIMENTATION CONTROL FACILITIES TO RETAIN SEDIMENTS ON-SITE OR PRECLUDE SEDIMENTATION OF ADJACENT WATERS.
- CONTRACTOR SHALL NOT BE PERMITTED TO PLACE ANY FILL MATERIAL INTO AREAS DESIGNATED AS WETLAND BY THE U.S. ARMY CORPS OF ENGINEERS UNLESS SPECIFIC PERMITS FOR SUCH FILL HAVE BEEN OBTAINED.
- EACH DAY WHEN ANY TYPE OF CONSTRUCTION ACTIVITY HAS TAKEN PLACE AT THE CONSTRUCTION SITE, THE CONTRACTOR SHALL PROVIDE CERTIFIED PERSONNEL TO INSPECT: (A) ALL AREAS AT THE SITE WHERE PETROLEUM PRODUCTS ARE STORED, USED, OR HANDLED FROM VEHICLES AND LEAKS FROM VEHICLES AND EQUIPMENT LOCATIONS AT THE SITE WHERE VEHICLES ENTER OR EXIT THE SITE FOR EVIDENCE OF OFF-SITE SEDIMENT TRACKING, AND (C) MEASURE RAINFALL ONCE EACH TWENTY-FOUR HOUR PERIOD AT THE SITE. THESE INSPECTIONS MUST BE CONDUCTED UNTIL FINAL STABILIZATION. REPORT OF THESE INSPECTIONS SHOULD BE SENT VIA U.S. MAIL TO THE OWNER AND TO THE ARCHITECT.
- CERTIFIED PERSONNEL (PROVIDED BY THE CONTRACTOR) SHALL INSPECT AT LEAST ONCE EVERY SEVEN (7) CALENDAR DAYS AND WITHIN 24 HOURS OF THE END OF A STORM THAT IS 0.5 INCHES OR GREATER THE FOLLOWING: (A) DISTURBED AREAS OF THE CONSTRUCTION SITE THAT HAVE NOT UNDERGONE FINAL STABILIZATION; (B) ALL AREAS USED FOR THE STORAGE OF MATERIALS THAT ARE EXPOSED TO PRECIPITATION THAT HAVE NOT UNDERGONE FINAL STABILIZATION; AND (C) STRUCTURAL CONTROL MEASURES. EROSION AND SEDIMENT CONTROL MEASURES IDENTIFIED IN THE PLAN APPLICABLE TO THE SITE SHALL BE OBSERVED TO ENSURE THAT THEY ARE OPERATING CORRECTLY, WHERE DISCHARGE LOCATIONS OR POINTS ARE ACCESSIBLE THEY SHALL BE INSPECTED TO ASCERTAIN WHETHER EROSION CONTROL MEASURES ARE EFFECTIVE IN PREVENTING SIGNIFICANT IMPACTS TO RECEIVING WATERSHEDS. THESE INSPECTIONS MUST BE CONDUCTED UNTIL FINAL STABILIZATION. REPORT OF THESE INSPECTIONS SHOULD BE SENT VIA U.S. MAIL TO THE OWNER AND TO THE ARCHITECT.
- CERTIFIED PERSONNEL (PROVIDED BY THE CONTRACTOR) SHALL INSPECT AT LEAST ONCE PER MONTH, THE AREAS OF THE SITE THAT HAVE UNDERGONE FINAL STABILIZATION. THESE AREAS SHALL BE INSPECTED FOR EVIDENCE OF, OR THE POTENTIAL FOR, POLLUTANTS ENTERING THE DRAINAGE SYSTEM AND THE RECEIVING WATERSHED. EROSION AND SEDIMENT CONTROL MEASURES IDENTIFIED IN THE PLAN SHALL BE OBSERVED TO ENSURE THAT THEY ARE OPERATING CORRECTLY, WHERE DISCHARGE LOCATIONS OR POINTS ARE ACCESSIBLE, THEY SHALL BE INSPECTED TO ASCERTAIN WHETHER EROSION CONTROL MEASURES ARE EFFECTIVE IN PREVENTING SIGNIFICANT IMPACTS TO RECEIVING WATERSHEDS. REPORT OF THESE INSPECTIONS SHOULD BE SENT VIA U.S. MAIL TO THE OWNER AND TO THE ARCHITECT.
- BASED ON THE RESULTS OF EACH INSPECTION, THE SITE DESCRIPTION AND THE POLLUTION PREVENTION AND CONTROL MEASURES IDENTIFIED IN THE EROSION, SEDIMENTATION AND POLLUTION CONTROL PLAN, THE PLAN SHALL BE REVISED AS APPROPRIATE NOT LATER THAN SEVEN (7) CALENDAR DAYS FOLLOWING EACH INSPECTION. IMPLEMENTATION OF SUCH CHANGES SHALL BE MADE AS SOON AS PRACTICAL BUT IN NO CASE LATER THAN SEVEN (7) CALENDAR DAYS FOLLOWING EACH INSPECTION.
- A REPORT SUMMARIZING THE SCOPE OF EACH INSPECTION, THE DATES OF EACH INSPECTION, THE IMPLEMENTATION OF THE EROSION, SEDIMENTATION AND POLLUTION CONTROL PLAN AND ACTIONS TAKEN SHALL BE MADE AND RETAINED AT THE SITE AND COPY SENT TO THE OWNER AND TO THE ARCHITECT UNTIL THE END OF THE PORTION OF A CONSTRUCTION PROJECT THAT HAS BEEN PHASED AND UNDERGONE FINAL STABILIZATION. REPORTS SHALL IDENTIFY ANY INCIDENTS OF NON-COMPLIANCE WHERE THE REPORT DOES NOT IDENTIFY ANY INCIDENTS OF NON-COMPLIANCE. THE REPORT SHALL CONTAIN A CERTIFICATION THAT THE FACILITY IS IN COMPLIANCE WITH THE EROSION, SEDIMENTATION AND POLLUTION CONTROL PLAN.

**EAST MAIN STREET
(150' R/W)**

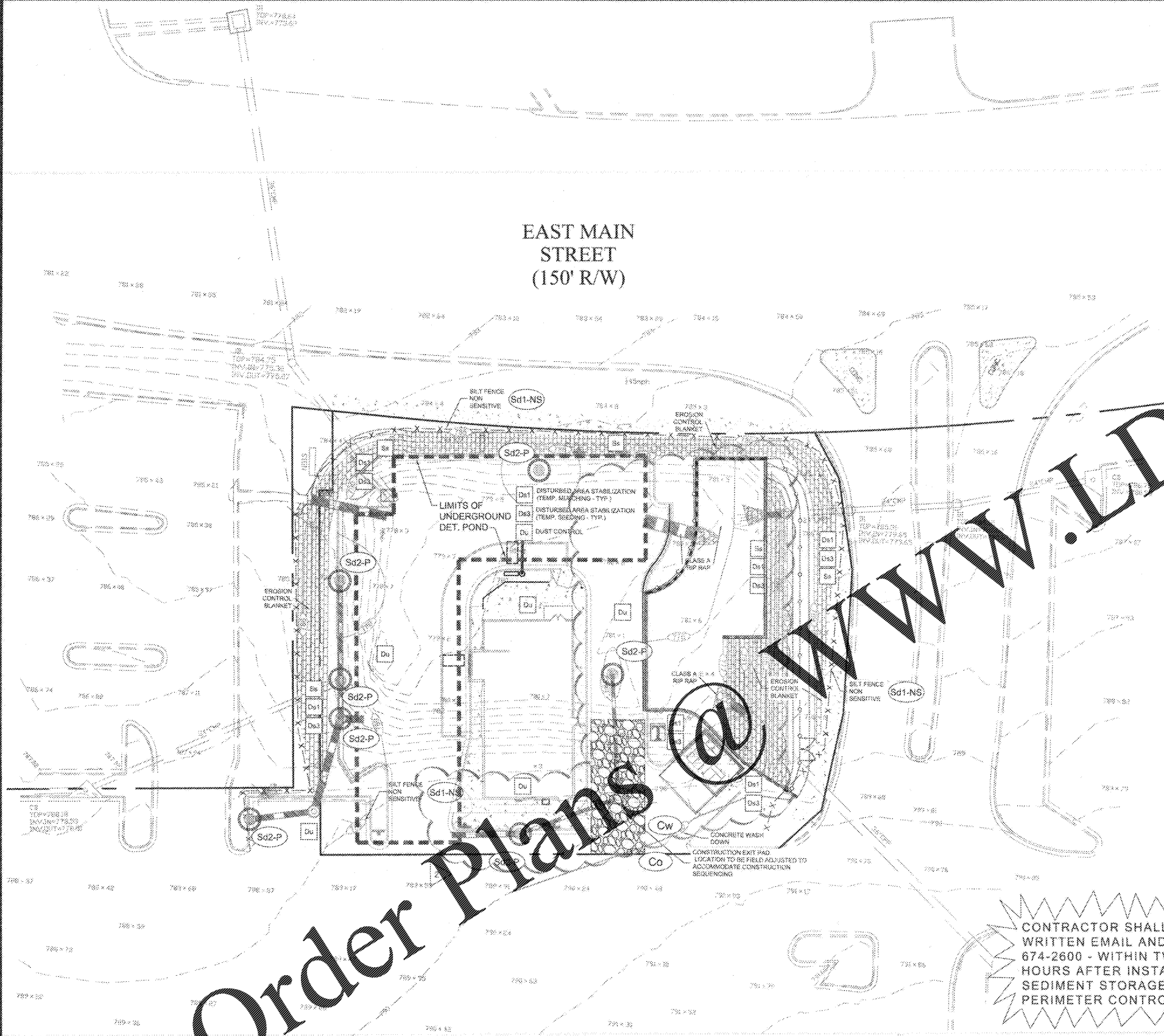

Order Plans @

CONTRACTOR SHALL NOTIFY ENGINEER BY WRITTEN EMAIL AND BY PHONE - (770) 674-2600 - WITHIN TWENTY-FOUR (24) HOURS AFTER INSTALLATION OF THE INITIAL SEDIMENT STORAGE REQUIREMENTS AND PERIMETER CONTROL BMPs.

**DISTURBED AREA:
0.70 AC**

EROSION, SEDIMENTATION, & POLLUTION CONTROL PLAN - PHASE II

EROSION CONTROL LEGEND

	CONSTRUCTION EXIT (TEMP)
	SEDIMENT BARRIER (TEMP)
	DISTURBED AREA STABILIZATION (MULCH)
	DISTURBED AREA STABILIZATION (TEMP. SEED)
	DISTURBED AREA STABILIZATION (PERMANENT)

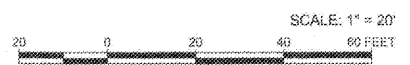

ROBERSON LOIA ROOF ARCHITECTS & ENGINEERS
3450 Prichard Ridge Road, Suite 275 Alpharetta, GA, 30005
770-674-2600 / www.rlrfpr.com

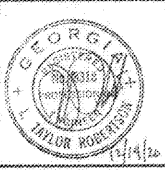

**CARTERSVILLE, GEORGIA
CHIPOTLE
405 EAST MAIN ST. CARTERSVILLE, GA 30121
CARTERSVILLE QSR, LLC
ATLANTA, GEORGIA**

REVISIONS	CITY COMMENTS
10-15-20	
17	UPDATED CHIPOTLE CRITERIA 11-25-20

09-01-2020

19-303

C-4.2

Small vertical text at the bottom left corner containing project details and dates.