

KEYNOTES

- 16.126 EXISTING LIGHT FIXTURE TO BE DEMOLISHED.
- 16.129 CONNECT TO EXISTING CIRCUIT PREVIOUSLY SERVING AREA LIGHTING THAT WAS REMOVED. MAINTAIN EXISTING CIRCUIT CONTROL UNLESS NOTED OTHERWISE. PROVIDE CONSTANT HOT FOR EMERGENCY EXIT AND LOCALLY CONTROLLED LIGHT FIXTURES.

brr
 ARCHITECT OF RECORD:
 DONN P. FRANK
 8111 MEDICAL AVENUE
 OVERLAND PARK, KS 66204
 www.brrarch.com
 TEL: 913-342-9095
 FAX: 913-342-9096

STIPULATION FOR REUSE
 THIS DRAWING WAS PREPARED FOR CONTRACTOR INFORMATION ONLY. IT IS NOT TO BE USED FOR BIDDING OR FOR ANY OTHER PURPOSES WITHOUT THE WRITTEN PERMISSION OF THE ARCHITECT. THE ARCHITECT ASSUMES NO LIABILITY FOR REUSE OF THIS DRAWING FOR ANY OTHER PROJECTS. THE USER OF THIS DRAWING SHALL BE RESPONSIBLE FOR OBTAINING ALL NECESSARY PERMITS AND APPROVALS FROM THE APPLICABLE AGENCIES. THE ARCHITECT ASSUMES NO LIABILITY FOR THE USER OF THIS DRAWING.

CONSULTANTS
HENDERSON ENGINEERS
 8865 LEBLANC DRIVE, SUITE 300
 ATLANTA, GA 30338
 TEL: 770.433.2000 FAX: 770.433.2001
 WWW.HENDERSONENGINEERS.COM
 GA. LICENSE NO.: FE0102734
 EXPRESS 03/02/02

Walmart
ATLANTA (GRESHAM)
 2427 GRESHAM RD SE 30316
 STORE NO: 13709-233
 JOB NUMBER: 216660706 | PHOTO: SPRB

ISSUE BLOCK	

CHECKED BY: BC/BW
 DRAWN BY: JRF
 PHOTO CYCLE: 09/25/20
 DOCUMENT DATE: 11/20/20

NOT FOR CONSTRUCTION

ENLARGED LIGHTING PLANS

SHEET: E1.2

CONTRACTOR IS RESPONSIBLE FOR COMPLETE INSTALLATION OF THE LIGHTING SYSTEM, AS INDICATED ON PLANS AND/OR AS MODIFIED TO ACCOMMODATE EXISTING OBSTRUCTIONS. IDENTIFY CONFLICTS PRIOR TO ROUGH-IN. WHERE CONFLICTS WITH EXISTING UTILITIES OCCUR, ADJUST FIXTURE LOCATIONS AS REQUIRED. FIXTURES SHALL BE INSTALLED AS NEAR AS POSSIBLE TO LOCATIONS INDICATED ON PLANS.

FURNISH AND INSTALL LITETRONICS #PTAM201 SURFACE MOUNT KIT, TYP QF 6.
 CONTACT WILLIAM MARR FOR ORDERING INFORMATION.
 (478) 751-7123
 WILLIAM.MARR@REXELUSA.COM

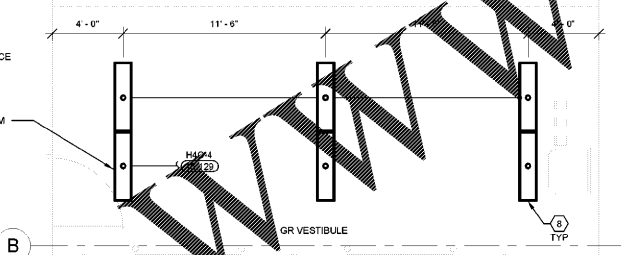

3 GR VESTIBULE LIGHTING PLAN
 1/4" = 1'-0"

CONTRACTOR IS RESPONSIBLE FOR COMPLETE INSTALLATION OF THE LIGHTING SYSTEM, AS INDICATED ON PLANS AND/OR AS MODIFIED TO ACCOMMODATE EXISTING OBSTRUCTIONS. IDENTIFY CONFLICTS PRIOR TO ROUGH-IN. WHERE CONFLICTS WITH EXISTING UTILITIES OCCUR, ADJUST FIXTURE LOCATIONS AS REQUIRED. FIXTURES SHALL BE INSTALLED AS NEAR AS POSSIBLE TO LOCATIONS INDICATED ON PLANS.

FURNISH AND INSTALL LITETRONICS #PTAM201 SURFACE MOUNT KIT, TYP QF 6.
 CONTACT WILLIAM MARR FOR ORDERING INFORMATION.
 (478) 751-7123
 WILLIAM.MARR@REXELUSA.COM

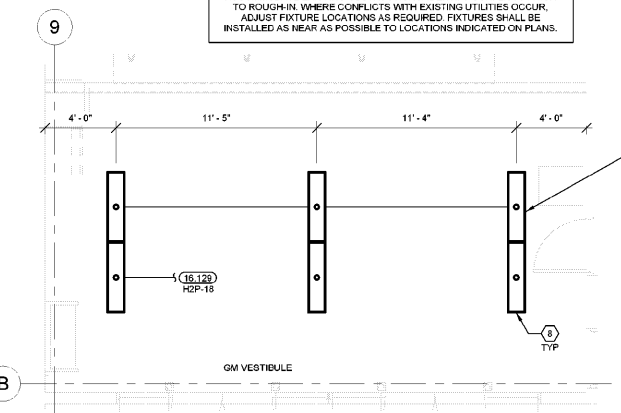

2 GM VESTIBULE LIGHTING PLAN
 1/4" = 1'-0"

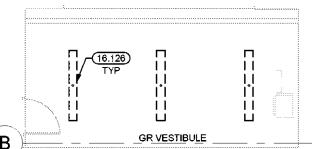

3 GR VESTIBULE LIGHTING DEMO PLAN
 1/8" = 1'-0"

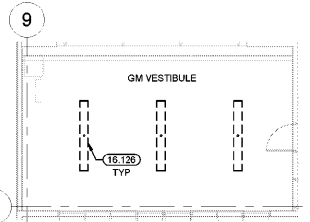

1 GM VESTIBULE LIGHTING DEMO PLAN
 1/8" = 1'-0"

EXISTING CONDITIONS WERE TAKEN FROM ORIGINAL DRAWINGS AND MAY NOT REFLECT EXACT "AS-BUILT" CONDITIONS. CONTRACTOR SHALL VERIFY ALL EXISTING CONDITIONS PRIOR TO SUBMITTING FINAL BIDS. CONTRACTOR SHALL CAREFULLY COORDINATE NEW WORK AND DEMOLITION WITH ALL OTHER DISCIPLINES AND EXISTING CONDITIONS.

EACH SUBCONTRACTOR IS RESPONSIBLE FOR HAVING A THOROUGH KNOWLEDGE OF ALL DRAWINGS AND SPECIFICATIONS IN THEIR RELATED FIELD. THE FAILURE TO ACQUAINT THEMSELVES WITH THIS KNOWLEDGE DOES NOT RELIEVE THE RESPONSIBILITY OF PERFORMING THE WORK PROPERLY. NO ADDITIONAL COMPENSATION SHALL BE ALLOWED BECAUSE OF CONDITIONS THAT OCCUR DUE TO FAILURE TO FAMILIARIZE WORKERS WITH THIS KNOWLEDGE.

Order Plans @

WWW.LDILine.com