

City of Wildwood Product Approval

Wind Speed: 119 M.P.H. Exposure Category: B Protection Required: NO

WINDOWS AND DOORS														
SYMBOL ON PLAN	NUMBER OF UNITS	PRODUCT CATEGORY	PRODUCT SUBCATEGORY	MANUFACTURER	SERIES OR MODEL #	FL OR MIAMI APPROVAL #	WIDTH	HEIGHT	POSITIVE PRESSURE (PSF)	NEGATIVE PRESSURE (PSF)	DESIGN POSITIVE PRESSURE	DESIGN NEGATIVE PRESSURE	FASTENER TYPE	FASTENER SPACING
100A	1	ENTRANCE	OUT SWINGING	YKK AMERICA	35H	16554.1	77in	98in	70	70	44	47.9	1/4" x 5"L SS wd screws	SEE NOTE 1
101A	1	WINDOW	FIXED	YKK AMERICA	YHS-50-FS	14218.6	68in	60in	70	70	44	47.9	1/4" x 3"L SS wd screws	SEE NOTE 2
101B	1	WINDOW	FIXED	YKK AMERICA	YHS-50-FS	14218.6	68in	60in	70	70	44	47.9	1/4" x 3"L SS wd screws	SEE NOTE 2
101C	1	WINDOW	FIXED	YKK AMERICA	YHS-50-FS	14218.6	68in	60in	70	70	44	47.9	1/4" x 3"L SS wd screws	SEE NOTE 2
101D	1	WINDOW	FIXED	YKK AMERICA	YHS-50-FS	14218.6	68in	60in	70	70	44	47.9	1/4" x 3"L SS wd screws	SEE NOTE 2
101E	1	WINDOW	FIXED	YKK AMERICA	YHS-50-FS	14218.6	36in	60in	70	70	44	47.9	1/4" x 3"L SS wd screws	SEE NOTE 3
101F	1	ENTRANCE	OUT SWINGING	YKK AMERICA	35H	16554.1	41in	98in	90	90	44	47.9	1/4" x 5"L SS wd screws	SEE NOTE 4
101G	1	WINDOW	FIXED	YKK AMERICA	YHS-50-FS	14218.6	27in	60in	70	90	44	47.9	1/4" x 3"L SS wd screws	SEE NOTE 2
101H	1	WINDOW	FIXED	YKK AMERICA	YHS-50-FS	14218.6	68in	60in	70	90	44	47.9	1/4" x 3"L SS wd screws	SEE NOTE 2
104	1	WINDOW	BI-PARTING	QUIKSERV	BP-7241E-IP	23326.1	72in	41in	70	80	44	47.9	1/4" x 1"L SS TEK screws	SEE NOTE 5
104A	1	WINDOW	FIXED	YKK AMERICA	YHS-50-FS	14218.6	18in	60in	70	70	44	47.9	1/4" x 3"L SS wd screws	SEE NOTE 6
104B	1	WINDOW	FIXED	YKK AMERICA	YHS-50-FS	14218.6	18in	60in	70	70	44	47.9	1/4" x 3"L SS wd screws	SEE NOTE 6
104C	1	WINDOW	FIXED	YKK AMERICA	YHS-50-FS	14218.6	72in	23in	70	70	44	47.9	1/4" x 3"L SS wd screws	SEE NOTE 7
105A	1	WINDOW	FIXED	YKK AMERICA	YHS-50-FS	14218.6	68in	60in	70	70	44	47.9	1/4" x 3"L SS wd screws	SEE NOTE 2
107	1	DOOR	HM OUT SWING	CECO	IMPERIAL	16355.2	42in	84in	60	60	44	47.9	3/8" x 6"L galv lag bolt	SEE NOTE 8
107A	1	WINDOW	FIXED	YKK AMERICA	YHS-50-FS	14218.6	68in	60in	70	70	44	47.9	1/4" x 3"L SS wd screws	SEE NOTE 2
OTHER (ROOFING, SIDING, SOFFIT, FASCIA, ETC.)														
ROOF MEMBRANE	1 LOT	ROOF	SINGLE PLY	DURO-LAST	DL50	16039.1			50	52.5	38.2	46.1	DL-#14 HD Fastener w/ poly or clear plate	SEE NOTE 9
ROOF INSUL	1 LOT	ROOF	INSULATION	DURO-LAST	ISO-HD	16039.1	48in	48in	50	52.5	38.2	46.1	DL-#15 HD Fastener w/ poly or metal plate	SEE NOTE 10
COND. UNIT STANDS	10	ROOF	COND. UNIT STANDS	PRECISION ALUMINUM	HD-STAND	16921.1	24in	24in	54.6	54.6	38.2	46.1	(4) 3/8" dia SAE Grade 5 threaded rod w/ 3/4" washers & nuts	SEE NOTE 11
EIFS	1 LOT	SIDING	EIFS	STO	STO-THERM	21034.1			100	100	44	57.5		SEE NOTE 13
METAL PANELS	1 LOT	SIDING	ACM PANELS	MITSUBISHI PLASTICS	20 ACM	10520.1			70	90	44	57.5		SEE NOTE 14
HOLD DOWNS	1 LOT	FASTENER	HOLD DOWNS	SIMPSON	HDU-4, HDU-14	10441.4			60	60	44	57.5	SDS 2.5 screws	SEE NOTE 15
TRUSS CLIPS	1 LOT	FASTENER	TRUSS CLIPS	SIMPSON	H3, H2.5A, H10A	10456.2			60	60	44	57.5		SEE NOTE 16
FRAM'G ANGLE	1 LOT	FASTENER	FRAMING ANGLE	SIMPSON	A35	10446.1			60	60	44	57.5		SEE NOTE 16

FASTENER SPACING NOTES

- Jamb: (1) fastener @ 5 1/2" max from sill and head & (1) fastener @ 13 1/2" o.c. max centered on vertical opening.
Head: (1) fastener @ 4 1/2" max from jamb & (1) fastener spaced @ 3" o.c. max after first fastener (qty = 2) & (1) fastener at mid span of opening.
- Jamb: (1) fastener @ 5 1/2" max from sill and head & (1) fastener spaced @ 13" o.c. max centered on vertical opening.
Sill / Head: (1) fastener @ 4" max from jamb & (1) fastener @ 3" o.c. max after first fastener (qty 1).
Mullion (head & sill): (1) fastener @ 1 1/2" from edge of mullion & (1) fastener @ 3" max from first fastener.
- See No. 2 above but without Mullion fastener.
- See No. 1 above for fastener spacing information.
- Jamb: (1) fastener @ 6" max from sill and head & (1) fastener @ 10" o.c. max centered on vertical opening.
- Jamb: (1) fastener @ 5 1/2" max from sill and head & (1) fastener @ 13" o.c. max centered vertically.
Sill / Head: (1) fastener @ 4" max from jamb & (1) fastener @ 3" max from first fastener.
Mullion: (1) fastener @ 1 1/2" from edge of mullion & (1) fastener @ 3" max from first fastener.
- Jamb: (1) fastener @ 5 1/2" max from sill and head & (1) fastener @ 13" o.c. max centered vertically.
Head: (1) fastener @ 4" max from jamb & (1) fastener @ 3" max from first fastener & (1) fastener at mid span of opening.
- Jamb: (1) fastener @ 6" max from sill and head & (1) fastener @ 28" o.c. max vertically.
Threshold: (1) 1/4" ITW Tapcon w/ 1-3/4" embedment @ 6" max from jamb & (1) Tapcon @ 12" o.c. max.
- Field: (1) fastener and plate @ 18" o.c. max in 60" o.c. rows.
Perimeter: (1) fastener and plate @ 6" o.c. max, typ all perimeter edges of roof.
- Long Edge: (1) fastener and plate @ 12" from edge of insulation board & (1) fastener and plate @ 24" o.c. max thereafter.
Short Edge: (1) fastener and plate @ 6" from edge of insulation board & (1) fastener and plate @ 18" o.c. max (forming three rows of fasteners)
- (4) fasteners typical at each condensing unit stand leg mounting foot plate.
- Not used
- Provide STO Primer / Adhesive-B using 1/2" x 1/2" U-notched trowel or 5/8" x 5/8" square notched trowel in vertical oriented striation over STO Gold Coat Air / Moisture Barrier (liquid applied)
- Provide (1) #10 x 1" long TEK screws @ 16" o.c. max fasten Aluminum Expansion to exterior sheathing and studs & (1) #12 x 2" long TEK screws @ 16" o.c. max fastening Metal Panels to Aluminum Extrusion
- HDU-4 Hold downs: Provide SDS 2.5 Screws, filling angles (10/31)
HDU-14 Hold downs: Provide SDS 2.5 Screws, filling angles (30/31)
- H3 Clip: Provide 4-8d fasteners to each stud and 8d fasteners to plates
H2.5A Clip: Provide 5-8d fasteners to each stud & 8d fasteners to plates and 5-8d fasteners to each truss as applicable.
H10A Clip: Provide 9-8d 1 1/2" fasteners to plate and 9-8d x 1 1/2" fasteners to each stud.
110 Framing Angle: Provide #10 x 1 1/2" fastener to each stud and 6-8d x 1 1/2" fastener to blocking.

JAMES E. WILKERSON
A.I.A.
119 East Tallulah Drive
Greenville, S.C. 29605
864-370-2582
864-240-5375 f

FLA REG. AR0015603
JOB NO. 202016

DQ GRILL & CHILL
US HWY 90 (LOT 2)
GLEN ST MARY, FL
32040

DQ
GRILL & CHILL
AMERICAN DAIRY QUEEN
MINNEAPOLIS, MN U.S.A.
*REGISTERED U.S. PATENT OFFICE.
AMERICAN DAIRY QUEEN CORPORATION.
THIS DRAWING, ITS DESIGN DETAIL AND
INVENTION ARE THE PROPERTY OF
AMERICAN DAIRY QUEEN INC. (ADQ) AND
SHALL NOT BE COPIED IN ANY MANNER
NOR DISCLOSED TO ANY OUTSIDE
PARTY WITHOUT ADQ CONSENT.

BUILDING TYPE:
DAIRY QUEEN GRILL & CHILL
CORE66
STORE No. 45961

DRAWN, CHECKED, & APPROVED BY: ADQ
DESIGN-ARCHITECTURE-CONSTRUCTION
(DAC) DEPARTMENT

THIS IS "PLAN" NORTH
FOR ACTUAL BUILDING
ORIENTATION REFER TO
SITE PLAN (BY OTHERS)

ISSUE DATE: 10/30/2020
REVISION DATE:
10/30/2020 Δ ISSUE FOR CONSTRUCTION
 Δ
 Δ
 Δ
 Δ

LIFE SAFETY PLAN
FL PRODUCT APPROVAL

SHEET NUMBER:
LSP-1

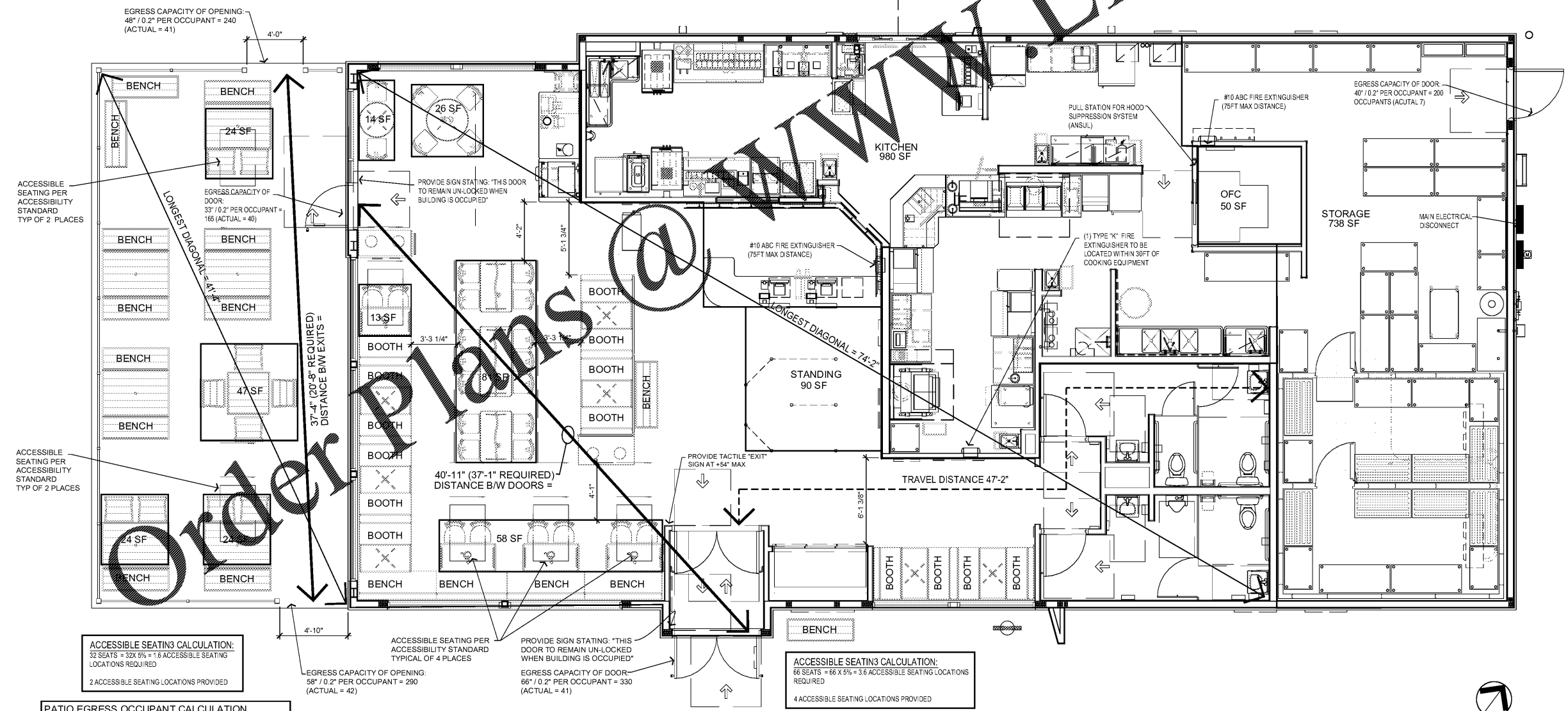

ACCESSIBLE SEATING CALCULATION:
32 SEATS = 32 X 5% = 1.6 ACCESSIBLE SEATING LOCATIONS REQUIRED
2 ACCESSIBLE SEATING LOCATIONS PROVIDED

ACCESSIBLE SEATING CALCULATION:
58 SEATS = 58 X 5% = 2.9 ACCESSIBLE SEATING LOCATIONS REQUIRED
2 ACCESSIBLE SEATING LOCATIONS PROVIDED

ACCESSIBLE SEATING CALCULATION:
66 SEATS = 66 X 5% = 3.3 ACCESSIBLE SEATING LOCATIONS REQUIRED
4 ACCESSIBLE SEATING LOCATIONS PROVIDED

ACCESSIBLE SEATING CALCULATION:
66 SEATS = 66 X 5% = 3.3 ACCESSIBLE SEATING LOCATIONS REQUIRED
4 ACCESSIBLE SEATING LOCATIONS PROVIDED

PATIO EGRESS OCCUPANT CALCULATION
ASSEMBLY WITH FIXED SEATS 35 PEOPLE
BENCH SEATING: (62" x 18") = 8 PEOPLE
NON-FIXED SEATING (119 SF @ 15 SF / PERSON) = 8 PEOPLE
TOTAL 43 PEOPLE

LIFE SAFETY PLAN
SCALE: 1/4" = 1'-0"