

JAMES E. WILKERSON
A.I.A.

119 East Tallulah Drive
Greenville, S.C. 29605
864-370-2582
864-240-5375 f

FLA REG. AR0015603
JOB NO. 202016

DQ GRILL & CHILL
US HWY 90 (LOT 2)
GLEN ST MARY, FL
32040

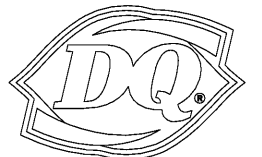

GRILL & CHILL

AMERICAN DAIRY QUEEN
MINNEAPOLIS, MN U.S.A.

*REGISTERED U.S. PATENT OFFICE.
AMERICAN DAIRY QUEEN CORPORATION.
THIS DRAWING, ITS DESIGN DETAIL AND
INVENTION ARE THE PROPERTY OF
AMERICAN DAIRY QUEEN INC. (ADQ) AND
SHALL NOT BE COPIED IN ANY MANNER
NOR DISCLOSED TO ANY OUTSIDE
PARTY WITHOUT ADQ CONSENT.

BUILDING TYPE:
DAIRY QUEEN GRILL & CHILL
CORE66
STORE No. 45961

DRAWN, CHECKED, & APPROVED BY: ADQ
DESIGN-ARCHITECTURE-CONSTRUCTION
(DAC) DEPARTMENT

THIS IS "PLAN" NORTH
FOR ACTUAL BUILDING
ORIENTATION REFER TO
SITE PLAN (BY OTHERS)

ISSUE DATE: 10/30/2020

REVISION DATE:

10/30/2020 ISSUE FOR CONSTRUCTION

FLOOR PLAN

SHEET NUMBER:

A2.1

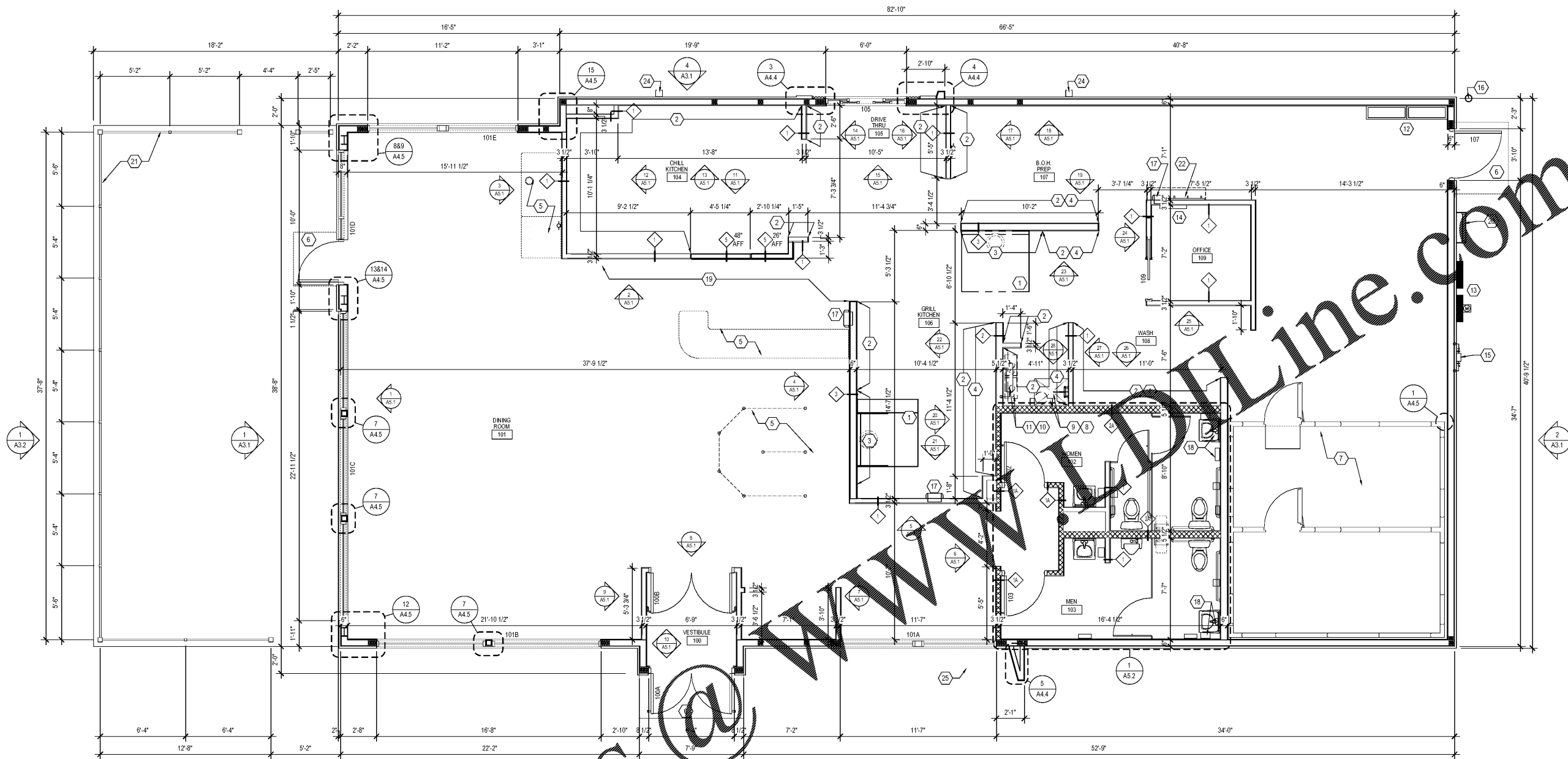

1 FLOOR PLAN
A2.1 SCALE: 1/4" = 1'-0"

GENERAL NOTES

- UNLESS NOTED OTHERWISE, ALL EXTERIOR DIMENSIONS ARE TO FACE OF SHEATHING.
- UNLESS NOTED OTHERWISE, ALL INTERIOR DIMENSIONS ARE TO FACE OF STUD.
- REFER TO DRAWINGS AND SPECIFICATIONS PREPARED BY EQUIPMENT SUPPLIERS AND MECHANICAL SUPPLIER FOR THEIR UNIQUE REQUIREMENTS. ALL MATERIALS ARE TO BE INSTALLED ACCORDING TO THE MANUFACTURER'S SPECIFICATIONS AND RECOMMENDATIONS.

FLOOR PLAN NOTES

- GENERAL CONTRACTOR SHALL INSTALL EXHAUST FAN PACKAGE AS WELL AS PROVIDE ANY/ALL NECESSARY MATERIALS IN ORDER FOR PROPER HOOD OPERATION. SEE SHEETS F1, F1.1, M1, M3, & M5 FOR ADDITIONAL INFORMATION AND DETAILS. ANSUL SYSTEM PROVIDED AND INSTALLED BY HOOD SUPPLIER.
- PROVIDE 1/2" INTERIOR SANDED PLYWOOD IN LIEU OF GYPSUM WALL BOARD
- PROVIDE SHEETMENT BOARD IN LIEU OF GYPSUM WALL BOARD
- PROVIDE W.D. BLOCKING AT WALL SHELVES COORDINATE EXTENT WITH SHEETMENT PLAN. SEE DETAIL 13/A6.1
- COUNTERS AND DECOR WALLS ARE PART OF COUNTER MILLWORK PKG. SEE "F" SHEETS FOR PLAN, ELEVATION AND DETAILS.
- CONC STOOP. SEE STRUCTURAL
- GENERAL CONTRACTOR SHALL INSTALL WALK-IN COOLER/FREEZER PACKAGE. PROVIDE SEALED TRIM FROM COOLER BOX TO SIDE WALL. VERIFY SEALING REQUIREMENTS PER LOCAL CODES. (COOLER TYPICALLY 1" FROM WALLS - REFER TO DETAILS 9, 12, 13, & 19/A4.3)
- MOP SINK. SEE DETAIL 14/A6.1
- WATER FILTER SYSTEM
- WATER METER LOCATION. SEE PLUMBING SHEETS
- WATER HEATER. SEE PLUMBING DWGS

PARTITION TYPES

- 2x4 WOOD FRAMING @ 16" O.C. EXTEND TO ROOF STRUCTURE
- 2x4 WOOD FRAMING @ 16" O.C. EXTEND TO ROOF STRUCTURE. PROVIDE FULL THICKNESS SOUND BATT INSULATION TO 3" ABOVE CEILING
- 2x6 WOOD FRAMING @ 16" O.C. EXTEND TO ROOF STRUCTURE
- 2x6 WOOD FRAMING @ 16" O.C. EXTEND TO ROOF STRUCTURE. PROVIDE FULL THICKNESS SOUND BATT INSULATION TO 3" ABOVE CEILING
- 6" MTL. FRAMING @ 16" O.C. EXTEND TO ROOF STRUCTURE.
- 6" MTL. FRAMING @ 16" O.C. EXTEND TO ROOF STRUCTURE. PROVIDE FULL THICKNESS SOUND BATT INSULATION TO 3" ABOVE CEILING
- ELECTRICAL PANEL. SEE ELEC DWGS - VERIFY W/MANUFACTURER INSTALL REQUIREMENTS
- ELECTRICAL DISCONNECT AND METER SOCKET.
- PHONE BOARD
- GAS METER
- 6"Ø CONC. FILLED STEEL BOLLARD. PAINT
- SEMI RECESSED FIRE EXTINGUISHER CABINET. RECOMMENDED MANUFACTURER AND MODEL ACTIVAR, COSMOPOLITAN 2038-S21 PROVIDED AND INSTALLED BY G.C. AVAILABLE FROM HJC
- G.C. TO VERIFY AND PROVIDE BLOCKING PER MANUFACTURER'S REQUIREMENTS
- G.C. TO PROVIDE AND INSTALL 2x8 HORIZONTAL WOOD BLOCKING (LET IN) TO STUDS BEHIND GYP. BD. TOP OF BLOCKING TO BE AT 94 7/8" AFF AND 10" AFF. MIN. LENGTH OF BLOCKING AS NOTED (SEE DETAIL 2/A7.1-FULL DIGITAL). END OF BLOCKING MUST LAND ON STUD.
- OPTIONAL ROOF ACCESS LADDER
- PATIO RAILING. SEE DETAIL 8/A1.2
- COAT HOOKS & SHELF. PROVIDED & INSTALLED BY G.C.
- EXTERIOR FIREPLACE ENCLOSURE
- ROOF SCUPPER DOWNSPOUT
- EXTERIOR RED SPOON. SEE EQUIPMENT PLAN, ELEVATIONS, WALL SECTIONS, & FOUNDATION PLAN

PARTITION TYPES

- 3 5/8" MTL. FRAMING @ 16" O.C. EXTEND TO ROOF STRUCTURE.
- 3 5/8" MTL. FRAMING @ 16" O.C. EXTEND TO ROOF STRUCTURE. PROVIDE FULL THICKNESS SOUND BATT INSULATION TO 3" ABOVE CEILING
- 2x4 WOOD FRAMING @ 16" O.C. PARTIAL HEIGHT WALL SEE PLAN FOR HEIGHT

GENERAL NOTES:

- PROVIDE 5/8" GYP. BD. ON ALL WALL SURFACES UNLESS NOTED OTHERWISE
- PROVIDE MOISTURE RESISTANT GYP. BD. AT WET WALL LOCATIONS.
- ALL INTERIOR WALL SHEATHING (GYP. BD. OR PLYWOOD) TO EXTEND 3" ABOVE CEILING.

Order Plans @ www.dline.com