

**PAVING LEGEND**

- ASPHALT PAVEMENT
  - 1.5" SP-9.5 (TL-C) WITH TACK COAT PER FDOT SPECIFICATIONS
  - 6" CRUSHED CONCRETE (LBR=130) MIN OF 98% MODIFIED PROCTOR MAX DENSITY PER AASHTO T-180 (4" MAX. LIFTS)
  - 12" STABILIZED SUBBASE (BR 40) MIN OF 98% MODIFIED PROCTOR MAX DENSITY PER AASHTO T-180 (TYPE B STABILIZATION)
  - \*ALTERNATE 12" STABILIZED SUBBASE: 6" CRUSHED CONCRETE (LBR=130) MIN OF 98% MODIFIED PROCTOR MAX DENSITY PER AASHTO T-180 (4" MAX. LIFTS)
  - \*ALTERNATE PAVEMENT TO ASPHALT IS CONCRETE PAVEMENT
- CONCRETE PAVEMENT
  - 6" CONCRETE (4000 P.S.I. @ 28 DAYS)
  - 12" STABILIZED SUBGRADE (LBR 40) MIN OF 98% MODIFIED PROCTOR MAX DRY DENSITY PER ASTM D1557, AASHTO T-180 (6" LIFTS) SEE CITY DETAIL R-19, SHEET No. 14
- CONCRETE SIDEWALK
  - 4" THICK CONCRETE (3,000 P.S.I. @ 28 DAYS), CLASS I, APPROVED FDOT DESIGN MIX (FDOT INDEX No. 522-001)
  - SEE CITY DETAILS M-6, M-6.1, & M-7, SHEET No. 14

**CURB RAMP LEGEND:**

- 1 SIDEWALK CURB RAMP (CR-C) WITH 24" DETECTABLE WARNING MAT PER FDOT INDEX 522-002
- 2 SIDEWALK CURB RAMP (CR-E) WITH 24" DETECTABLE WARNING MAT PER FDOT INDEX 522-002
- 3 SIDEWALK CURB RAMP (CR-G) WITH 24" DETECTABLE WARNING MAT PER FDOT INDEX 522-002

**LEGEND**

- TYPE "F1" CURB
- TYPE "F2" CURB
- TRANSITION FROM "F2" CURB TO "F1" CURB
- 24" DETECTABLE WARNING MAT
- SITE LIGHTING
- SEE ARCHITECTURAL PLANS

**STRIPING KEYNOTES:**

- 1 6" SOLID WHITE LINE
- 2 6" SOLID DOUBLE YELLOW LINE
- 3 24" WHITE STOP BAR (THERMOPLASTIC)
- 4 WHITE DIRECTIONAL ARROW
- 5 12"x6" WHITE SPECIAL EMPHASIS CROSSWALK (THERMOPLASTIC)
- 6 STANDARD CROSSWALK (THERMOPLASTIC)
- 7 6" SOLID YELLOW LINE
- 8 4" O.C. @ 45°
- 9 6" SOLID YELLOW LINE

**DRIVE THRU KEY:**

- A HEIGHT RESTRICTION BAR (9'-0" CLEARANCE)
- B DRIVE THRU PRE-MENU
- C DRIVE THRU ORDER MENU BOARD

**GENERAL NOTES:**

1. BAKER COUNTY BUILDING PERMITS ARE REQUIRED FOR BUILDING, DUMPSTER ENCLOSURE, LIGHT POLES, AND SIGNS. CONTRACTOR SHALL BE RESPONSIBLE FOR SUBMITTING APPROPRIATE INFORMATION (ENGINEERING, SPECIFICATIONS, ETC.) FOR LIGHT POLES AND FIXTURES AT TIME OF PERMIT.
2. PERMITS ARE REQUIRED FOR: CONSTRUCTION OF NEW BUILDING; MONUMENT AND ART SIGNS; AND DUMPSTER ENCLOSURE. CONTACT THE BUILDING DIVISION IF THERE ARE QUESTIONS OR CONCERNS ABOUT PERMIT REQUIREMENTS FOR WORK NOT SPECIFICALLY MENTIONED HEREIN.
3. ALL SERVICE AREAS AND MECHANICAL EQUIPMENT (GROUND, WALL OR ROOF) INCLUDING, BUT NOT LIMITED TO AIR CONDITIONING CONDENSERS, HEATING UNITS, SATELLITE DISHES, IRRIGATION PUMPS, AND PROPANE TANKS, DISPLAYS AND REFILLING AREAS, SHALL BE SCREENED USING ARCHITECTURAL FEATURES CONSISTENT WITH THE STRUCTURE, OR LANDSCAPING OF SUFFICIENT DENSITY AND MATURITY AT PLANTING TO PROVIDE OPAQUE SCREENING.
4. EXTERNAL DOWNSPOUTS VISIBLE FROM ANY RIGHTS-OF-WAY ARE NOT PERMITTED, UNLESS THEY ARE DECORATIVE. IN LOCATIONS THAT ARE CLEARLY VISIBLE FROM A PUBLIC RIGHT-OF-WAY, DOWNSPOUTS MAY BE INSTALLED EXTERNALLY ONLY IF THEY HAVE A HIGH-QUALITY, DECORATIVE DESIGN AND APPEARANCE OF COPPER, STEEL, TIN, OR SILVER OR SIMILAR NATURAL METALLIC MATERIAL. IN LOCATIONS THAT ARE MOSTLY OR COMPLETELY SCREENED FROM A PUBLIC RIGHT-OF-WAY, EXTERNAL DOWNSPOUTS ARE NOT REQUIRED TO BE DECORATIVE AS ABOVE BUT MUST BE PAINTED TO MATCH THE BUILDING EXTERIOR ON WHICH THEY ARE MOUNTED.
5. ALL DIMENSIONS AND TIES ARE TO THE EDGE OF PAVEMENT AND OUTSIDE FACE OF BUILDING.
6. ALL IMPROVEMENTS SHALL BE STAKED FOR CONSTRUCTION BY MEANS OF DIGITAL COORDINATE SURVEY OR UTILIZING GEODETIC TOTAL STATION OR GPS. SCALING OF DRAWINGS FOR PURPOSES OF STAKING ARE AT THE SURVEYOR'S RISK.
7. THE CONTRACTOR SHALL COORDINATE WITH THE EXISTING ADJACENT BUSINESSES TO ENSURE THERE IS NO DISRUPTION TO THEIR RESPECTIVE OPERATIONS.
8. THE CONTRACTOR AT ITS OWN DISCRETION SHALL MAINTAIN THE CONSTRUCTION SITE SECURE FROM TRESPASS.
9. SOD ALL DISTURBED AREAS IN RIGHT-OF-WAY WITH BATHYWOOD.
10. ALL CURB RAMPS SHALL COMPLY WITH SECTION 9.05 OF FLORIDA ACCESSIBILITY CODE FOR BUILDING CONSTRUCTION (FACBC).
11. ALL PAVEMENT EDGE SHALL HAVE TYPE "F1" CURB UNLESS OTHERWISE NOTED ON THESE PLANS.
12. ALL WALL-MOUNTED EQUIPMENT SUCH AS ELECTRICAL METERS, IRRIGATION METERS, PHONE/CABLE BOXES, EXTERNAL VENTS AND LOGS, ETC., SHALL BE PAINTED TO MATCH THE WALL ON WHICH IT IS MOUNTED OR OTHERWISE CONSISTENT WITH THE COLOR(S) OF THE BUILDING.
13. ALL MATERIALS, MACHINERY AND VEHICLES SHALL BE STORED ON-SITE IN AN ORDERLY ORGANIZED FASHION.
14. COMMERCIAL IMPACT FEE SHALL BE CALCULATED, DUE AND PAYABLE WITHIN 30 DAYS OF INITIATION OF PERMANENT ELECTRIC SERVICE.
15. CONTRACTOR TO PROVIDE PREMISE IDENTIFICATION FOR BUILDING DURING CONSTRUCTION.
16. SITE LIGHTING MUST NOT SHINE DIRECTLY UPON ANY ADJACENT RESIDENCE AND MUST NOT PRODUCE EXCESSIVE GLARE. GLARE GUARDS WILL BE INSTALLED IF NEEDED.

**PAVEMENT MARKING NOTES:**

1. PAINTED PAVEMENT MARKINGS SHALL BE APPLIED AFTER PAVEMENT SURFACE HAS CURED. SURFACE SHALL BE FREE OF FINE SAND AND DEBRIS PRIOR TO APPLICATIONS.
2. APPLY PAINTED PAVEMENT MARKINGS AT LAST STAGE OF CONSTRUCTION AFTER LANDSCAPE PLANTINGS ARE INSTALLED.
3. PAINT SHALL BE SHERWIN WILLIAMS LOW-VOC ACRYLIC PRO PARK PAINT, APPLY PER MANUFACTURER'S RECOMMENDATIONS. REFER TO DRAWINGS FOR LOCATIONS OF SPECIFIC COLORS.
4. ALL STOP BARS SHALL BE THERMOPLASTIC.
5. ALL REFLECTIVE PAVEMENT MARKERS ARE TO BE PLACED IN ACCORDANCE WITH FDOT STANDARD INDEX NO. 17352.
6. ALL SIGNS SHALL BE PLACED IN ACCORDANCE WITH INDEX NO. 17301 AND THE "MANUAL ON UNIFORM TRAFFIC CONTROL DEVICES FOR STREETS AND HIGHWAYS".
7. LOCATION OF SIGNS IS APPROXIMATE ONLY AND IS SUBJECT TO CHANGE AS DIRECTED BY THE ENGINEER.
8. FOR ADDITIONAL DETAILS SEE INDEX NO. 700-010, 11863, 700-101, 17344 AND 706-001.
9. ALL TRAFFIC CONTROL SIGNS SHALL BE FABRICATED USING 3M BRAND "SCOTCHLITE" SHEETING (ENGINEER GRADE) ON MINIMUM .08 GA ALUMINUM BLANKS. ALL 36"x48" SIGNS SHALL BE .100 GA MINIMUM AND SHALL BE INSTALLED USING 3"x12" ROUND ALUMINUM POST. ALL STOP SIGNS SHALL BE 36" OCTAGON INSTALLED ON 12.3 LBS/FT "U" CHANNEL POST RAIL STEEL ONLY OR 3"x12" ROUND ALUMINUM POSTS. "U" CHANNEL POSTS MAY BE USED FOR SIGNS SMALLER THAN 36"x36". ALL SPEED LIMIT SIGNS SHALL BE 24"x30".

PARCEL ID#: 36-25-21-0000-0000-0346  
OWNER: WILDCAT CROSSING OWNERS  
US HIGHWAY 90  
GLEN ST. MARY, FL 32040

PARCEL ID#: 36-25-21-0211-0000-05000  
OWNER: BCD GREYSTONE, LLC & ETAL  
10262 GREYSTONE DRIVE  
GLEN ST. MARY, FL 32040

PARCEL ID#: 31-25-22-0000-0130  
OWNER: GREYSTONE HOMEOWNER'S  
GREYSTONE DRIVE  
GLEN ST. MARY, FL 32040

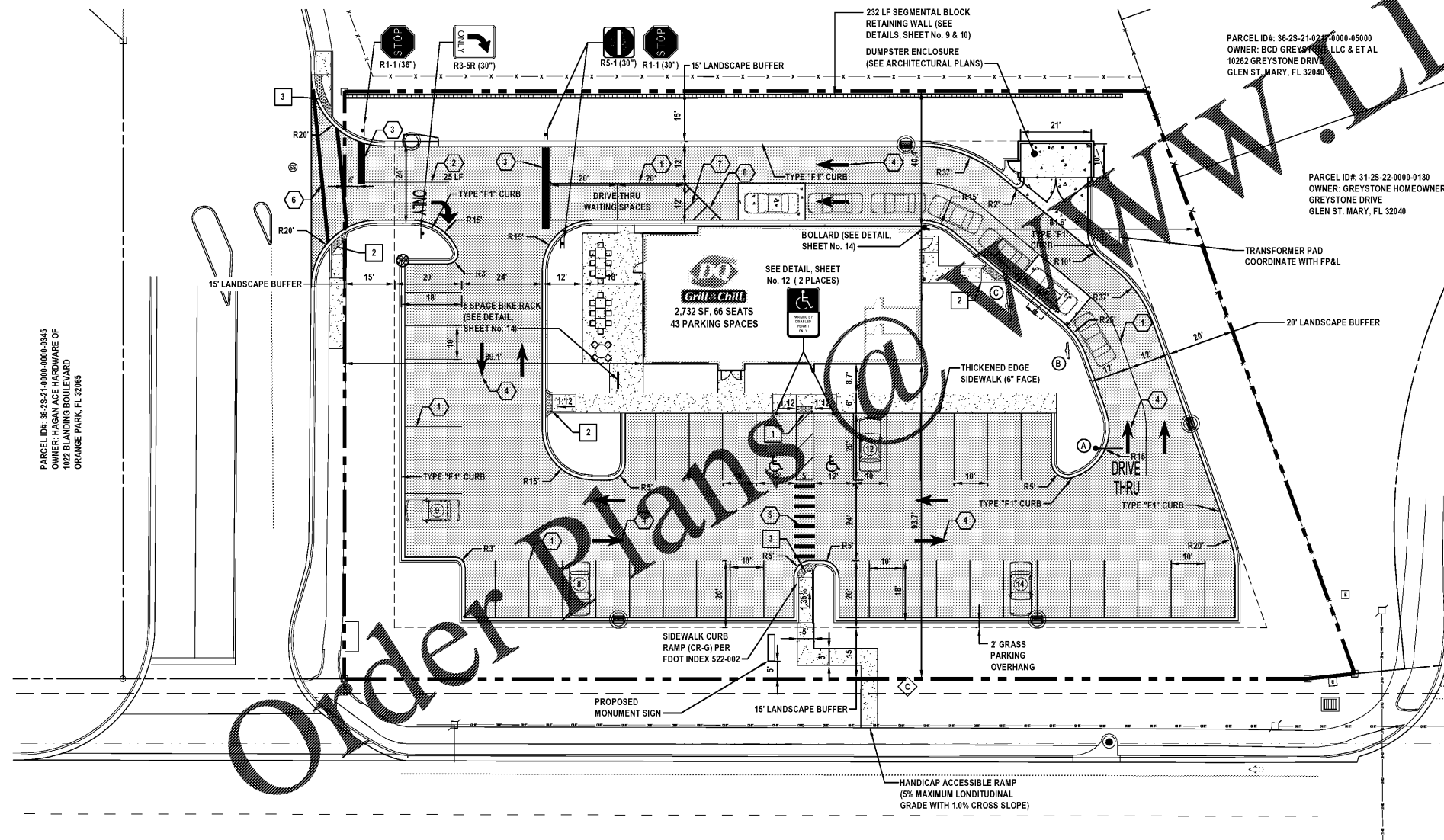

**U.S. HIGHWAY 90 (STATE ROAD 10)**  
(VARIABLE RW)(SPEED LIMIT 45 MPH)

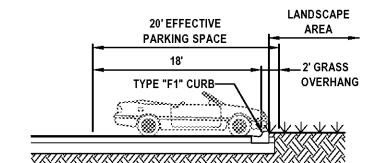

**PARKING SPACE OVERHANG DETAIL**  
NOT TO SCALE

**REVISIONS**

DATE	DESCRIPTION

1230 North US1, Suite 3  
Ormond Beach, Florida 32174  
Phone (386) 872-7794  
www.Newkirk-Engineering.com  
C.A. # 93209  
L.C. # 26000684  
© 2013  
Civil Engineering  
Transportation, CEI &  
Landscape Architecture



**SITE LAYOUT PLAN**  
**DAIRY QUEEN**  
6567 US-90  
GLEN ST. MARY, FL 32040

THIS DRAWING IS THE PROPERTY OF NEWKIRK ENGINEERING. ANY USE OR REPRODUCTION IN WHOLE OR PART IS PROHIBITED WITHOUT THE EXPRESSED WRITTEN CONSENT OF NEWKIRK ENGINEERING. COPYRIGHT © 2013 ALL RIGHTS RESERVED.



PROJECT No: 2020-307

DATE: DECEMBER 2020

DESIGN BY: HHN

DRAWN BY: DAB

CHECKED BY: HHN

SCALE: 1" = 20'

DRAWING NUMBER