

Order Plans @

WWW.IDIline.com

LEGEND		SHEET NOTES	
CARPET (CPT1)		CERAMIC TILE (CT1)	
SEALED CONCRETE (CONC)		VINYL COMPOSITION TILE (VCT1)	
*REF. SPECIFICATIONS		1. REFER TO A6.0 FOR FLOOR FINISH DESIGNATIONS	

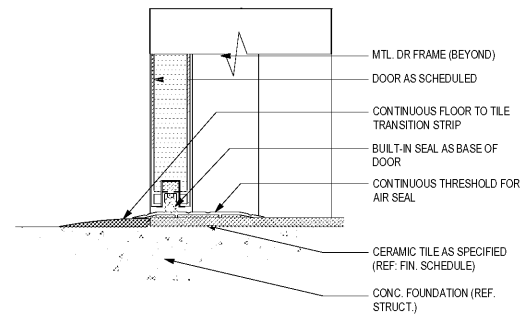

DETAIL @ TS4

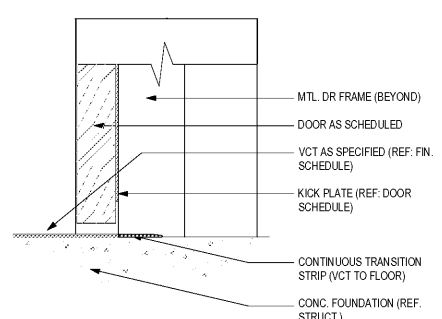

DETAIL @ TS3

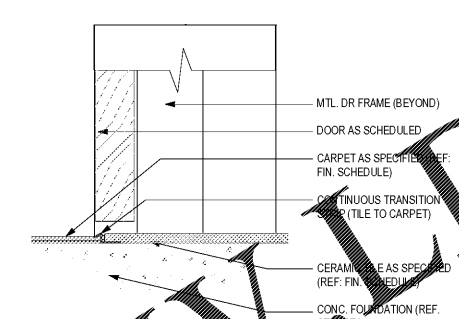

DETAIL @ TS2

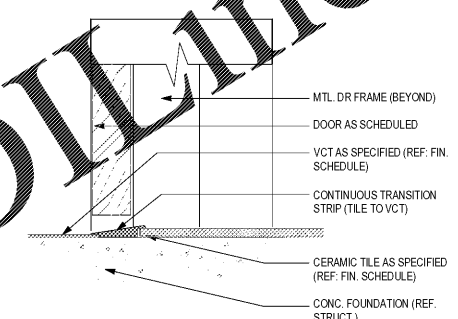

DETAIL @ TS1

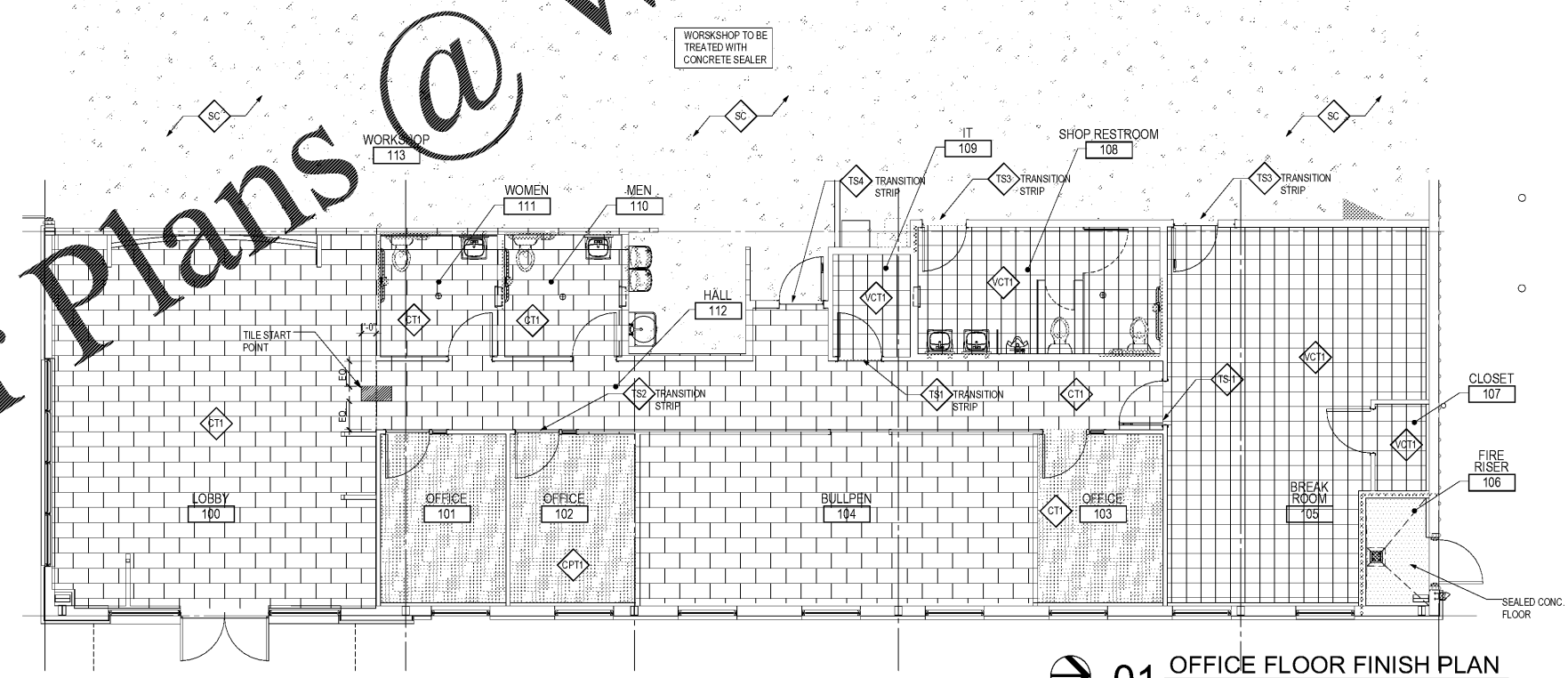

CLIENT NAME
Cross Development
4536 Marshall Road
Carrilton, TX 75010

PROJECT NAME
Caliber Collision Five Forks (161)
1215 East Buller Rd
Greenville, SC 29607

RELEASE
PERMIT COMMENTS RESPONSE - 08/27/2020

PROJECT NO.
2200057

DATE
07/08/2020

DRAWN
JJ

CHECKED
CD

STATE OF SOUTH CAROLINA
JEFFREY R. SUCHAN
ARCHITECTS & ENGINEERS
ORLANDO, FL
No. 8871
REGISTERED PROFESSIONAL ENGINEER
10/27/2020

SHEET TITLE
Floor Finish Plan

1925 Prospect Av.
Orlando, FL 32814
P (407) 661-9100
F (407) 661-9101
www.cp.com
Florida Corporate Certificate #AA 0006256

Chauhan & Peterson
Architects Engineers Planners
ORLANDO • PHILADELPHIA