

THIS DRAWING IS THE PROPERTY OF MAXDESIGN GROUP, AND IS NOT TO BE REPRODUCED OR COPIED IN WHOLE OR IN PART. IT IS NOT TO BE USED ON ANOTHER PROJECT AND SHALL BE RETURNED UPON REQUEST.

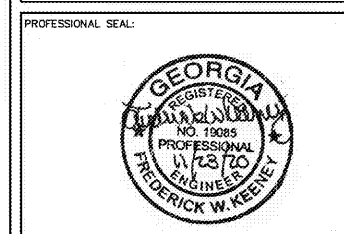

PROJECT TITLE:
**MARKET PLACE
 AT LOCUST
 GROVE SHOPS
 PHASE 2**
 LOCUST GROVE, GEORGIA

PROJECT INFO:
 4959 BILL GARDNER PARKWAY
 LOCUST GROVE, GA 30248

OWNER:
IP ILG, LLC
 JACOB LANG
 912.655.3438

PRINT RECORD

Description	Date

REVISION

No.	Description	Date

**DOMESTIC
 FLOOR PLAN
 & SPECIFICATIONS**

Project number: 020-101
 Date: 10/26/2020
 Drawn by: RK
 Checked by: RK

P-102

Scale: AS NOTED

ISSUED FOR CONSTRUCTION

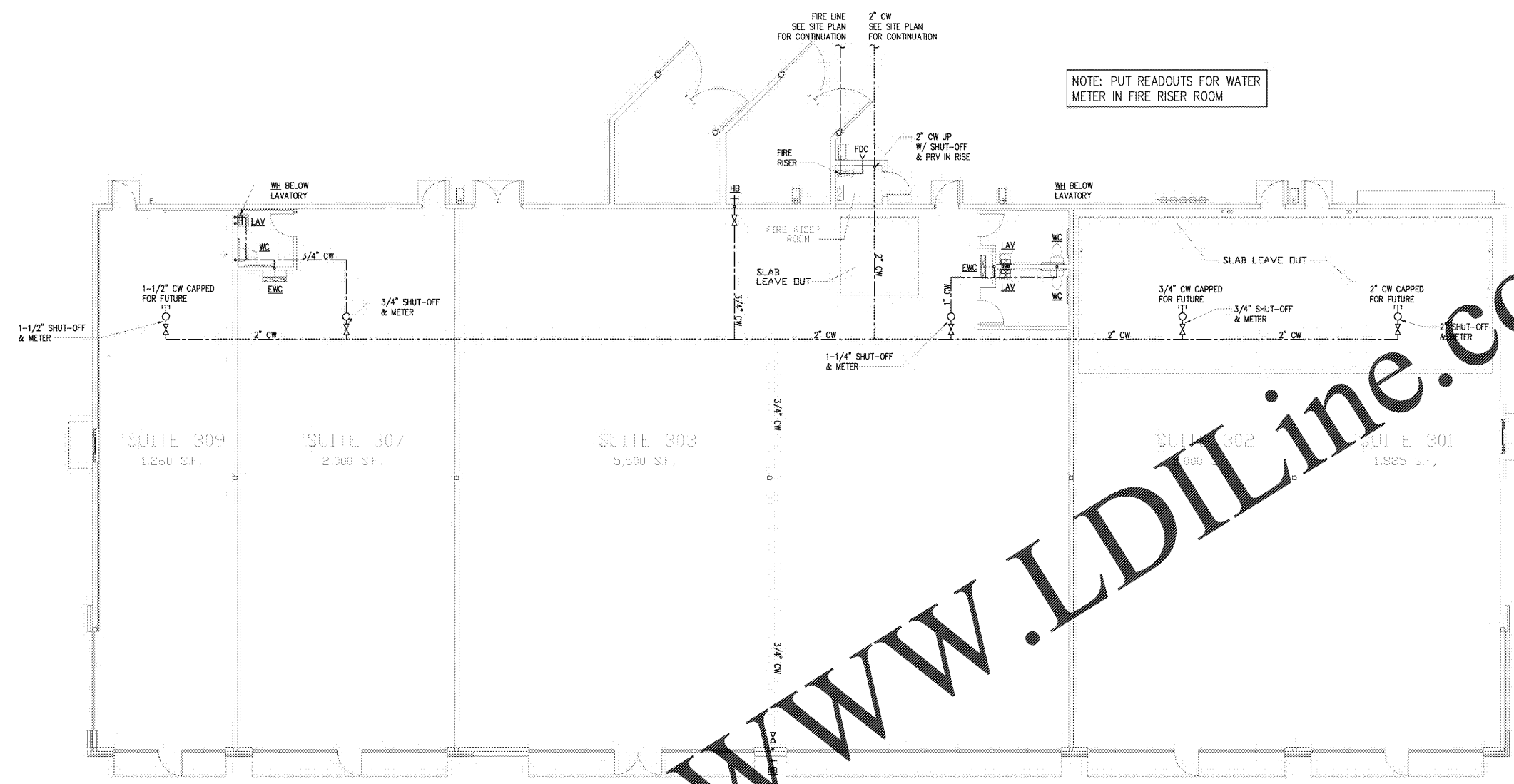

NOTE: PUT READOUTS FOR WATER METER IN FIRE RISER ROOM

www.LDILine.com

1
 P-102
 DOMESTIC FLOOR PLAN
 1/8" = 1'-0"

- PLUMBING NOTES AND SPECIFICATIONS**
- FURNISH ALL LABOR, MATERIAL, AND EQUIPMENT REQUIRED FOR A COMPLETE PLUMBING SYSTEM IN ACCORDANCE WITH ALL NATIONAL, STATE, AND LOCAL CODES.
 - FURNISH AND INSTALL ALL SYSTEMS OF SOIL, WASTE, AND VENT PIPING, HOT & COLD WATER PIPING, AND DRAINAGE PIPING INCLUDING ALL FITTINGS, VALVES, ETC. AS REQUIRED.
 - FURNISH AND INSTALL ALL PLUMBING FIXTURES AND EQUIPMENT AS SHOWN ON THE DRAWINGS.
 - ALL PLUMBING WORK SHALL BE DONE UNDER THE SUPERVISION OF AND BY LICENSED AND QUALIFIED PLUMBERS PER ALL LOCAL, STATE, AND NATIONAL CODES AND TO THE COMPLETE SATISFACTION OF THE LOCAL PLUMBING INSPECTOR.
 - SUBMISSION OF A BID OR PROPOSAL SHALL BE CONSTRUED AS EVIDENCE THAT THE CONTRACTOR HAS FAMILIARIZED HIMSELF WITH THE PLANS, SPECIFICATIONS, AND BUILDING SITE. CLAIMS MADE SUBSEQUENT TO BIDS FOR MATERIALS AND/OR LABOR DUE TO DIFFICULTIES ENCOUNTERED WILL NOT BE RECOGNIZED, UNLESS DIFFICULTIES COULD NOT HAVE BEEN FORESEEN EVEN THOUGH PROPER EXAMINATION HAD BEEN MADE.
 - CONTRACTOR SHALL BE RESPONSIBLE FOR ALL UTILITY CONNECTIONS AND SHALL BEAR ALL COSTS OF REPAIRING ANY WATER DAMAGE.
 - ALL MATERIALS SHALL BE NEW, CLEAN, AND WITHOUT DEFECTS. ANY DEFECTIVE MATERIALS SHALL BE REMOVED FROM THE JOB SITE.
 - ALL PLUMBING PIPING SHALL BE CONCEALED WITHIN THE BUILDING STRUCTURE AND ABOVE CEILINGS.
 - ALL HOT AND COLD WATER PIPING SHALL BE COPPER TYPE "L".
 - ALL COPPER DOMESTIC PIPING SHALL HAVE SOLDER JOINTS, 95-5 NO-LEAD SOLDER, AND SUPPORTED ADEQUATELY FROM STRUCTURE WITH SPLIT RING HANGERS.
 - COLD WATER PIPING IN UNCONDITIONED SPACES AND ALL HOT WATER PIPING SHALL BE INSULATED WITH 1/2" THICK PRE-FORMED FOAM PIPE INSULATION BY IMCOLOCK. INSULATE FITTINGS WITH MITERED SECTIONS.
 - SANITARY, WASTE, AND VENT PIPING ABOVE GRADE SHALL BE NO-HUB CAST IRON OR ASTM D2665-81 PVC SCHEDULE 40 PIPE.
 - CLEANOUT PLUGS SHALL BE INSTALLED IN ACCORDANCE WITH PLUMBING CODE REQUIREMENTS AT EACH CHANGE IN DIRECTION & AT THE BASE OF EACH SANITARY STACK. CLEANOUTS SHALL BE PLACED IN READILY ACCESSIBLE LOCATIONS.

- PLUMBING FIXTURES (OR APPROVED EQUAL)**
- HB Hose Bibb - Freezeless - Woodford Model B65 with anti-siphon vacuum breaker, self draining design & enclosure.
 - FD Floor Drain - Jay R. Smith 2005-A5NB-U with cast iron body with Type "A" strainer.
 - TP Trap Primer - Precision Plumbing Products "Oregon #1" with soft copper tubing to drain.
 - WC Water Closet - Floor Mounted - Tank type - ADA - American Standard 2835.126 Cadet 3 Flowise (16-1/2" high) elongated water sewer, 1.28 GPF, white vitreous china toilet, siphon jet action, close coupled tank and two bolt caps. Seat to be 590.100 white solid plastic open front heavy duty seat. Handle shall be installed on wide side of toilet.
 - LAV Lavatory - Wall Hung - American Standard 0321.026 Declyn white vitreous china lavatory, with wall hanger, Delta 5011F-HGMHDF 4" centerset faucet with chrome single lever handle & a 0.5 GPM flow rate, McGuire 155A grid drain assembly, with 1-1/4" tailpiece, McGuire 8872 1-1/4" P-trap with cleanout, McGuire 170 supplies with wheel handle stops & escutcheons.
 - WH Water Heater - Electric - Chromalox Model SR-30L capable of 49F temperature rise at 0.5 GPM with 3.6 KW electrical input at 120 volt.
 - EWC Electric Water Cooler - Wall Hung Hi-Low - Acom A112108F with self closing front & side pressbars.
- PROVIDE VALVES IN DOMESTIC WATER SYSTEM TO CUT-OFF WATER SERVICE MAIN INSIDE THE BUILDING, AT EACH WALL DRAIN. ISOLATE EACH FIXTURE IN THE BUILDING.
 - PROVIDE BACK-FLOW PREVENTER AND SHUT-OFF VALVES ON WATER METER, OR AS SHOWN. WATTS SERIES WITH MAIN TO METER.
 - PROVIDE WATER PRESSURE REDUCING VALVE (WATTS) (SET AT 60 PSIG)
 - INSULATE ALL EXPOSED PIPING UNDER UNDERCAPPED LAVATORIES WITH TRUEBR.
 - FIRESTOPS SHALL BE PROSET "FIRESTOP PENETRATORS."
 - PROVIDE WATTS MODEL 15 WATER HAMMER ARRESTORS WHERE QUICK CLOSING VALVES ARE UTILIZED.
 - UPON COMPLETION OF THE WORK, TEST ALL PIPING SYSTEMS AS FOLLOWS:
 - DRAINAGE SYSTEMS INCLUDING SANITARY SEWERS, ROOF DRAINAGE, AND SANITARY VENTS: PLUG LOW POINTS OF SYSTEM AND FILL WITH WATER TO UPPERMOST OUTLET UP TO TWELVE (12) FEET HIGH, WHICHEVER IS LOWER. LET SYSTEM STAND FULL OF WATER WITH NO INDICATIONS OF LEAKS.
 - DOMESTIC HOT AND COLD WATER: 150 PSIG HYDROSTATIC TEST. HOLD HYDROSTATIC TESTS FOR A MINIMUM OF EIGHT (8) HOURS WITHOUT LOSS OF PRESSURE. HOLD AIR TESTS FOR A MINIMUM OF ONE HOUR WITHOUT SIGNIFICANT LOSS OF PRESSURE. WITH APPROVAL OF ARCHITECT, AIR TESTING MAY BE SUBSTITUTED FOR HYDROSTATIC TESTING IN FREEZING WEATHER.
 - RETESTING: RETEST PIPING FAILING INITIAL TESTS FOLLOWING CORRECTION OF DEFECTIVE WORK. REQUIREMENTS OF INITIAL TESTS SHALL APPLY.
 - EACH UNIT SHALL HAVE A SMALL DIGITAL WATER METER WITH REMOTE READOUT POSITIONED AFTER THE PRV AND BEFORE ANY BRANCH TAKEOFFS HAVE OCCURRED. ALL READOUTS SHALL TERMINATE IN A LOCKING WEATHERPROOF BOX TO BE LOCATED ON THE BUILDING BY THE ARCHITECT. CONTACT: MASTER METER, INC. 816 McKESSON DRIVE LONGVIEW, TX 35604 (214) 297-0635

