

PLOT DATE: 12/11/20 2:34 PM
 R:\07-Production\0206124\0206124-ICC.01 - Lake Lanier Islands Conference Center -\Production\Engineering\Design\LI Conference Center\0206124-ICC-EROS_INITIAL.dwg

EROSION CONTROL LEGEND

(Co)	CONSTRUCTION EXIT	(Di)	DIVERSION
(Tc-F)	TURBIDITY CURTAIN - FLOATING	(Sk)	SKIMMER
(Fr)	FILTER RING	(Ss)	SLOPE STABILIZATION
(Re)	RETAINING WALL	(St)	STORM OUTLET PROTECTION
(Rt-P)	RETROFIT (PERFORATED HALF-ROUND)	(Su)	SURFACE ROUGHENING
(Sd2-F)	INLET SEDIMENT TRAP (FILTER FABRIC)	(Ds1)	DISTURBED AREA STABILIZATION (MULCHING ONLY)
(Sd2-P)	INLET SEDIMENT TRAP (PIGS-IN-A-BLANKET)	(Ds2)	DISTURBED AREA STABILIZATION (TEMP. SEEDING)
(Sd1-S)	SEDIMENT BARRIER (SENSITIVE AREA)	(Ds3)	DISTURBED AREA STABILIZATION (PERM. SEEDING)
(Sd1-BB)	SEDIMENT BARRIER (BRUSH BARRIER)	(Ds4)	DISTURBED AREA STABILIZATION (SODDING)
(Sd4-C)	TEMPORARY SEDIMENT TRAP (ROCK OUTLET)		

NOTES:

- SEE SHEETS C54 THROUGH C57 FOR EROSION CONTROL NOTES AND DETAILS.
- SEE SHEET C55 FOR SEDIMENT CONTROL CALCULATIONS.

Order Plans @ WWW.LDILLINE.COM

GPS LOCATION
 LAT: 34.180270
 LONG: -84.032088

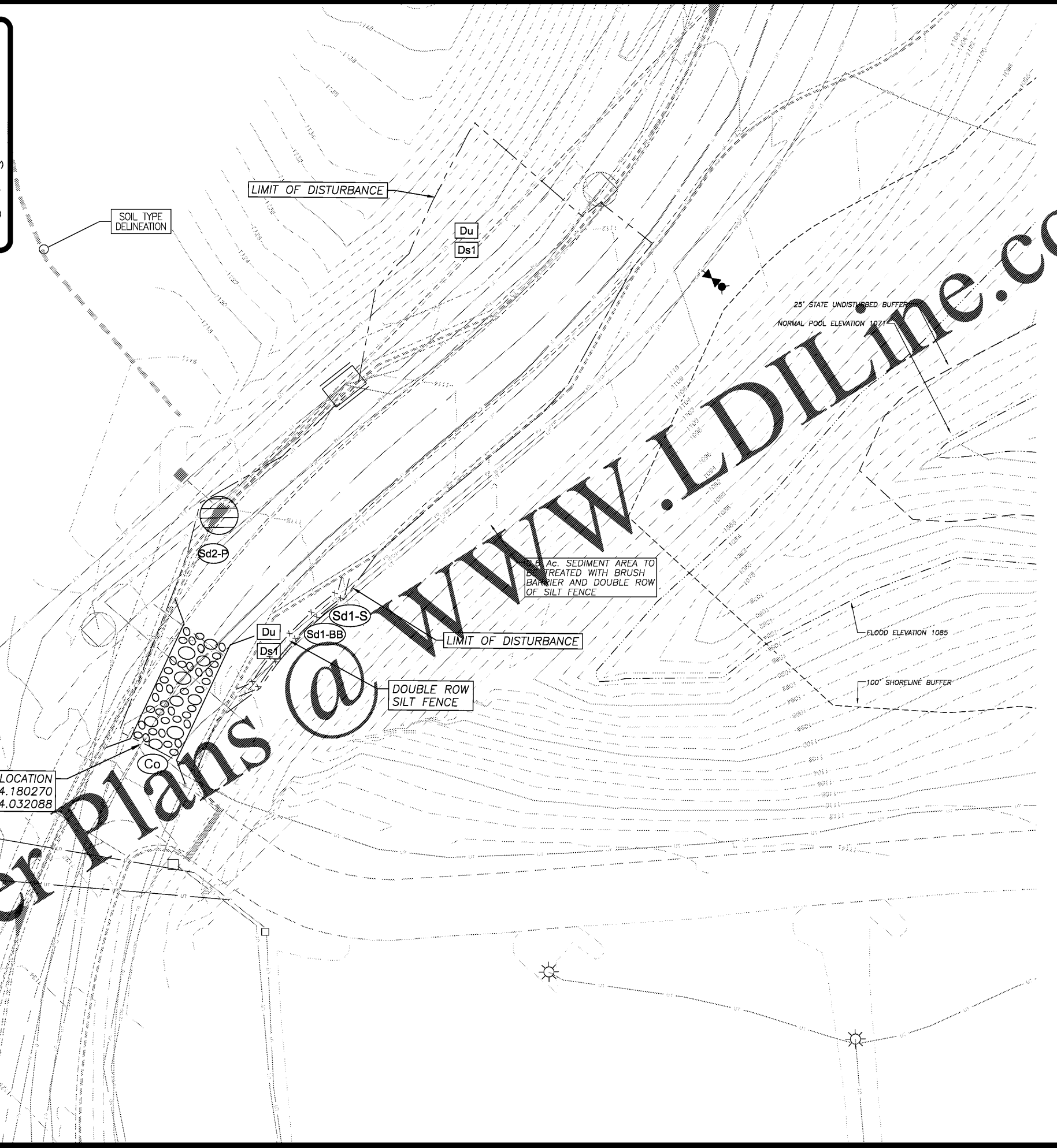

Rochester & Associates, Inc.
 200 Highway 115, Suite A • Fayetteville, Georgia 30214
 (770) 424-1122 (770) 424-1124 fax • www.rochesterinc.com

EROSION CONTROL PLAN 6 - INITIAL PH1
 FOR:
LANIER ISLANDS CONFERENCE CENTER
 LAND LOT 380
 7TH DISTRICT
 CITY OF BUFORD, HALL COUNTY, GEORGIA

REVISIONS

REV	DATE	DESCRIPTION

ANY CHANGES OR ALTERATIONS MADE TO THESE CONSTRUCTION DRAWINGS WITHOUT THE SIGNATURE OF THE ENGINEER OF RECORD OR ANY LIABILITY ASSOCIATED THEREWITH, SHALL BE VOID. ANY CHANGES MADE TO THESE DRAWINGS SHALL BE KEPT ON FILE FOR VERIFICATION OF ANY CHANGES.

GRAPHIC SCALE
 1" = 20'
 0" 20' 40'



SHEET
C39
 OF
C66
 DATE: 12-11-20
 SCALE: 1"=20'
 JOB NO.: 0206124-ICC.01
 REV'D BY: JNC
 DRAWN BY: JRS