

PLOT DATE: 12/11/20 2:33 PM
 RE: LDI-Production\2206124\ICC-01 - Lake Lanier Islands Conference Center -\Production\Engineering\Design\LDI Conference Center\2206124-ICC-EROS-INITIAL.dwg

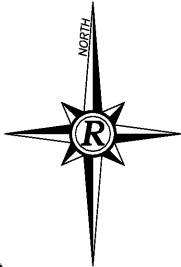

WWW.LDILine.com

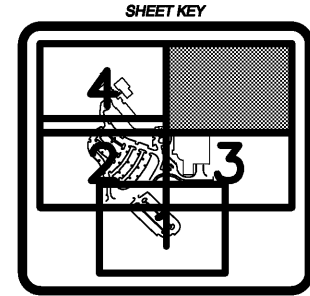
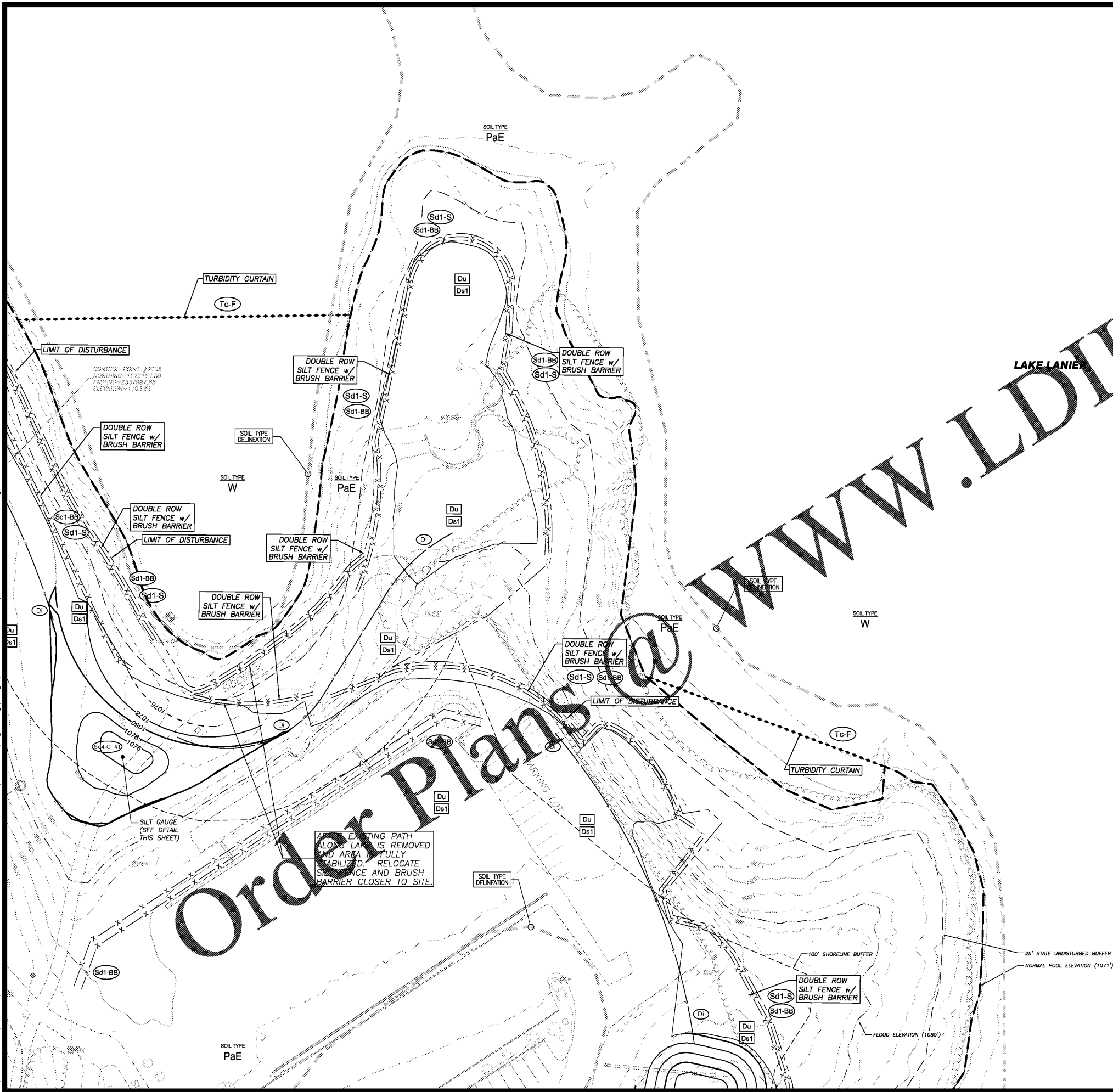
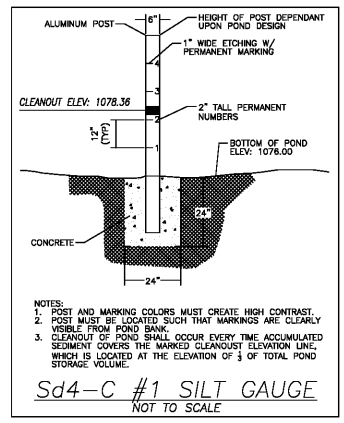

NOTES:
 1. SEE SHEETS C54 THROUGH C57 FOR EROSION CONTROL NOTES AND DETAILS.
 2. SEE SHEET C55 FOR SEDIMENT CONTROL CALCULATIONS.

EROSION CONTROL LEGEND			
(Co)	CONSTRUCTION EXIT	(DI)	DIVERSION
(Tc-F)	TURBIDITY CURTAIN - FLOATING	(Sk)	SKIMMER
(Fr)	FILTER RING	(Ss)	SLOPE STABILIZATION
(Re)	RETAINING WALL	(St)	STORM OUTLET PROTECTION
(Rt-P)	RETROFIT (PERFORATED HALF-ROUND)	(Su)	SURFACE ROUGHENING
(Sd2-F)	INLET SEDIMENT TRAP (FILTER FABRIC)	(Ds1)	DISTURBED AREA STABILIZATION (MULCHING ONLY)
(Sd2-P)	INLET SEDIMENT TRAP (PIGS-IN-A-BLANKET)	(Ds2)	DISTURBED AREA STABILIZATION (TEMP. SEEDING)
(Sd1-S)	SEDIMENT BARRIER (SENSITIVE AREA)	(Ds3)	DISTURBED AREA STABILIZATION (PERM. SEEDING)
(Sd1-BB)	SEDIMENT BARRIER (BRUSH BARRIER)	(Ds4)	DISTURBED AREA STABILIZATION (SODDING)
(Sd4-C)	TEMPORARY SEDIMENT TRAP (ROCK OUTLET)		



EROSION CONTROL PLAN 5 - INITIAL PH1
 FOR:
**LANIER ISLANDS
 CONFERENCE CENTER**
 LAND LOT 380
 7TH DISTRICT
 CITY OF BUFORD, HALL COUNTY, GEORGIA

REVISIONS	REV/DATE	DESCRIPTION

ANY CHANGES OR ALTERATIONS MADE TO THESE CONSTRUCTION DRAWINGS WITHOUT THE SIGNATURE OF THE PROFESSIONAL ENGINEER AND ANY LIABILITY ASSOCIATED THEREWITH ARE KEPT ON FILE FOR VERIFICATION OF ANY CHANGES.
 GRAPHIC SCALE: 1" = 30' 60'



SHEET
C38
 OF
C66
 DATE: 12-11-20
 SCALE: 1"=30'
 JOB NO.: 6268154.02-01
 REV'D BY: JNC
 DRAWN BY: JRS