

SOIL SERIES CHART					
SYM	SOIL SERIES	SLOPE CLASS	HYDRO GROUP	K FACTOR (NRCS)	T FACTOR (NRCS)
PaE	PACOLET-SANDY LOAM	15-25	B	0.17	5
PuD2	PACOLET	10-15	B	0.24	5
W	WATER	-	-	-	-

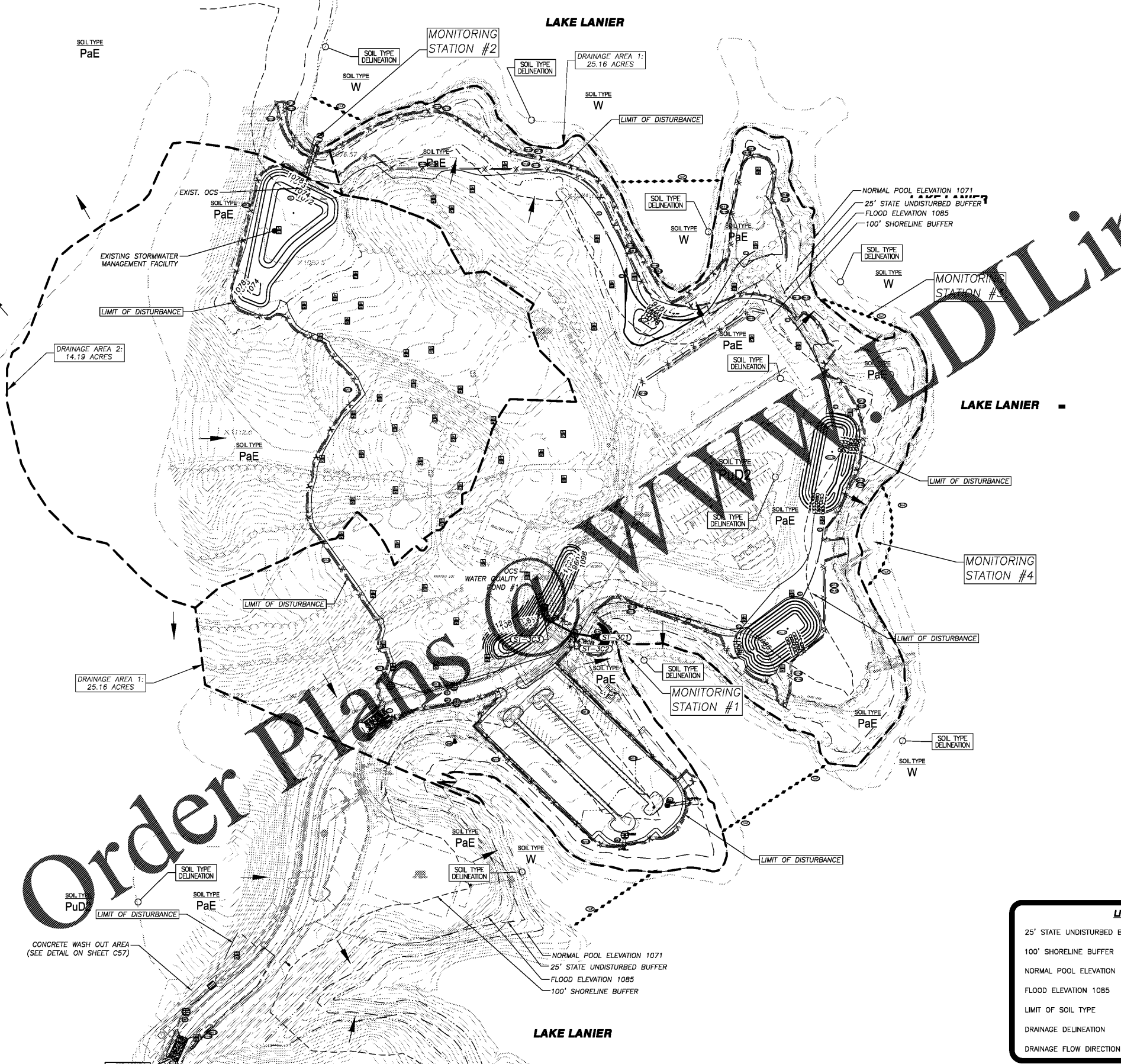
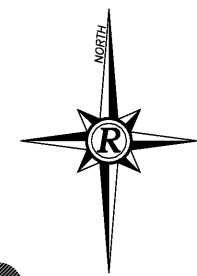

EROSION CONTROL LEGEND			
(Co)	CONSTRUCTION EXIT	(Di)	DIVERSION
(Tc-F)	TURBIDITY CURTAIN - FLOATING	(Sk)	SKIMMER
(Fr)	FILTER RING	(Ss)	SLOPE STABILIZATION
(Re)	RETAINING WALL	(St)	STORM OUTLET PROTECTION
(Rt-P)	RETROFIT (PERFORATED HALF-ROUND)	(Su)	SURFACE ROUGHENING
(Sd2-F)	INLET SEDIMENT TRAP (FILTER FABRIC)	(Ds1)	DISTURBED AREA STABILIZATION (MULCHING ONLY)
(Sd2-P)	INLET SEDIMENT TRAP (PIGS-IN-A-BLANKET)	(Ds2)	DISTURBED AREA STABILIZATION (TEMP. SEEDING)
(Sd1-S)	SEDIMENT BARRIER (SENSITIVE AREA)	(Ds3)	DISTURBED AREA STABILIZATION (PERM. SEEDING)
(Sd1-BB)	SEDIMENT BARRIER (BRUSH BARRIER)	(Ds4)	DISTURBED AREA STABILIZATION (SODDING)
(Sd4-C)	TEMPORARY SEDIMENT TRAP (ROCK OUTLET)		

DESIGN PROFESSIONAL EROSION CONTROL CERTIFICATION:
 (1) I CERTIFY THAT THE PERMITTEE'S EROSION, SEDIMENTATION AND POLLUTION CONTROL PLAN PROVIDES FOR AN APPROPRIATE AND COMPREHENSIVE SYSTEM OF BEST MANAGEMENT PRACTICES REQUIRED BY THE GEORGIA WATER QUALITY CONTROL ACT AND THE DOCUMENT "MANUAL FOR EROSION AND SEDIMENT CONTROL GEORGIA" (MANUAL) PUBLISHED BY THE STATE SOIL AND WATER CONSERVATION COMMISSION AS OF JANUARY 1 OF THE YEAR IN WHICH THE LAND-DISTURBING ACTIVITY WAS PERMITTED, PROVIDES FOR THE SAMPLING OF THE RECEIVING WATER(S) OR THE SAMPLING OF THE STORM WATER OUTFALLS AND THAT THE DESIGNED SYSTEM OF BEST MANAGEMENT PRACTICES AND SAMPLING METHODS IS EXPECTED TO MEET THE REQUIREMENTS CONTAINED IN THE GENERAL NPDES PERMIT NO. GAR 100001.
 (2) I CERTIFY UNDER PENALTY OF LAW THAT THIS PLAN WAS PREPARED AFTER A SITE VISIT TO THE LOCATIONS DESCRIBED HEREIN BY MYSELF OR MY AUTHORIZED AGENT, UNDER MY DIRECT SUPERVISION.
 (3) I CERTIFY THAT THE PERMITTEE'S EROSION, SEDIMENTATION AND POLLUTION CONTROL PLAN PROVIDES FOR THE MONITORING OF: (A) ALL PERENNIAL AND INTERMITTENT STREAMS AND OTHER WATER BODIES, OR (B) WHERE ANY SUCH SPECIFIC IDENTIFIED PERENNIAL OR INTERMITTENT STREAM AND OTHER WATER BODY IS NOT PROPOSED TO BE SAMPLED, I HAVE DETERMINED IN MY PROFESSIONAL JUDGMENT, UTILIZING THE FACTORS REQUIRED IN THE GENERAL NPDES PERMIT NO. GAR 100001, THAT THE INCREASE IN THE TURBIDITY OF EACH SPECIFIC IDENTIFIED SAMPLED RECEIVING WATER WILL BE REPRESENTATIVE OF THE INCREASE IN THE TURBIDITY OF A SPECIFIC IDENTIFIED UN-SAMPLED RECEIVING WATER."

Jeff Collins
 JEFF COLLINS, PE
 12-11-20
 CERTIFICATION #13400

EROSION CONTROL PLAN - INITIAL OVERALL
 FOR:
**LANIER ISLANDS
 CONFERENCE CENTER**
 LAND LOT 380
 7TH DISTRICT
 CITY OF BUFORD, HALL COUNTY, GEORGIA

REVISIONS	REV	DATE	DESCRIPTION

ANY CHANGES OR ALTERATIONS MADE TO THESE CONSTRUCTION DRAWINGS WITHOUT THE SIGNATURE AND SEAL OF THE ASSOCIATED PROFESSIONAL ENGINEER ARE VOID AND ANY LIABILITY ASSOCIATED WITH THESE DRAWINGS SHALL BE THE RESPONSIBILITY OF THE ASSOCIATED PROFESSIONAL ENGINEER.
 GRAPHIC SCALE
 0' 100' 200'

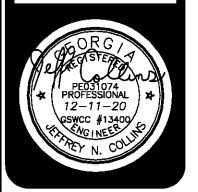

LINETYPE LEGEND	
---	25' STATE UNDISTURBED BUFFER
----	100' SHORELINE BUFFER
.....	NORMAL POOL ELEVATION 1071
-----	FLOOD ELEVATION 1085
.....	LIMIT OF SOIL TYPE
-----	DRAINAGE DELINEATION
----->	DRAINAGE FLOW DIRECTION

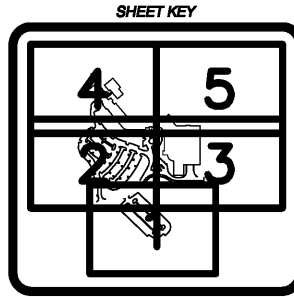

SHEET
C33
 OF
C66
 DATE: 12-11-20
 SCALE: 1"=100'
 JOB NO.: 6206164.KCZ.01
 REV'D BY: JNC
 DRAWN BY: JRS

PLOT DATE: 12/11/20 2:33 PM
 R:\07-Production\6206164\6206164-ICC.01 - Lake Lanier Islands Conference Center -\Production\Engineering\Design\LLI Conference Center\6206164-ICC-EROS-INITIAL.dwg

Order Plans

www.dline.com