

PLOT DATE: 12/11/20 2:24 PM
 R:\07-Production\0206124\0206124-ICC-01 - Lake Lanier Islands Conference Center -\Production\Engineering\Design\LLI Conference Center\0206124-ICC-SITE.dwg

HATCH LEGEND

	REINFORCED TURF
	CONCRETE SIDEWALKS
	HEAVY DUTY CONCRETE
	STAMPED CONCRETE SEE LANDSCAPE PLANS
	ASPHALT OVERLAY
	BUILDING
	HEAVY DUTY PAVEMENT
	LIGHT DUTY PAVEMENT

LEGEND

AIF	- ANGLE IRON FOUND
AKA	- ALSO KNOWN AS
BC	- BACK OF CURB
BL	- BUILDING SETBACK LINE
BWF	- BARS WIRE FENCE
CKG	- CURB & GUTTER
C/T	- CRIMP TOP PIPE
CI	- CURB INLET
CL	- CENTER LINE
CLF	- CHAIN LINK FENCE
CMF	- CONCRETE MONUMENT FOUND
CMP	- CORRUGATED METAL PIPE
CO	- CLEAN OUT
CONC	- CONCRETE
CORPS	- US ARMY CORPS OF ENGINEERS
DB/PG	- DEED BOOK PAGE
DI	- DROP INLET
DIP	- DUCTILE IRON PIPE
DS	- DOWN SPOUT
DWCB	- DOUBLE WING CATCH BASIN
EP	- EDGE OF PAVEMENT
FFE	- FINISH FLOOR ELEVATION
FH	- FIRE HYDRANT
-G-	- GAS LINE
GM	- GAS METER
GP	- GUY POLE
GV	- GAS VALVE
GW	- GUY WIRE
HC	- HANDICAP
HW	- HEADWALL
HWF	- HOG WIRE FENCE
IE	- INVERT ELEVATION
IFP	- IRON PIN FOUND
IPS	- IRON PIN SET
JB	- JUNCTION BOX
LL	- LAND LOT
LLL	- LAND LOT LINE
LP	- LIGHT POLE
MH	- MANHOLE
MON	- MONUMENT
N/F	- NOW OR FORMERLY
OIT	- OPEN TOP PIPE
PBX	- POWER BOX / TRANSFORMER
-P-	- OVERHEAD POWER LINE
-PT-	- OVERHEAD POWER & TELEPHONE LINE
PL	- PROPERTY LINE
PM	- POWER METER
POB	- POINT OF BEGINNING
PP	- POWER POLE
PTP	- POWER & TELEPHONE POLE
PVC	- POLYVINYLCHLORIDE PIPE
R/B	- REINFORCING IRON BAR
RCP	- REINFORCED CONCRETE PIPE
R/W	- RIGHT OF WAY
-SS-	- SANITARY SEWER LINE
SSE	- SANITARY SEWER EASEMENT
SW	- SIDEWALK
SWCB	- SINGLE WING CATCH BASIN
TBM	- TEMPORARY BENCHMARK
TBX	- TELEPHONE BOX
TF	- TRANSFORMER
TMH	- TELEPHONE MANHOLE
TP	- TELEPHONE POLE
TPOB	- TRUE POINT OF BEGINNING
-T-	- OVERHEAD TELEPHONE LINE
UP	- UNDERGROUND POWER
UT	- UNDERGROUND TELEPHONE
WI	- WEIR INLET
-W-	- WATER LINE
WM	- WATER METER
WMH	- WATER MANHOLE
WV	- WATER VALVE

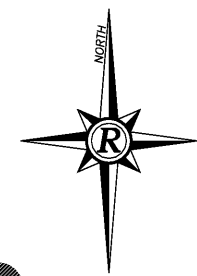
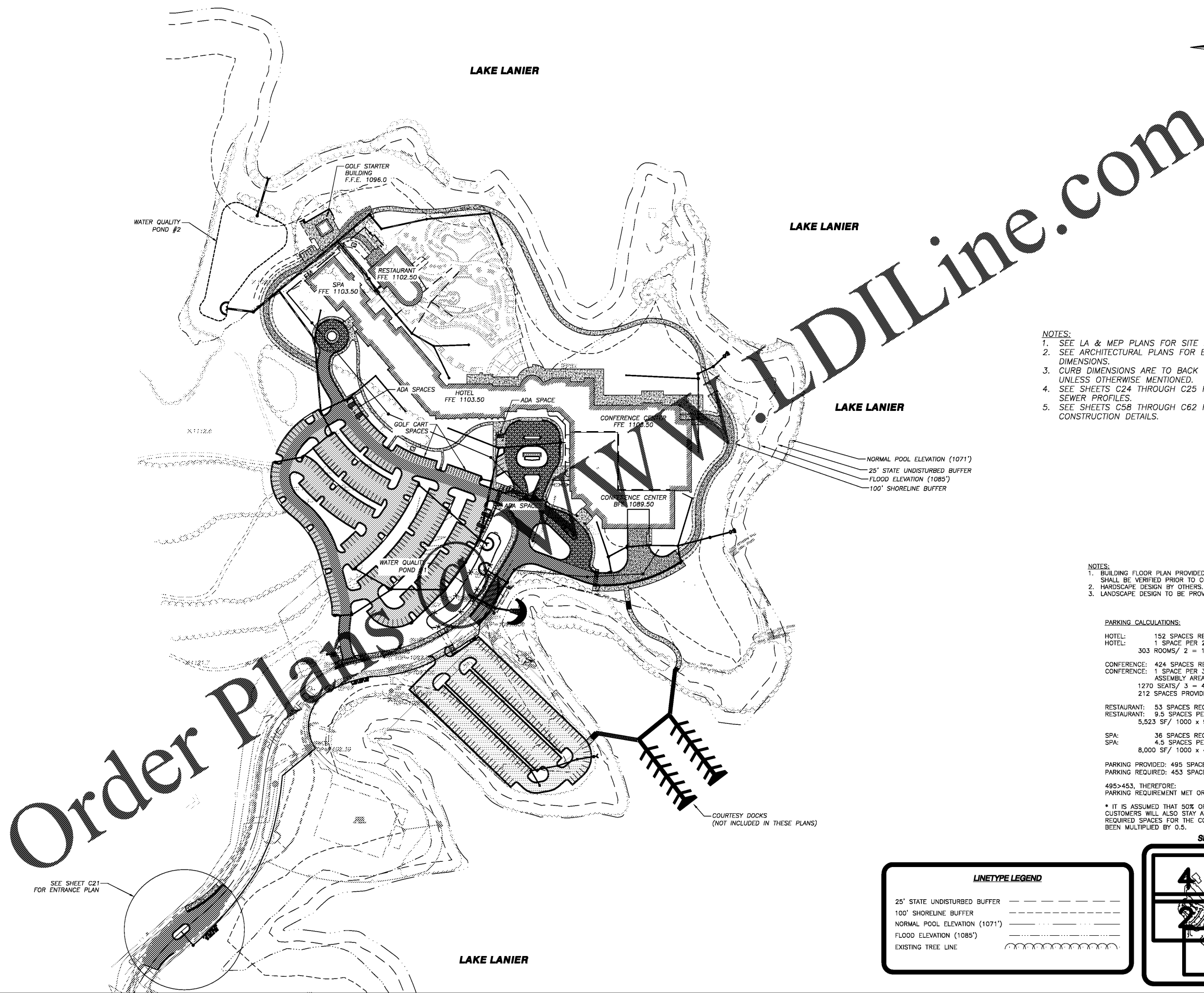

LDILine.com

- NOTES:**
1. SEE LA & MEP PLANS FOR SITE LIGHTING PLANS.
 2. SEE ARCHITECTURAL PLANS FOR EXACT BUILDING DIMENSIONS.
 3. CURB DIMENSIONS ARE TO BACK OF CURB UNLESS OTHERWISE MENTIONED.
 4. SEE SHEETS C24 THROUGH C25 FOR SANITARY SEWER PROFILES.
 5. SEE SHEETS C58 THROUGH C62 FOR CONSTRUCTION DETAILS.

- NOTES:**
1. BUILDING FLOOR PLAN PROVIDED BY OTHERS AND SHALL BE VERIFIED PRIOR TO CONSTRUCTION.
 2. HARDSCAPE DESIGN BY OTHERS.
 3. LANDSCAPE DESIGN TO BE PROVIDED BY OTHERS.

PARKING CALCULATIONS:

HOTEL:	152 SPACES REQUIRED
HOTEL:	1 SPACE PER 2 ROOMS
303 ROOMS / 2 =	152 SPACES
CONFERENCE:	424 SPACES REQUIRED
CONFERENCE:	1 SPACE PER 3 SEATS FOR LARGEST ASSEMBLY AREA
1270 SEATS / 3 =	424 SPACES *
212 SPACES PROVIDED (SEE NOTE BELOW)	
RESTAURANT:	53 SPACES REQUIRED
RESTAURANT:	9.5 SPACES PER 1,000SF
5,523 SF / 1000 x 9.5 =	53 SPACES
SPA:	36 SPACES REQUIRED
SPA:	4.5 SPACES PER 1,000SF
8,000 SF / 1000 x 4.5 =	36 SPACES
PARKING PROVIDED:	495 SPACES (INCLUDES 9 ADA)
PARKING REQUIRED:	453 SPACES (9 ADA REQ'D)
495 > 453, THEREFORE:	PARKING REQUIREMENT MET OR EXCEEDED

* IT IS ASSUMED THAT 50% OF THE CONFERENCE CUSTOMERS WILL ALSO STAY AT HOTEL. THEREFORE REQUIRED SPACES FOR THE CONFERENCE CENTER HAVE BEEN MULTIPLIED BY 0.5.

LINETYPE LEGEND

25' STATE UNDISTURBED BUFFER	-----
100' SHORELINE BUFFER	-----
NORMAL POOL ELEVATION (1071')	-----
FLOOD ELEVATION (1085')	-----
EXISTING TREE LINE	~~~~~

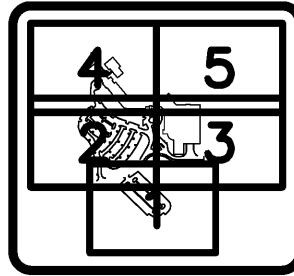

Rochester & Associates, Inc.
 288 Highway 215, Suite A • Fayetteville, Georgia 30214
 (770) 424-1111 • www.rochesterassoc.com

OVERALL SITE & UTILITY PLAN
 FOR:
LANIER ISLANDS CONFERENCE CENTER
 LAND LOT 380
 7TH DISTRICT
 CITY OF BUFORD, HALL COUNTY, GEORGIA

REVISIONS

NO.	REV./DATE	DESCRIPTION

ANY CHANGES OR ALTERATIONS MADE TO THESE CONSTRUCTION DRAWINGS WITHOUT THE SIGNATURE OF THE PROFESSIONAL ENGINEER AND ANY LIABILITY ASSOCIATED THEREWITH ARE HEREBY DISCLAIMED. ANY CHANGES ARE KEPT ON FILE FOR VERIFICATION OF ANY CHANGES.

GRAPHIC SCALE
 0' 100' 200'

GEORGIA REGISTERED PROFESSIONAL ENGINEER
 12-11-20
 #13400
 KEFREY N. COLLINS

SHEET
C9
 OF
C66
 DATE: 12-11-20
 SCALE: 1"=100'
 JOB NO.: 0206124-ICC-01
 REV'D BY: JNC
 DRAWN BY: JRS