

USER: 6675 - Dec 18, 2020 - 3:31pm
Z:\All Project Data\Projects\2019\19-LD-090 Circle K Cordele GA\LD\Production\Drawings\19-LD-090 MAIN.dwg - LAYOUT: ES-2 VERSION: 0000

REPRESENTS NOTE/FEATURE WHICH CORRESPONDS WITH THE ES&PC PLAN CHECKLIST. SEE SHEET ES-4 FOR ES&PC CHECKLIST.

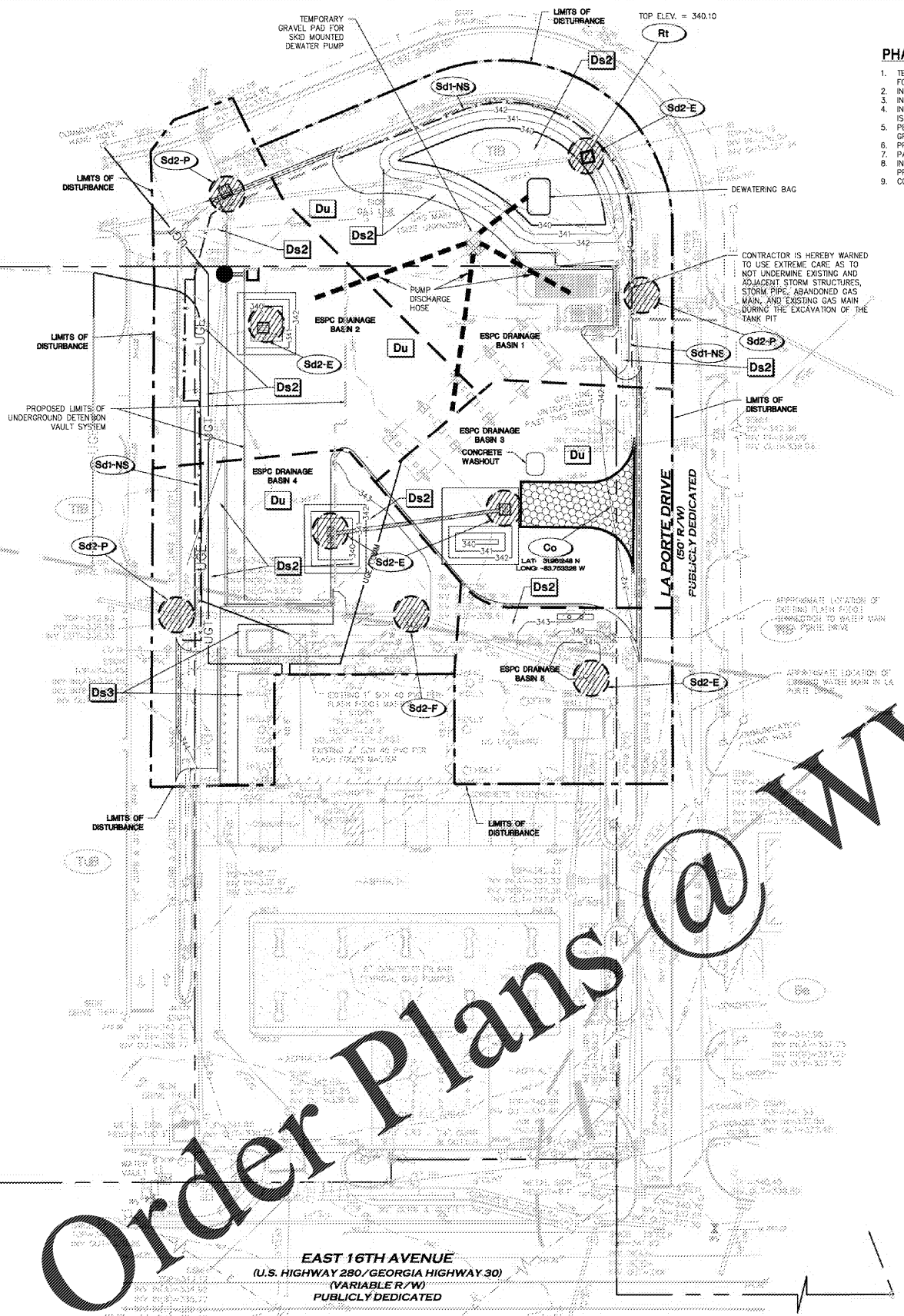

Order Plans @ www.wildfire.com



PHASE II

1. TEMPORARY SEED, THROUGHOUT CONSTRUCTION, DENIED AREAS THAT WILL BE INACTIVE FOR 14 DAYS OR MORE.
2. INSTALL UTILITIES, UNDERDRAINS, STORM SEWERS, CURBS AND OUTLETS.
3. INSTALL RIP-RAP AROUND OUTLET STRUCTURES AS EACH OUTLET STRUCTURE IS INSTALLED.
4. INSTALL INLET PROTECTION AT ALL STORM SEWER STRUCTURES AS EACH INLET STRUCTURE IS INSTALLED.
5. PERMANENTLY STABILIZE AREAS TO BE VEGETATED AS THEY ARE BROUGHT TO FINAL GRADE.
6. PREPARE SITE FOR PAVING.
7. PAVE SITE.
8. INSTALL APPROPRIATE INLET PROTECTION DEVICES FOR PAVED AREAS AS WORK PROGRESSES.
9. COMPLETE GRADING AND INSTALLATION OF PERMANENT STABILIZATION OVER ALL AREAS.

CONTRACTOR IS HEREBY WARNED TO USE EXTREME CARE AS TO NOT UNDERMINE EXISTING AND ADJACENT STORM STRUCTURES, STORM PIPE, ABANDONED GAS MAIN, AND EXISTING GAS MAIN DURING THE EXCAVATION OF THE TANK PIT.

APPROXIMATE LOCATION OF 48\"

APPROXIMATE LOCATION OF 48\"

ACREAGE SUMMARY
(IN ACRES)

SITE AREA	1.72 AC
ON-SITE DISTURBED AREA	0.90 AC
OFF-SITE DISTURBED AREA	1.61 AC
TOTAL DISTURBED AREA	1.51 AC
IMPERVIOUS AREA AT COMPLETION	0.74 AC
PERVIOUS AREA AT COMPLETION	0.44 AC

TEMPORARY SEDIMENT BASIN #1 CALCULATIONS

Drainage Area = 0.43 AC
Disturbed Area = 0.43 AC
Sediment Storage Required = 28.81 CY (67 CY/AC.)
Sediment Storage Provided = 44.08 CY
Cleanout Volume Required = 9.46 CY (22 CY/AC.)
Cleanout Volume Provided = 9.62 CY
Cleanout Volume Elevation = 340.10

TEMPORARY SEDIMENT BASIN #2 CALCULATIONS

Drainage Area = 0.33 AC
Disturbed Area = 0.33 AC
Sediment Storage Required = 22.11 CY (67 CY/AC.)
Sediment Storage Provided = 32.97 CY
Cleanout Volume Required = 7.26 CY (22 CY/AC.)
Cleanout Volume Provided = 11.89 CY
Cleanout Volume Elevation = 340.00

TEMPORARY SEDIMENT BASIN #3 CALCULATIONS

Drainage Area = 0.24 AC
Disturbed Area = 0.24 AC
Sediment Storage Required = 16.08 CY (67 CY/AC.)
Sediment Storage Provided = 17.36 CY
Cleanout Volume Required = 5.28 CY (22 CY/AC.)
Cleanout Volume Provided = 6.18 CY
Cleanout Volume Elevation = 341.50

TEMPORARY SEDIMENT BASIN #4 CALCULATIONS

Drainage Area = 0.34 AC
Disturbed Area = 0.34 AC
Sediment Storage Required = 22.87 CY (67 CY/AC.)
Sediment Storage Provided = 39.62 CY
Cleanout Volume Required = 7.48 CY (22 CY/AC.)
Cleanout Volume Provided = 14.75 CY
Cleanout Volume Elevation = 341.00

TEMPORARY SEDIMENT BASIN #5 CALCULATIONS

Drainage Area = 0.10 AC
Disturbed Area = 0.10 AC
Sediment Storage Required = 6.70 CY (67 CY/AC.)
Sediment Storage Provided = 11.78 CY
Cleanout Volume Required = 2.20 CY (22 CY/AC.)
Cleanout Volume Provided = 2.85 CY
Cleanout Volume Elevation = 341.25

DEVELOPER/OWNER:
CIRCLE K - SOUTH ATLANTIC DIVISION
215 PENDLETON ST.
WAYCROSS, GA 31501
(912) 490-2327

SITE OPERATOR/GENERAL CONTRACTOR:

SUPERINTENDENT:

24 HR LOCAL EMERGENCY CONTACT

REBECCA THOMPEN (912) 387-7259
CIRCLE K - SOUTH ATLANTIC DIVISION

(CONTRACTOR'S NAME) (PHONE NUMBER)

NOTE: CONTRACTOR TO PROVIDE UPDATED INFORMATION ONCE CONTRACT IS AWARDED.

NOTE: SEE SURVEY FOR EXISTING LEGEND SYMBOLS

SOIL SERIES LEGEND

Se STILSON LOAMY SAND, 0-2% SLOPES, HSG
TfB TWIN LOAMY SAND, 2-5% SLOPES, HSG
TuB TWIN LOAMY SAND, COMPLETELY, 2-5% SLOPES, HSG

MULCHING SCHEDULE

MATERIAL	RATE/ACRE
STRAW OR HAY	2.5 TONS
WOOD WASTE, CHIPS, SAWDUST, OR BARK	6 TO 9 TONS (2 TO 3\"

TEMPORARY SEEDING SCHEDULE

SPECIES (MIXTURE OF)	RATE/ACRE	PLANTING DATES
SUDAN (SWEET OR TIF)	60 LBS	APRIL-SEPT 1
ANNUAL RYE GRASS	40 LBS	AUG 1-APRIL 15

NOTE: APPLY LIME AT THE RATE OF 1 TON/ACRE REFER TO ES-5 FOR FERTILIZER REQUIREMENTS

PERMANENT SEEDING SCHEDULE

SPECIES	RATE/ACRE	PLANTING DATES
COMMON BERMUDA (HULLED) (CYNODON DACTYLON)	10 LBS	MARCH 1-JULY 1
COMMON BERMUDA (UNHULLED) (CYNODON DACTYLON)	10 LBS	OCT 1-MAR 1
BAHIA PENSACOLA (PASPALUM NOTATUM)	60 LBS	JAN 1-DEC 31

NOTE: APPLY LIME AT THE RATE OF 1 TON/ACRE REFER TO ES-5 FOR FERTILIZER REQUIREMENTS

SOD PLANTING AND FERTILIZATION REQUIREMENTS

SPECIES	FERTILIZER (N-P-K)	RATE (lbs/AC)	NITROGEN TOP DRESSING RATE (lbs/AC)
BERMUDA GRASS (COMMON)	6-12-12	1,500	50-100

NOTE: APPLY LIME AT THE RATE OF 1 TON/ACRE REFER TO ES-5 FOR FERTILIZER REQUIREMENTS

PROVIDE TEMPORARY IRRIGATION OR WATERING, VIA WATER TRUCK, AS NEEDED TO ESTABLISH TEMPORARY AND PERMANENT VEGETATION UNTIL THE PERMANENT IRRIGATION SYSTEM IS FULLY FUNCTION OR UNTIL THE NOT IS SUBMITTED IF A PERMANENT IRRIGATION SYSTEM ISN'T PLANNED. AREAS NOT HAVING A PERMANENT IRRIGATION SYSTEM SHALL BE IRRIGATED OR WATERED UNTIL THE NOT HAS BEEN SUBMITTED AND ACCEPTED.

EROSION CONTROL LEGEND

- PROPERTY LINE
- - - LIMITS OF DISTURBANCE
- xxx CONTOUR ELEVATIONS
- STORM DRAIN
- SOIL SERIES BOUNDARY
- XX SILT FENCE
- TREE PROTECTION FENCE
- SWPPP INFORMATION SIGN
- TEMPORARY BARRICADE



LOCATION MAP

STRUCTURAL PRACTICES

CONSTRUCTION PRACTICE	DETAIL	MAP SYMBOL	DESCRIPTION
CONSTRUCTION EXIT			A crushed stone pad located at the construction site will provide a place for removing mud from tires thereby protecting public streets.
SEDIMENT BARRIER			A barrier to prevent sediment from leaving the construction site. It may be sandbags, bales of straw or hay, brush, logs and poles, grove, or a silt fence.
SOFT SWEEP TRAP			An impervious area created by excavating around a storm drain drop inlet. The excavated area will be filled and stabilized on completion of construction activities.
RETRO PITBOS			A device or structure placed in front of a permanent stormwater detention pond outlet structure to serve as a temporary sediment filter.
TREE PROTECTION			To protect desirable trees from injury during construction activity.
STORMWATER OUTLET PROTECTION			A silted or short section of riprap channel at the outlet of a storm water system preventing erosion from the concentrated runoff.

VEGETATIVE PRACTICES

CODE	PRACTICE	DETAIL	MAP SYMBOL	DESCRIPTION
Ds1	TEMPORARY AREA STABILIZATION (WITH MULCH ONLY)			Establishing temporary protection for disturbed areas where seedlings may not have a suitable growing season to produce an erosion reducing cover.
Ds2	TEMPORARY AREA STABILIZATION (WITH SOY SEEDING)			Establishing a temporary vegetative cover with fast growing seedlings on disturbed areas.
Ds3	TEMPORARY AREA STABILIZATION (WITH PERM SEEDING)			Establishing a permanent vegetative cover with fast growing seedlings on disturbed areas.
Ds4	TEMPORARY AREA STABILIZATION (SOYSEED)			A permanent vegetative cover using soils on highly erodible or critically eroded lands.
Du	SOIL CONTROL ON DISTURBED AREAS			Controlling surface soil and movement of dust on construction site, roadways and similar sites.
Ss	SOIL STABILIZATION			A protective covering used to prevent erosion and establish temporary or permanent vegetation on steep slopes, shore lines, or channels.

CONSERVATION COMMISSION NOTES

1. EROSION CONTROL MEASURES WILL BE MAINTAINED AT ALL TIMES IF FULL IMPLEMENTATION OF THE APPROVED PLAN DOES NOT PROVIDE FOR EFFECTIVE EROSION CONTROL. ADDITIONAL EROSION AND SEDIMENT CONTROL MEASURES SHALL BE IMPLEMENTED TO CONTROL OR TREAT THE SEDIMENT SOURCE.
2. THE ESCAPE OF SEDIMENT FROM THE SITE SHALL BE PREVENTED BY THE INSTALLATION OF SEDIMENT CONTROL MEASURES AND PRACTICES PRIOR TO LAND-DISTURBING ACTIVITIES.
3. ALL EROSION & SEDIMENT CONTROL MEASURES WILL BE CHECKED DAILY AND ANY DEFICIENCIES NOTED WILL BE CORRECTED BY THE END OF EACH DAY. ADDITIONAL EROSION AND SEDIMENT CONTROL MEASURES WILL BE INSTALLED IF DEEMED NECESSARY AFTER ONSITE INSPECTION BY THE ISSUING AUTHORITY.
4. ANY DISTURBED AREA LEFT EXPOSED FOR A PERIOD GREATER THAN 14 DAYS SHALL BE STABILIZED WITH MULCH OR TEMPORARY SEEDING.

DEWATERING NOTE:
WHEN PERFORMING GRADING OPERATIONS DURING PERIODS OF WET WEATHER, PROVIDE ADEQUATE DEWATERING, DRAINAGE AND GROUND WATER MANAGEMENT TO CONTROL MOISTURE OF SOILS.

**PHASE II
EROSION, SEDIMENTATION,
& POLLUTION CONTROL PLAN**

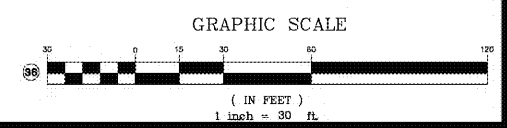

GSWCC# 3001

Project Title
**CIRCLE K DIESEL EXPANSION
CORDELE, GA (CRISP COUNTY)**
BY: **CIRCLE K - SOUTH ATLANTIC DIVISION
WAYCROSS, GA 31501**

REVISIONS

NO	BY

DRAWN BY RLP
CHECKED BY JLH
DATE 12/15/2020
SCALE 1" = 30'
JOB No. 19-LD-090
SHEET NUMBER

ES-2