

GENERAL DEMOLITION NOTES:

1. CONTRACTOR SHALL VERIFY LOCATION OF ALL EXISTING UTILITIES BEFORE SAW CUTTING/DEMOLITION.
2. CONTRACTOR SHALL PROVIDE PROPER SHORING OF EXISTING STRUCTURE, IF REQUIRED, AND PERFORM ANY STRUCTURAL WORK REQUIRED TO MAINTAIN OR PERMANENTLY REESTABLISH THE STRUCTURAL INTEGRITY OF THE BUILDING BEFORE AND AFTER DEMOLITION WORK.
3. THE CONTRACTOR SHALL BE RESPONSIBLE FOR PROVIDING ALL INTERIOR FLOOR SLAB TRENCHING AND EXCAVATION REQUIRED FOR INSTALLATION OF SUB-SLAB UTILITY LINES, NEW STRUCTURAL FOUNDATIONS AND STRUCTURAL FEATURES AND ALL NEW CONSTRUCTION. CONTRACTOR SHALL BACKFILL ALL TRENCHING, COMPACT SOIL, APPLY TERMITE TREATMENT, INSTALL 4" GRAVEL BASE, VAPOR BARRIER, AND SLAB. COORDINATE WITH ARCHITECT.
4. REMOVE PLUMBING FIXTURES, PIPING, LIGHTING, WIRING AND CONDUIT FROM ALL WALLS AND CEILING TO BE DEMOLISHED. WHERE PLUMBING FIXTURES ARE TO BE REMOVED, DRAINS SHALL BE CAPPED.
5. SAW-CUTTING OF CONCRETE SLAB SHOULD BE CUT IN 90° INCREMENTS AND WHERE POSSIBLE TO CLOSEST CONTROL JOINT, UNLESS INDICATED OTHERWISE. CUTS SHALL ALIGN WITH THE ORIENTATION OF THE STRUCTURAL GRID AND BUILDING FLOOR PLAN. CUTS SHALL BE STRAIGHT AND SMOOTH. CUTS ON OPPOSITE SIDES OF TRENCHES SHALL BE EVENLY PARALLEL.
6. G.C. RESPONSIBLE FOR FIELD VERIFYING EXISTING CONDITIONS FOR TRENCHES. NEW WORK SHOULD BE COORDINATED BEFORE DEMOLITION BEGINS.
7. G.C. WILL DEACTIVATE AND LOWER ALL CLEAN-OUTS, HOSE BIB, FLOOR BOXES, FLUSH MOUNTED ELECTRICAL BOXES, ETC. BELOW SLAB AND COVER WITH NEW SLAB ASSEMBLY. FIELD VERIFY ALL LOCATIONS AND CONDITIONS.
8. CONTRACTOR SHALL ESTABLISH IF WALL OR ITEM TO BE REMOVED IS LOAD BEARING IN ANY WAY OR IF IT BRACES ANY BUILDING COMPONENT. SUPPORTS ROOF, INTERIOR OR EXTERIOR EQUIPMENT. IF SO, CONTRACTOR SHALL REFRAIN FROM DEMOLISHING THE COMPONENT IN QUESTION UNTIL CONTRACTOR HAS CONTACTED THE STRUCTURAL ENGINEER AND OBTAINED HIS AUTHORIZATION TO PROCEED. CONTRACTOR IS RESPONSIBLE FOR ALL DEMOLITION SHORING AND BRACING.
9. WHERE EXISTING BLOCK WALLS TO BE REMOVED ARE SUPPORTED ON SLAB, CONTRACTOR SHALL REMOVE WALL, REBARS, ETC. AND PATCH SLAB SMOOTH.
10. PREDEMOLITION CONFERENCE: CONDUCT CONFERENCE AT PROJECT SITE:
 - a. INSPECT AND DISCUSS CONDITION OF CONSTRUCTION TO BE DEMOLISHED.
 - b. REVIEW STRUCTURAL LOAD LIMITATIONS OF EXISTING STRUCTURES.
 - c. REVIEW AND FINALIZE BUILDING DEMOLITION SCHEDULE AND VERIFY AVAILABILITY OF DEMOLITION PERSONNEL, EQUIPMENT, AND FACILITIES NEEDED TO MAKE PROGRESS AND AVOID DELAYS.
 - d. REVIEW AND FINALIZE PROTECTION REQUIREMENTS.
 - e. REVIEW PROCEDURES FOR NOISE CONTROL AND DUST CONTROL.
 - f. REVIEW PROCEDURES FOR PROTECTION OF ADJACENT BUILDINGS.
 - g. REVIEW ITEMS TO BE SALVAGE AND RETURNED TO OWNER.
11. REGULATORY REQUIREMENTS: COMPLY WITH GOVERNING EPA AND ALL OTHER GOVERNMENT AGENCIES NOTIFICATION REGULATIONS OF AUTHORITIES HAVING JURISDICTION.
12. HAZARDOUS MATERIALS:
 - a. HAZARDOUS MATERIALS WILL BE REMOVED BY OWNER BEFORE THE START OF WORK (UNDER SEPARATE CONTRACT)
 - b. IF MATERIALS SUSPECTED OF CONTAINING HAZARDOUS MATERIALS ARE ENCOUNTERED, DO NOT DISTURB; IMMEDIATELY NOTIFY ARCHITECT AND OWNER. HAZARDOUS MATERIALS WILL BE REMOVED BY OWNER UNDER SEPARATE CONTRACT.
 - c. VERIFY THAT HAZARDOUS MATERIALS HAVE BEEN REMEDIATED BEFORE PROCEEDING WITH BUILDING DEMOLITION OPERATIONS.
13. PREDEMOLITION PHOTOGRAPHS: SHOW EXISTING CONDITIONS OF ADJOINING CONSTRUCTION AND SITE IMPROVEMENTS, INCLUDING FINISH SURFACES, THAT MIGHT BE MISCONSTRUCTED AS DAMAGED CAUSED BY DEMOLITION OPERATIONS. COMPLY WITH SECTION 013233 "PHOTOGRAPHIC DOCUMENTATION". SUBMIT BEFORE WORK BEGINS.
14. ENGAGE A PROFESSIONAL ENGINEER TO PERFORM AN ENGINEERING SURVEY OF CONDITION OF BUILDING TO DETERMINE WHETHER REMOVING ANY ELEMENT MIGHT RESULT IN STRUCTURAL DEFICIENCY OR UNPLANNED COLLAPSE OF ANY PORTION OF STRUCTURE OR ADJACENT STRUCTURES DURING BUILDING DEMOLITION OPERATIONS.
15. TEMPORARY SHORING: PROVIDE AND MAINTAIN INTERIOR AND EXTERIOR SHORING, BRACING, OR STRUCTURAL SUPPORT TO PRESERVE STABILITY AND PREVENT UNEXPECTED MOVEMENT OF COLLAPSE OF CONSTRUCTION BEING DEMOLISHED. STRENGTHEN OR ADD SUPPORTS WHEN REQUIRED DURING PROGRESS OF DEMOLITION.
16. BELOW-GRADE CONSTRUCTION: DEMOLISH FOUNDATION WALLS AND OTHER BELOW-GRADE CONSTRUCTION. REMOVE BELOW-GRADE CONSTRUCTION, INCLUDING BASEMENTS, PITS OR TANKS, FOUNDATION WALLS, AND FOOTINGS TO EXTENT REQUIRED TO ACCOMMODATE AND ALLOW FOR NEW CONSTRUCTION.
17. STEEL TENDONS: LOCATE TENSIONED STEEL TENDONS AND INCLUDE RECOMMENDATIONS FOR DE-TENSIONING.
18. REMOVE: DETACH ITEMS FROM EXISTING CONSTRUCTION AND LEGALLY DISPOSE OF THEM OFF-SITE UNLESS INDICATED TO BE REMOVED AND SALVAGED.
19. REFRIGERANTS:
 - a. REMOVE REFRIGERANT FROM MECHANICAL EQUIPMENT TO BE DEMOLISHED ACCORDING TO 40.CFR.82 AND REGULATIONS OF AUTHORITIES HAVING JURISDICTION BEFORE STARTING DEMOLITION.
 - b. STATEMENT OF REFRIGERANT RECOVERY: SIGNED BY A REFRIGERANT RECOVERY TECHNICIAN RESPONSIBLE FOR RECOVERING REFRIGERANT, STATING THAT ALL REFRIGERANT THAT WAS PRESENT WAS RECOVERED AND THAT RECOVERY WAS PERFORMED ACCORDING TO EPA REGULATIONS. INCLUDE NAME AND ADDRESS OF THE TECHNICIAN AND DATE REFRIGERANT WAS RECOVERED.
 - c. REFRIGERANT RECOVERY TECHNICIAN QUALIFICATIONS: CERTIFIED BY EPA-APPROVED CERTIFICATION PROGRAM.
20. EXISTING UTILITIES: LOCATE, IDENTIFY, DISCONNECT AND SEAL OR CAP OFF INDICATED UTILITIES TO BE DEMOLISHED. CONSULT WITH OWNER AND ARCHITECT TO IDENTIFY.
21. TEMPORARY PROTECTION: ERECT TEMPORARY PROTECTION, SUCH AS WALKS, FENCES, RAILINGS, CANOPIES, AND COVERED PASSAGEWAYS, WHERE REQUIRED BY AUTHORITIES HAVING JURISDICTION AND AS INDICATED. COMPLY WITH THE REQUIREMENTS IN SECTION 015000 "TEMPORARY FACILITIES AND CONTROLS"
22. BELOW-GRADE AREAS: ROUGH GRADE BELOW GRADE AREAS READY FOR FURTHER EXCAVATION OR NEW CONSTRUCTION.
23. BELOW-GRADE AREAS: COMPLETELY FILL BELOW-GRADE AREAS AND VOIDS RESULTING FROM BUILDING DEMOLITION OPERATIONS WITH SATISFACTORY SOIL MATERIALS ACCORDING TO BACKFILL REQUIREMENTS.
24. SITE GRADING: UNIFORMLY ROUGH GRADE AREA OF DEMOLISHED CONSTRUCTION TO A SMOOTH SURFACE, FREE FROM IRREGULAR SURFACE CHANGES. PROVIDE A SMOOTH TRANSITION BETWEEN ADJACENT EXISTING GRADES AND NEW GRADES.
25. THE CONTRACTOR SHALL PREPARE ALL INTERIOR AND EXTERIOR SURFACES TO BE PRIMED, PAINTED COATED OR TO RECEIVE APPLICATIONS OF WATER-PROOFING, EIFS OR VENEERS IN ACCORDANCE WITH THE REQUIREMENTS AND RECOMMENDATIONS OF THE MANUFACTURERS AND INSTALLERS OF THESE PRODUCTS AND SYSTEMS. IF HAZARDOUS MATERIALS ARE ENCOUNTERED, CONTACT OWNER.
26. REPLACE ALL EXTERIOR PARAPET AND WALL COPING ASSEMBLIES (METAL COPING, WATERPROOF MEMBRANE FLASHING AND FASTENERS) WITH NEW PRE-FINISHED METAL COPING, P.T. WOOD BLOCKING, WATERPROOF MEMBRANE AND FASTENERS, TYP.

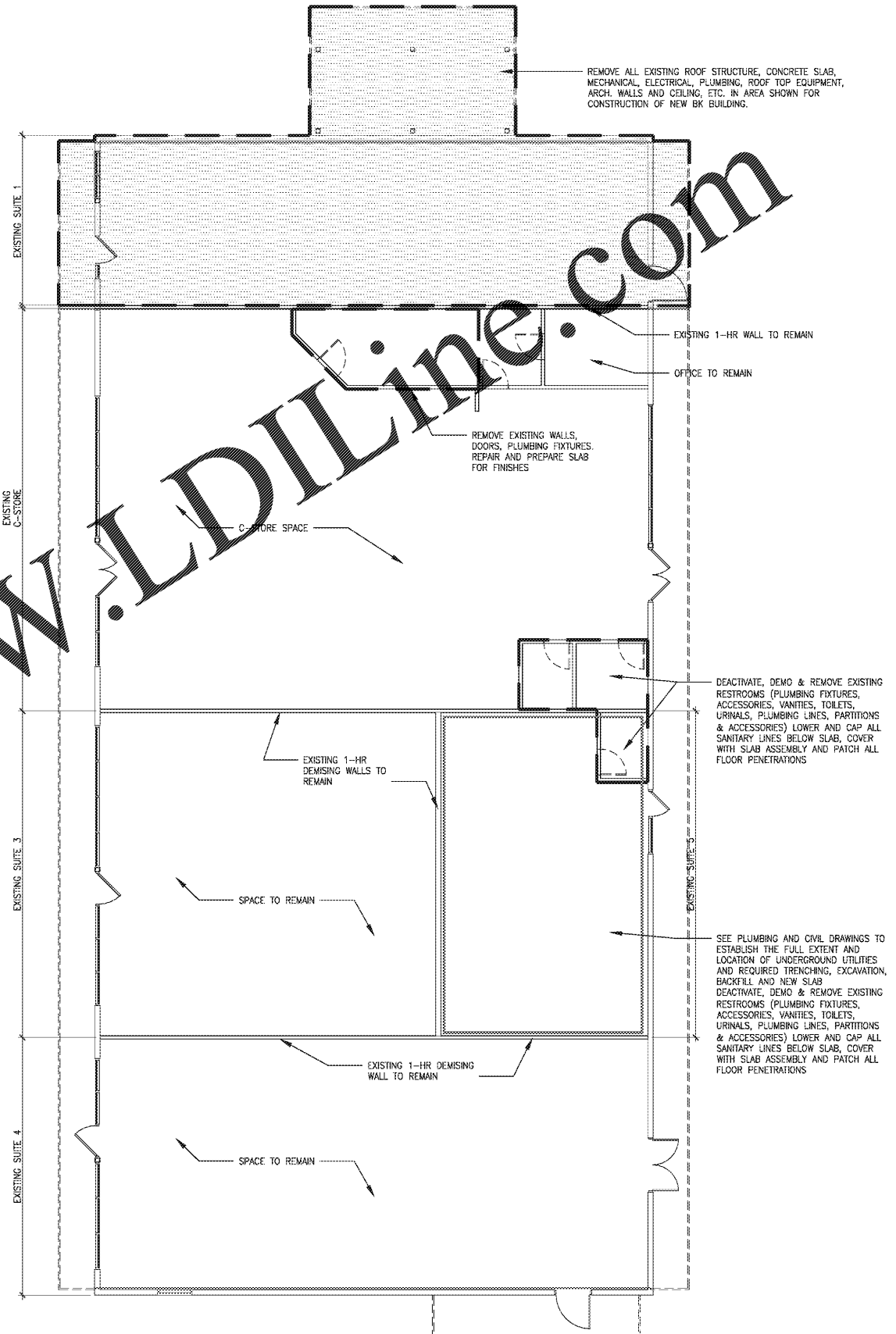

Order Plans @

1
A0.2 DEMOLITION PLAN
SCALE: 1/8" = 1'-0"

ROBERTSON LOIA ROOF
ARCHITECTS & ENGINEERS
3460 Preston Ridge Road · Suite 275 · Alpharetta, Georgia 30005
770-674-2600 · Fax 678-319-0745



PALMETTO BURGER KING
9165 ROOSEVELT HWY, PALMETTO, GA.
FOR
JP DESIGN & CONSTRUCTION
JACKSON, GA.

REVISIONS

SHEET TITLE
DEMOLITION PLAN

DATE
10-30-20

PROJECT NUMBER
20-197

SHEET NUMBER
A0.2

Tuesday, December 01, 2020 01:52:10pm C:\add N:\Projects\2019\2019-197\2019-197.dwg User: jking