

NOTIFY FORSYTH COUNTY INSPECTOR 24 HOURS BEFORE THE BEGINNING PHASE OF CONSTRUCTION. (770) 781-2165.

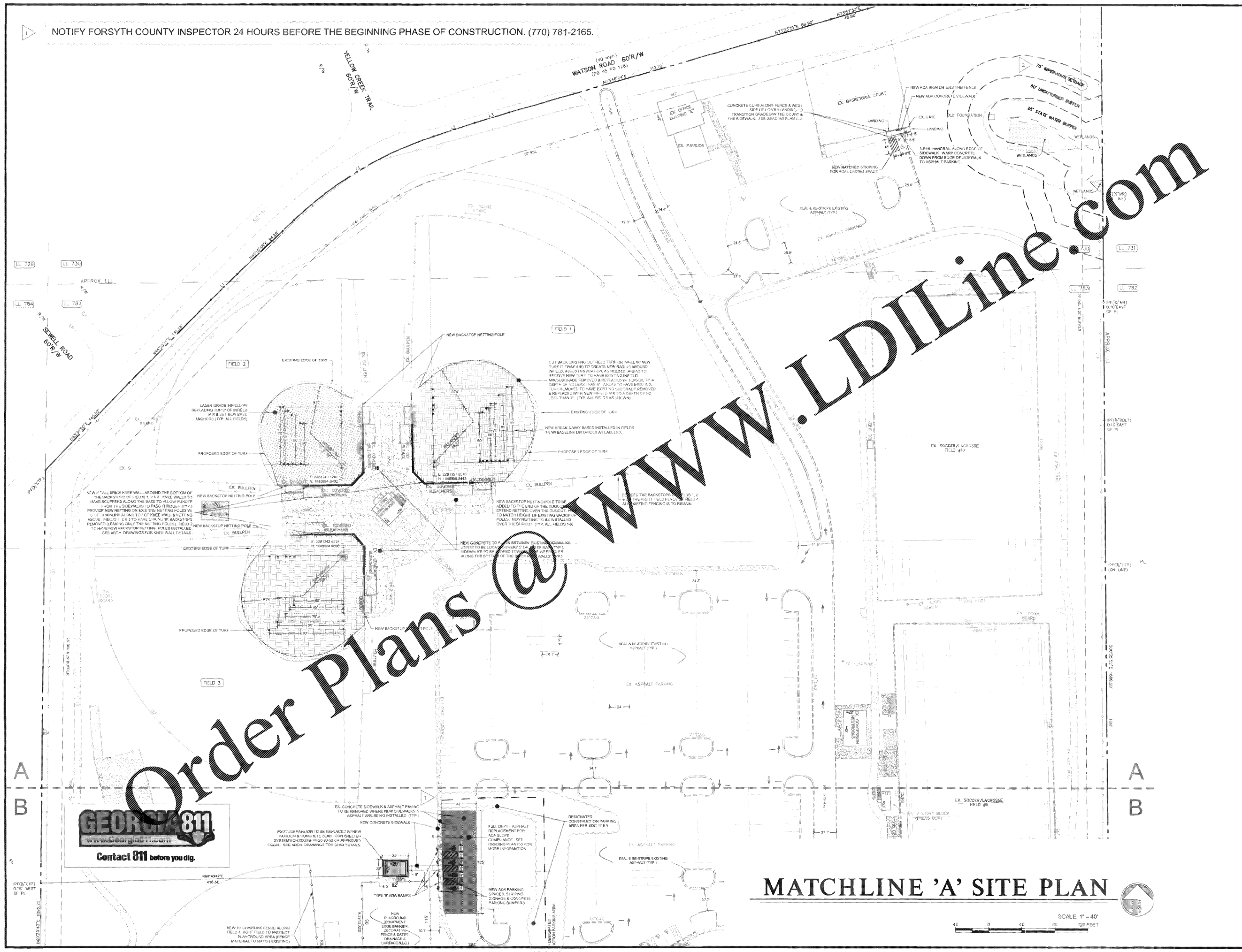

GEORGIA 811
www.Georgia811.com
Contact 811 before you dig.

MATCHLINE 'A' SITE PLAN

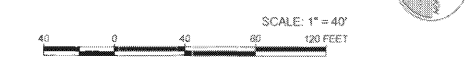

ROBERTSON LOIA ROOF ARCHITECTS & ENGINEERS
3460 Preston Ridge Road, Suite 275, Alpharetta, GA 30025
770-874-2600 / www.rlrc.com



SAWNEE MOUNTAIN PARK IMPROVEMENTS
3995 WATSON ROAD, CUMMING, GEORGIA 30028
FOR
FORSYTH COUNTY PARKS & RECREATION
P.O. BOX 2417, CUMMING, GEORGIA 30028

REF(S) TO COUNTY COMMENTS 10-27-2020
REF(S) TO COUNTY COMMENTS 11-19-2020

MATCHLINE 'A' SITE PLAN

09/09/2020

19323

C-1A