

277V RELAY SCHEDULE LC-1					
RELAY	PANEL	CIRCUIT #	CIRCUIT DESCRIPTION	CONTROL MEANS	NOTES
LC-1	MDP	1	LIGHTING E100	SECURITY SYSTEM	
LC-2	MDP	3	LIGHTING F100	SECURITY SYSTEM	
LC-3	MDP	3	CELLS F100	SECURITY SYSTEM	
LC-4	MDP	5	LIGHTING E100,E104	SECURITY SYSTEM	
LC-5	MDP	5	LIGHTING F100,F104	SECURITY SYSTEM	

- KEYNOTES**  
APPLIES TO E2.4.1 SERIES DRAWINGS  
REPRESENTED BY:
- FIXTURES IN THIS SPACE CONNECTED TO EMERGENCY POWER SHALL BE CONTROLLED BY THE LOCAL SWITCH.
  - PROVIDE UNI-STRUT SPANNING THE BOTTOM OF THE WALKWAY STRUCTURAL MEMBERS TO SUPPORT FIXTURES. PROVIDE GRS CONDUIT ROUTED BETWEEN FIXTURES SECURED TO THE UNI-STRUT WITH DOUBLE THE SUPPORTS REQUIRED BY NEC. UNDER WALKWAY LIGHTING SHALL BE CONTROLLED WITH THE DAY ROOM LIGHTING.
- GENERAL NOTES**
- A. GENERAL NOTES FOR LIGHTING FIXTURE TYPE "D1", "D2", & "D4".
- EXPOSED CONDUIT AND BOXES ARE NOT ACCEPTABLE IN THE SECURED PERIMETER. CONDUIT AND BOXES FOR LIGHTING NOT LOCATED ABOVE A SECURED CEILING SHALL BE EMBEDDED IN THE STRUCTURE AND ROUTED TO JUNCTION BOX IN A CHASE OR ABOVE ACT CEILING (JUNCTION BOX NOT SHOWN).
  - FIXTURES CONNECTED TO NORMAL POWER BY RELAY CONTROLLED: REFER TO THE RELAY SCHEDULE FOR THE RELAY NUMBER. FIXTURES CONNECTED TO EMERGENCY POWER SHALL NOT BE CONTROLLED.
- B. GENERAL NOTES FOR LIGHTING FIXTURE TYPE "D4".
- EXPOSED CONDUIT AND BOXES IN THE CEILING ARE NOT ACCEPTABLE. PROVIDE CONDUIT, BOXES AND THE SPECIFIED LIGHTING FIXTURE IN THE CELL WITH CONDUIT AND BOXES FOR LIGHTING EMBEDDED IN THE STRUCTURE AND TERMINATED AT A JUNCTION BOX IN A CHASE (NOT INDICATED FOR CLARITY).
  - PROVIDE A RELAY CONTROLLED INDUCTION OF THE CIRCUIT INDICATED TO CONTROL THE MAIN LIGHTING IN EACH CELL LIGHTING FIXTURE. REFER TO THE RELAY SCHEDULE FOR THE RELAY NUMBER. ALSO PROVIDE AN UNSWITCHED CONDUCTOR OF THE CIRCUIT INDICATED TO THE NIGHT LIGHT IN EACH CELL LIGHTING FIXTURE. WHICH SHALL ILLUMINATE AT ALL TIMES.
- C. GENERAL NOTES FOR LIGHTING FIXTURE TYPE "V1".
- PROVIDE EXPOSED GRS CONDUIT AND CAST BOXES FOR LIGHTING IN CHASES.
  - INTERIOR FIXTURES CONNECTED TO THE EMERGENCY CIRCUIT SHALL NOT BE CONTROLLED OR SWITCHED AND SHALL BE ILLUMINATED 24 HOURS A DAY UNO. EXIT SIGNS SHALL NOT BE SWITCHED.
  - WHERE FIXTURES EQUIPPED WITH BATTERY BACKUP ARE CONTROLLED, PROVIDE AN UNSWITCHED CONDUCTOR OF THE SAME CIRCUIT TO THE FIXTURE'S EMERGENCY INPUT.

Order Plans @ [www.LDILine.com](http://www.LDILine.com)

BASE BID

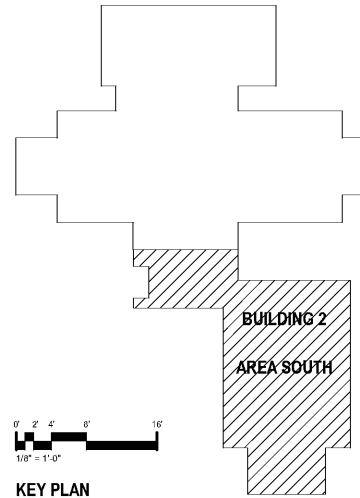
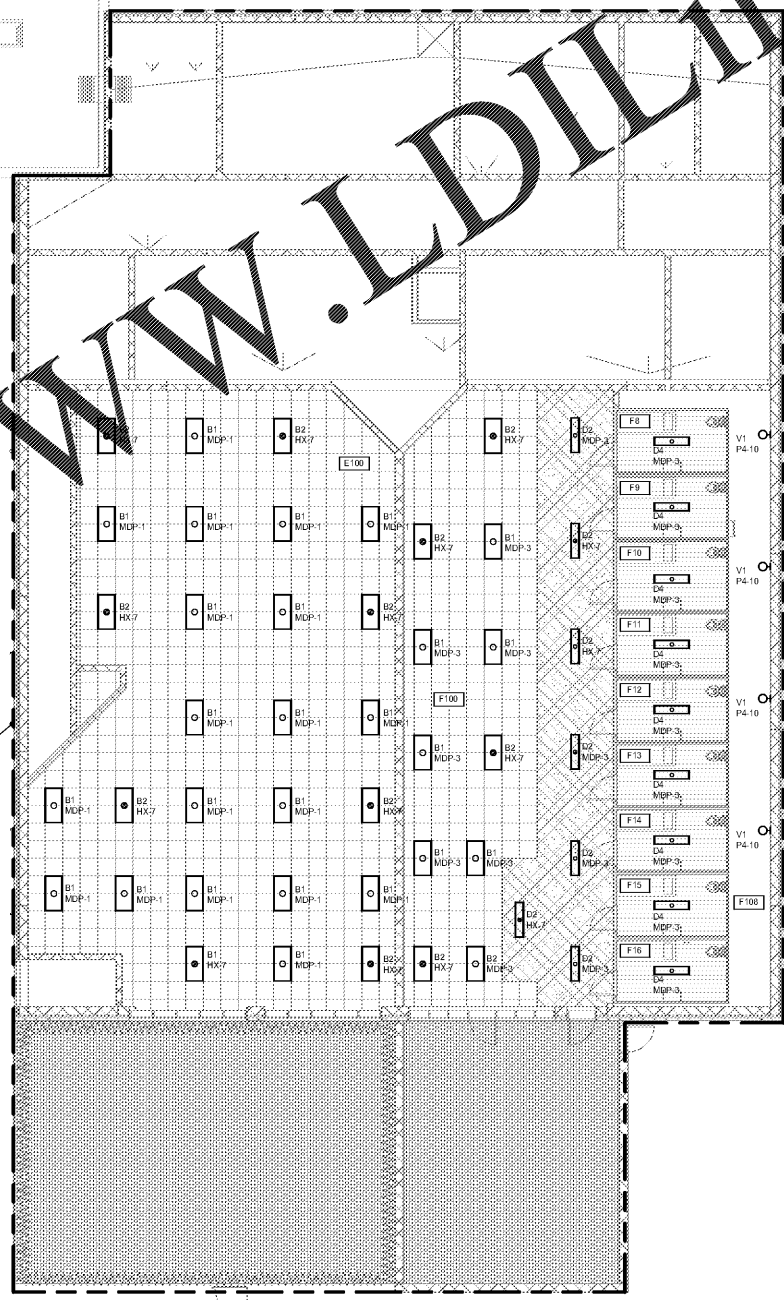

KEY PLAN

MEZZANINE FLOOR PLAN - AREA SOUTH - LIGHTING  
1/8" = 1'-0"

MOSELEYARCHITECTS



MARION COUNTY LEC  
591492  
MARION COUNTY  
2715 EAST HWY 76, MULLINS, SC 29574

PROJECT NO.	DATE	REVISIONS
591492	OCTOBER 30, 2020	

MEZZANINE FLOOR PLAN - AREA SOUTH - LIGHTING

E2.4.1

6210 ARDREY HELL ROAD - THE HUB AT WAVERLY, SUITE 425 - CHARLOTTE, NC 28277  
PHONE (704) 540-3755 FAX (704) 540-3754  
MOSELEYARCHITECTS.COM

10/30/2020 1:22:40 PM