

277V RELAY SCHEDULE LC-1					
RELAY	PANEL	CIRCUIT #	CIRCUIT DESCRIPTION	CONTROL MEANS	NOTES
LC-1	MDP	1	LIGHTING E100	SECURITY SYSTEM	
LC-2	MDP	3	LIGHTING F100	SECURITY SYSTEM	
LC-3	MDP	3	CELLS F100	SECURITY SYSTEM	
LC-4	MDP	5	LIGHTING E102/E104	SECURITY SYSTEM	
LC-5	MDP	5	LIGHTING F102/F104	SECURITY SYSTEM	

KEYNOTES
 APPLIES TO E2.2.1 SERIES DRAWINGS
 REPRESENTED BY [Symbol]

- FIXTURES IN THIS SPACE CONNECTED TO EMERGENCY POWER SHALL BE CONTROLLED BY THE LOCAL SWITCH.
- PROVIDE UNIS-TRUT SPANNING THE BOTTOM OF THE WALKWAY STRUCTURAL MEMBERS TO SUPPORT FIXTURES. PROVIDE GRS CONDUIT ROUTED BETWEEN FIXTURES SECURED TO THE UNIS-TRUT WITH DOUBLE THE SUPPORTS REQUIRED BY NEC UNDER WALKWAY LIGHTING SHALL BE CONTROLLED WITH THE DAY ROOM LIGHTING.

GENERAL NOTES

A. GENERAL NOTES FOR LIGHTING FIXTURE TYPE "D1", "D2", & "D4".

- EXPOSED CONDUIT AND BOXES ARE NOT ACCEPTABLE IN THE SECURED PERIMETER. CONDUIT AND BOXES FOR LIGHTING NOT LOCATED ABOVE A SECURED CEILING SHALL BE EMBEDDED IN THE STRUCTURE AND ROUTED TO A JUNCTION BOX IN A CHASE OR ABOVE ACT CEILING (JUNCTION BOX NOT SHOWN FOR CLARITY).
- FIXTURES CONNECTED TO NORMAL POWER SHALL BE RELAY CONTROLLED. REFER TO THE RELAY SCHEDULE FOR THE RELAY NUMBER. FIXTURES CONNECTED TO EMERGENCY POWER SHALL NOT BE CONTROLLED BY RELAY.

B. GENERAL NOTES FOR LIGHTING FIXTURE TYPE "V1".

- EXPOSED CONDUIT AND BOXES ARE NOT ACCEPTABLE. PROVIDE CONDUIT, BOXES AND THE SPECIFIED LIGHTING FIXTURE IN THE CELL WITH CONDUIT AND BOXES FOR ALL LIGHTING SERVICES TO THE STRUCTURE AND TERMINATED AT A JUNCTION BOX IN A CHASE AND INDICATED FOR CLARITY.
- PROVIDE A RELAY CONTROLLED UNIS-TRUT CONDUCTOR OF THE CIRCUIT INDICATED TO CONTROL MAIN LIGHTS IN EACH CELL LIGHTING FIXTURE. REFER TO THE RELAY SCHEDULE FOR THE RELAY NUMBER. ALSO PROVIDE AN UNSWITCHED CONDUCTOR OF THE CIRCUIT INDICATED TO THE NIGHT LIGHT IN EACH CELL LIGHTING FIXTURE. WHEN THE MAIN LIGHTS ILLUMINATE AT ALL TIMES.

C. INTERIOR FIXTURES CONNECTED TO THE EMERGENCY CIRCUIT SHALL NOT BE CONTROLLED OR SWITCHED AND SHALL BE ILLUMINATED 24 HOURS A DAY UNO. EXIT SIGNS SHALL NOT BE SWITCHED.

D. WHERE FIXTURES EQUIPPED WITH BATTERY BACKUP ARE CONTROLLED, PROVIDE AN UNSWITCHED CONDUCTOR OF THE SAME CIRCUIT TO THE FIXTURE'S EMERGENCY INPUT.

Order Plans @ www.wadline.com

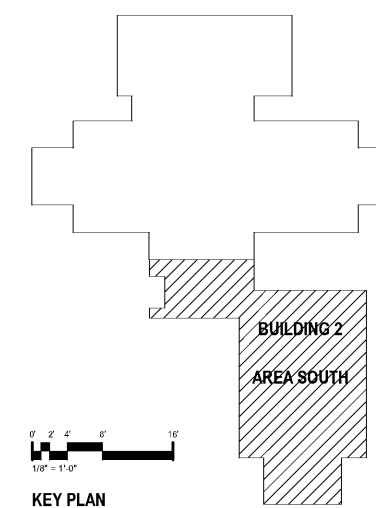
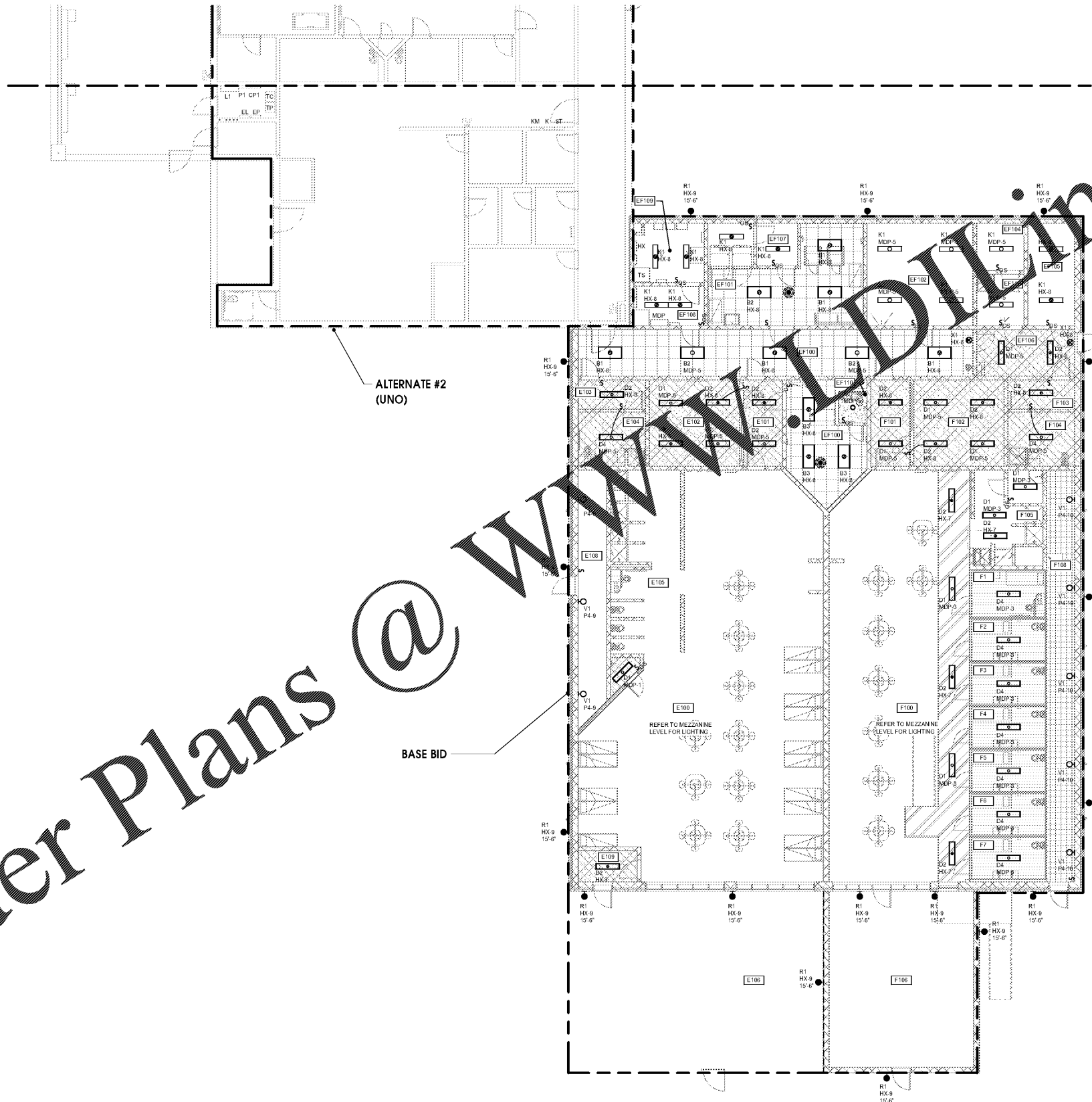

MOSELEYARCHITECTS



MARION COUNTY LEC

591492
 MARION COUNTY
 2715 EAST HWY 76, MULLINS, SC 29574

PROJECT NO.	DATE	REVISIONS
591492	OCTOBER 30, 2020	

FIRST FLOOR PLAN - AREA SOUTH - LIGHTING

E2.2.1

10/30/2020 1:22:26 PM

FIRST FLOOR PLAN - AREA SOUTH - LIGHTING
 1/8" = 1'-0"

6210 ARDREY HELL ROAD - THE HUB AT WAVERLY, SUITE 425 - CHARLOTTE, NC 28277
 PHONE (704) 540-3755 FAX (704) 540-3754
 MOSELEYARCHITECTS.COM