

10/30/2020 1:22:21 PM

J
H
G
F
E
D
C
B
A

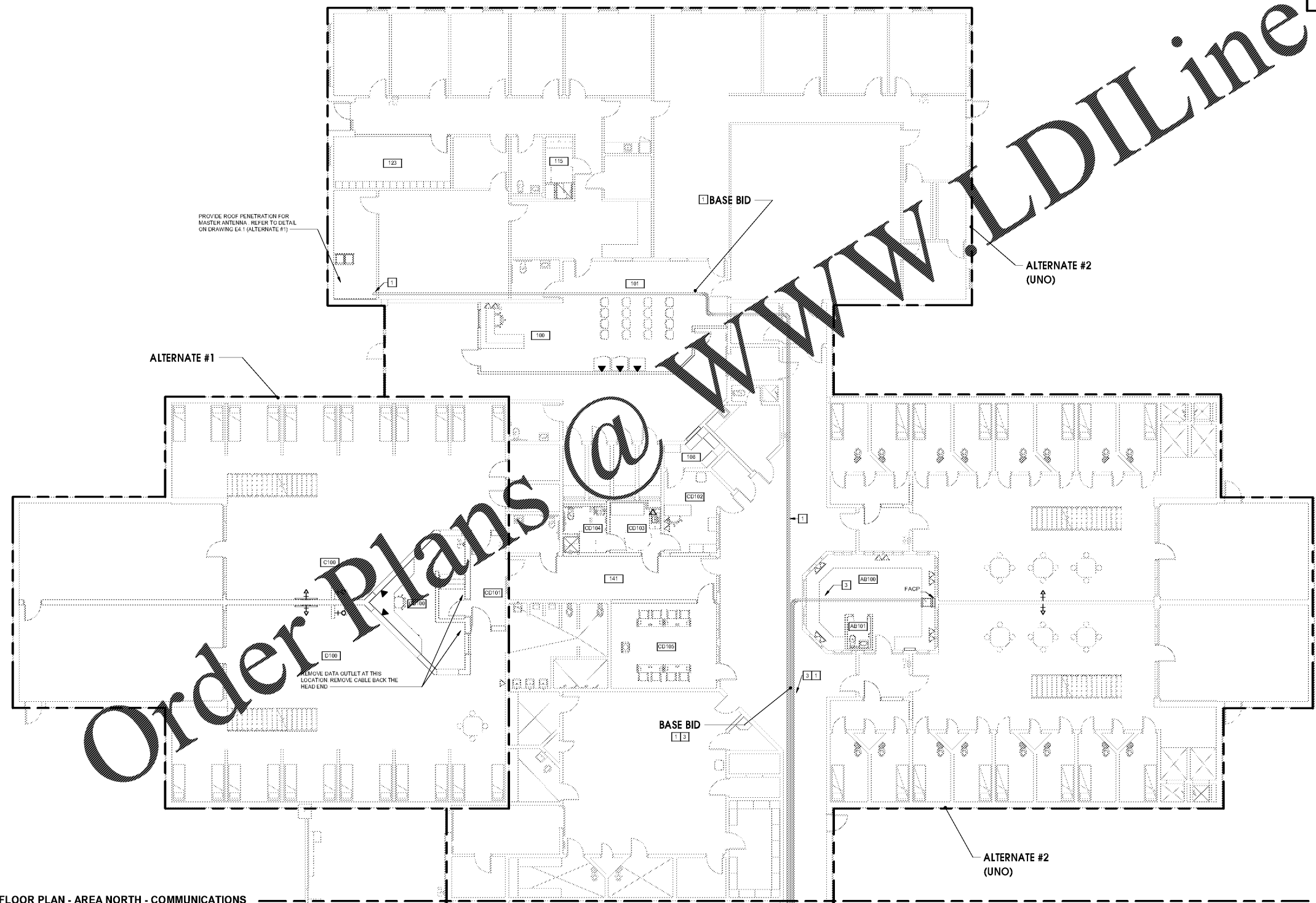

COMM KEYNOTES	
APPLIES TO E2.1.3 SERIES DRAWINGS REPRESENTED BY [Symbol]	
1	PROVIDE TWO 2" CONDUITS FROM EXISTING TELECOM ROOM TO CABLE TRAY IN BUILDING 2 FIELD COORDINATE ROUTING TO AVOID CONFLICTS. PROVIDE ONE 12 STRAND FIBER FROM EXISTING TELECOM ROOM TO SECURITY ROOM VIA ONE CONDUIT AND CABLE TRAY. PROVIDE PULL STRING IN THE OTHER CONDUIT. PROVIDE INNER DUCT FOR FIBER WHERE ROUTED IN CABLE TRAY. (THIS WORK IS BASE BID)
2	PROVIDE ONE 2" POST RACK TO MATCH EXISTING COORDINATE LOCATION WITH SE CONTRACTOR AND OWNER. (THIS WORK IS BASE BID)
3	PROVIDE FOUR 2" CONDUITS WITH PULL STRING FROM EXISTING CONTROL ROOM TO SECURITY ROOM IN BUILDING 2 FIELD COORDINATE ROUTING TO AVOID CONFLICTS. ONE SHALL BE USED BY THE FIRE ALARM CONTRACTOR, ONE BY THE SECURITY CONTRACTOR, AND TWO SPARE. (THIS WORK IS BASE BID)
4	THE RTU'S AND EP'S IN ZONE 1 AND 2 ARE CURRENTLY CONTROLLED BY THE BAS VIA INPUT FOR THE FIRE ALARM SYSTEM. REFER TO THE FIRE ALARM/SMOKE CONTROL MATRIX ON DRAWING E-1 FOR THE REVISED OPERATION OF THE EQUIPMENT ASSOCIATED WITH THE SMOKE CONTROL FOR SMOKE ZONES 1 AND 2. PROVIDE FIRE ALARM CONTROL AND MONITOR MODULES FOR THIS EQUIPMENT TO CONTROL AND MONITOR THE STATUS OF THE EQUIPMENT DIRECTLY FROM THE FIRE ALARM CONTROL PANEL (AND OVERRIDE THE BAS CONTROLS) AS INDICATED ON THE FIRE FIGHTER CONTROL PANEL (FFSCP) ON DRAWING E-2. ALSO WIRE THE CONTROL SWITCHES ON THE FFSCP INDICATED ON DRAWING E-2 TO CONTROL THE EQUIPMENT PER THE MODE OF OPERATION INDICATED THEREIN.
5	PROVIDE 4'X6'X1/2" FIRE RESISTANT PLYWOOD MOUNTED WITH 1/2" DIMENSION MOUNTED VERTICALLY ON WALLS AS NOTED.
6	PROVIDE 18" LADDER TRAY AT 9' 0" THROUGH FOUR 2" CONDUITS. LADDER WITH LADDER TRAY THRU WALL TO THE CABLE TRAY IN CORRIDOR. REFER TO CABLE TRAY WALL PENETRATION DETAIL IN DRAWING E-1 FOR WALL PENETRATION.
GENERAL NOTES	
A. REFER TO ARCHITECTURAL DRAWINGS FOR SMOKE COMPARTMENTS LOCATIONS.	

MOSELEY ARCHITECTS
 6270 ARDREY HELL ROAD - THE HUB AT WAVERLY, SUITE 425 - CHARLOTTE, NC 28277
 PHONE (704) 540-3755 FAX (704) 540-3754
 MOSELEYARCHITECTS.COM



Order Plans @

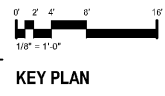
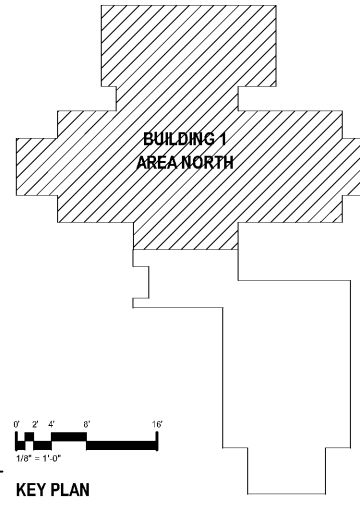

FIRST FLOOR PLAN - AREA NORTH - COMMUNICATIONS
 1/8" = 1'-0"

MARION COUNTY LEC
 591492
 MARION COUNTY
 2715 EAST HWY 76, MULLINS, SC 29574

DATE	REVISIONS
PROJECT NO. 591492	DATE OCTOBER 30, 2020
DATE	DESCRIPTION

FIRST FLOOR PLAN - AREA NORTH - COMMUNICATIONS

E2.1.3